

1120 NORTH EASTERN

MOORE, OK 73160

PROPERTY SUMMARY



PROPERTY DESCRIPTION

Check out this exciting leasing opportunity at 1120 NORTH EASTERN, located in the heart of Moore, OK. With its strategic location, this property is the perfect choice for businesses looking to establish and expand their presence within Moore. Reach out to our team for further information and arrange a showing.

OFFERING SUMMARY

Lease Rate: Currently Occupied | Inquire if Interested

Available SF:

Building Size: 5,436 SF

SPACES	LEASE RATE			SPACE SIZE
DEMOGRAPHICS	1 MILE	3 MILES	5 MILES	
Total Households	3,393	22,553	50,445	
Total Population	9,140	60,136	133,152	



Presented By:

Legacy Commercial Property

847.904.9200

info@legacypro.com

1120 NORTH EASTERN

MOORE, OK 73160

ADDITIONAL PHOTOS



Presented By:

Legacy Commercial Property

847.904.9200

info@legacypro.com



LEGACY
COMMERCIAL PROPERTY

209 Powell Place
Brentwood, TN 37027
<http://legacypro.com>

1120 NORTH EASTERN

MOORE, OK 73160

SITE PLANS

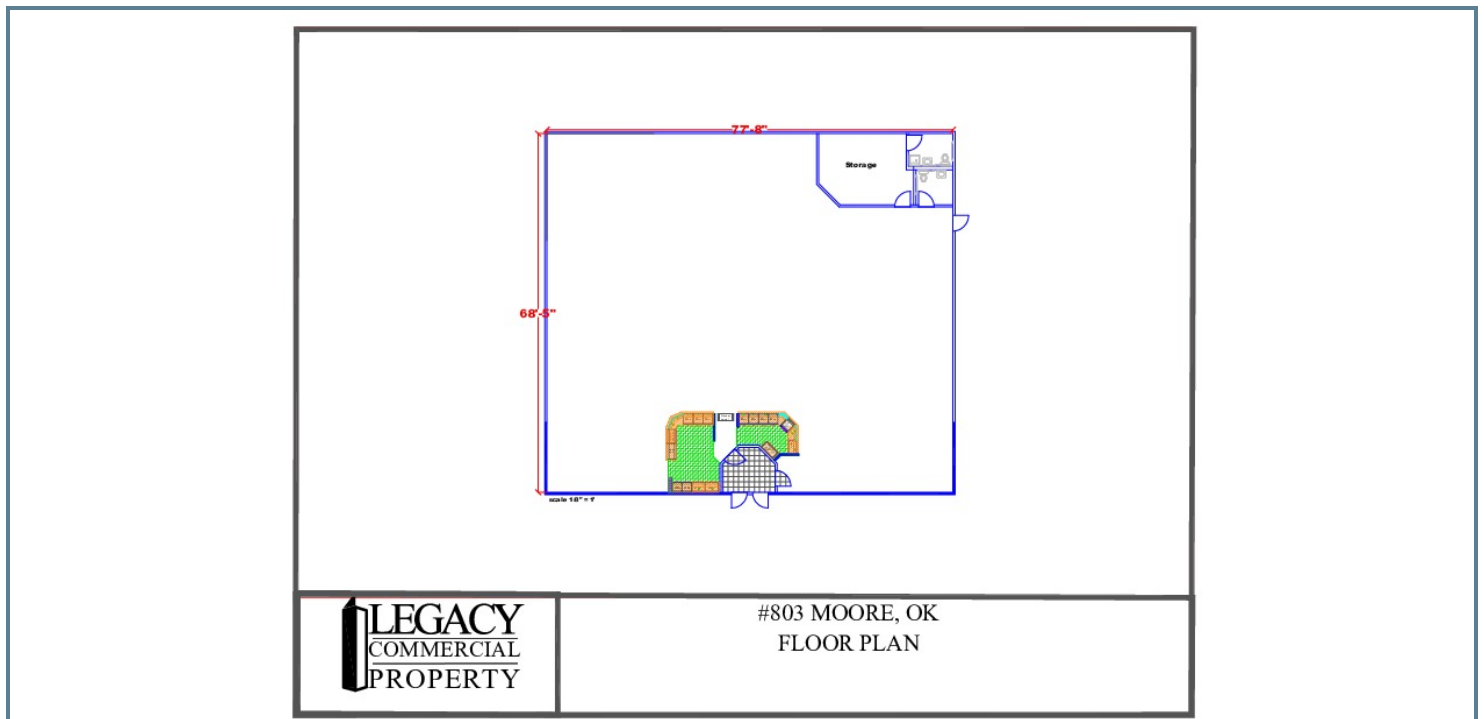

Presented By:

Legacy Commercial Property

847.904.9200

info@legacypro.com



LEGACY
COMMERCIAL PROPERTY

209 Powell Place
Brentwood, TN 37027
<http://legacypro.com>

1120 NORTH EASTERN

MOORE, OK 73160

RENT ROLL

TENANT NAME	UNIT NUMBER	UNIT SIZE (SF)	LEASE START	LEASE END	ANNUAL RENT	% OF GLA	PRICE PER SF/YR
Rose Gold	BLDG	5,436			\$0	100.0	\$0.00
Highland Pure Water & Ice #4261	KIOSK	0			\$0	0.0	
Totals/Averages		5,436			\$0		\$0.00

Presented By:

Legacy Commercial Property

847.904.9200

info@legacypro.com



LEGACY
COMMERCIAL PROPERTY

209 Powell Place
Brentwood, TN 37027
<http://legacypro.com>