

11 NW 67TH ST.

11 NW 67TH ST., LAWTON, OK 73505

PROPERTY SUMMARY

PROPERTY DESCRIPTION

Strong visibility on the northeast corner of W Gore Blvd and SW 67th St with up to 1,200 - 6,000 Sq Ft available

OFFERING SUMMARY

Lease Rate:	Negotiable
Building Size:	8,400 SF

SPACES	LEASE RATE	SPACE SIZE
11 NW 67th St	Negotiable	6,000 SF
11 NW 67th St	Negotiable	1,200 SF

DEMOGRAPHICS	1 MILE	3 MILES	5 MILES
Total Households	4,186	19,473	32,317
Total Population	10,805	44,732	69,183
Average HH Income	\$60,070	\$62,753	\$53,646



Presented By:

Legacy Commercial Property

847.904.9200

info@legacypro.com

11 NW 67TH ST.

11 NW 67TH ST., LAWTON, OK 73505

ADDITIONAL PHOTOS

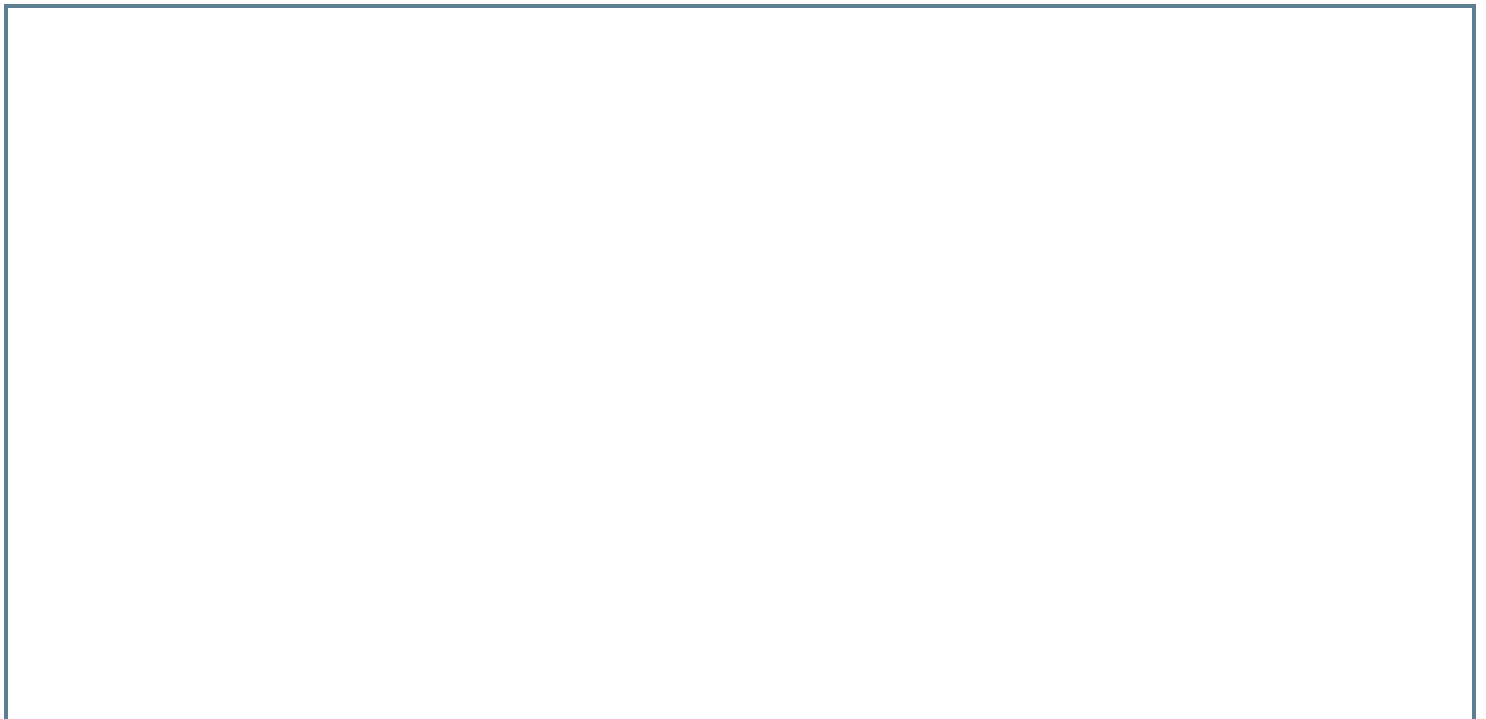

Presented By:

Legacy Commercial Property

847.904.9200

info@legacypro.com



LEGACY
COMMERCIAL PROPERTY

209 Powell Place
Brentwood, TN 37027
<http://legacypro.com>

11 NW 67TH ST.

11 NW 67TH ST., LAWTON, OK 73505

SITE PLANS

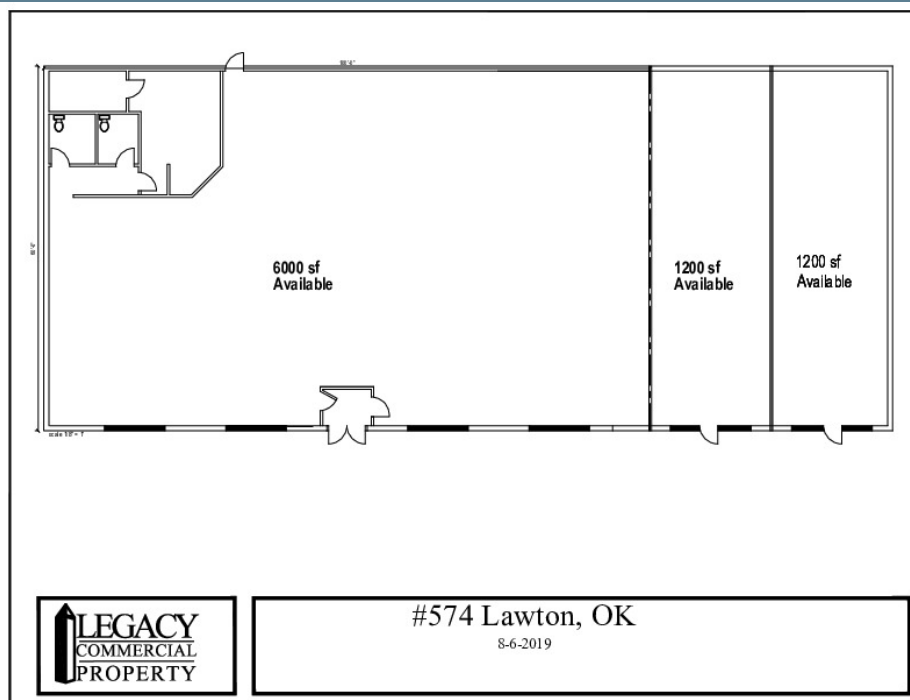

Presented By:

Legacy Commercial Property

847.904.9200

info@legacypro.com



LEGACY
COMMERCIAL PROPERTY

209 Powell Place
Brentwood, TN 37027
<http://legacypro.com>

11 NW 67TH ST.

11 NW 67TH ST., LAWTON, OK 73505

RENT ROLL

TENANT NAME	UNIT NUMBER	UNIT SIZE (SF)	% OF GLA	PRICE PER SF/YR
Vacant	1A	6,000	71.43	\$0.00
Vacant	2B	1,200	14.29	\$0.00
Pot Luck	3C	1,200	14.29	\$0.00
Totals/Averages		8,400		\$0.00

Presented By:

Legacy Commercial Property

847.904.9200

info@legacypro.com



LEGACY
COMMERCIAL PROPERTY

209 Powell Place
Brentwood, TN 37027
<http://legacypro.com>