

612 SANDY LAKE RD

COPPELL, TX 75019

PROPERTY SUMMARY



PROPERTY DESCRIPTION

Check out this exciting leasing opportunity at 612 SANDY LAKE RD, located in the heart of Coppell, TX. With its strategic location, this property is the perfect choice for businesses looking to establish and expand their presence within Coppell. Reach out to our team for further information and arrange a showing.

OFFERING SUMMARY

Lease Rate:	Currently Occupied Inquire if Interested
Number of Units:	3
Available SF:	
Building Size:	12,185 SF

SPACES	LEASE RATE		SPACE SIZE	
DEMOGRAPHICS	1 MILE	3 MILES	5 MILES	
Total Households	4,442	30,086	67,611	

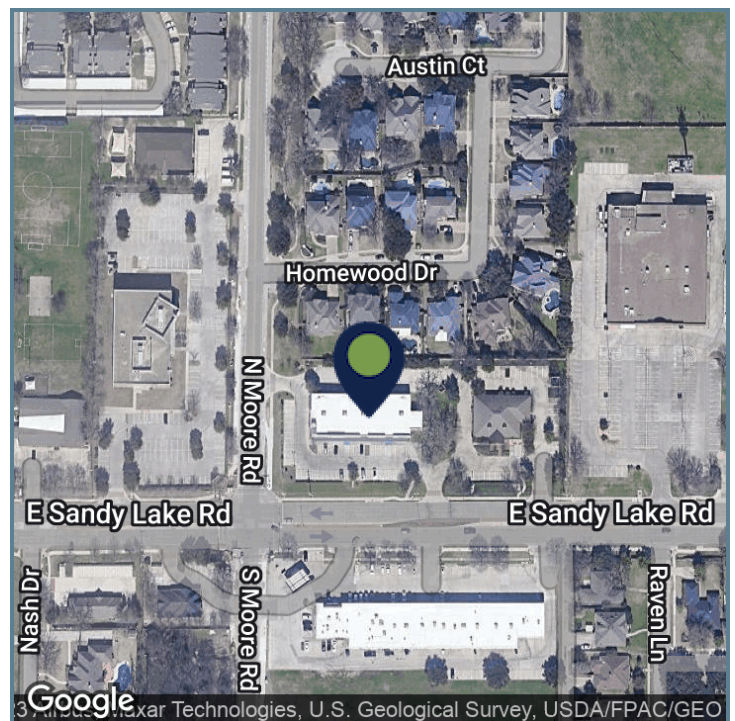

Presented By:

Legacy Commercial Property

847.904.9200

info@legacypro.com

612 SANDY LAKE RD

COPPELL, TX 75019

ADDITIONAL PHOTOS



Presented By:

Legacy Commercial Property

847.904.9200

info@legacypro.com



LEGACY
COMMERCIAL PROPERTY

209 Powell Place
Brentwood, TN 37027
<http://legacypro.com>

612 SANDY LAKE RD

COPPELL, TX 75019

SITE PLANS

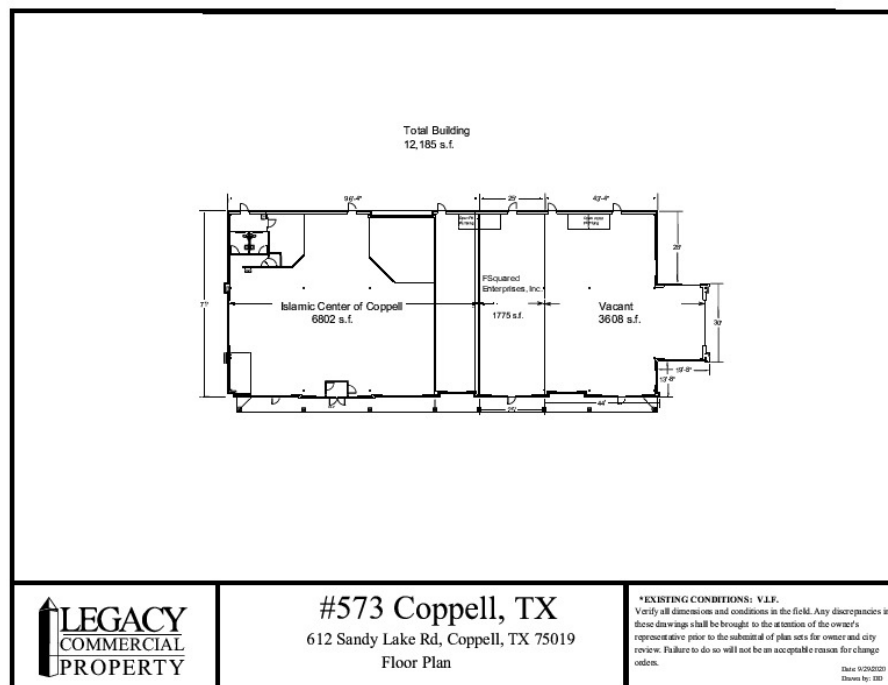
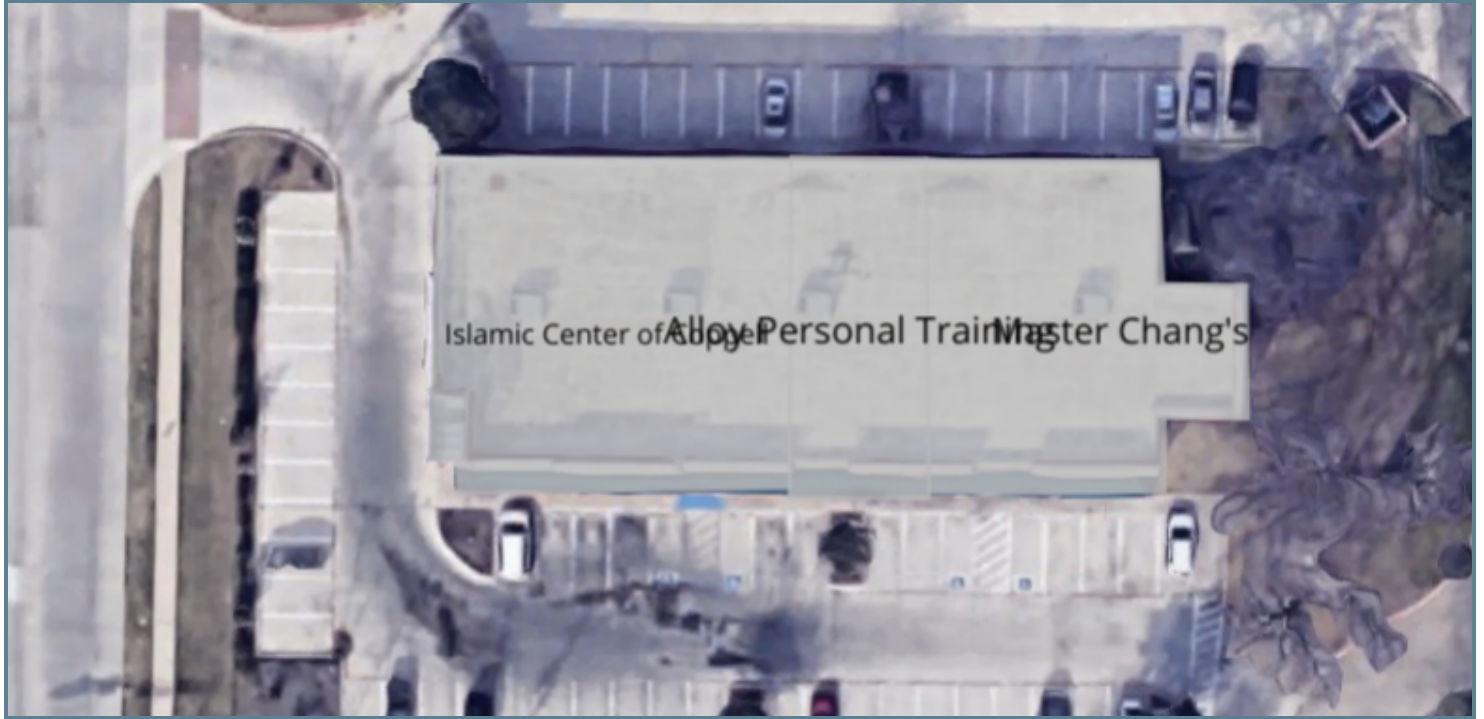

Presented By:

Legacy Commercial Property

847.904.9200

info@legacypro.com



LEGACY
COMMERCIAL PROPERTY

209 Powell Place
Brentwood, TN 37027
<http://legacypro.com>

612 SANDY LAKE RD

COPPELL, TX 75019

RENT ROLL

TENANT NAME	UNIT NUMBER	UNIT SIZE (SF)	LEASE START	LEASE END	ANNUAL RENT	% OF GLA	PRICE PER SF/YR
Islamic Center of Coppel	100	6,802			\$0	55.82	\$0.00
Alloy Personal Training	140	1,775			\$0	14.57	\$0.00
Master Chang's	180	3,608			\$0	29.61	\$0.00
Totals/Averages		12,185			\$0		\$0.00

Presented By:

Legacy Commercial Property

847.904.9200

info@legacypro.com



LEGACY
COMMERCIAL PROPERTY

209 Powell Place
Brentwood, TN 37027
<http://legacypro.com>