

427 5TH AVE

MOON TOWNSHIP, PA 15108

PROPERTY SUMMARY



PROPERTY DESCRIPTION

Check out this exciting leasing opportunity at 427 5TH AVE, located in the heart of Moon Township, PA. With its strategic location, this property is the perfect choice for businesses looking to establish and expand their presence within Moon Township. Reach out to our team for further information and arrange a showing.

OFFERING SUMMARY

Lease Rate:	Currently Occupied Inquire if Interested
Available SF:	
Building Size:	6,000 SF

SPACES	LEASE RATE			SPACE SIZE
DEMOGRAPHICS	1 MILE	3 MILES	5 MILES	
Total Households	2,899	13,111	27,398	
Total Population	6,042	22,205	48,477	

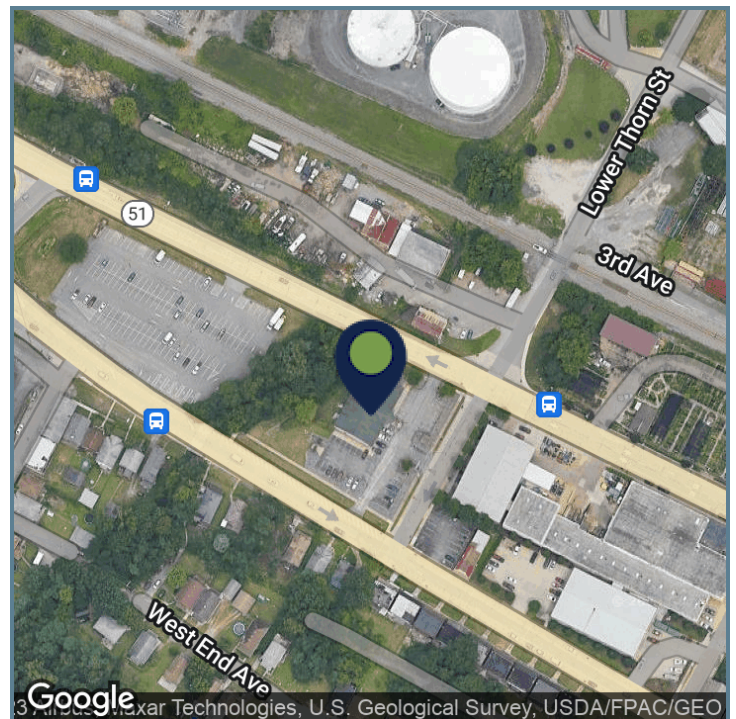

Presented By:

Legacy Commercial Property

847.904.9200

info@legacypro.com

427 5TH AVE

MOON TOWNSHIP, PA 15108

ADDITIONAL PHOTOS



Presented By:

Legacy Commercial Property

847.904.9200

info@legacypro.com



LEGACY
COMMERCIAL PROPERTY

209 Powell Place
Brentwood, TN 37027
<http://legacypro.com>

427 5TH AVE

MOON TOWNSHIP, PA 15108

SITE PLANS

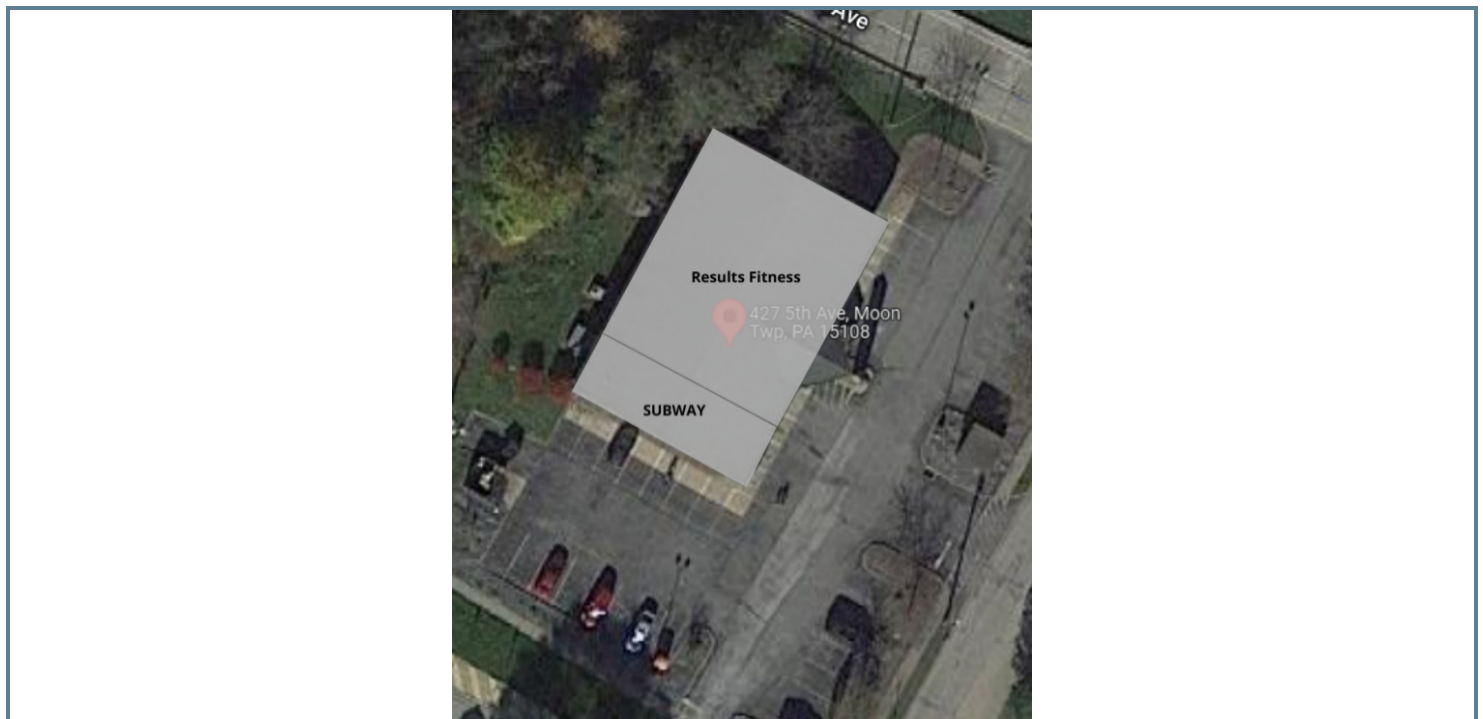
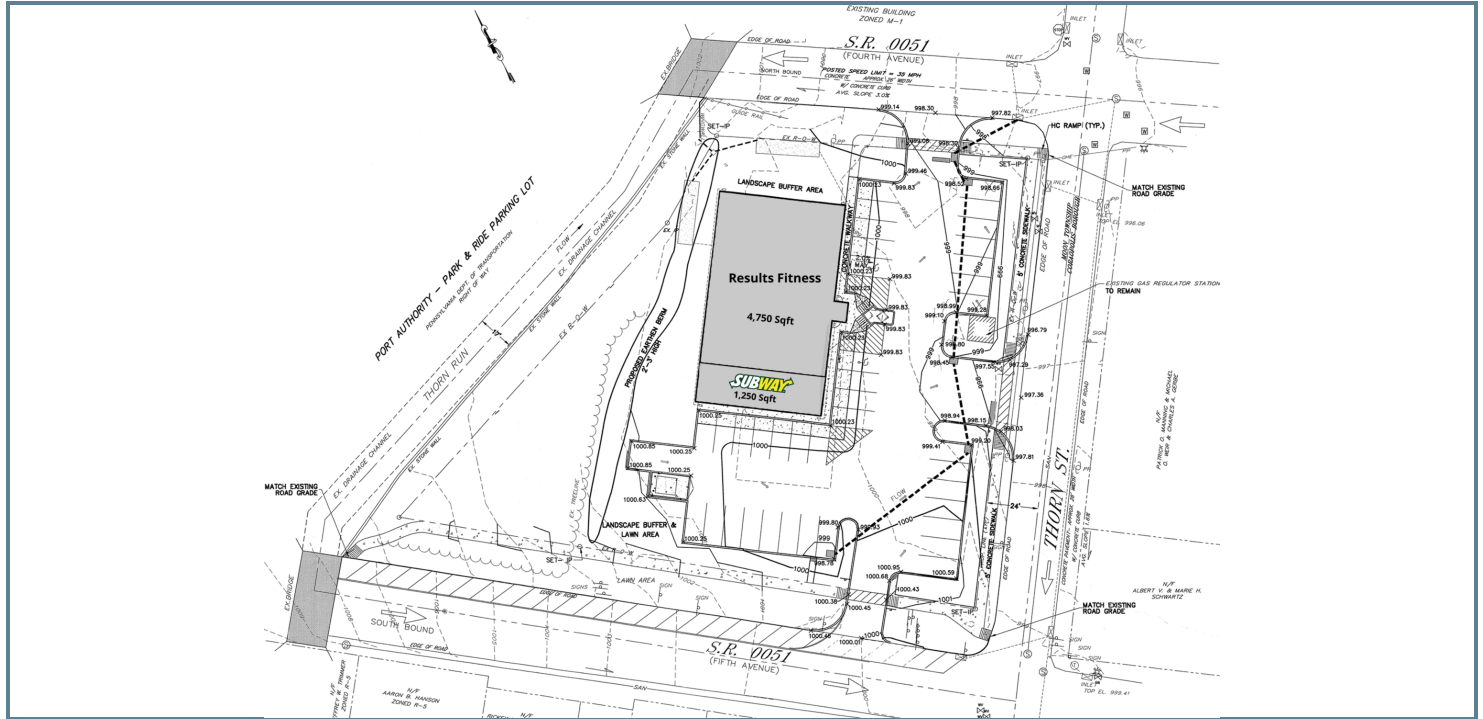

Presented By:

Legacy Commercial Property

847.904.9200

info@legacypro.com



LEGACY
COMMERCIAL PROPERTY

209 Powell Place
Brentwood, TN 37027
<http://legacypro.com>

427 5TH AVE

MOON TOWNSHIP, PA 15108

RETAILER MAP



Presented By:

Legacy Commercial Property

847.904.9200

info@legacypro.com



LEGACY
COMMERCIAL PROPERTY

209 Powell Place
Brentwood, TN 37027
<http://legacypro.com>