

301 W. AUSTIN

NEVADA, MO 64772

PROPERTY SUMMARY



PROPERTY DESCRIPTION

Check out this exciting leasing opportunity at 301 W. AUSTIN, located in the heart of Nevada, MO. With its strategic location, this property is the perfect choice for businesses looking to establish and expand their presence within Nevada. Reach out to our team for further information and arrange a showing.

OFFERING SUMMARY

Lease Rate:	Currently Occupied Inquire if Interested
Number of Units:	2
Available SF:	
Building Size:	7,007 SF

SPACES	LEASE RATE		SPACE SIZE	
DEMOGRAPHICS	1 MILE	3 MILES	5 MILES	
Total Households	995	4,486	5,098	

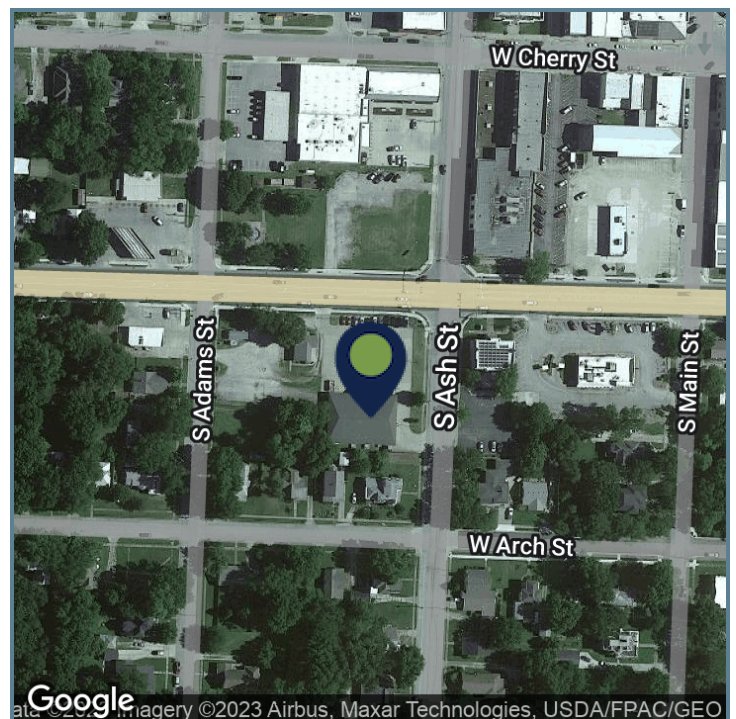

Presented By:

Legacy Commercial Property

847.904.9200

info@legacypro.com

301 W. AUSTIN

NEVADA, MO 64772

ADDITIONAL PHOTOS



Presented By:

Legacy Commercial Property

847.904.9200

info@legacypro.com



LEGACY
COMMERCIAL PROPERTY

209 Powell Place
Brentwood, TN 37027
<http://legacypro.com>

301 W. AUSTIN

NEVADA, MO 64772

SITE PLANS

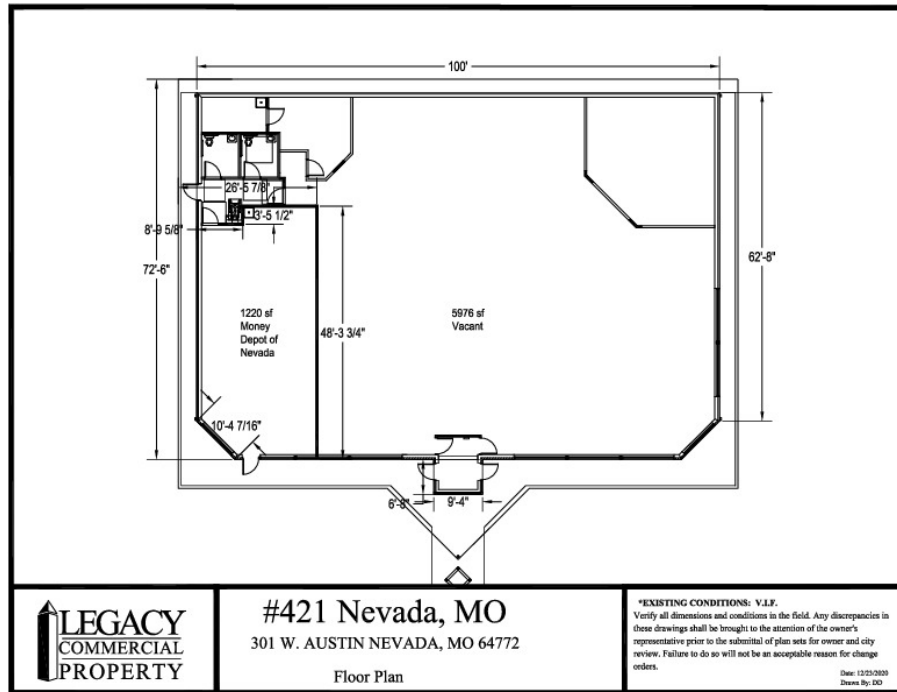

Presented By:

Legacy Commercial Property

847.904.9200

info@legacypro.com



LEGACY
COMMERCIAL PROPERTY

209 Powell Place
Brentwood, TN 37027
<http://legacypro.com>

301 W. AUSTIN

NEVADA, MO 64772

RENT ROLL

TENANT NAME	UNIT NUMBER	UNIT SIZE (SF)	LEASE START	LEASE END	ANNUAL RENT	% OF GLA	PRICE PER SF/YR
Compass Health	BLDG	7,007			\$0	100.0	\$0.00
Totals/Averages		7,007			\$0		\$0.00

Presented By:

Legacy Commercial Property

847.904.9200

info@legacypro.com



LEGACY
COMMERCIAL PROPERTY

209 Powell Place
Brentwood, TN 37027
<http://legacypro.com>