

2305 10TH ST.

2305 10TH ST., MENOMINEE, MI 49858

EXECUTIVE SUMMARY



OFFERING SUMMARY

Available SF:

6,691 SF

PROPERTY OVERVIEW

Strong visibility on the northwest corner of 10th St and 23rd Ave with up to 6691 Sq Ft available

Lease Rate:

Negotiable

Building Size:

6,691 SF



Presented By:

Legacy Commercial Property

847-904-9200

info@legacypro.com



LEGACY
COMMERCIAL PROPERTY

209 Powell Place
Brentwood, TN 37027
<http://legacypro.com>

2305 10TH ST.

2305 10TH ST., MENOMINEE, MI 49858

ADDITIONAL PHOTOS



Presented By:

Legacy Commercial Property

847-904-9200

info@legacypro.com



LEGACY
COMMERCIAL PROPERTY

209 Powell Place
Brentwood, TN 37027
<http://legacypro.com>

2305 10TH ST.

2305 10TH ST., MENOMINEE, MI 49858

PLANS

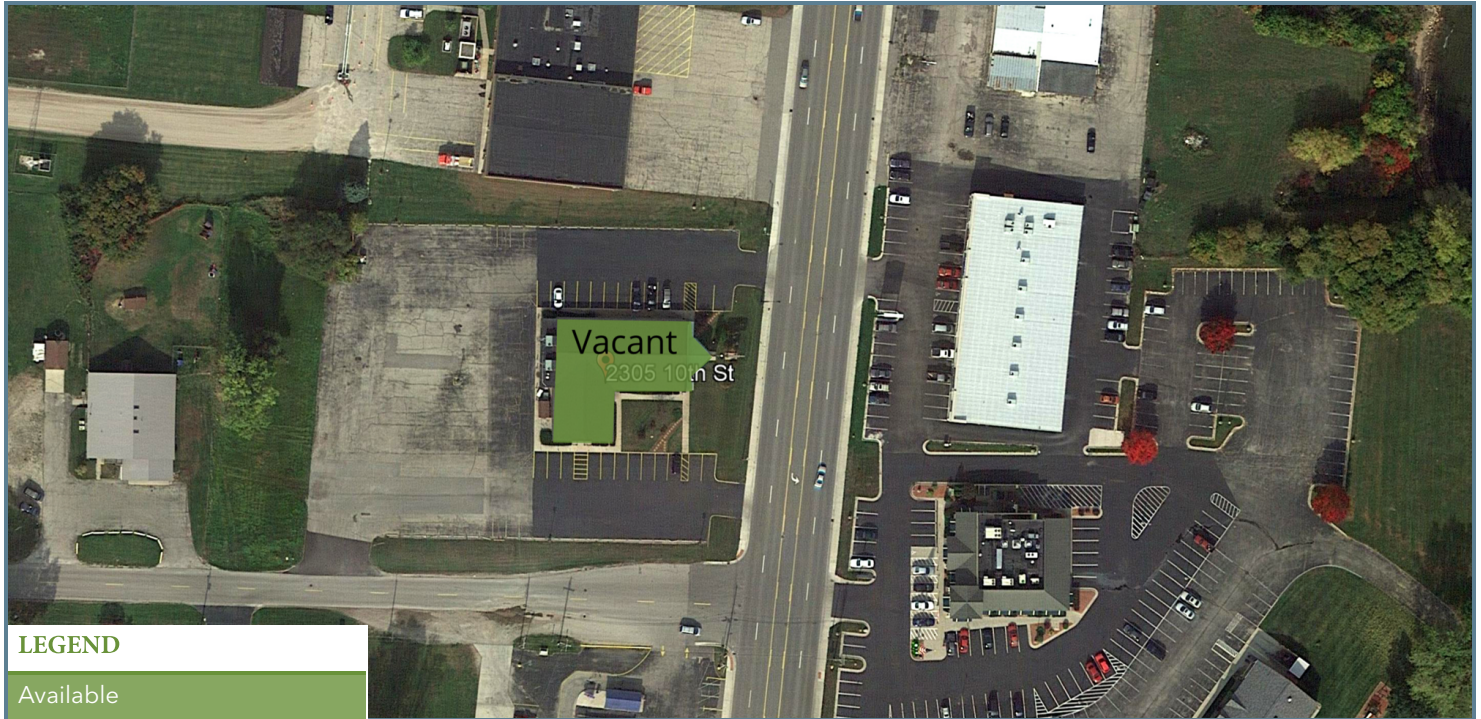

LEASE INFORMATION

Lease Type:	NNN	Lease Term:	Negotiable
Total Space:	6,691 SF	Lease Rate:	Negotiable

AVAILABLE SPACES

SUITE	TENANT	SIZE	TYPE	RATE	DESCRIPTION
2305 10th St	Available	6,691 SF	NNN	Negotiable	-

Presented By:

Legacy Commercial Property

847-904-9200

info@legacypro.com



LEGACY
COMMERCIAL PROPERTY

209 Powell Place
Brentwood, TN 37027
<http://legacypro.com>

2305 10TH ST.

2305 10TH ST., MENOMINEE, MI 49858

FLOOR PLANS

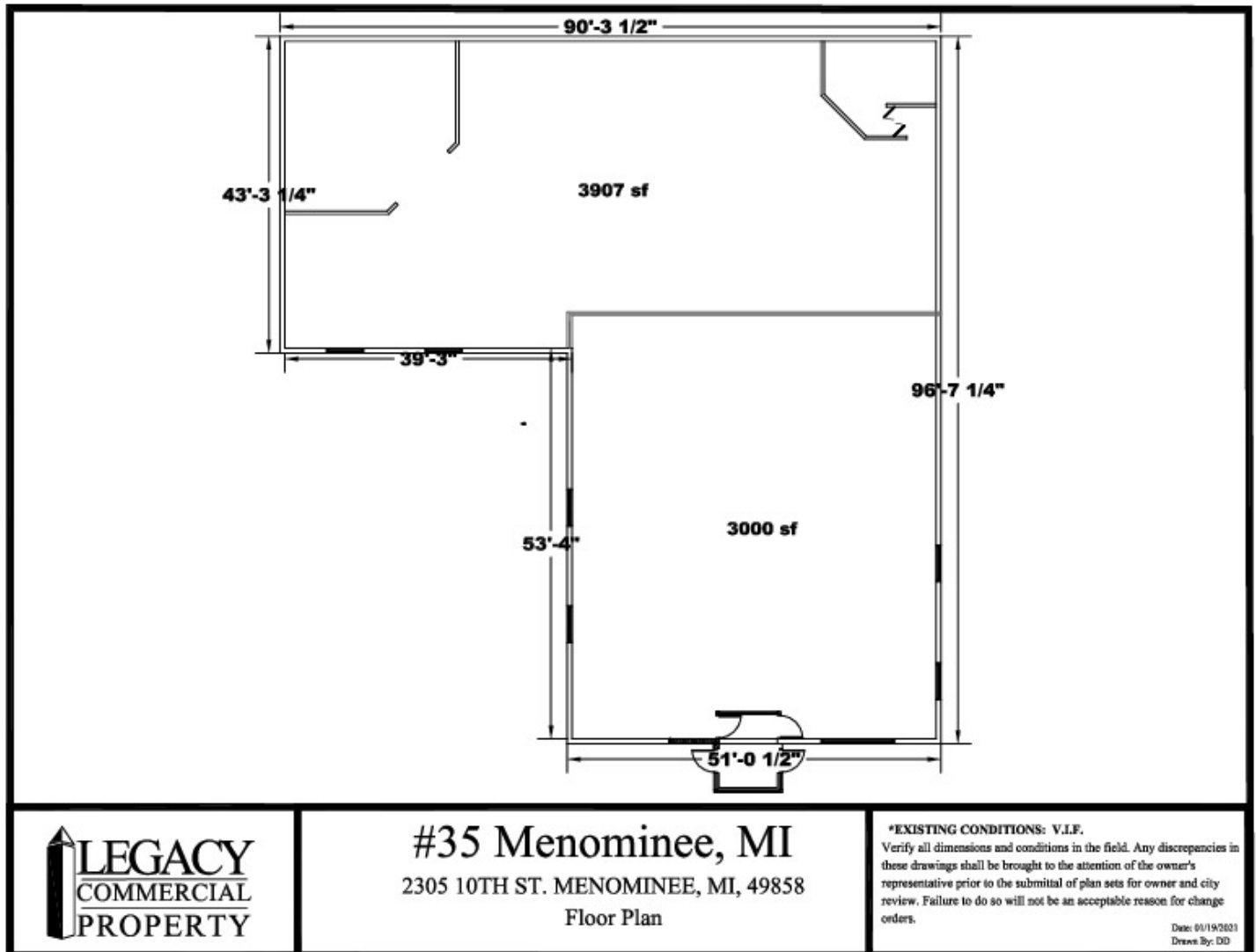

Presented By:

Legacy Commercial Property

847-904-9200

info@legacypro.com



LEGACY
COMMERCIAL PROPERTY

209 Powell Place
Brentwood, TN 37027
<http://legacypro.com>