

Property Summary



OFFERING SUMMARY

Available SF:

Lease Rate: Price Upon Request

Building Size: 17,600 SF

Availability: January 2020

PROPERTY OVERVIEW

SVN is pleased to offer a 10,000 SF flex warehouse space behind the new Dunkin' Donuts, Firehouse Subs, and Taco Bell at the intersection of Chatham Parkway and Ogeechee Rd. The yellow outlined portion in the building elevations above shows the available space. Sherwin-Williams to occupy the remaining portion of the building.

This property is located along the rapidly growing Ogeechee Rd corridor. Ideal for service contractors, this area has long established itself as the best area for supply houses that serve the greater Savannah MSA.

PROPERTY HIGHLIGHTS

- +/- 3 Dock Height Doors
- Sprinklered
- Optional Showroom with Storefront
- Great Exposure to Chatham Pkwy
- Signage on Chatham Pkwy & Ogeechee Rd
- Vehicular Access via Chatham Pkwy & Ogeechee Rd
- Easy Access for Large Trucks & Ample Parking



Site Plan

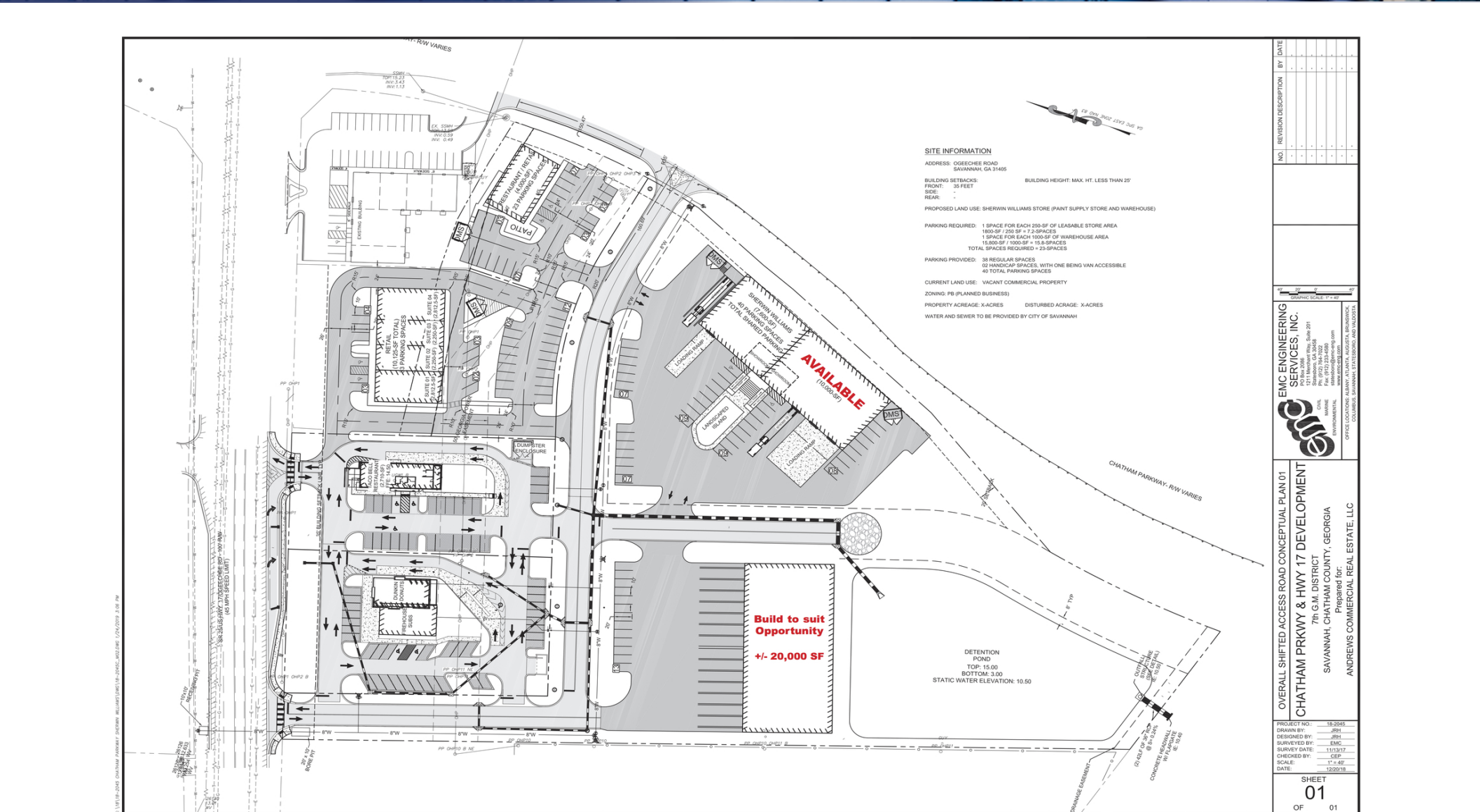

Aerial Map



Additional Photos



Location Maps

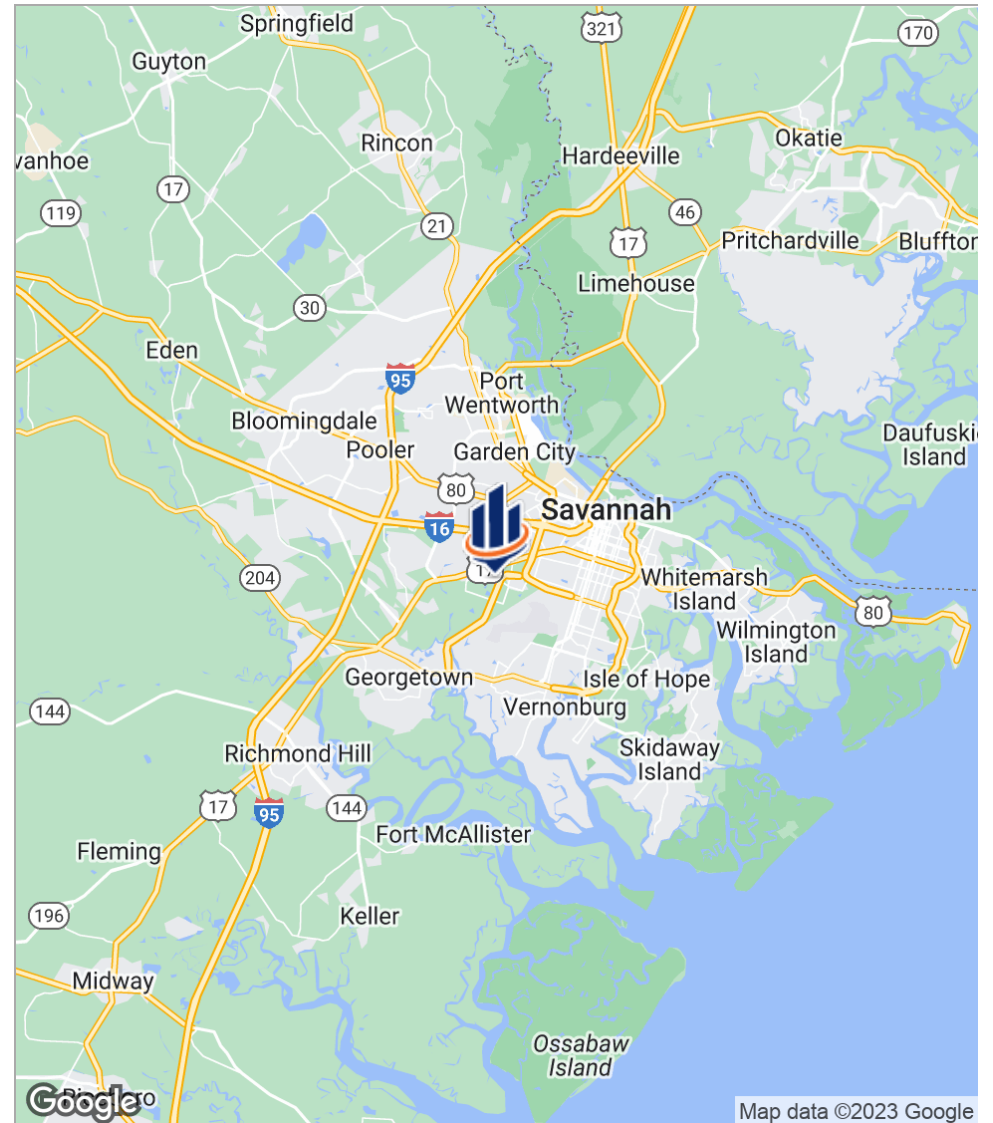
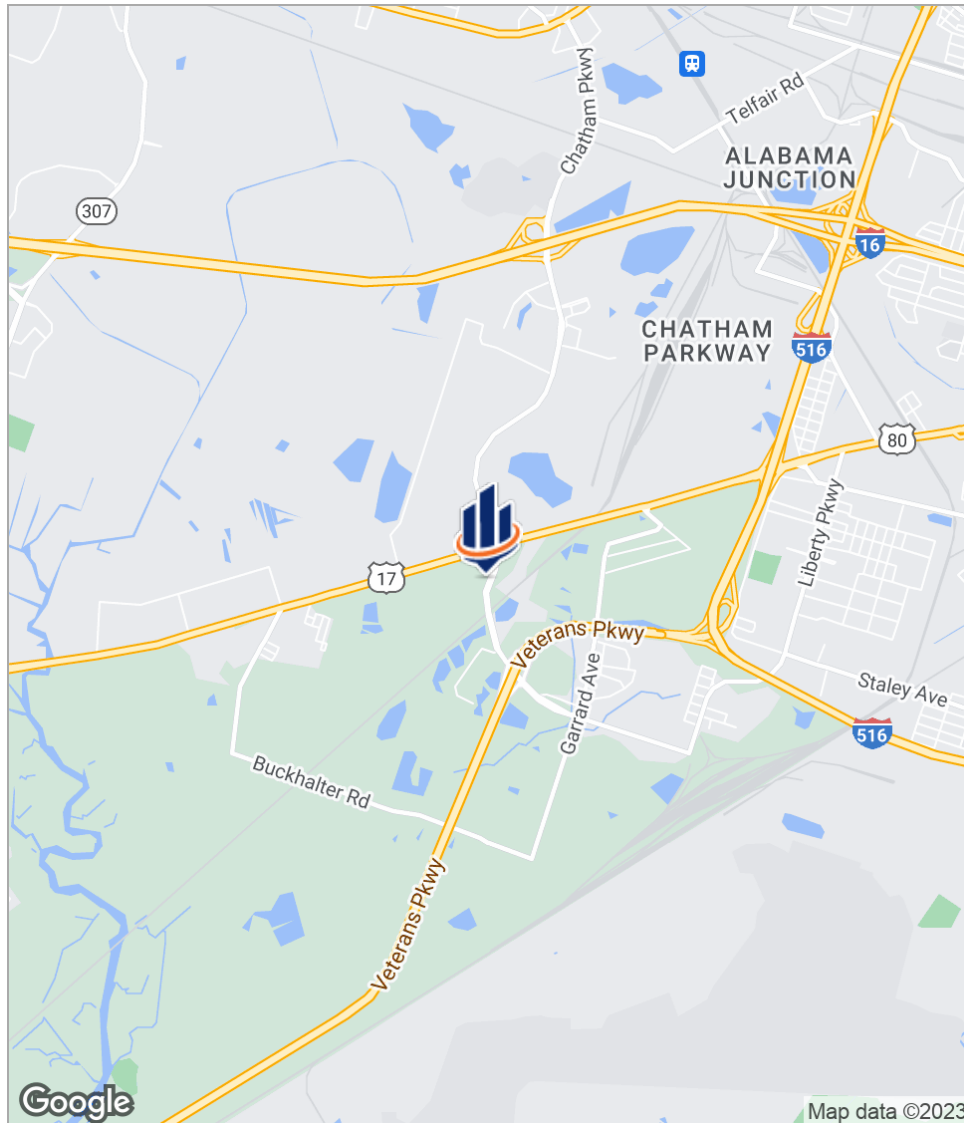

1851 CHATHAM PARKWAY SAVANNAH, GA 31405

SVN | GASC | Page 6

The information presented here is deemed to be accurate, but it has not been independently verified. We make no guarantee, warranty or representation. It is your responsibility to independently confirm accuracy and completeness. All SVN® offices are independently owned and operated.



6001 Chatham Center Drive, Suite 120
Savannah, GA 31405
912.200.4531
www.svnsavhh.com