

2100 N Hayden Island Dr, Portland, OR 97217

FOR SALE

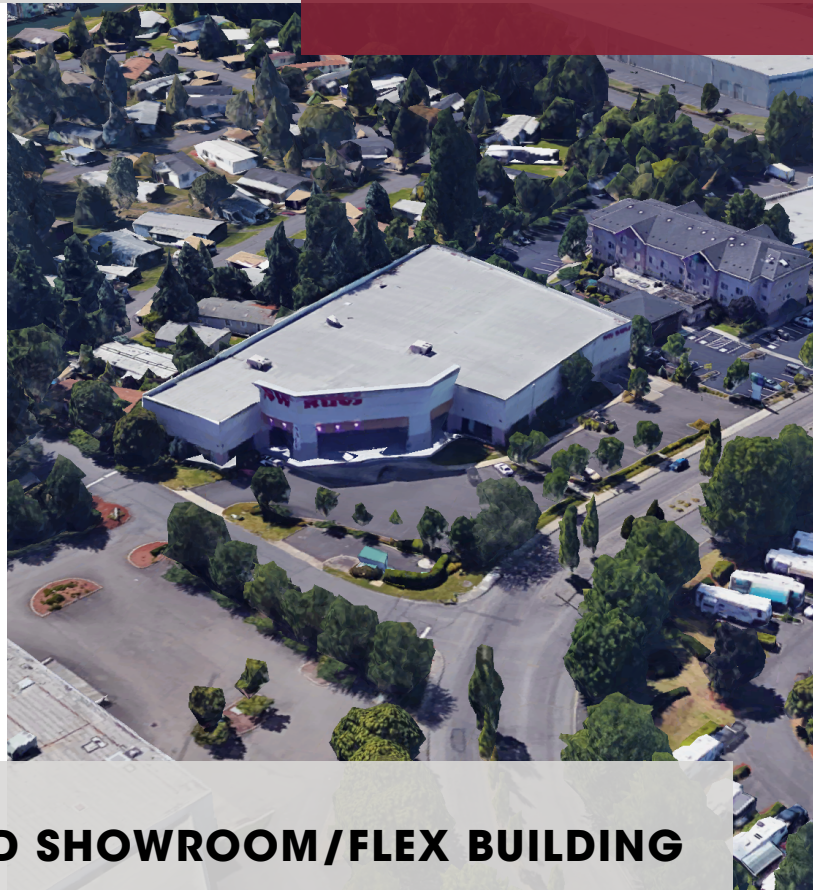

FREESTANDING HAYDEN ISLAND SHOWROOM/FLEX BUILDING

OFFERING SUMMARY

| | |
|------------------------|----------------------|
| Sale Price: | \$7,200,000 |
| Lot Size: | 1.7 Acres |
| Year Built: | 2004 |
| Building Size: | 37,577 SF |
| Zoning: | CE, City of Portland |
| Price / SF: | \$191.61 |
| Property Taxes: | \$57,117 |

PROPERTY OVERVIEW

Rare 15 year-old concrete tilt building on Hayden Island. With high visibility, functional layout, high ceilings, flexible zoning, and direct interstate access, the building offers a unique opportunity for a wide array of uses.

LOCATION OVERVIEW

Located 0.6 miles from I-5, providing immediate access to Vancouver and Downtown Portland.

PROPERTY HIGHLIGHTS

- Dock Height Loading
- Access to Restaurant and Retail Amenities on Hayden Island
- Less than 10 Minutes from North Portland and Vancouver
- Adjacent to Jantzen Beach Center, anchored by Target, Home Depot, & Staples
- Abundant Window Light



Kevin VandenBrink
503.972.7289
kevinv@macadamforbes.com
Licensed in OR

Clayton Madey
503.972.7277
clayton@macadamforbes.com
Licensed in OR

All of the information contained herein was obtained either from the owner or other parties we consider reliable. We have no reason to doubt its accuracy, however we do not guarantee it.

MACADAMFORBES.COM | 503.227.2500

FOR SALE

2100 N Hayden Island Dr , Portland, OR 97217

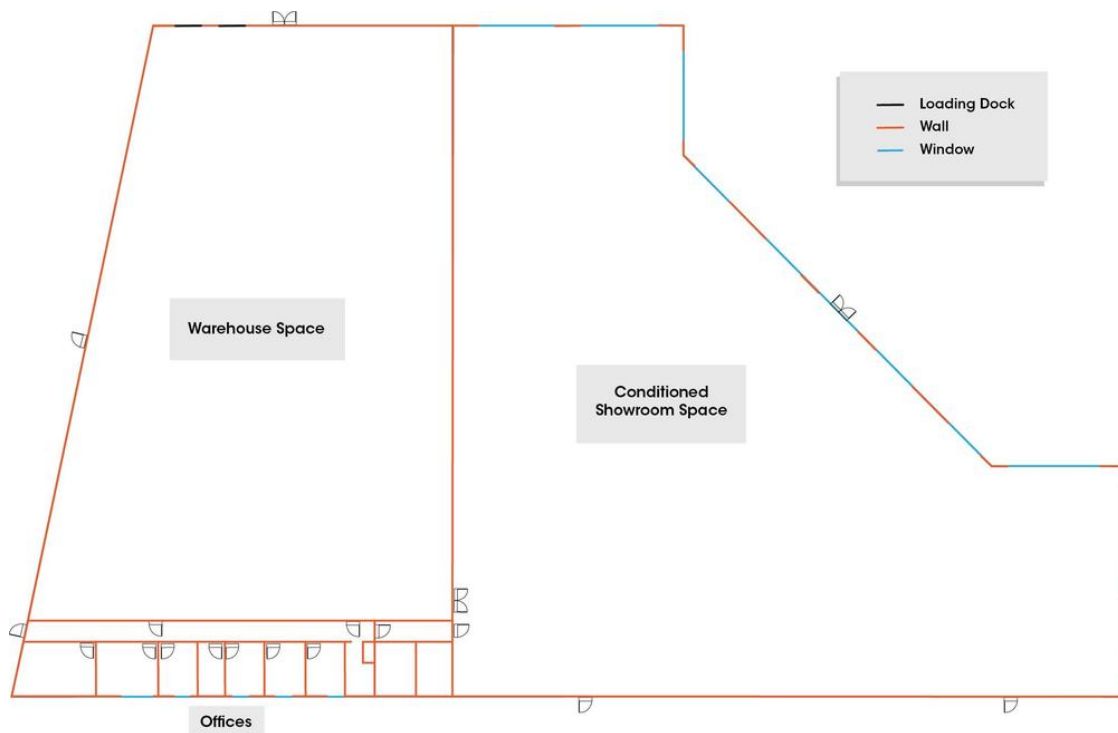

Kevin VandenBrink
503.972.7289
kevinv@macadamforbes.com
Licensed in OR

Clayton Madey
503.972.7277
clayton@macadamforbes.com
Licensed in OR

All of the information contained herein was obtained either from the owner or other parties we consider reliable. We have no reason to doubt its accuracy, however we do not guarantee it.

MACADAMFORBES.COM | 503.227.2500

2100 N Hayden Island Dr , Portland, OR 97217

FOR SALE

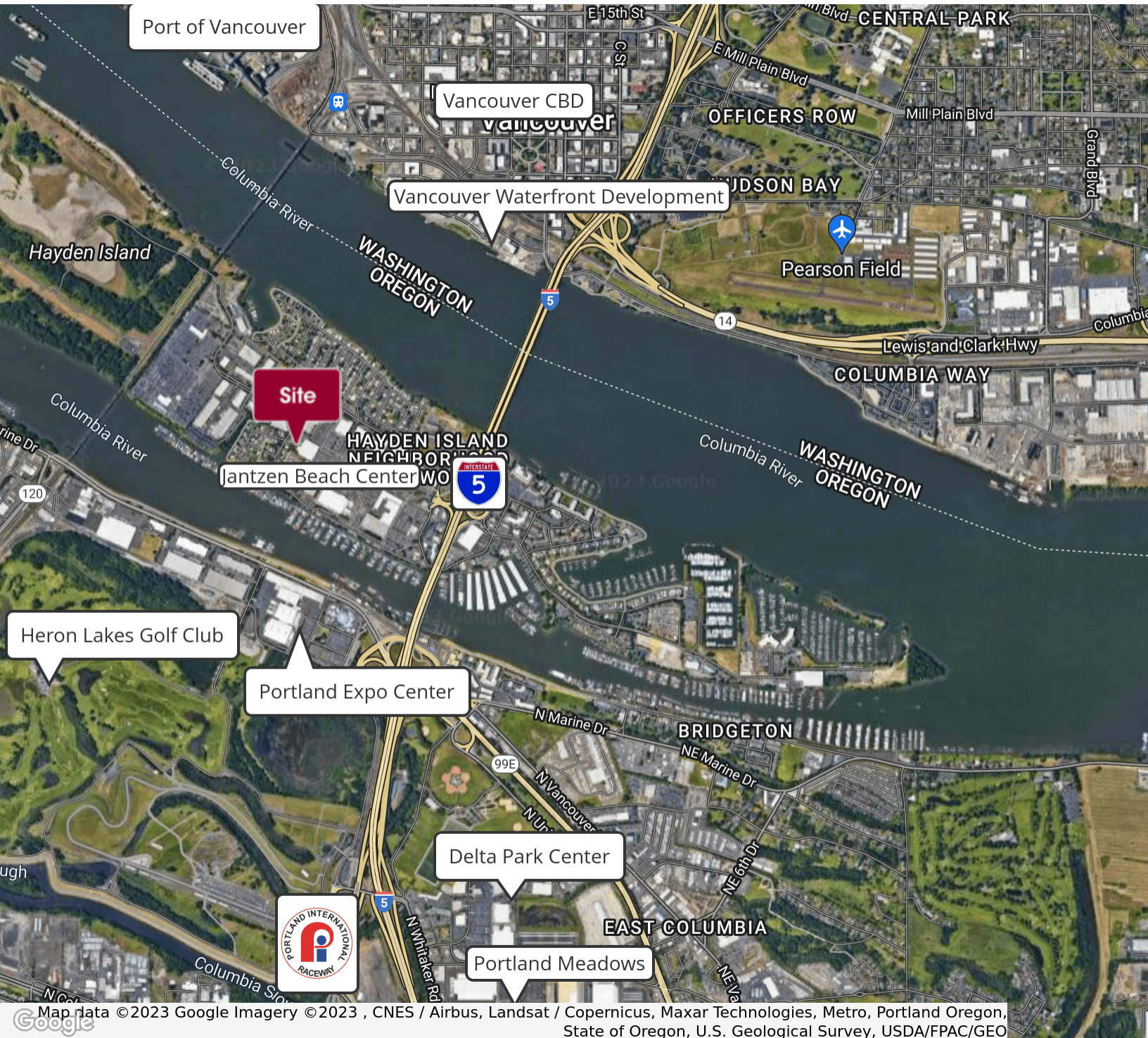

Map data ©2023 Google Imagery ©2023 , CNES / Airbus, Landsat / Copernicus, Maxar Technologies, Metro, Portland Oregon, State of Oregon, U.S. Geological Survey, USDA/FPAC/GEO



Kevin VandenBrink
503.972.7289
kevinv@macadamforbes.com
Licensed in OR

Clayton Madey
503.972.7277
clayton@macadamforbes.com
Licensed in OR

All of the information contained herein was obtained either from the owner or other parties we consider reliable. We have no reason to doubt its accuracy, however we do not guarantee it.

MACADAMFORBES.COM | 503.227.2500

FOR SALE

2100 N Hayden Island Dr , Portland, OR 97217

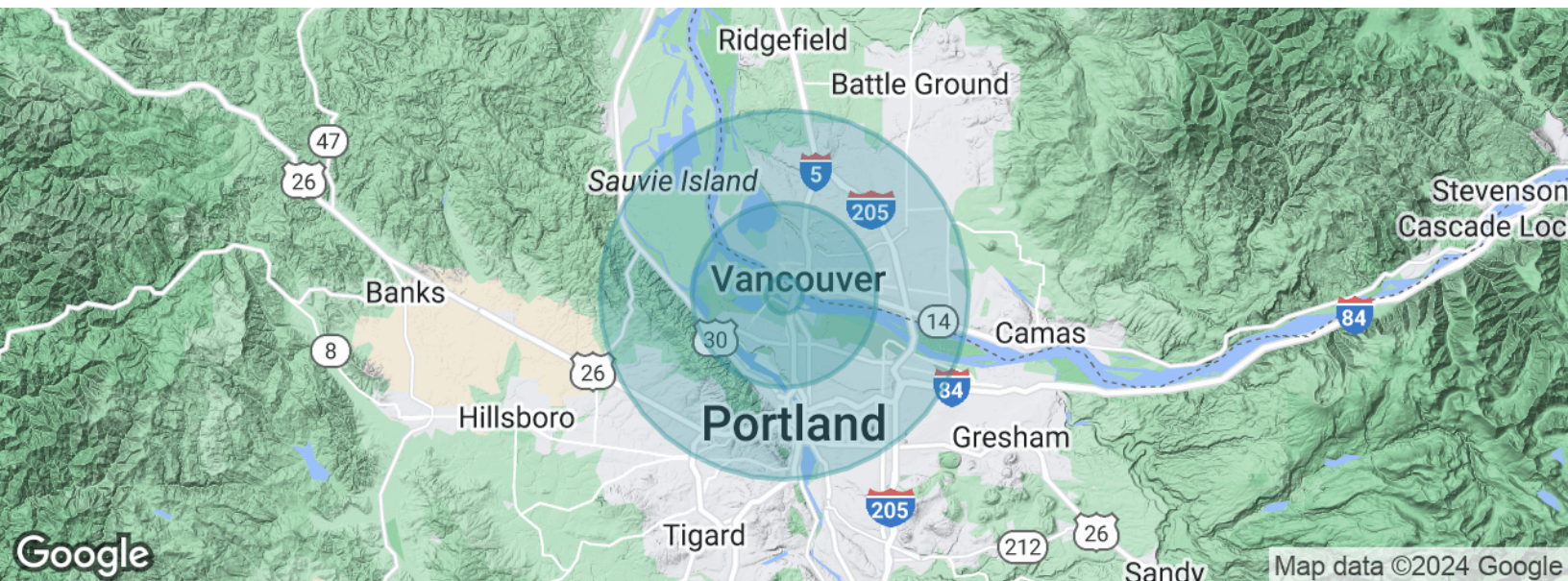

| POPULATION | 1 MILE | 5 MILES | 10 MILES |
|---------------------|-----------|-----------|-----------|
| Total population | 1,989 | 183,725 | 782,803 |
| Median age | 47.0 | 34.9 | 36.8 |
| Median age (Male) | 46.6 | 34.2 | 36.3 |
| Median age (Female) | 50.4 | 35.8 | 37.5 |
| HOUSEHOLDS & INCOME | 1 MILE | 5 MILES | 10 MILES |
| Total households | 961 | 76,578 | 342,633 |
| # of persons per HH | 2.1 | 2.4 | 2.3 |
| Average HH income | \$55,941 | \$57,758 | \$71,957 |
| Average house value | \$248,160 | \$276,312 | \$370,115 |

* Demographic data derived from 2020 ACS - US Census



Kevin VandenBrink
503.972.7289
kevinv@macadamforbes.com
Licensed in OR

Clayton Madey
503.972.7277
clayton@macadamforbes.com
Licensed in OR

All of the information contained herein was obtained either from the owner or other parties we consider reliable. We have no reason to doubt its accuracy, however we do not guarantee it.

MACADAMFORBES.COM | 503.227.2500