

3785 Bayshore Blvd.  
Brisbane, CA 94005  
**±35,141 SF Yard For Lease**

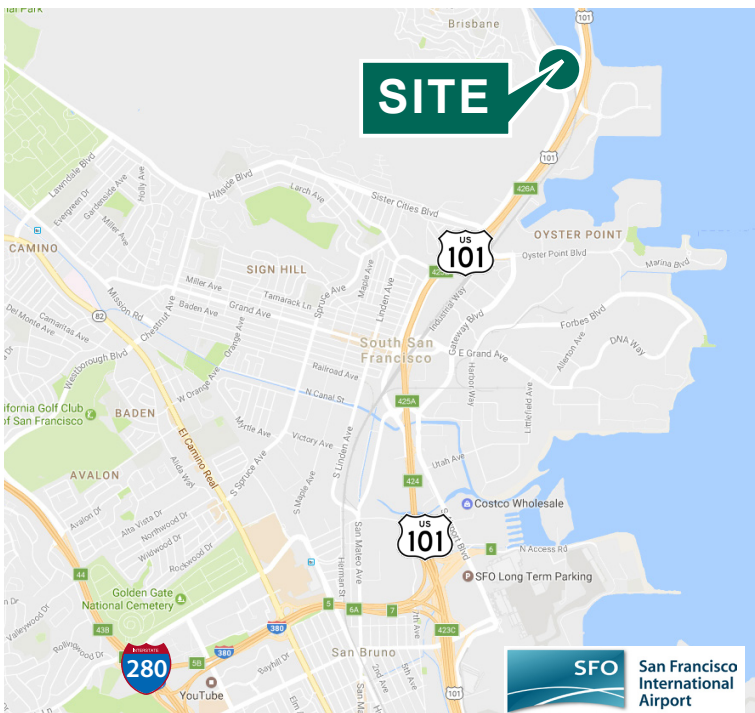

### Location

- Excellent access to Highway 101
- Close to San Francisco and SFO
- Bus stop adjacent to property
  - [SamTrans bus schedule link](#)
  - [Caltrain shuttle schedule link](#)

### Facility

- Usable size: ±35,141 SF
- Landlord will deliver paved, fenced, and lighted
- Available now

**Avison Young**  
Randy Keller  
Principal, Managing Director  
+ 1 650 425 6425 (Direct)  
randy.keller@avisonyoung.com  
LIC #00841897

**Prologis**  
Christina Jackson  
Vice President, Leasing Officer  
+ 1 415 733 9934 (Direct)  
cjackson@prologis.com

**Prologis**  
Ali Harandi  
Investment Director, Capital Deployment  
+ 1 415 733 9525 (Direct)  
aharandi@prologis.com

3785 Bayshore Blvd.  
Brisbane, CA 94005  
**±35,141 SF Yard For Lease**



**Option A: Automotive Parking  
±99 Stalls**

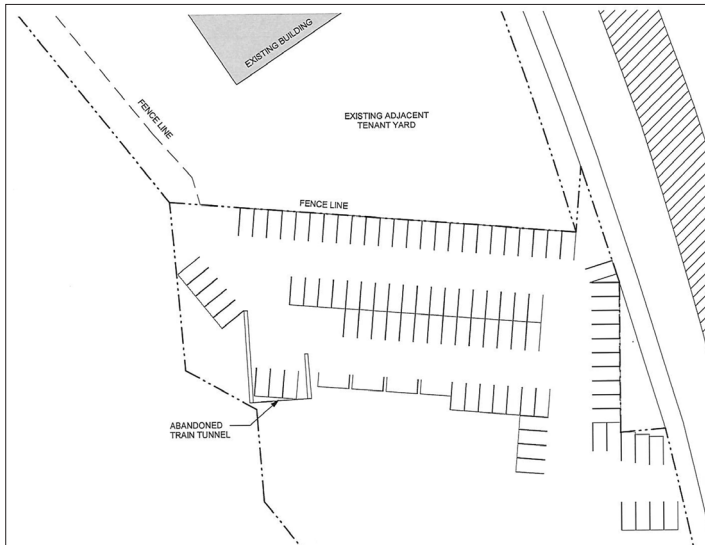

**Option B: Trailer Storage  
±26 Trailer Spots**

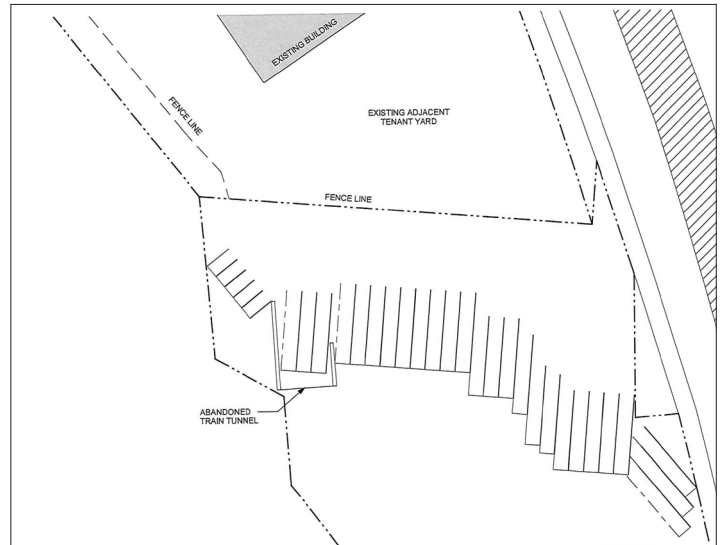

**Option C: Automobile Storage  
±186 Stacked Stalls**

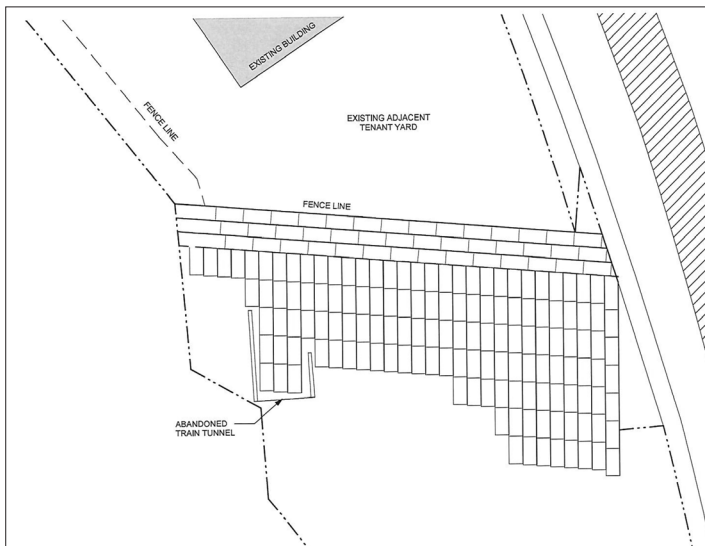

**Avison Young**  
Randy Keller  
Principal, Managing Director  
+ 1 650 425 6425 (Direct)  
randy.keller@avisonyoung.com  
LIC #00841897

**Prologis**  
Christina Jackson  
Vice President, Leasing Officer  
+ 1 415 733 9934 (Direct)  
cjackson@prologis.com

**Prologis**  
Ali Harandi  
Investment Director, Capital Deployment  
+ 1 415 733 9525 (Direct)  
aharandi@prologis.com