

OFFICE FOR SALE

11300 CAPITAL BLVD, WAKE FOREST

11300 Capital Blvd, Wake Forest, NC 27587

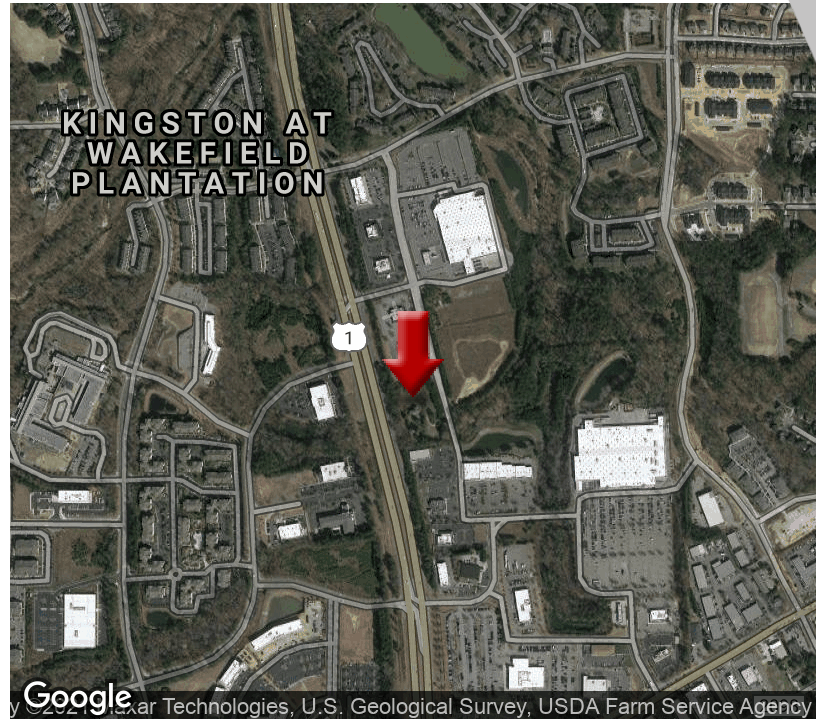

OFFERING SUMMARY

SALE PRICE:	\$450,000
AVAILABLE SF:	
LOT SIZE:	2.77 Acres
BUILDING SIZE:	2,373 SF
ZONING:	HB
PRICE / SF:	\$189.63

PROPERTY OVERVIEW

Historic 1814 building on 2.77 acres of land AVAILABLE NOW! Property is on the National Register of Historic Places. Zoning is HB. Future additions and alterations an option! Truly artistic character and charm - heart of pine floors, thick detailed molding throughout the home, storm windows, impressive foyer, NUMEROUS fireplaces, detailed flooring in bathrooms - feel like you're stepping back in time all while feet off of Capital Blvd. Historic Preservation Easement automatically conveys with deed transfer.

PROPERTY HIGHLIGHTS

- On 2.77 acres
- On National Register of Historic Places
- Zoning - HB
- Can be used as residential or commercial property
- Located in retail corridor right off Capital Blvd.
- Current residential tenant on month to month lease

KW COMMERCIAL - KELLER WILLIAMS PREFERRED REALTY
919.471.8000
7751 Brier Creek Parkway, STE 100
Raleigh, NC 27617

PETER KIMA
Director
O: 919.609.6777
peter@kimacommercial.com
NC #247276

MEHDI HILMI
Associate
O: 919.389.7945
mehdi@kimacommercial.com



We obtained the information above from sources we believe to be reliable. However, we have not verified its accuracy and make no guarantee, warranty or representation about it. It is submitted subject to the possibility of errors, omissions, change of price, rental or other conditions, prior sale, lease or financing, or withdrawal without notice. We include projections, opinions, assumptions or estimates for example only, and they may not represent current or future performance of the property. You and your tax and legal advisors should conduct your own investigation of the property and transaction.

Each Office Independently Owned and Operated kwcommercial.com

OFFICE FOR SALE

11300 CAPITAL BLVD, WAKE FOREST

11300 Capital Blvd, Wake Forest, NC 27587



KW COMMERCIAL - KELLER WILLIAMS PREFERRED REALTY
919.471.8000
7751 Brier Creek Parkway, STE 100
Raleigh, NC 27617

PETER KIMA
Director
O: 919.609.6777
peter@kimacommercial.com
NC #247276

MEHDI HILMI
Associate
O: 919.389.7945
mehdi@kimacommercial.com



We obtained the information above from sources we believe to be reliable. However, we have not verified its accuracy and make no guarantee, warranty or representation about it. It is submitted subject to the possibility of errors, omissions, change of price, rental or other conditions, prior sale, lease or financing, or withdrawal without notice. We include projections, opinions, assumptions or estimates for example only, and they may not represent current or future performance of the property. You and your tax and legal advisors should conduct your own investigation of the property and transaction.

Each Office Independently Owned and Operated kwcommercial.com

OFFICE FOR SALE

11300 CAPITAL BLVD, WAKE FOREST

11300 Capital Blvd, Wake Forest, NC 27587



KW COMMERCIAL - KELLER WILLIAMS PREFERRED REALTY
919.471.8000
7751 Brier Creek Parkway, STE 100
Raleigh, NC 27617

PETER KIMA
Director
O: 919.609.6777
peter@kimacommercial.com
NC #247276

MEHDI HILMI
Associate
O: 919.389.7945
mehdi@kimacommercial.com



We obtained the information above from sources we believe to be reliable. However, we have not verified its accuracy and make no guarantee, warranty or representation about it. It is submitted subject to the possibility of errors, omissions, change of price, rental or other conditions, prior sale, lease or financing, or withdrawal without notice. We include projections, opinions, assumptions or estimates for example only, and they may not represent current or future performance of the property. You and your tax and legal advisors should conduct your own investigation of the property and transaction.

Each Office Independently Owned and Operated kwcommercial.com

OFFICE FOR SALE

11300 CAPITAL BLVD, WAKE FOREST

11300 Capital Blvd, Wake Forest, NC 27587



KW COMMERCIAL - KELLER WILLIAMS PREFERRED REALTY
919.471.8000
7751 Brier Creek Parkway, STE 100
Raleigh, NC 27617

PETER KIMA
Director
O: 919.609.6777
peter@kimacommercial.com
NC #247276

MEHDI HILMI
Associate
O: 919.389.7945
mehdi@kimacommercial.com



We obtained the information above from sources we believe to be reliable. However, we have not verified its accuracy and make no guarantee, warranty or representation about it. It is submitted subject to the possibility of errors, omissions, change of price, rental or other conditions, prior sale, lease or financing, or withdrawal without notice. We include projections, opinions, assumptions or estimates for example only, and they may not represent current or future performance of the property. You and your tax and legal advisors should conduct your own investigation of the property and transaction.

Each Office Independently Owned and Operated kwcommercial.com

OFFICE FOR SALE

11300 CAPITAL BLVD, WAKE FOREST

11300 Capital Blvd, Wake Forest, NC 27587

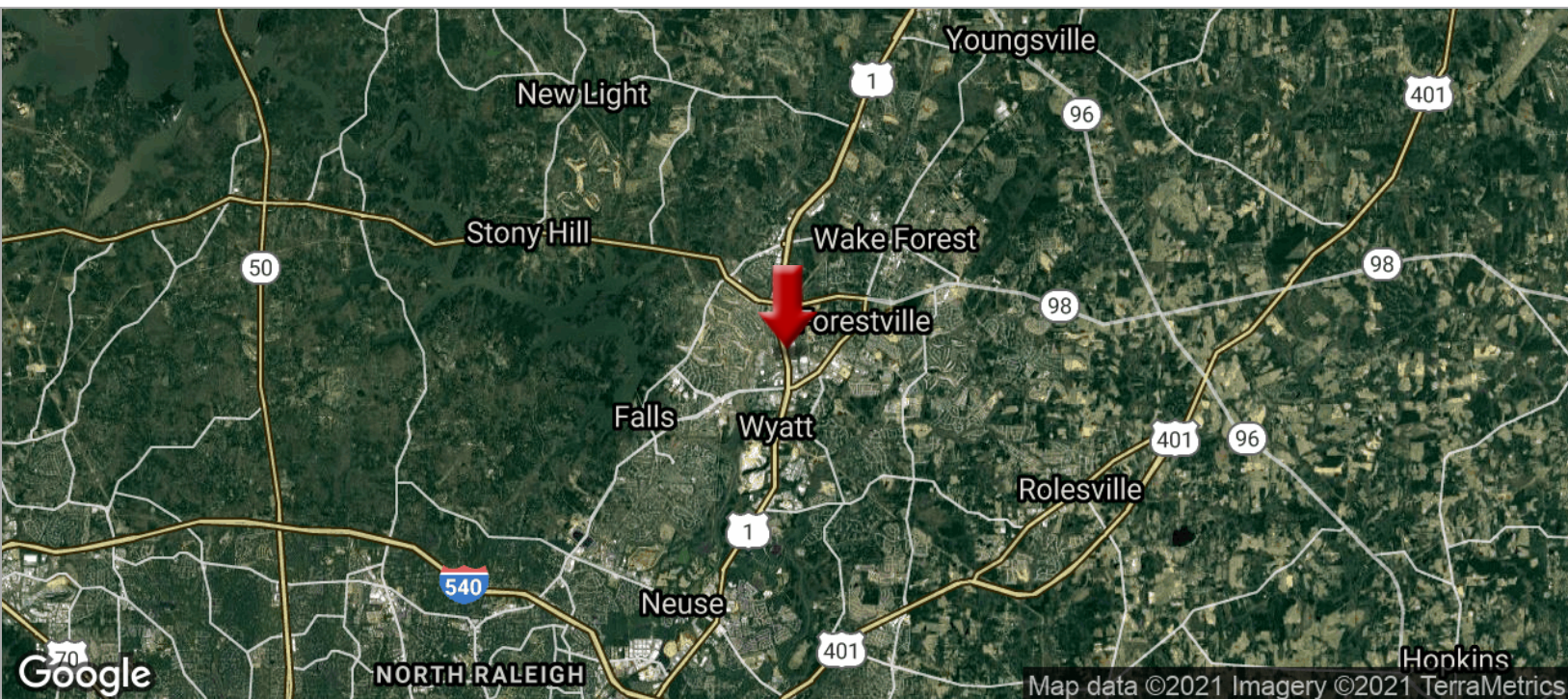

KW COMMERCIAL - KELLER WILLIAMS PREFERRED REALTY
919.471.8000
7751 Brier Creek Parkway, STE 100
Raleigh, NC 27617

PETER KIMA
Director
O: 919.609.6777
peter@kimacommercial.com
NC #247276

MEHDI HILMI
Associate
O: 919.389.7945
mehdi@kimacommercial.com



We obtained the information above from sources we believe to be reliable. However, we have not verified its accuracy and make no guarantee, warranty or representation about it. It is submitted subject to the possibility of errors, omissions, change of price, rental or other conditions, prior sale, lease or financing, or withdrawal without notice. We include projections, opinions, assumptions or estimates for example only, and they may not represent current or future performance of the property. You and your tax and legal advisors should conduct your own investigation of the property and transaction.

Each Office Independently Owned and Operated kwcommercial.com

OFFICE FOR SALE

11300 CAPITAL BLVD, WAKE FOREST

11300 Capital Blvd, Wake Forest, NC 27587

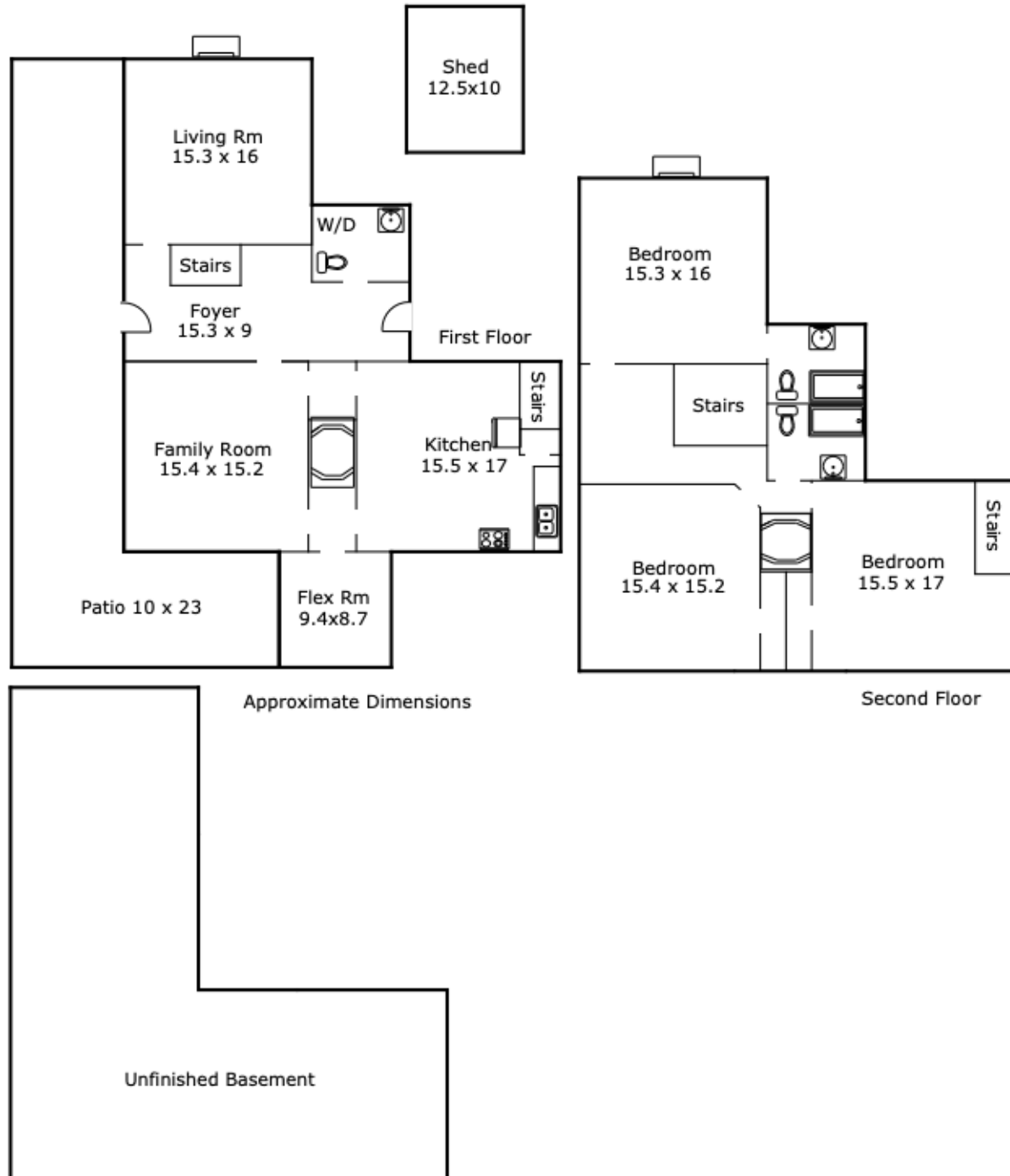

KW COMMERCIAL - KELLER WILLIAMS PREFERRED REALTY
919.471.8000
7751 Brier Creek Parkway, STE 100
Raleigh, NC 27617

PETER KIMA
Director
O: 919.609.6777
peter@kimacommercial.com
NC #247276

MEHDI HILMI
Associate
O: 919.389.7945
mehdi@kimacommercial.com



We obtained the information above from sources we believe to be reliable. However, we have not verified its accuracy and make no guarantee, warranty or representation about it. It is submitted subject to the possibility of errors, omissions, change of price, rental or other conditions, prior sale, lease or financing, or withdrawal without notice. We include projections, opinions, assumptions or estimates for example only, and they may not represent current or future performance of the property. You and your tax and legal advisors should conduct your own investigation of the property and transaction.

Each Office Independently Owned and Operated kwcommercial.com

OFFICE FOR SALE

11300 CAPITAL BLVD, WAKE FOREST

11300 Capital Blvd, Wake Forest, NC 27587

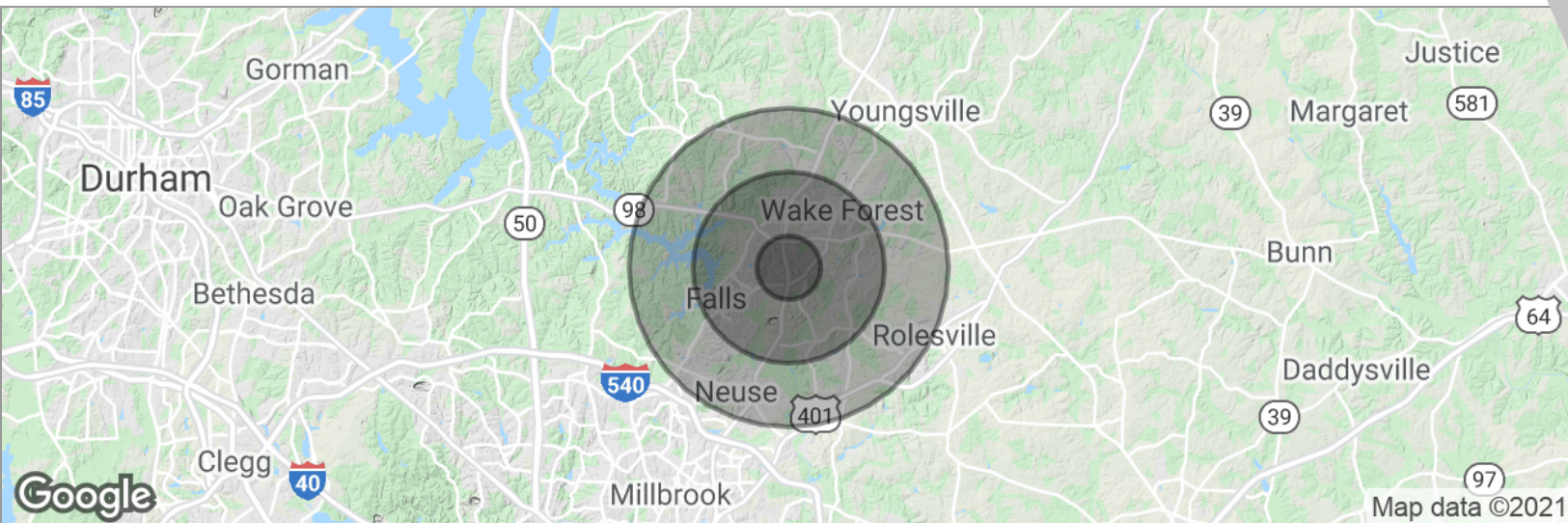

POPULATION	1 MILE	3 MILES	5 MILES
Total population	4,993	33,218	80,934
Median age	34.3	34.6	34.7
Median age (male)	30.8	31.9	32.8
Median age (Female)	35.2	35.5	35.5

HOUSEHOLDS & INCOME	1 MILE	3 MILES	5 MILES
Total households	1,791	12,053	29,456
# of persons per HH	2.8	2.8	2.7
Average HH income	\$98,717	\$96,039	\$93,248
Average house value		\$343,950	\$304,458

* Demographic data derived from 2010 US Census

KW COMMERCIAL - KELLER WILLIAMS PREFERRED REALTY
919.471.8000
7751 Brier Creek Parkway, STE 100
Raleigh, NC 27617

PETER KIMA
Director
O: 919.609.6777
peter@kimacommercial.com
NC #247276

MEHDI HILMI
Associate
O: 919.389.7945
mehdi@kimacommercial.com



We obtained the information above from sources we believe to be reliable. However, we have not verified its accuracy and make no guarantee, warranty or representation about it. It is submitted subject to the possibility of errors, omissions, change of price, rental or other conditions, prior sale, lease or financing, or withdrawal without notice. We include projections, opinions, assumptions or estimates for example only, and they may not represent current or future performance of the property. You and your tax and legal advisors should conduct your own investigation of the property and transaction.

Each Office Independently Owned and Operated kwcommercial.com

OFFICE FOR SALE

11300 CAPITAL BLVD, WAKE FOREST

11300 Capital Blvd, Wake Forest, NC 27587

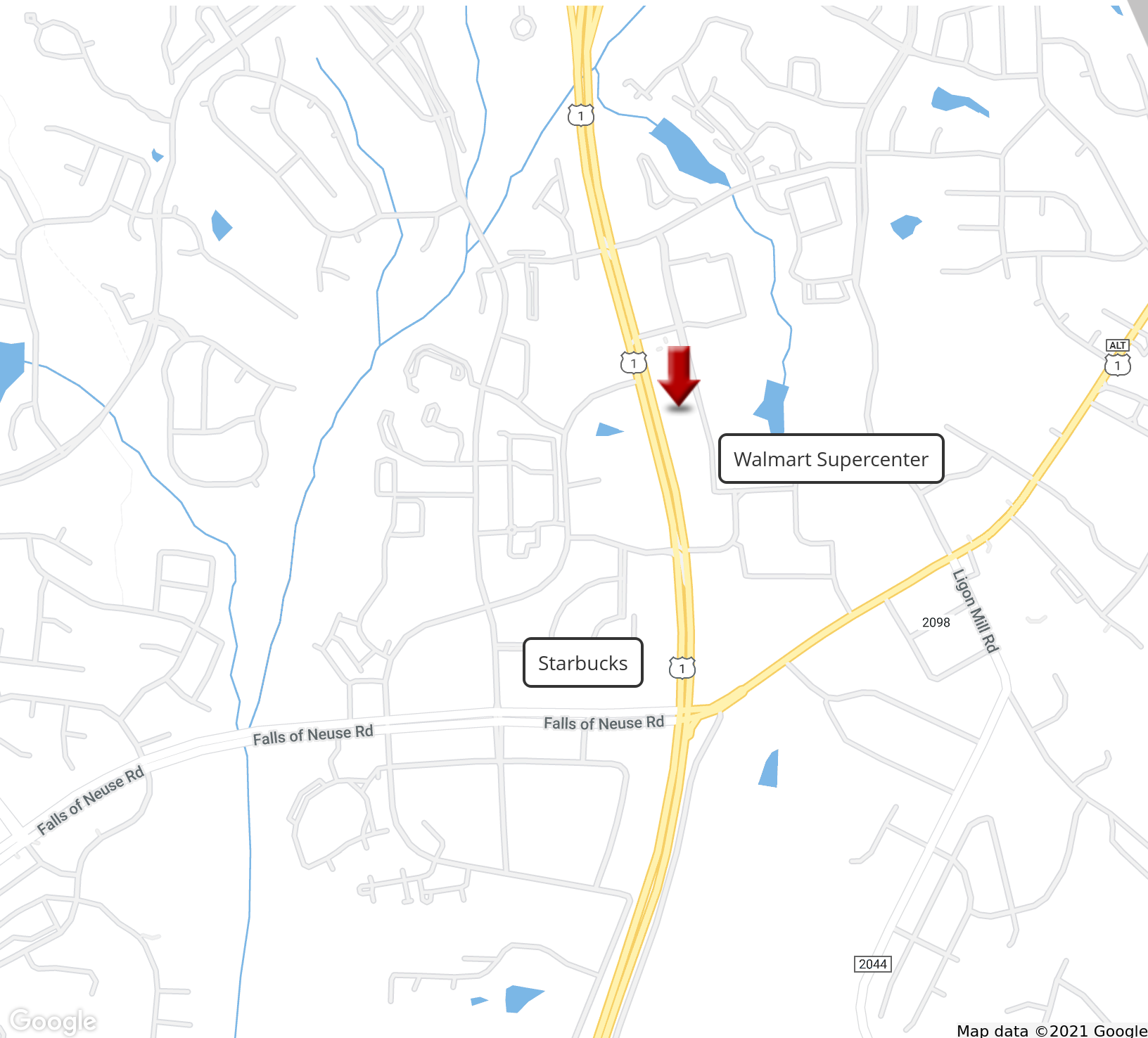

KW COMMERCIAL - KELLER WILLIAMS PREFERRED REALTY
919.471.8000
7751 Brier Creek Parkway, STE 100
Raleigh, NC 27617

PETER KIMA
Director
O: 919.609.6777
peter@kimacommercial.com
NC #247276

MEHDI HILMI
Associate
O: 919.389.7945
mehdi@kimacommercial.com



We obtained the information above from sources we believe to be reliable. However, we have not verified its accuracy and make no guarantee, warranty or representation about it. It is submitted subject to the possibility of errors, omissions, change of price, rental or other conditions, prior sale, lease or financing, or withdrawal without notice. We include projections, opinions, assumptions or estimates for example only, and they may not represent current or future performance of the property. You and your tax and legal advisors should conduct your own investigation of the property and transaction.

Each Office Independently Owned and Operated kwcommercial.com