

OFFICE FOR LEASE

1101 E FRONT AVE | BISMARCK, ND



LEASED



OFFERING SUMMARY

Lease Rate:	Negotiable
Building Size:	7,500 SF
Available SF:	
Zoning:	MA

PROPERTY OVERVIEW

Large unique office building with exposed industrial ceiling and wood beams. This space has a large reception area with an open center area for workstations or cubicles as well as a large conference room with a projection screen and kitchenette connected. Tenant pays building utilities. 1101 East Front Avenue has a Walk Score of 69 out of 100. This location is somewhat walkable so some errands can be accomplished on foot.

PROPERTY HIGHLIGHTS

- (13) Private Offices
- Second Conference Room / Executive Office
- Workroom
- Large Break Room
- Storage and Large Utility Room
- Attached Outdoor Deck / Patio
- Walk Score of 69
- PID#: 0005-031-001



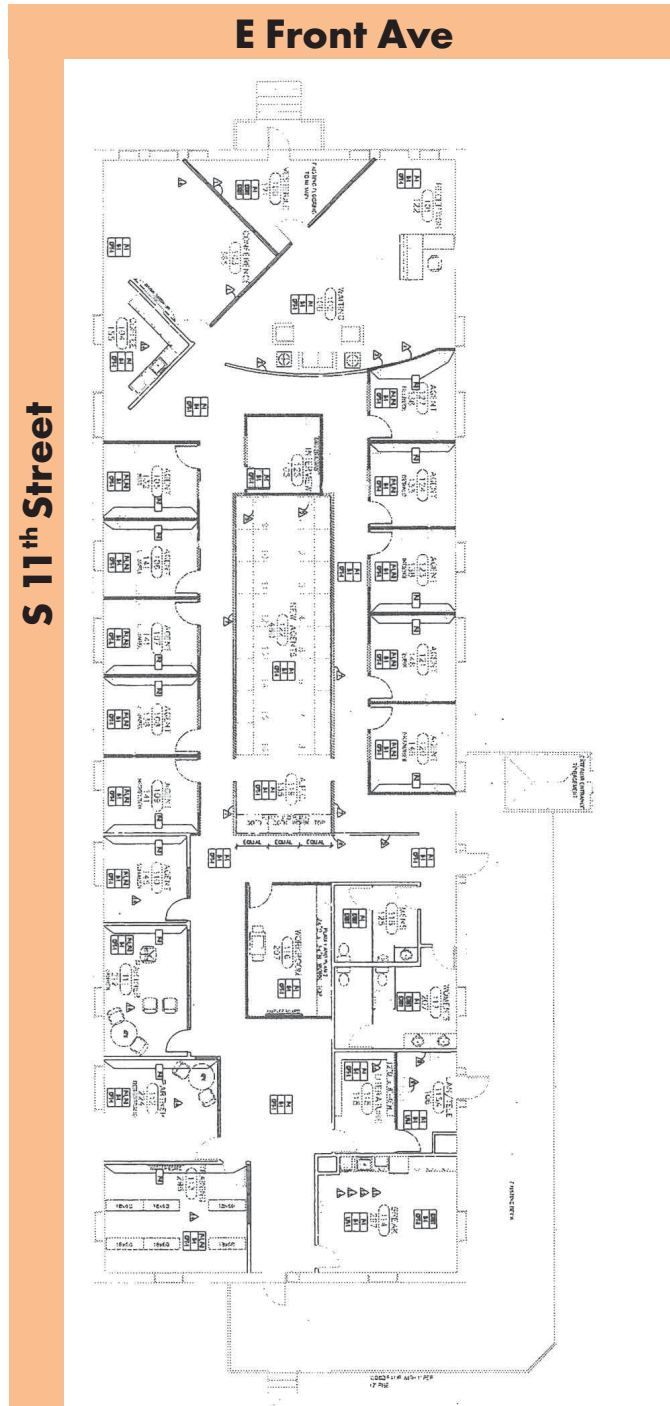

*INTENDED FOR VISUAL PURPOSE ONLY
*SOME DETAILS MAY NOT BE TO SCALE

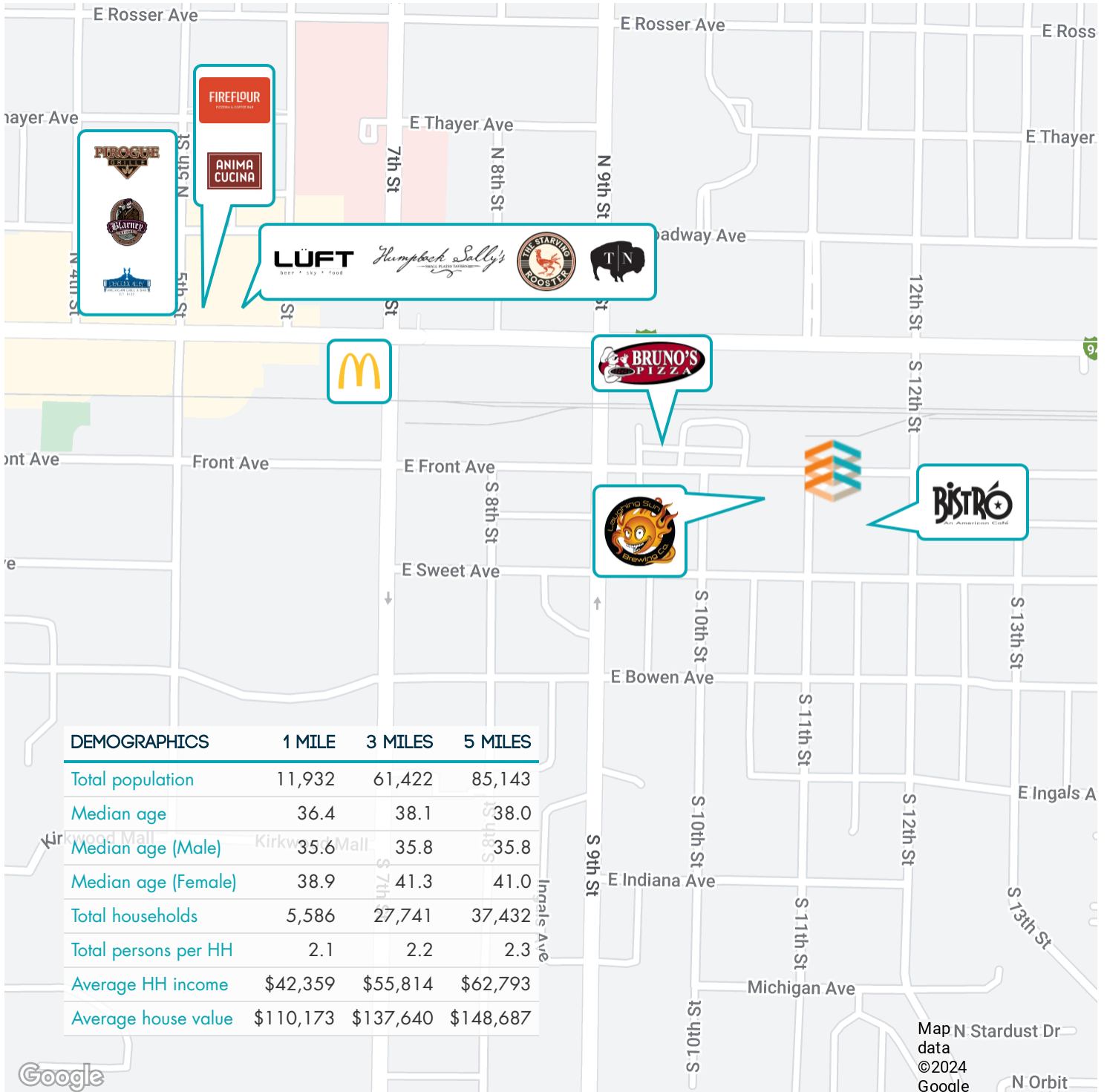

BUILDING RELATIONSHIPS. BUILDING THE COMMUNITY.™



**KYLE HOLWAGNER, CCIM,
SIOR**

Partner | Broker Associate

701.400.5373

kyle@thecragroup.com



**KRISTYN STECKLER,
COMMERCIAL REALTOR®**

Partner | Broker

701.527.0138

kristyn@thecragroup.com

STAY IN TOUCH



@THECRAGROUP



@THECRAGROUP



THE CRA GROUP

THECRAGROUP.com

THE CRA GROUP | 216 N 2ND ST | BISMARCK, ND 58501

Although information has been obtained from sources deemed reliable, neither Owner nor CRA makes any guarantees, warranties, or representations, express or implied, as to the completeness or accuracy as to the information contained herein. You should conduct a careful, independent investigation of the property and verify all information. Any reliance on this information is solely at your own risk. The Property may be withdrawn without notice. Neither Owner nor CRA accepts any liability for any loss or damage suffered by any party resulting from reliance on this information. Photos, logos, and other images herein are the property of their respective owners. Use of these images without the express written consent of the owner is prohibited.