

STORAGE & MANUFACTURING WAREHOUSE IN NW PORTLAND

2141 NW 25th Avenue | Portland, Oregon



FOR LEASE

FOR MORE INFORMATION, CONTACT:



Mark Hush
503.972.5517
mhush@ngkf.com

Greg Burpee
503.972.7282
burpee@macadamforbes.com



1800 SW First Avenue, Suite 650 | Portland OR 97201 | WWW.MACADAMFORBES.COM | 503.227.2500

All of the information contained herein was obtained either from the owner or other parties we consider reliable. We have no reason to doubt its accuracy, however we do not guarantee it.

2141 NW 25th Avenue

PROPERTY INFORMATION



BUILDING SIZE

30,550 SF

LOT SIZE

approx. 1 Acre

ZONING

IH, Heavy Industrial

LOADING

Multiple Grade Doors

CLEAR HEIGHT

12 - 20'

CONSTRUCTION

Wood Frame

POWER

To be verified

LEASE RATE

\$18,000 / month NNN

Flexible term



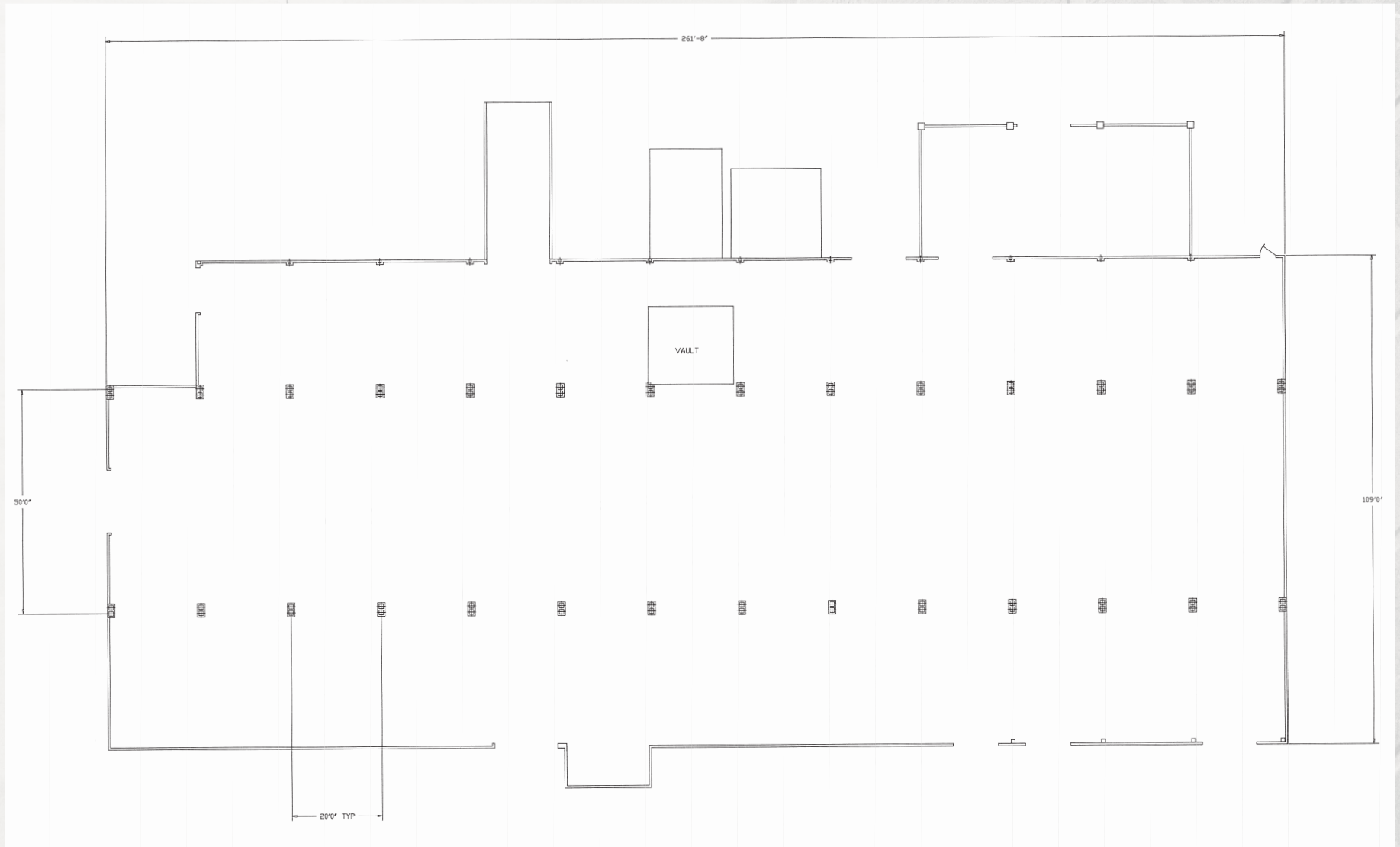





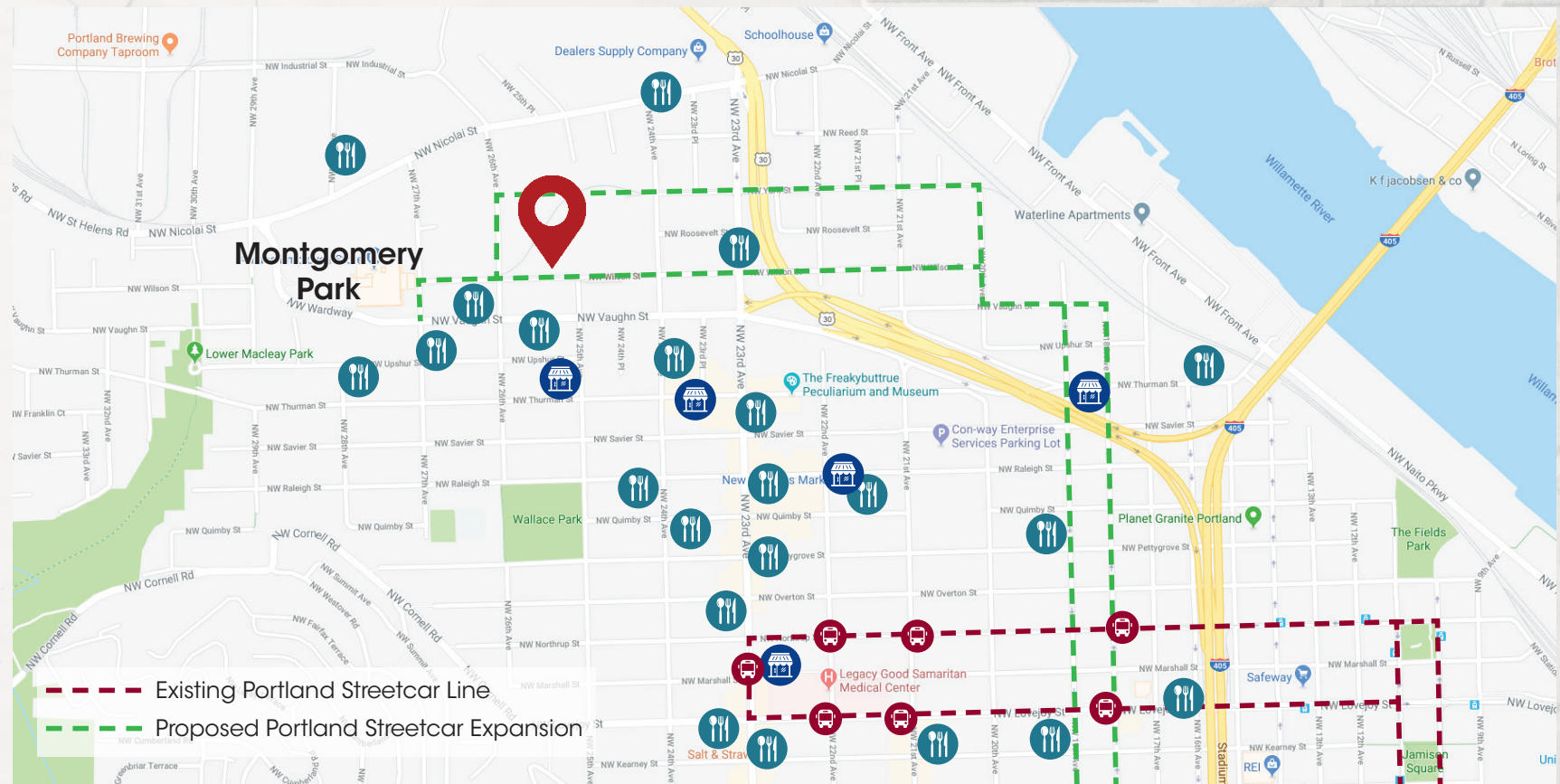

Located in the burgeoning NW Portland, this property is close to restaurants, retail shopping, breweries and more. Centrally located, it is in walking distance to neighborhoods such as NW 23rd, Slabtown, the Pearl District and Downtown. It is conveniently situated close to I-405 and Highway 30 with freeway visibility, and is serviced by public transit including TriMet buses. Nearby neighbors include tenants at Montgomery Park.

