



RETAIL REDEVELOPMENT SITE

937 S. SALISBURY BLVD
SALISBURY, MD 21801

Henry Hanna, CCIM, SIOR
Council Chair of Industrial Properties
O: 410.543.2420
henry.hanna@svn.com

Wesley Cox, CCIM
Senior Advisor
O: 410.543.2421
wesley.cox@svn.com

To College Avenue

Property Summary



OFFERING SUMMARY

Sale Price:	\$675,000
Lot Size:	0.76 Acres
Year Built:	1989
Building Size:	8,163 SF
Zoning:	General Commercial
Market:	Eastern Shore of Maryland
Submarket:	Salisbury
Price / SF:	\$82.69

PROPERTY OVERVIEW

Prime retail redevelopment site on S. Salisbury Blvd [US Route 13] with drive-thru. 25,000 cars per day pass this location. Only 1/4 mile to Salisbury University home to over 8,500 undergrads and over 1,900 post-graduates and 1 mile to Peninsula Regional Medical Center, a 5 Star Rated hospital seeing over 500,000 patients each year.

PROPERTY HIGHLIGHTS

- 0.76 Acre site - Current building footprint is 8,163 sq.ft.
- Direct access on US Rt. 13 - S. Salisbury Blvd.
- ADT over 25,000 cars per day
- Zoned General Commercial
- Rear access to College Avenue from Tower Drive

 **PENINSULA
REGIONAL**
MEDICAL CENTER

To College Avenue







Retail Map

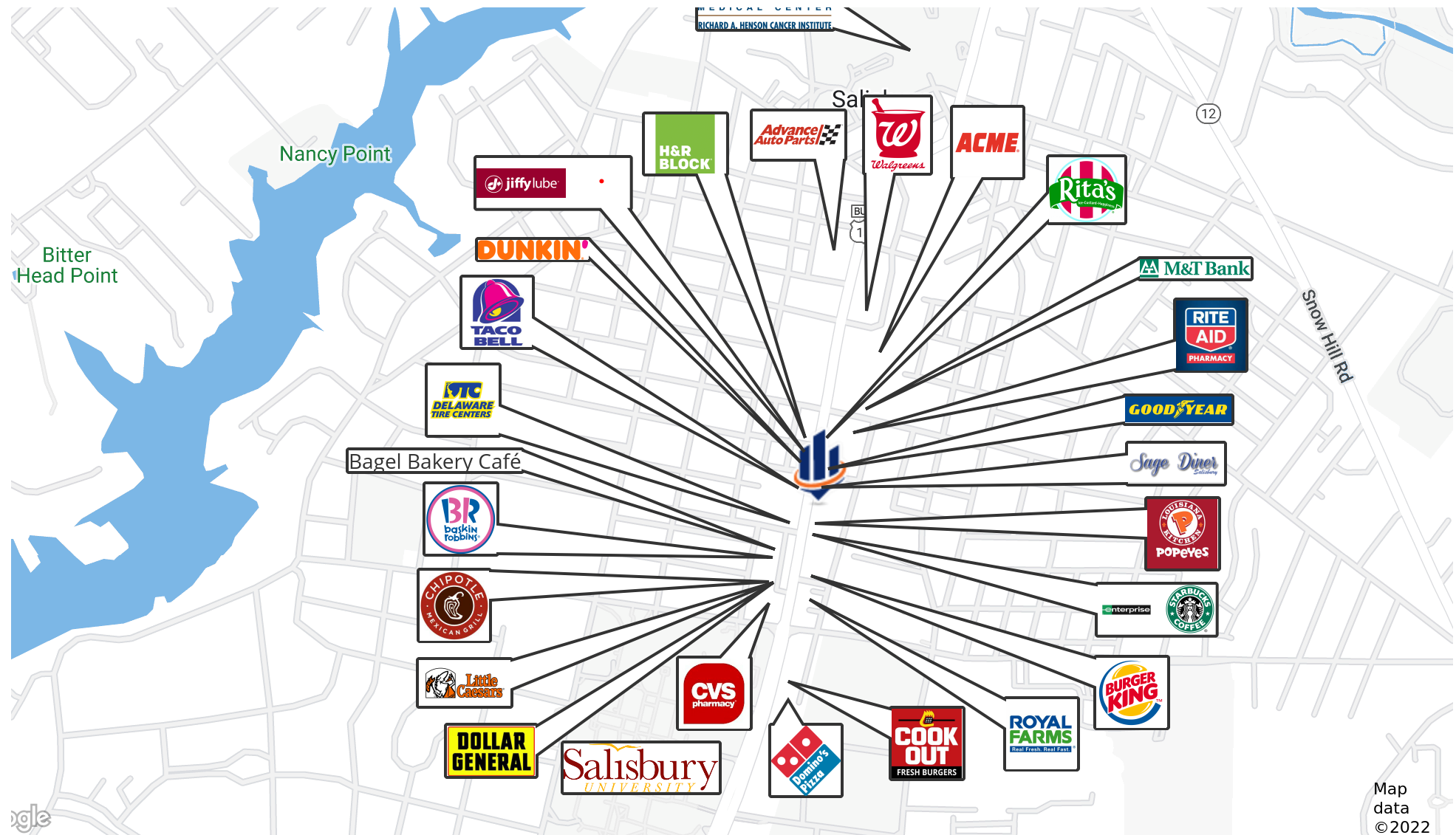

Additional Photos



2 Drive-thru Windows

Additional Photos

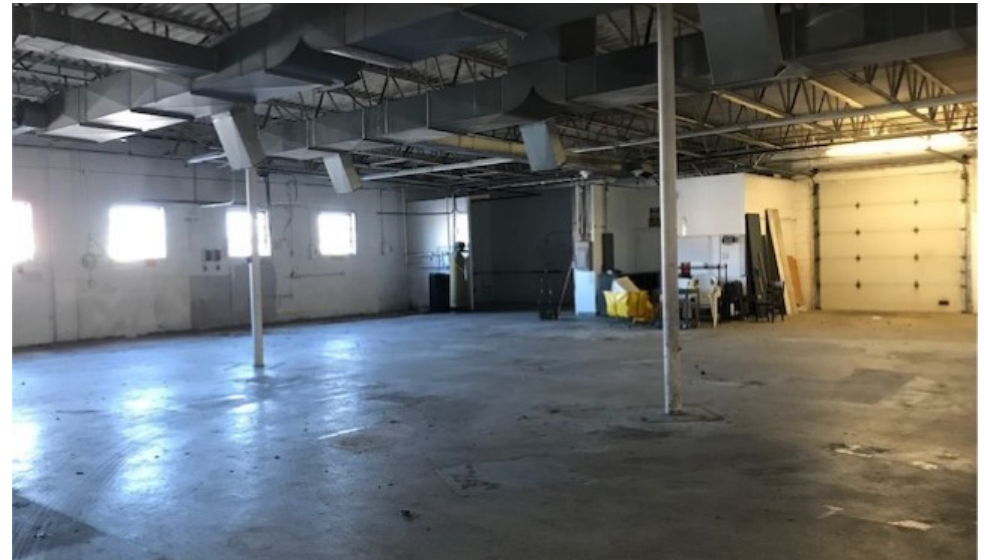

Floor Plan

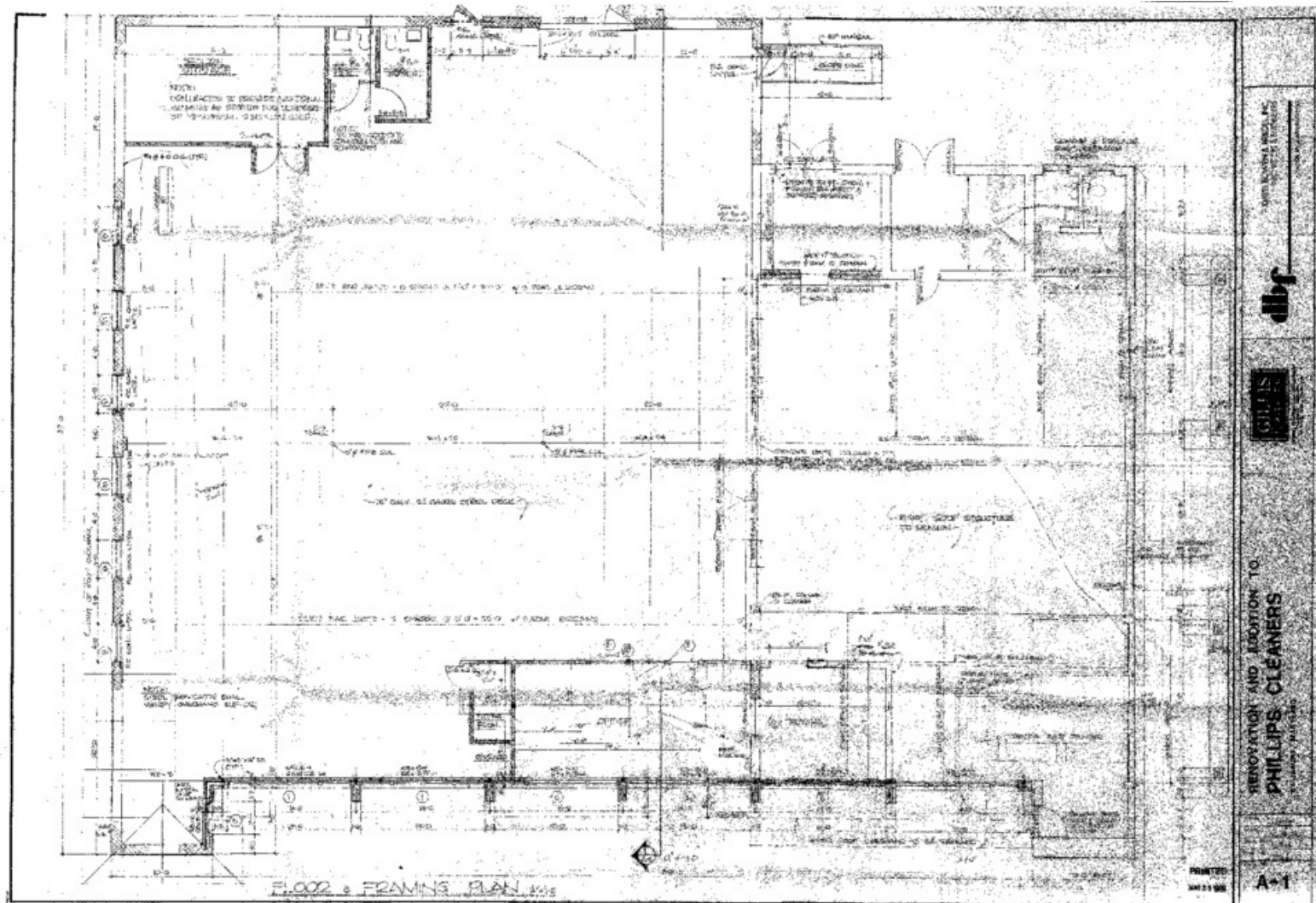



Site Plan

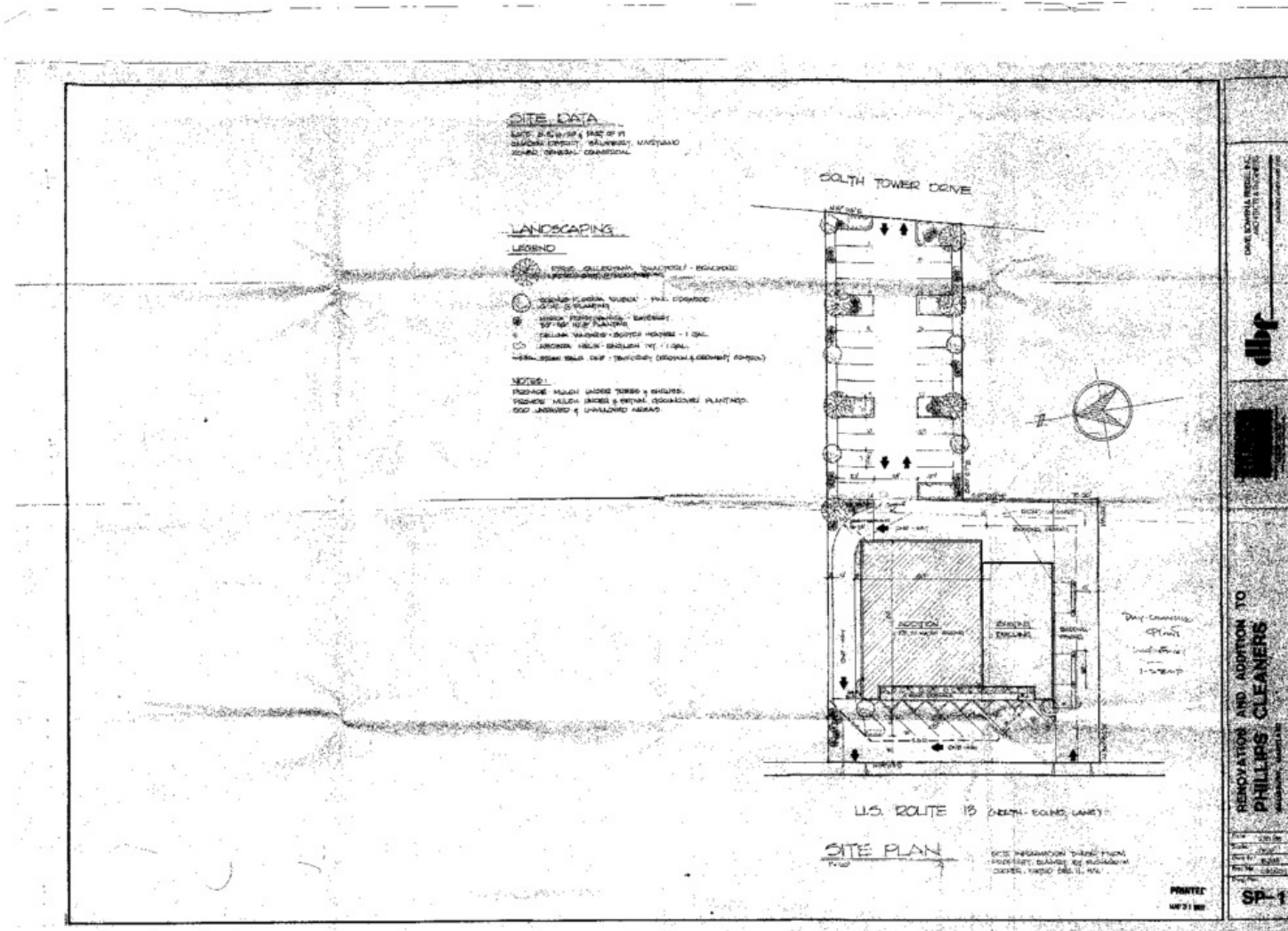

Chapter 17.36 - GENERAL COMMERCIAL DISTRICT

17.36.010 - Purpose.

The purpose of the general commercial district is to provide a wide range of functional and attractive regional retail, office, service, wholesale, storage, distributing and light manufacturing activities.

To alleviate problems with traffic congestion and unnecessary turning movements, unified access and consolidation of businesses are encouraged. Because of the potential impact of these types of activities, special landscaping and screening requirements are established for certain use.

The following uses, standards and area regulations have been established consistent with this purpose.

(Ord. 1599 § 1 (part), 1995: prior code § 150-65)

17.36.020 - Permitted uses.

A. Permitted uses shall be as follows:

1. Apartment units, in accordance with Chapter 17.168;
2. Bank;
3. Bakery;
4. Boardinghouse/rooming house;
5. Business center in accordance with the requirements of Chapter 17.172, provided that each individual lot shall have a minimum of six thousand (6,000) square feet of land area;
6. Carpenter, sheet metal, sign, blacksmith and welding shop, provided that all activities are confined within a building;
7. Church and other place of worship;
8. Club, lodge and fraternal organization;
9. Cultivation of land;
10. Cultural uses, such as museum, library or art gallery;
11. Dry-cleaning plant;
12. Eating and drinking establishments, including tavern, dance hall, nightclub and restaurants, all types;
13. Firehouse;
14. Equipment sales, rental, service, repair or maintenance facility for industrial, automotive, marine, office, construction, household, business or farm equipment;
15. Greenhouse, florist and nursery;
16. Hotel, motel or motor hotel;
17. Laboratory and establishment for production, sale, fitting or repair of eyeglasses, hearing aids and prosthetic appliances;
18. Light industrial uses, as listed in the light industrial district, completely confined within a building

with no outside storage of raw materials or finished products;

19. Lumber and building supplies;
20. Marina;
21. Medical-care facility;
22. Medical and dental office and clinic;
23. Police station or substation;
24. Parking garage, public or private;
25. Mixed use building as defined in Section 17.04.120 in this chapter in accordance with a comprehensive site plan, as approved by the planning commission, with a mandatory five-foot-wide landscaping area abutting all property lines and parking lots. Signage shall be the same as required for a shopping center;
26. Neighborhood shopping center not exceeding thirty thousand (30,000) gross square feet of building area in accordance with the requirements of Chapter 17.212;
27. Office or office building for more than one office;
28. Radio or television broadcasting station or studio;
29. Retail sales;
30. School of special instruction;
31. Service, rental or repair establishment, such as laundry or laundromat, automobile rental, gasoline and service station, car wash, appliance repair, equipment or instrument repair or rental, dry-cleaning pickup station, hairdresser shop, pet-grooming shop, excluding outdoor runs, upholstery shop, funeral home, tailor and other uses of similar nature;
32. Taxi and limousine service;
33. Theater, excluding drive-in theater;
34. Wholesale business, warehouse, moving, storage and distribution establishment, including wholesale sales;
35. Group domiciliary care facility.

(Ord. 1786 § 6, 2000; Ord. 1599 § 1 (part), 1995; prior code § 150-66)

17.36.030 - Uses permitted by special exception.

Uses permitted by special exception shall be as follows:

- A. Animal hospital or kennel or any other facility for the treatment of animals with outside pens or runs;
- B. Bus terminal;
- C. Shopping centers, neighborhood, over thirty thousand (30,000) gross square feet of floor area, commercial and regional shopping centers in accordance with Chapter 17.212;
- D. Trucking and freight stations, terminals, and storage yards, excluding the above ground storage of flammable liquids, except for servicing vehicles owned or used in the conduct of the business;
- E. Recreational establishment, indoor;

F. Day care facilities for the elderly and handicapped.

(Ord. 1690 § 2, 1998; Ord. 1599 § 1 (part), 1995; prior code § 150-67)

17.36.040 - Uses permitted by ordinance permit.

Uses permitted by ordinance permit shall be as follows:

- A. Commercial auction;
- B. Communication tower, over seventy-five (75) feet in height or any other electronic communications facilities with more than one tower or more than one sending or receiving disk in accordance with Chapter 17.220;
- C. Liquor stores and dispensaries (off-sale);
- D. Public or private utility building and uses;
- E. Recreational establishment, outdoor;
- F. Utility substation, in accordance with Chapter 17.220;
- G. Compact concrete dispenser as an accessory use to a use listed in Section 17.36.020, permitted uses, and/or Section 17.36.030, uses permitted by special exception.

(Ord. 1599 § 1 (part), 1995; prior code § 150-68)

17.36.045 - Prohibited uses.

Adult entertainment businesses, as defined in this title, shall be prohibited.

(Ord. 2048 § 2, 2008)

17.36.050 - Accessory uses and structures.

Accessory uses and structures shall be as follows:

- A. Off-street parking lot or structure;
- B. Off-street loading and unloading facilities;
- C. Underground storage of flammable liquids for vehicles used in the conduct of the business of the principal use;
- D. Communication towers for broadcasting and receiving, not exceeding seventy-five (75) feet in height;
- E. Other accessory uses and structures clearly incidental to, customary to and associated with the permitted use;
- F. Day-care services for employees or patrons of a permitted use.

(Prior code § 150-69)

17.36.060 - Development standards.

Development standards for the general commercial district shall be as follows:

- A. Minimum Lot Requirements. All lots hereafter established shall meet the following minimum requirements:
 - 1. Lot area: ten thousand (10,000) square feet;
 - 2. Interior lot width: eighty (80) feet;
 - 3. Corner lot width: one hundred (100) feet.
- B. Minimum yard and setback requirements shall be as follows:
 - 1. Front: twenty-five (25) feet;
 - 2. Rear: fifteen (15) feet;
 - 3. Side: two, not less than twenty (20) feet total in any combination.
- C. The height limitation shall be fifty (50) feet.
- D. Parking, loading and unloading areas shall be provided for all uses in accordance with Chapter 17.196.
- E. Access. Direct access onto a street or major highway shall be reduced or eliminated wherever the city department of infrastructure and development determines that alternate or unified points of access are available to a site resulting in better traffic flow and less traffic congestion. Service drives and loading and unloading areas shall be located so that in the process of loading or unloading no truck will block the passage of other vehicles on the service drive or extend into any public street or private drive used for traffic circulation.
- F. Lighting. Lighting shall be designed so as not to throw glare onto surrounding properties. Flashing lights are prohibited.
- G. Signs. Signs shall be in accordance with Chapter 17.216.
- H. Storage. All necessary outside storage of parts, materials, heavy equipment and inoperable vehicles accessory to uses permitted herein shall be in accordance with Chapter 17.220. Open, unenclosed storage of parts, materials, heavy equipment and inoperable vehicles is prohibited.
- I. Landscaping and Screening.
 - 1. Either landscaping or screening shall be provided for all uses in accordance with the provisions of Chapter 17.220;
 - 2. In addition to the requirements of Chapter 17.220, all areas devoted to building or required parking areas shall be landscaped as defined in Section 17.220.080, provided that a landscaped area of at least three feet shall be required abutting all property lines where a zero setback is not provided.

(Ord. 1599 § 1 (part), 1995; prior code § 150-70)

(Ord. No. 2459, 10-9-2017.)

Demographics Map

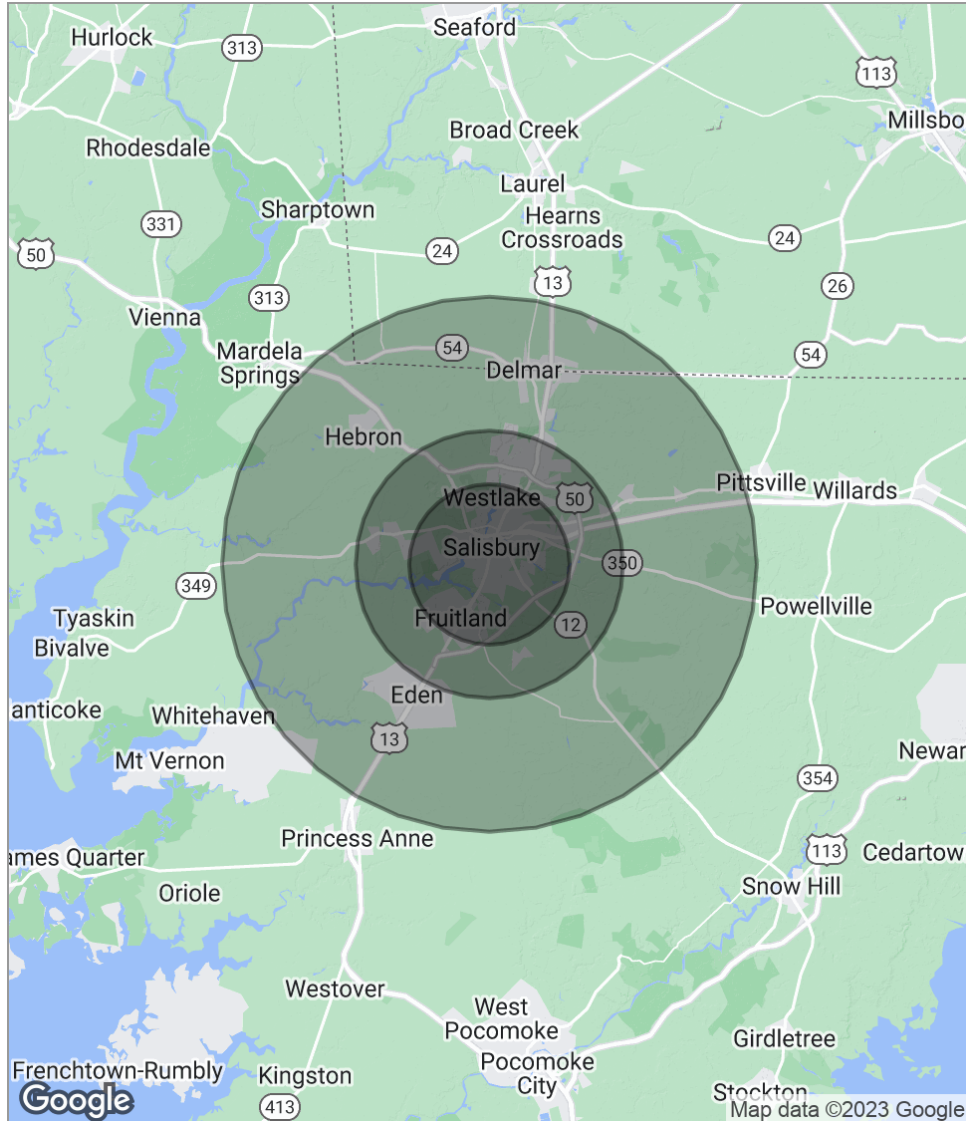

POPULATION	3 MILES	5 MILES	10 MILES
Total population	48,284	76,935	110,788
Median age	31.6	33.3	34.3
Median age [Male]	30.7	31.9	32.8
Median age [Female]	31.9	34.2	35.3
HOUSEHOLDS & INCOME	3 MILES	5 MILES	10 MILES
Total households	17,833	28,690	40,810
# of persons per HH	2.7	2.7	2.7
Average HH income	\$56,642	\$62,840	\$63,926
Average house value	\$196,630	\$212,374	\$214,394

* Demographic data derived from 2020 ACS - US Census

Disclaimer

The material contained in this Offering Brochure is furnished solely for the purpose of considering the purchase of the property within and is not to be used for any other purpose. This information should not, under any circumstances, be photocopied or disclosed to any third party without the written consent of the SVN® Advisor or Property Owner, or used for any purpose whatsoever other than to evaluate the possible purchase of the Property.

The only party authorized to represent the Owner in connection with the sale of the Property is the SVN Advisor listed in this proposal, and no other person is authorized by the Owner to provide any information or to make any representations other than contained in this Offering Brochure. If the person receiving these materials does not choose to pursue a purchase of the Property, this Offering Brochure must be returned to the SVN Advisor.

Neither the SVN Advisor nor the Owner make any representation or warranty, express or implied, as to the accuracy or completeness of the information contained herein, and nothing contained herein is or shall be relied upon as a promise or representation as to the future representation of the Property. This Offering Brochure may include certain statements and estimates with respect to the Property. These Assumptions may or may not be proven to be correct, and there can be no assurance that such estimates will be achieved. Further, the SVN Advisor and the Owner disclaim any and all liability for representations or warranties, expressed or implied, contained in or omitted from this Offering Brochure, or any other written or oral communication transmitted or made available to the recipient. The recipient shall be entitled to rely solely on those representations and warranties that may be made to it in any final, fully executed and delivered Real Estate Purchase Agreement between it and Owner.

The information contained herein is subject to change without notice and the recipient of these materials shall not look to Owner or the SVN Advisor nor any of their officers, employees, representatives, independent contractors or affiliates, for the accuracy or completeness thereof. Recipients of this Offering Brochure are advised and encouraged to conduct their own comprehensive review and analysis of the Property.

This Offering Brochure is a solicitation of interest only and is not an offer to sell the Property. The Owner expressly reserves the right, at its sole discretion, to reject any or all expressions of interest to purchase the Property and expressly reserves the right, at its sole discretion, to terminate negotiations with any entity, for any reason, at any time with or without notice. The Owner shall have no legal commitment or obligation to any entity reviewing the Offering Brochure or making an offer to purchase the Property unless and until the Owner executes and delivers a signed Real Estate Purchase Agreement on terms acceptable to Owner, in Owner's sole discretion. By submitting an offer, a prospective purchaser will be deemed to have acknowledged the foregoing and agreed to release the Owner and the SVN Advisor from any liability with respect thereto.

To the extent Owner or any agent of Owner corresponds with any prospective purchaser, any prospective purchaser should not rely on any such correspondence or statements as binding Owner. Only a fully executed Real Estate Purchase Agreement shall bind the property and each prospective purchaser proceeds at its own risk.