

ATLANTA MSA RETAIL DEVELOPMENT SITE | 0.57 ACRES

5432 BUFORD HWY NE DORAVILLE, GA 30340

FOR SALE

DEMOGRAPHICS & TRAFFIC COUNTS

	1 Mile	3 Miles	5 Miles
Total Households:	3,061	38,236	108,710
Total Population:	10,584	99,226	279,247
Average HH Income:	\$64,048	\$83,518	\$108,003
Traffic Counts:	48,000 - VPD on Buford Hwy		

*Data derived from ESRI

PARCEL DIMENSIONS



IN THE AREA

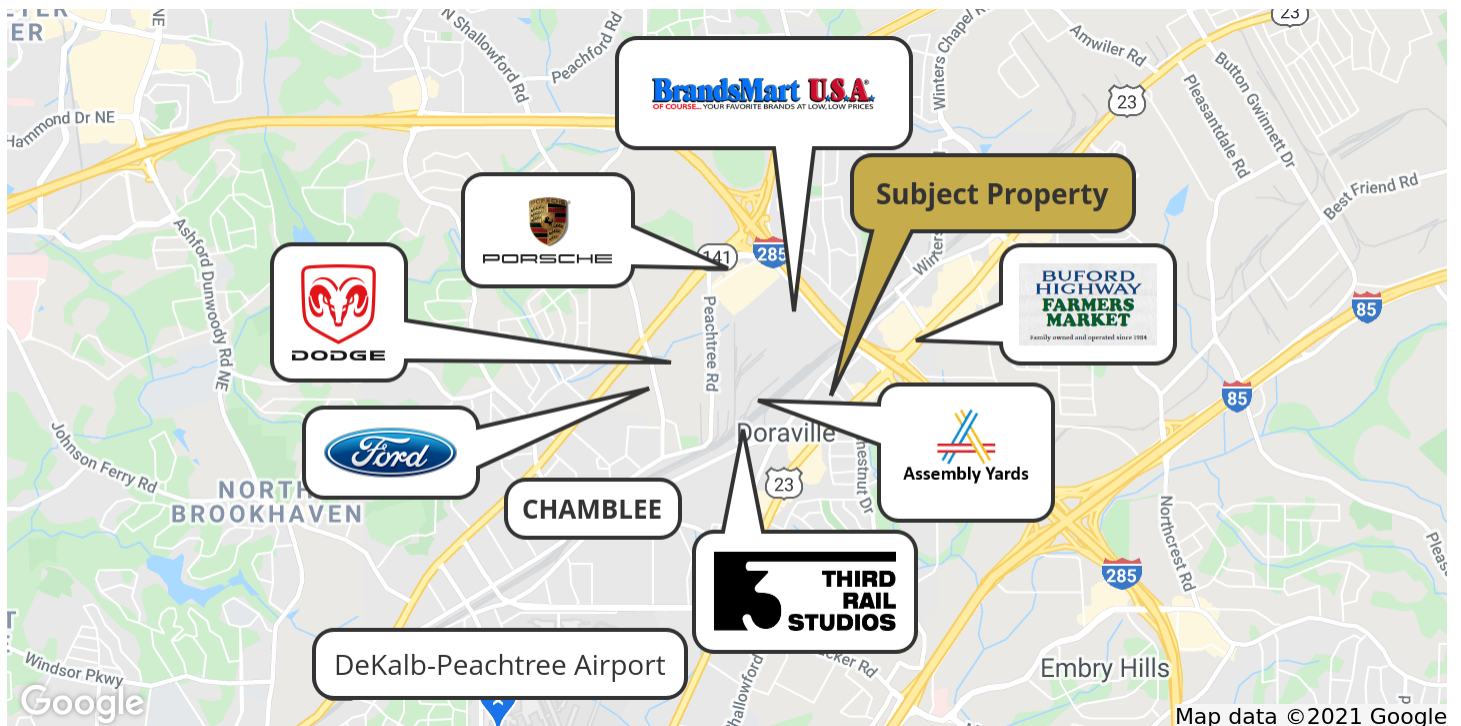

Map data ©2021 Google

ATLANTA MSA RETAIL DEVELOPMENT SITE | 0.57 ACRES

5432 BUFORD HWY NE DORAVILLE, GA 30340

FOR SALE



Subject Property within 1 mile of I-285.

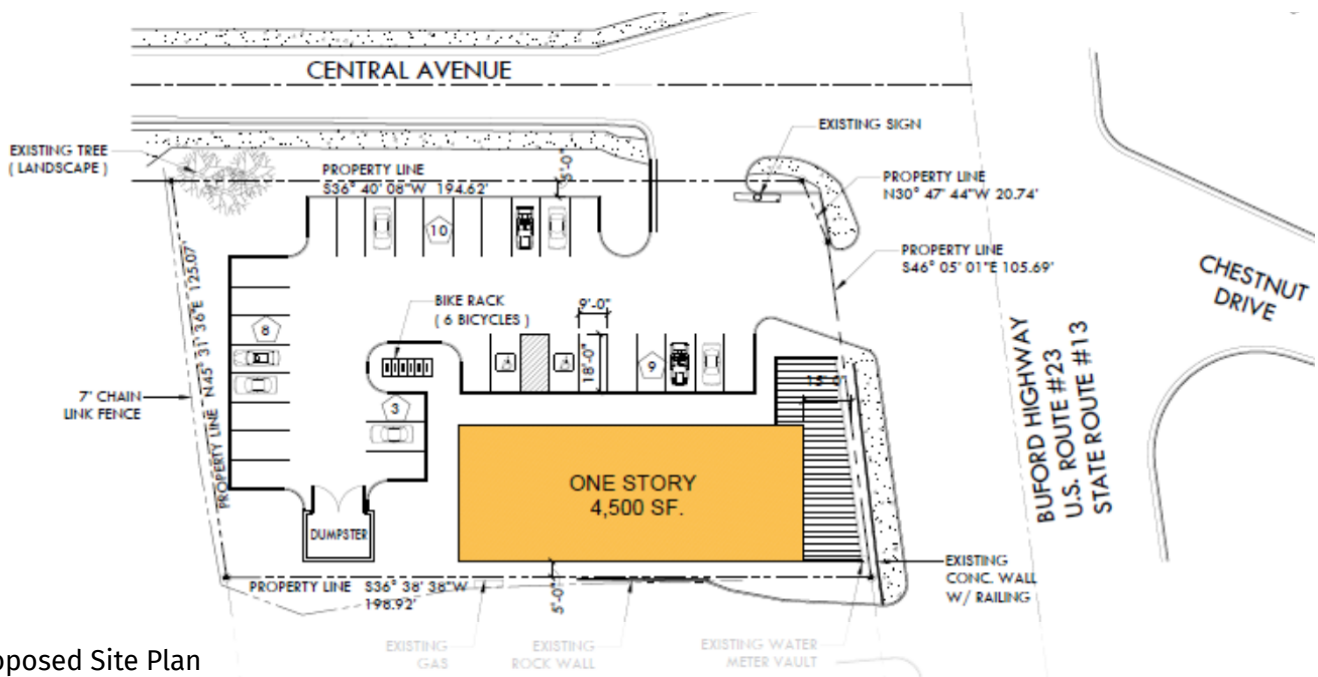

Proposed Site Plan