

LOCUS MAP
1"=300'

Plymouth County Registry of Deeds
PLAN BOOK **63** PAGE **1084**

2019 00000556
Bk: 63 Pg: 1084 Page: 1 of 1
Recorded: 12/06/2019 10:21 AM
ATTEST: John R. Buckley, Jr., Register
Plymouth County Registry of Deeds

PLYMOUTH CO. REG. OF DEEDS
DEC 06 2019
12-6-19
RECORDED

19-556

FOR REGISTRY USE ONLY

MCKENZIE
ENGINEERING GROUP
Assinippi Office Park
150 Longwater Drive, Suite 101
Norwell, MA 02061
P: 781.792.3900
F: 781.792.0333
www.mckeng.com

I HEREBY CERTIFY TO THE BEST OF MY PROFESSIONAL KNOWLEDGE, INFORMATION AND BELIEF, THAT THIS PLAN CONFORMS TO THE RULES AND REGULATIONS OF THE REGISTERS OF DEEDS OF THE COMMONWEALTH OF MASSACHUSETTS.

I HEREBY CERTIFY THAT THE PROPERTY LINES SHOWN HEREON ARE THE LINES DIVIDING EXISTING OWNERSHIPS, AND THE LINES OF STREETS AND WAYS SHOWN ARE THOSE OF PUBLIC OR PRIVATE STREETS OR WAYS ALREADY ESTABLISHED, AND THAT NO NEW LINES FOR DIVISION OF EXISTING OWNERSHIP OR FOR NEW WAYS ARE SHOWN.

Richard J. Hood, PLS
RICHARD J. HOOD, PLS
30OCT19
DATE

APPROVAL NOT REQUIRED UNDER THE SUBDIVISION CONTROL LAW
DATE OF ENDORSEMENT:

Richard J. Hood
James J. Valenza
John P. Dwyer
Paul J. Smith
TOWN OF ROCKLAND PLANNING BOARD



OWNER
WL REALTY TRUST
SUSANNE D. EATON, TRUSTEE
534 WHITMAN STREET
HANSON, MA 02041
DEED BK. 49968 - PG 232

RECEIVED
NOV 01 2019
Rockland Planning Board

LEGEND	
SURVEY SYMBOLS	
•	REBAR
✓	ANGLE IRON
CB/DH □	CONCRETE BOUND WITH DRILL HOLE
SB □	STONE BOUND
SB/DH □	STONE BOUND
FND. IP •	IRON PIPE FOUND

SCALE: 1" = 20'
0 10 20 40 80

- SURVEY NOTES:**
- LOCUS IS SHOWN AS PARCEL 34-90 ON THE TOWN OF ROCKLAND ASSESSORS MAPS.
 - DEED TO LOCUS IS RECORDED IN THE PLYMOUTH COUNTY REGISTRY OF DEEDS AT BOOK 49968 PAGE 232.
 - THIS SURVEY WAS MADE ON THE GROUND IN SEPTEMBER OF 2019 BY MCKENZIE ENGINEERING GROUP, INC.
 - LOCUS IS ZONED RESIDENTIAL R2
MINIMUM SETBACK REQUIREMENTS:
FRONTAGE 110'
FRONT YARD 25'
SIDE YARD 15'
REAR YARD 50'
MINIMUM AREA: 32,670 SF
 - LOCUS IS SITUATED IN ZONE X AS SHOWN ON F.I.R.M. No. 25023C0093J, EFFECTIVE JULY 17, 2012.
 - LOCUS IS NOT LOCATED IN A DEP ZONE 2 OR TOWN OF ROCKLAND AQUIFER PROTECTION ZONE.
 - PLAN REFERENCES:

PB	PG
3	563
8	557
23	130
39	170

PLAN 94 OF 1956
LCP 26514A
 - THE PURPOSE OF THIS PLAN IS TO DEPICT LOT 1 (APN 34-90-0) WITH AN AREA OF 11,200 SF (0.26 AC) FROM LAND NOW OWNED BY WL REALTY TRUST, SUSANNE D. EATON, TRUSTEE.

APPROVAL NOT REQUIRED PLAN
ASSESSOR'S MAP 34, LOT 90
0 DYER STREET
ROCKLAND, MASSACHUSETTS

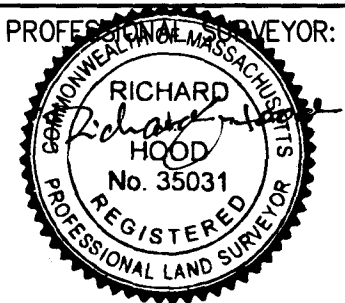

APPLICANT:
THOMAS J. HASTINGS CO., LLC
185 WHITING STREET, SUITE 2B,
HINGHAM, MASSACHUSETTS 02043

DRAWN BY: ESS
DESIGNED BY: ESS
CHECKED BY: RTLS
APPROVED BY: RJH
DATE: 30OCT2019
SCALE: 1"=20'
PROJECT NO.: 219-167
DWG. TITLE:

APPROVAL NOT REQUIRED PLAN

DWG. NO:
A-3