

4995 - 5001 Park Ave W

4995 - 5001 PARK AVE W, SEVILLE, OH 44273

FOR LEASE

Office Building



PROPERTY DESCRIPTION

Built in 1999 with renovations in 2013, this 4,032 sf office building is move in ready for a user in need of 932sf to 1,100sf. The 9,000 sf parking lot offers plenty of parking and the EXTREMELY convenient location allows for quick I-71 and I-76 access and is situated to be a short drive from Medina, Akron, Cleveland, Massillon, Wooster, Mansfield, Ashland, and even Columbus.

PROPERTY HIGHLIGHTS

- Well maintained office building - Built in 1999 with renovations in 2013
- Move in ready - 1,100sf and 932sf available
- Tenant pays utilities
- 9,000 sf parking lot offers plenty of parking
- Major highways are very accessible
- EXTREMELY convenient location allows for quick I-71 and I-76 access and is situated to be a short drive from Medina, Akron, Cleveland, Massillon, Wooster, Mansfield, Ashland, and even Columbus

OFFERING SUMMARY

Lease Rate:	\$1,000.00 - 1,150.00 per month (MG; Gross)
Number of Units Available:	2
Available SF:	932 - 1,100 SF
Lot Size:	0.81 Acres
Building Size:	4,032 SF

DEMOGRAPHICS	1 MILE	5 MILES	10 MILES
Total Households	257	6,715	45,965
Total Population	669	18,061	121,081
Average HH Income	\$68,256	\$80,531	\$76,507



THE MASICA COMPANY

www.SperryCGA.com

Valeria Long

REAL ESTATE AGENT

216.293.8900 x4

valeria.long@sperrycga.com

OH #SAL.2022003074

Steve Masica

PRINCIPAL

330.714.4415

steve.masica@sperrycga.com

OH #2013002150

Each office independently owned and operated.

We obtained the information above from sources we believe to be reliable. However, we have not verified its accuracy and make no guarantee, warranty or representation about it. It is submitted subject to the possibility of errors, omissions, change of price, rental or other conditions, prior sale, lease or financing, or withdrawal without notice. We include projections, opinions, assumptions or estimates for example only, and they may not represent current or future performance of the property. You and your tax and legal advisors should conduct your own investigation of the property and transaction.

5001 Park Ave W

5001 PARK AVE W , SEVILLE, OH 44273

FOR LEASE

Office Building



THE MASICA COMPANY

www.SperryCGA.com

Valeria Long

REAL ESTATE AGENT

216.293.8900 x4

valeria.long@sperrycga.com

OH #SAL.2022003074

Steve Masica

PRINCIPAL

330.714.4415

steve.masica@sperrycga.com

OH #2013002150

Each office independently owned and operated.

We obtained the information above from sources we believe to be reliable. However, we have not verified its accuracy and make no guarantee, warranty or representation about it. It is submitted subject to the possibility of errors, omissions, change of price, rental or other conditions, prior sale, lease or financing, or withdrawal without notice. We include projections, opinions, assumptions or estimates for example only, and they may not represent current or future performance of the property. You and your tax and legal advisors should conduct your own investigation of the property and transaction.

5001 Park Ave W

5001 PARK AVE W , SEVILLE, OH 44273

FOR LEASE

Office Building

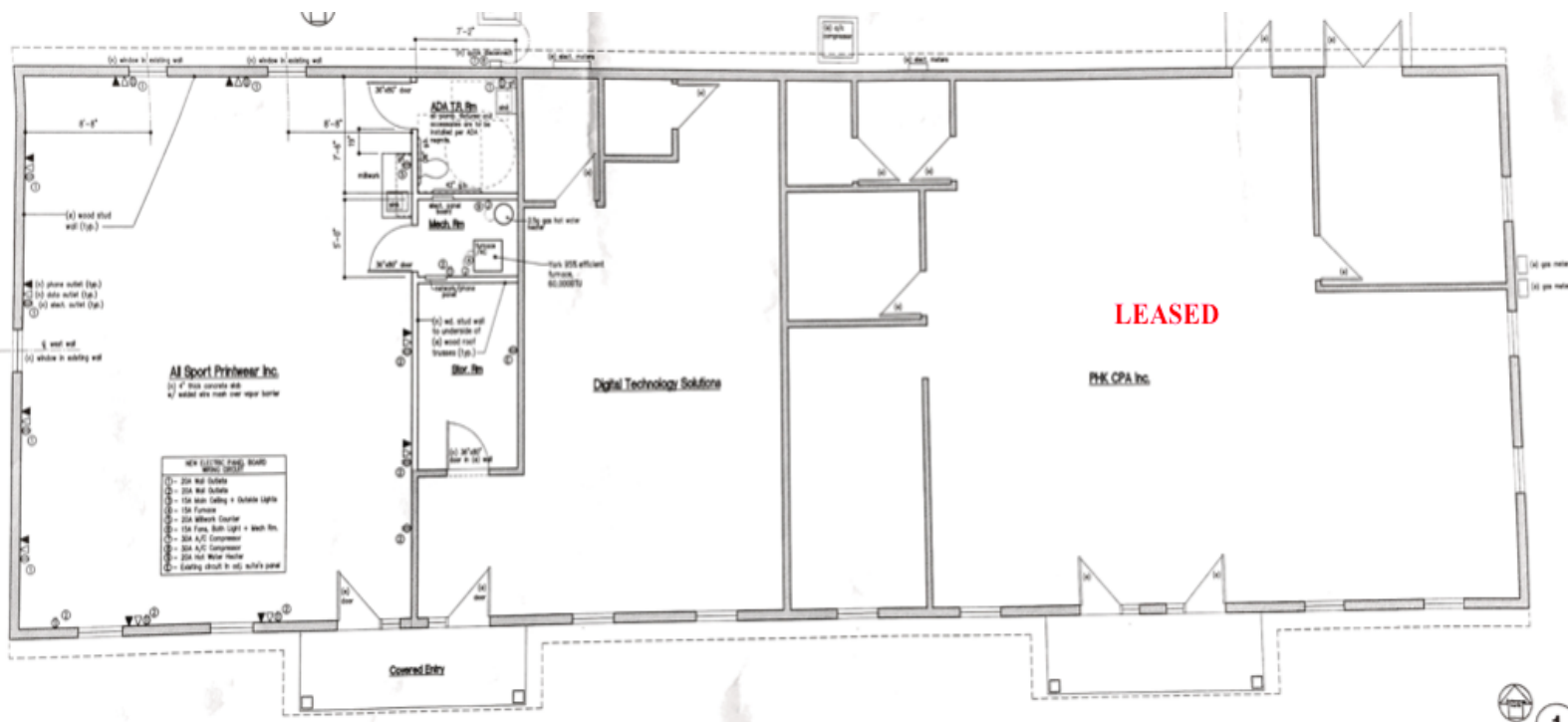

THE MASICA COMPANY

www.SperryCGA.com

Valeria Long

REAL ESTATE AGENT

216.293.8900 x4

valeria.long@sperrycga.com

OH #SAL.2022003074

Steve Masica

PRINCIPAL

330.714.4415

steve.masica@sperrycga.com

OH #2013002150

Each office independently owned and operated.

We obtained the information above from sources we believe to be reliable. However, we have not verified its accuracy and make no guarantee, warranty or representation about it. It is submitted subject to the possibility of errors, omissions, change of price, rental or other conditions, prior sale, lease or financing, or withdrawal without notice. We include projections, opinions, assumptions or estimates for example only, and they may not represent current or future performance of the property. You and your tax and legal advisors should conduct your own investigation of the property and transaction.

5001 Park Ave W

5001 PARK AVE W , SEVILLE, OH 44273

FOR LEASE

Office Building

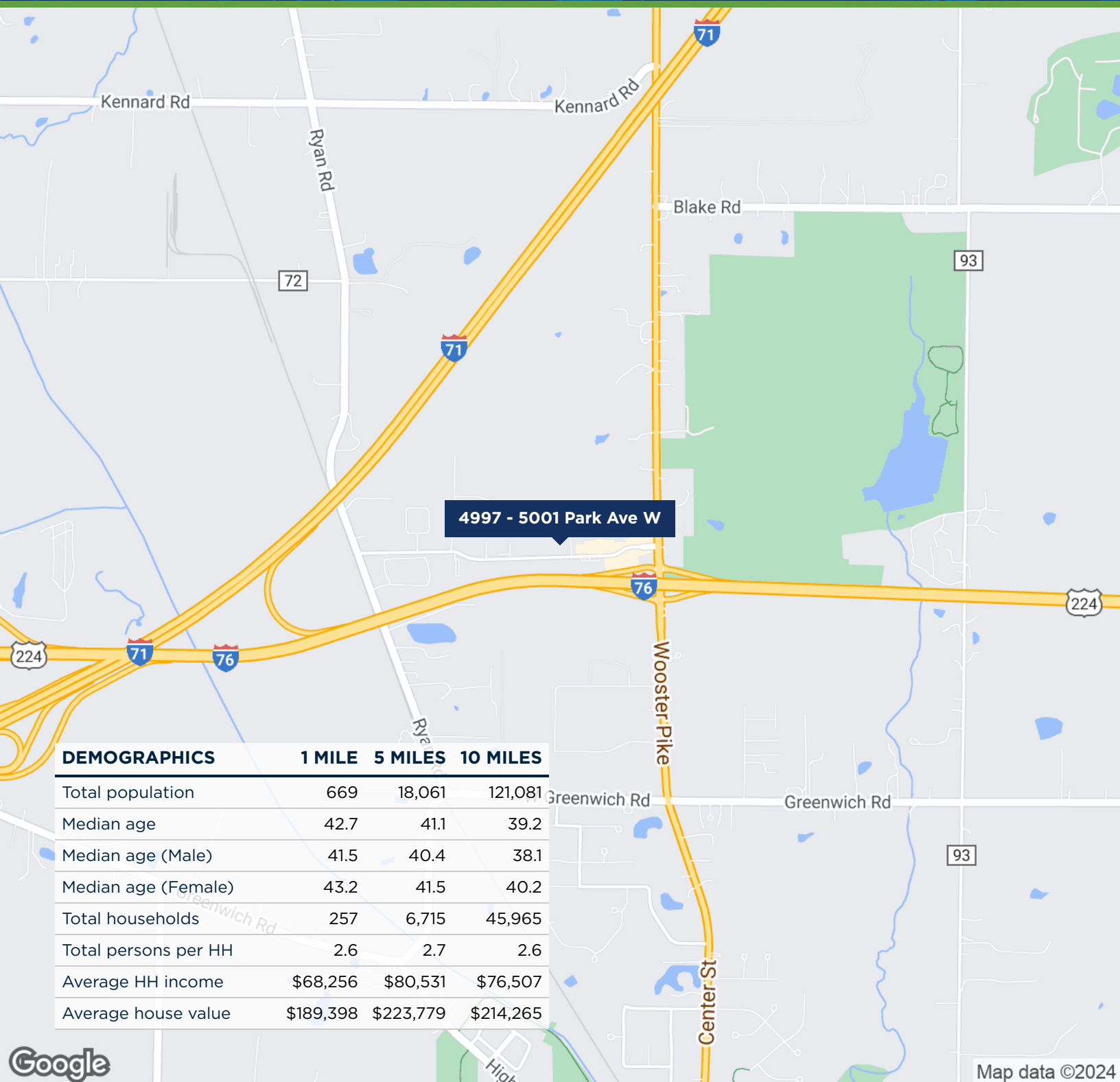

THE MASICA COMPANY

www.SperryCGA.com

Valeria Long

REAL ESTATE AGENT

216.293.8900 x4

valeria.long@sperrycga.com

OH #SAL.2022003074

Steve Masica

PRINCIPAL

330.714.4415

steve.masica@sperrycga.com

OH #2013002150

Each office independently owned and operated.

We obtained the information above from sources we believe to be reliable. However, we have not verified its accuracy and make no guarantee, warranty or representation about it. It is submitted subject to the possibility of errors, omissions, change of price, rental or other conditions, prior sale, lease or financing, or withdrawal without notice. We include projections, opinions, assumptions or estimates for example only, and they may not represent current or future performance of the property. You and your tax and legal advisors should conduct your own investigation of the property and transaction.