

First Bank & Trust Building

909 Poydras New Orleans, LA 70112

PROPERTY SUMMARY



Property Description

Ground floor office/retail space available for sublease

Property Highlights

- Ground floor space available in Class A First Bank & Trust Tower.
- Space has its own direct entry/exit to O'Keefe Ave. as well as exposure to the main building lobby.
- Potential for retail/restaurant use in addition to professional office.
- Full Service Gross
- Master Lease runs through April 2026. Subdivision possible.

Offering Summary

Sublease Rate:	Negotiable
Available SF:	5,198 SF
Lot Size:	
Building Size:	545,145 SF

Demographics	1 Mile	3 Miles	5 Miles
Total Households	6,059	65,341	130,828
Total Population	10,849	151,827	322,614
Average HH Income	\$58,124	\$55,653	\$59,440

Matthew Pittman, CCIM

504.322.1275

mpittman@beaubox.com

Broker of Record, Beau J. Box; Licensed by the Louisiana Real Estate Commission, Mississippi Real Estate Commission, Alabama Real Estate Commission and Florida Real Estate Commission, USA. This information has been secured from sources we believe to be reliable, but we make no representations or warranties, expressed or implied, as to the accuracy of the information. References to square footage or age are approximate. Buyer must verify the information and bears all risk for any inaccuracies. © Beau Box Commercial Real Estate. | December 09, 2021



First Bank & Trust Building

909 Poydras New Orleans, LA 70112

ADDITIONAL PHOTOS



Building Entrance



Main Building Lobby Entrance

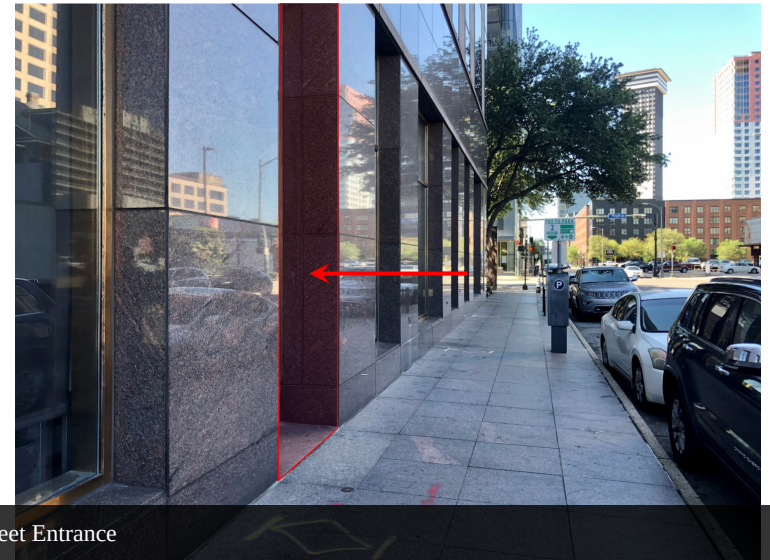
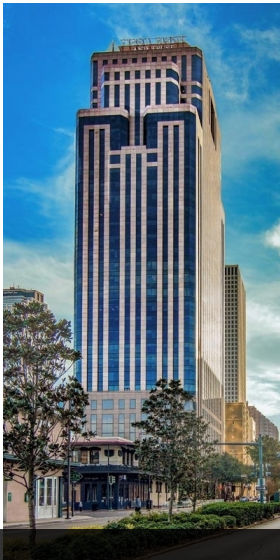

O'Keefe Street Entrance

Matthew Pittman, CCIM
504.322.1275
mpittman@beaubox.com

Broker of Record, Beau J. Box; Licensed by the Louisiana Real Estate Commission, Mississippi Real Estate Commission, Alabama Real Estate Commission and Florida Real Estate Commission, USA. This information has been secured from sources we believe to be reliable, but we make no representations or warranties, expressed or implied, as to the accuracy of the information. References to square footage or age are approximate. Buyer must verify the information and bears all risk for any inaccuracies. © Beau Box Commercial Real Estate. | December 09, 2021



First Bank & Trust Building

909 Poydras New Orleans, LA 70112

FLOOR PLANS

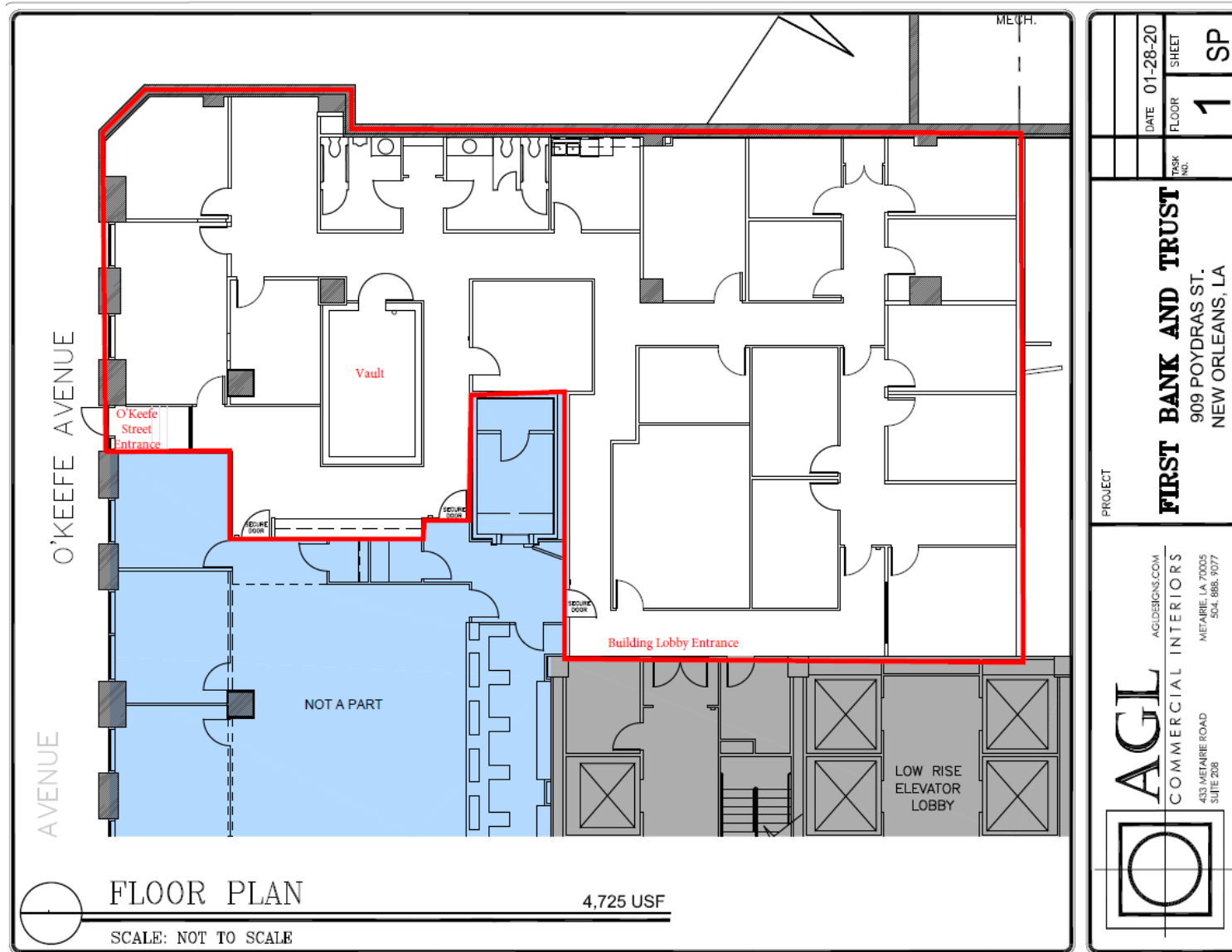

Matthew Pittman, CCIM
504.322.1275
mpittman@beaubox.com

Broker of Record, Beau J. Box; Licensed by the Louisiana Real Estate Commission, Mississippi Real Estate Commission, Alabama Real Estate Commission and Florida Real Estate Commission, USA. This information has been secured from sources we believe to be reliable, but we make no representations or warranties, expressed or implied, as to the accuracy of the information. References to square footage or age are approximate. Buyer must verify the information and bears all risk for any inaccuracies. © Beau Box Commercial Real Estate. | December 09, 2021

