

SOUTHFIELD, MI OAKLAND COMMONS



FOR LEASE



NEW LOBBY COMING SOON!

20700-20750 Civic Center Dr

Southfield, Michigan 48076

Property Highlights

- **Class A Office Buildings**
- **Recent Common Area Updates Include New Common Area Finishes, Parking Lots, and Enhanced Landscaping**
- **Full Service Buildings with On-Site Management, Security Desk with Lobby Attendant, Fitness Center, Building Conference Center and Restaurant**
- **BOMA Award Winning Buildings**
- **Quick and Easy Access to I-696 and M-10**
- **Abundant Parking**
- **High-Speed Elevators**
- **24/7 Card Access**
- **9'-12' Ceilings**
- **Loading Docks**
- **Close Proximity to Hotels, Restaurants and Other Retail**

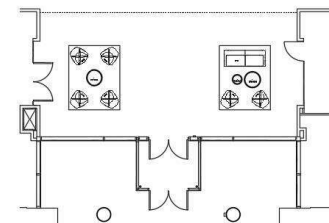
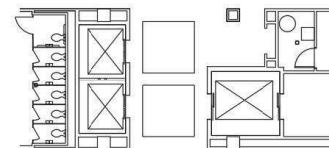
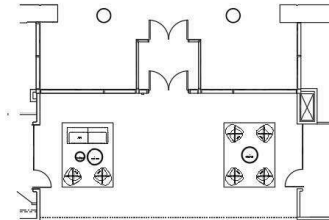

NAI Farbman

Commercial Real Estate Services, Worldwide.

www.naifarbman.com

Lesley Gutman

Senior Vice President | 248.860.6800

lgutman@farbman.com

NO WARRANTY, EXPRESS OR IMPLIED, IS MADE AS TO THE ACCURACY OF THE INFORMATION CONTAINED HEREIN. THIS INFORMATION IS SUBMITTED SUBJECT TO ERRORS, OMISSIONS, CHANGE OF PRICE, RENTAL OR OTHER CONDITIONS, WITHDRAWAL WITHOUT NOTICE, AND IS SUBJECT TO ANY SPECIAL LISTING CONDITIONS IMPOSED BY OUR PRINCIPALS. COOPERATING BROKERS, BUYERS, TENANTS AND OTHER PARTIES WHO RECEIVE THIS DOCUMENT SHOULD NOT RELY ON IT, BUT SHOULD USE IT AS A STARTING POINT OF ANALYSIS, AND SHOULD INDEPENDENTLY CONFIRM THE ACCURACY OF THE INFORMATION CONTAINED HEREIN THROUGH A DUE DILIGENCE REVIEW OF THE BOOKS, RECORDS, FILES AND DOCUMENTS THAT CONSTITUTE RELIABLE SOURCES OF THE INFORMATION DESCRIBED HEREIN. LOGOS ARE FOR IDENTIFICATION PURPOSES ONLY AND MAY BE TRADEMARKS OF THEIR RESPECTIVE COMPANIES. NAI Farbman, INC. CA BRE LIC. #01990696.

SOUTHFIELD, MI OAKLAND COMMONS



FOR LEASE



AVAILABLE SPACES

SUITE	SIZE (SF)	LEASE RATE
20700 Civic Center Drive Suite 105	1,114 SF	\$17.50 SF/yr
20700 Civic Center Drive Suite 150	806 SF	\$17.50 SF/yr
20700 Civic Center Drive Suite 380	6,812 SF	\$17.50 SF/yr
20750 Civic Center Drive Suite 290	7,028 SF	\$17.50 SF/yr
20750 Civic Center Drive Suite 330	4,839 SF	\$17.50 SF/yr
20750 Civic Center Drive Suite 410*	1,692 SF	\$17.50 SF/yr
20750 Civic Center Drive Suite 415*	829 SF	\$17.50 SF/yr
20750 Civic Center Drive Suite 430	4,420 SF	\$17.50 SF/yr
20750 Civic Center Drive Suite 500	13,611 SF	\$17.50 SF/yr
20750 Civic Center Drive Suite 550	7,551 SF	\$19.50 SF/yr
20750 Civic Center Drive Suite 615	541 SF	\$17.50 SF/yr
20750 Civic Center Drive Suite 630	1,221 SF	\$17.50 SF/yr

*Suites 410/415 can be combined for a total of 2,521 RSF.



Commercial Real Estate Services, Worldwide.

www.naifarbman.com

Lesley Gutman
Senior Vice President | 248.860.6800
lgutman@farbman.com

NO WARRANTY, EXPRESS OR IMPLIED, IS MADE AS TO THE ACCURACY OF THE INFORMATION CONTAINED HEREIN. THIS INFORMATION IS SUBMITTED SUBJECT TO ERRORS, OMISSIONS, CHANGE OF PRICE, RENTAL OR OTHER CONDITIONS, WITHDRAWAL WITHOUT NOTICE, AND IS SUBJECT TO ANY SPECIAL LISTING CONDITIONS IMPOSED BY OUR PRINCIPALS. COOPERATING BROKERS, BUYERS, TENANTS AND OTHER PARTIES WHO RECEIVE THIS DOCUMENT SHOULD NOT RELY ON IT, BUT SHOULD USE IT AS A STARTING POINT OF ANALYSIS, AND SHOULD INDEPENDENTLY CONFIRM THE ACCURACY OF THE INFORMATION CONTAINED HEREIN THROUGH A DUE DILIGENCE REVIEW OF THE BOOKS, RECORDS, FILES AND DOCUMENTS THAT CONSTITUTE RELIABLE SOURCES OF THE INFORMATION DESCRIBED HEREIN. LOGOS ARE FOR IDENTIFICATION PURPOSES ONLY AND MAY BE TRADEMARKS OF THEIR RESPECTIVE COMPANIES. NAI CAPITAL, INC. CA BRE LIC. #01990696.