

# Rare Multi-Family Investment/Development Opportunity

MARYSVILLE, WA



OFFERING MEMORANDUM

**KW COMMERCIAL**

11109 Slater Avenue NE  
Kirkland, WA 98033

*PRESENTED BY:*

**MARIANNE CHRISTIAN, CCIM**

Managing Broker  
O: 206.915.9222  
C: 206.915.9222  
mchristian369@gmail.com

**RUTH GREEN**

eXp Realtor  
C: 206.713.4902  
ruthgreen@gmail.com



## Executive Summary



### OFFERING SUMMARY

<b>SALE PRICE:</b>	\$950,000
<b>NUMBER OF UNITS:</b>	4
<b>LOT SIZE:</b>	2.42 Acres
<b>BUILDING SIZE:</b>	4,564
<b>ZONING:</b>	R6
<b>MARKET:</b>	Marysville
<b>PRICE / SF:</b>	\$9.01 PSF (land only)

### PROPERTY OVERVIEW

Looking for an investment or development property? This one is it! Secluded 2.42 acres zoned R6 with 4 legal, non-conforming manufactured homes included in sale (3 currently rented). Public sewer at street. Let the rents pay your expenses, while you plan the development of this R6 zoned property. Upside is in development and bringing in sewer - manhole is in driveway. Approximately \$9 per square foot (land only - for calculating potential subdivision development). Tenants pay electricity and maintain their own yards. Landlord pays water/trash/recycling. Secure this for your portfolio. \*Buyer to verify use, utilities, future use, zoning, size, etc to their own satisfaction.\*

### LOCATION OVERVIEW

Located 35 miles outside of Seattle, Marysville has grown into a bedroom community of Washington's largest city. The property lies near the banks of Possession Sound and in close proximity to several lakes and idyllic parks. Grocery stores, big box retailers, and several schools are a short distance away.

### PROPERTY HIGHLIGHTS

- Perfect investment property
- Renters pay your mortgage for you
- Month to month leasing creates a value-add opportunity
- 4 rental units with opportunity to subdivide into estate lots, or subdivide into a single or multi-family subdivision

## Property Details

### SALE PRICE

**\$950,000**

### LOCATION INFORMATION

Building Name	6227 Grove Street, Marysville, WA
Street Address	6227 Grove Street
City, State, Zip	Marysville, WA 98270
County/Township	Snohomish
Market	Marysville

### BUILDING INFORMATION

Building Size	4,564 SF
Year Built	1970
Load Factor	Yes

### PROPERTY DETAILS

Property Type	Multifamily
Property Subtype	Mobile Home Park
Zoning	Multi-Family, Residential
Lot Size	2.42 Acres

# Rent Roll And Expenses

## RENT ROLL

UNIT NUMBERS	UNIT BEDS	UNIT BATHS	UNIT SIZE	CURRENT RENT	CURRENT RENT PER SF
B	2	2	924	\$1,100	\$1.19
C	3	2	1,336	\$1,400	\$1.05
D	2	2	1,056	\$1,150	\$1.09
E	3	2	1,248	\$1,400	\$1.12
<b>TOTALS</b>			<b>4,564</b>	<b>\$5,050</b>	

## LANDLORD FIXED EXPENSES

2020 Expenses - water, garbage, recycling, surface water (bi-monthly)	\$3,856.00
2020 Total:	\$3,856.00
2021 property taxes	\$2,667.00
2021 manufactured home taxes	\$685.00
2021 Total:	\$3352.00

## DETAILS

Tenants pay electric and maintain yards. Manhole located in driveway easement; units currently on septic.



## Property Photos





## Rental Photos - 4 Manufactured Homes





## Regional Map

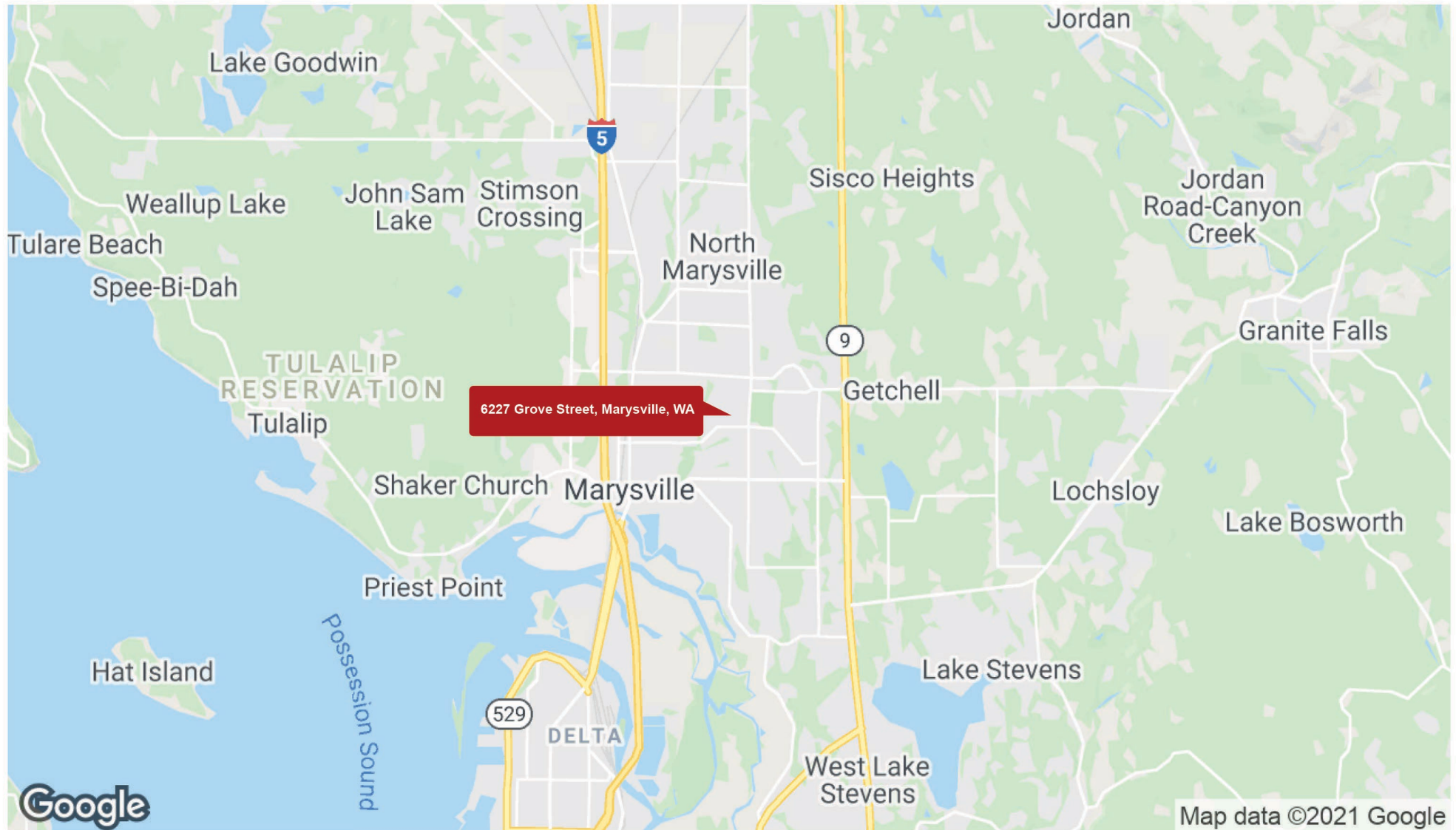

## Location Maps

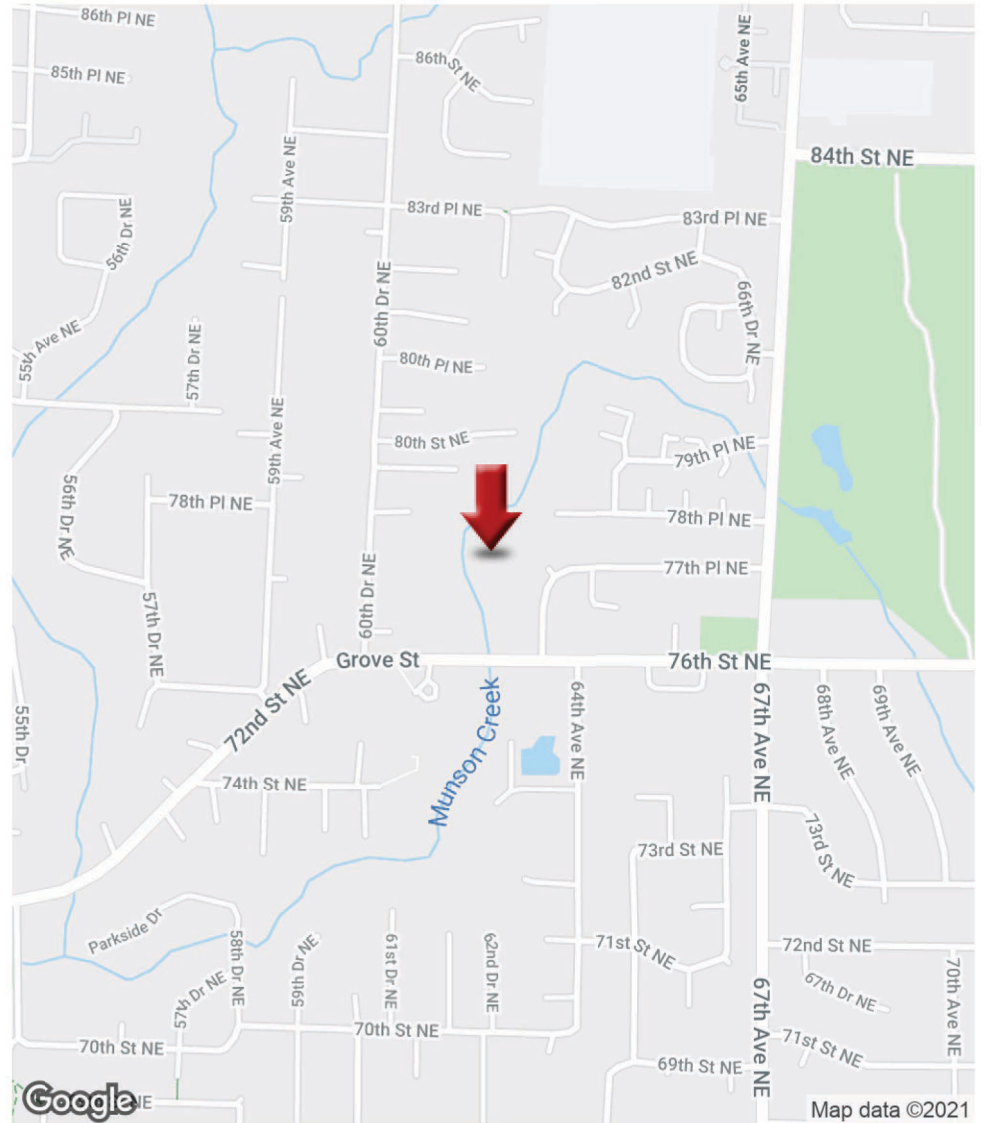
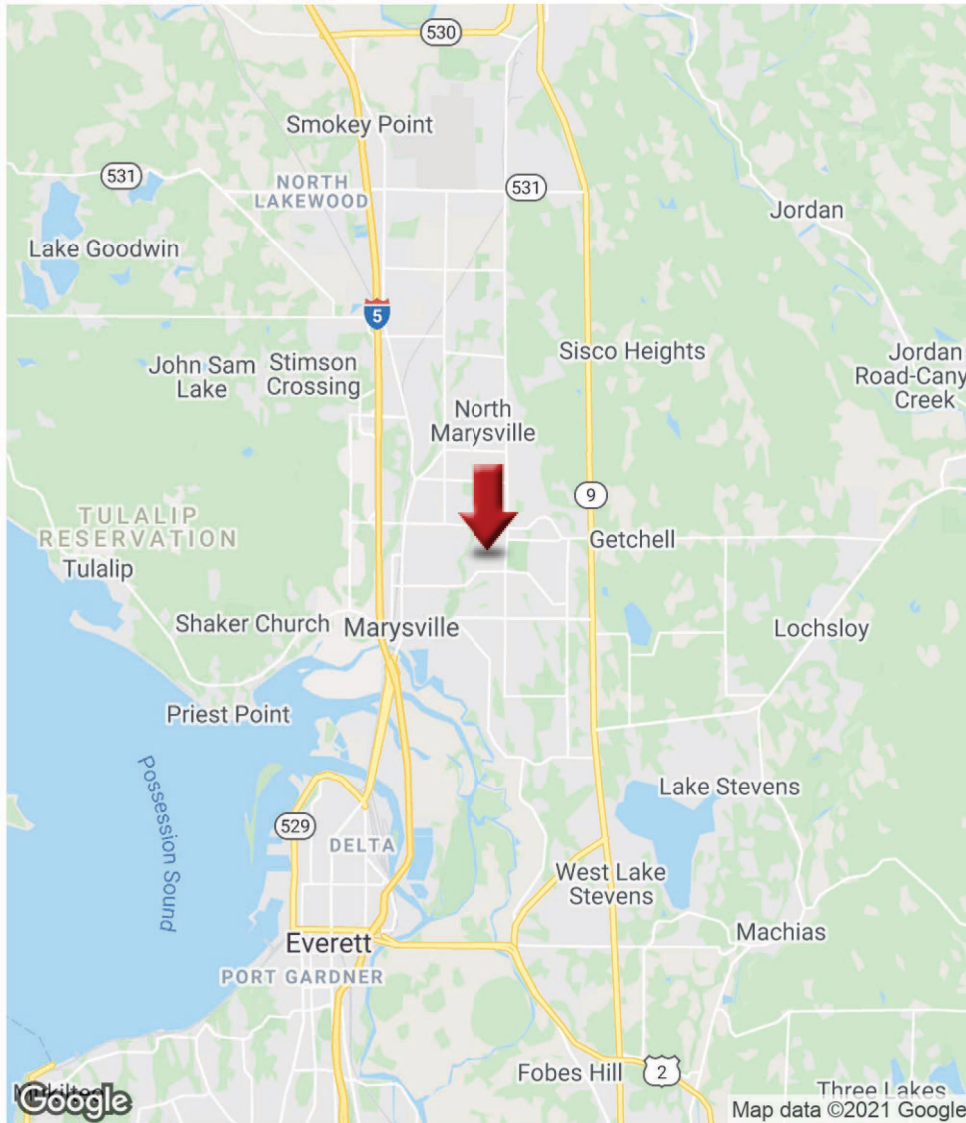



## Retailer Map





## Notable Locations

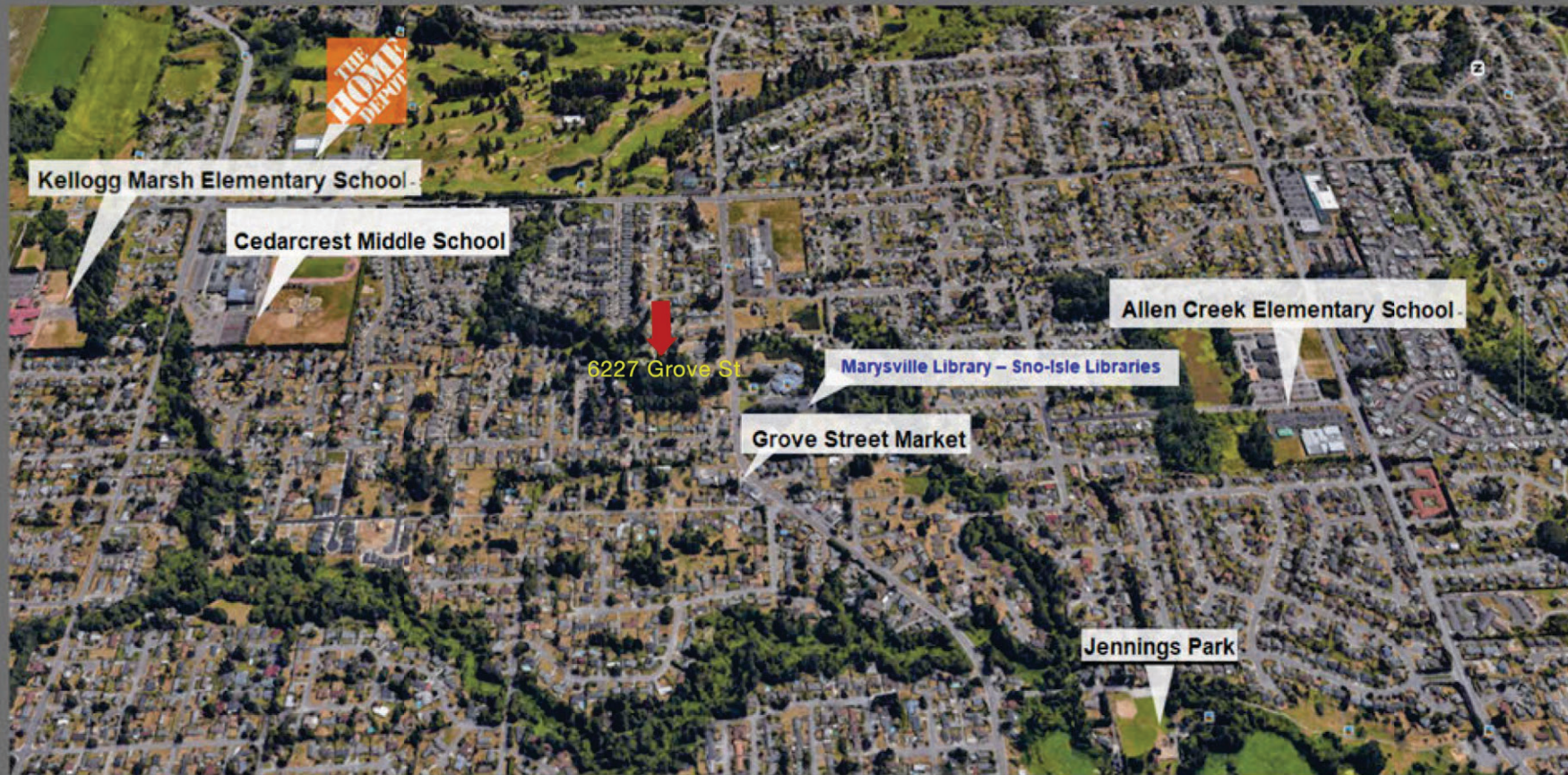

6227 GROVE ST, MARYSVILLE 98270



# Demographics Map

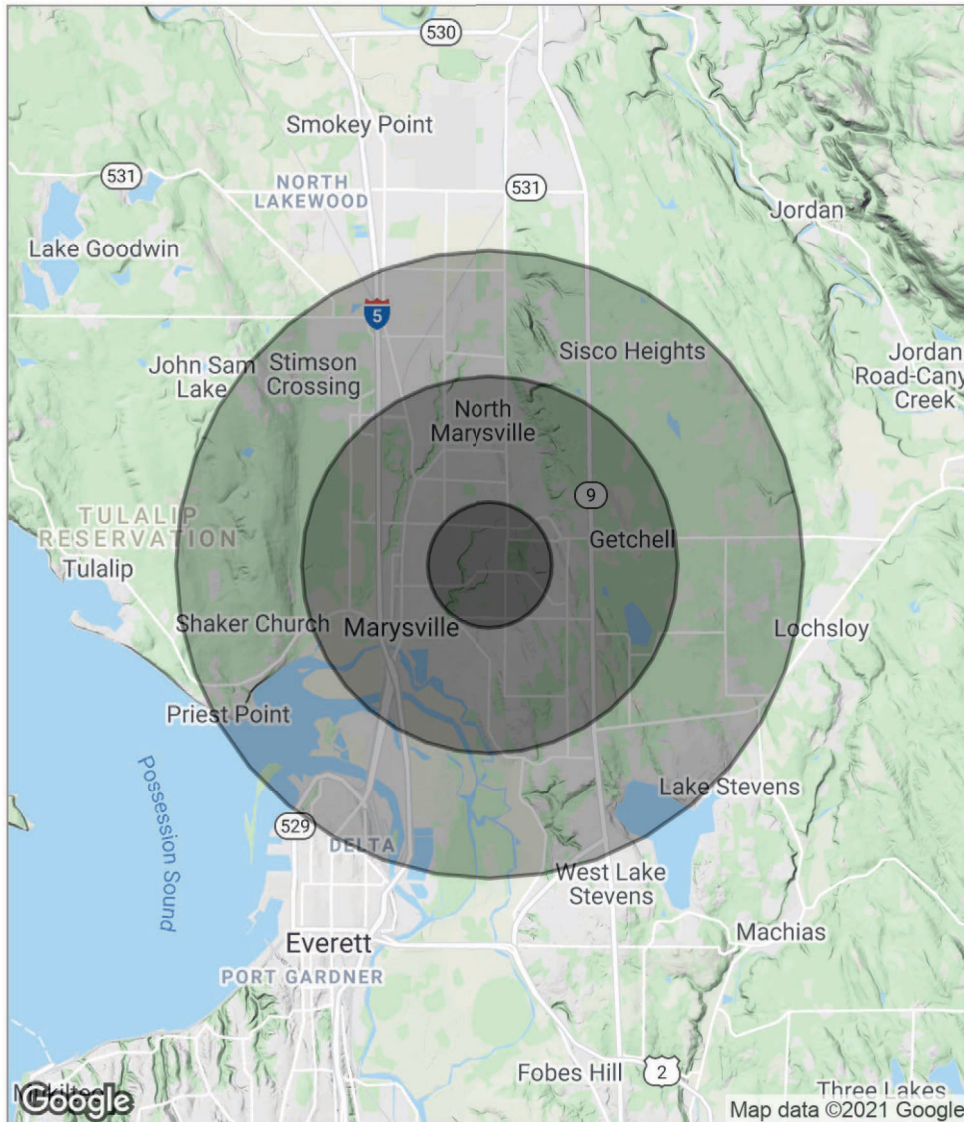

POPULATION	1 MILE	3 MILES	5 MILES
Total Population	14,267	63,700	99,189
Median Age	34.0	34.3	34.4
Median Age (Male)	33.0	33.3	33.7
Median Age (Female)	35.0	35.6	35.4
HOUSEHOLDS & INCOME	1 MILE	3 MILES	5 MILES
Total Households	4,963	23,360	35,706
# Of Persons Per HH	2.9	2.7	2.8
Average HH Income	\$75,030	\$69,351	\$72,361
Average House Value	\$262,259	\$276,982	\$304,196

\* Demographic data derived from 2010 US Census

# Confidentiality & Disclaimer

## MARYSVILLE, WA

All materials and information received or derived from KW Commercial its directors, officers, agents, advisors, affiliates and/or any third party sources are provided without representation or warranty as to completeness, veracity, or accuracy, condition of the property, compliance or lack of compliance with applicable governmental requirements, developability or suitability, financial performance of the property, projected financial performance of the property for any party's intended use or any and all other matters.

Neither KW Commercial its directors, officers, agents, advisors, or affiliates makes any representation or warranty, express or implied, as to accuracy or completeness of the any materials or information provided, derived, or received. Materials and information from any source, whether written or verbal, that may be furnished for review are not a substitute for a party's active conduct of its own due diligence to determine these and other matters of significance to such party. KW Commercial will not investigate or verify any such matters or conduct due diligence for a party unless otherwise agreed in writing.

EACH PARTY SHALL CONDUCT ITS OWN INDEPENDENT INVESTIGATION AND DUE DILIGENCE.

Any party contemplating or under contract or in escrow for a transaction is urged to verify all information and to conduct their own inspections and investigations including through appropriate third party independent professionals selected by such party. All financial data should be verified by the party including by obtaining and reading applicable documents and reports and consulting appropriate independent professionals. KW Commercial makes no warranties and/or representations regarding the veracity, completeness, or relevance of any financial data or assumptions. KW Commercial does not serve as a financial advisor to any party regarding any proposed transaction.

All data and assumptions regarding financial performance, including that used for financial modeling purposes, may differ from actual data or performance. Any estimates of market rents and/or projected rents that may be provided to a party do not necessarily mean that rents can be established at or increased to that level. Parties must evaluate any applicable contractual and governmental limitations as well as market conditions, vacancy factors and other issues in order to determine rents from or for the property. Legal questions should be discussed by the party with an attorney. Tax questions should be discussed by the party with a certified public accountant or tax attorney. Title questions should be discussed by the party with a title officer or attorney. Questions regarding the condition of the property and whether the property complies with applicable governmental requirements should be discussed by the party with appropriate engineers, architects, contractors, other consultants and governmental agencies. All properties and services are marketed by Kirkland in compliance with all applicable fair housing and equal opportunity laws.

### PRESENTED BY:

#### KW COMMERCIAL

11109 Slater Avenue NE  
Kirkland, WA 98033

#### MARIANNE CHRISTIAN, CCIM

Managing Broker  
O: 206.915.9222  
C: 206.915.9222  
mchristian369@gmail.com

#### RUTH GREEN

eXp Realtor  
C: 206.713.4902  
ruthgreen@gmail.com

We obtained the information above from sources we believe to be reliable. However, we have not verified its accuracy and make no guarantee, warranty or representation about it. It is submitted subject to the possibility of errors, omissions, change of price, rental or other conditions, prior sale, lease or financing, or withdrawal without notice. We include projections, opinions, assumptions or estimates for example only, and they may not represent current or future performance of the property. You and your tax and legal advisors should conduct your own investigation of the property and transaction.

