

Office Suite - Historic Stroudsburg National Bank Building

637 Main St, Stroudsburg, PA 18360



OFFERING SUMMARY

Available SF: 220 - 550 SF

Lease Rate: \$475.00 - 925.00 per month (Gross)

Building Size: 3,000 SF

Zoning: C-2

Market: Northeast PA

Submarket: Poconos

PROPERTY OVERVIEW

Clean and updated office space with very unique features in the heart of downtown Stroudsburg. This historic bank was renovated and updated into a multi-tenant office building. This building is prominently located at the best intersection in downtown Stroudsburg making its iconic features and restored clock tower a landmark of the community. Join PNC Wealth Management, Keller Williams Real estate, and 7 Mountains Media in this perfect location.

PROPERTY HIGHLIGHTS

- Downtown Location
- Prominent building
- Parking for 1 car
- Utilities & Internet Included

Dan Lichty

Commercial Advisor

570.801.6170

570.460.2335

daniel.lichty@gmail.com

TACM Commercial Realty Inc

2331 Route 209/Suite 5

Sciota, PA 18354

No warranty of representation, express or implied, is made as to the accuracy of the information contained herein, and the same is submitted. Subject to errors, omissions, change of price, rental or other conditions, prior sale, lease or financing or withdrawal without notice. And any special listing Conditions imposed by our principals no warranties or representations are made as to the condition of the property or any hazards contained therein or any to be implied.

2nd Floor Office - Historic Stroudsburg National Bank

637 Main St, Stroudsburg, PA 18360

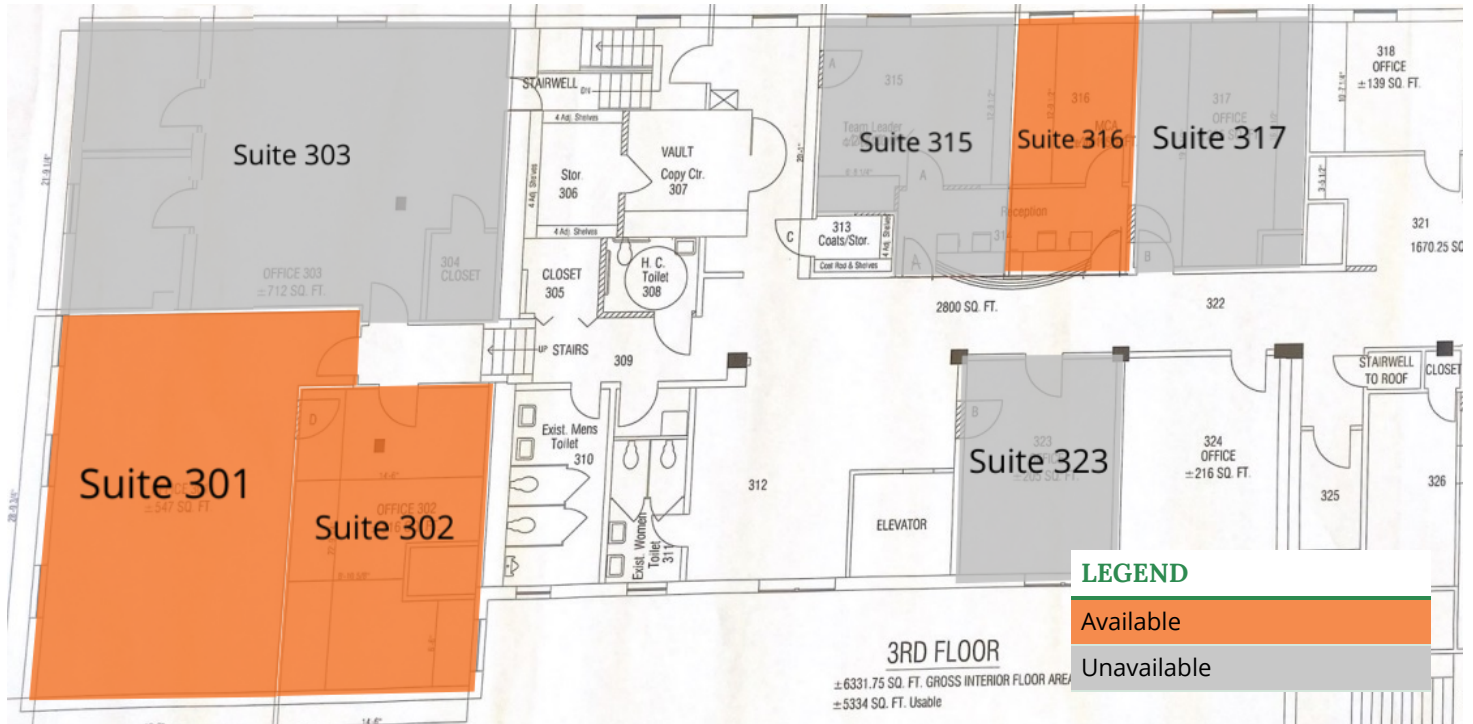

LEGEND

Available

Unavailable

LEASE INFORMATION

Lease Type:	Gross
Total Space:	220 - 550 SF

Lease Term:	Negotiable
Lease Rate:	\$475.00 - \$925.00 per month

AVAILABLE SPACES

SUITE	TENANT	SIZE	TYPE	RATE	DESCRIPTION
Suite 316	Available	220 - 225 SF	Gross	\$475 per month	Single Office Suite approx. 225 SF. This office suite is all-inclusive (utilities, HVAC, Internet). Elevator service and has recently been updated.
Suite 301	Available	550 SF	Gross	\$925 per month	Single, large, Office Suite approx. 550SF. Large windows with lots of natural light. Currently open space, but can be modified. This office suite is all-inclusive (utilities, HVAC, water/sewer). The building has elevator service, common lobby areas, and has recently been updated.
Suite 302	Available	316 SF	Gross	\$595 per month	Single Office Suite approx. 316 SF. Large window with lots of natural light. Currently open space, but can be modified. This office suite is all-inclusive (utilities, HVAC, water/sewer). The building has elevator service, common lobby areas, and has recently been updated.

Dan Lichty

Commercial Advisor

570.801.6170

570.460.2335

daniel.lichty@gmail.com

Office Suite - Historic Stroudsburg National Bank Building

637 Main St, Stroudsburg, PA 18360



Dan Lichty

Commercial Advisor

570.801.6170

570.460.2335

daniel.lichty@gmail.com

2nd Floor Office - Historic Stroudsburg National Bank Building

637 Main St, Stroudsburg, PA 18360

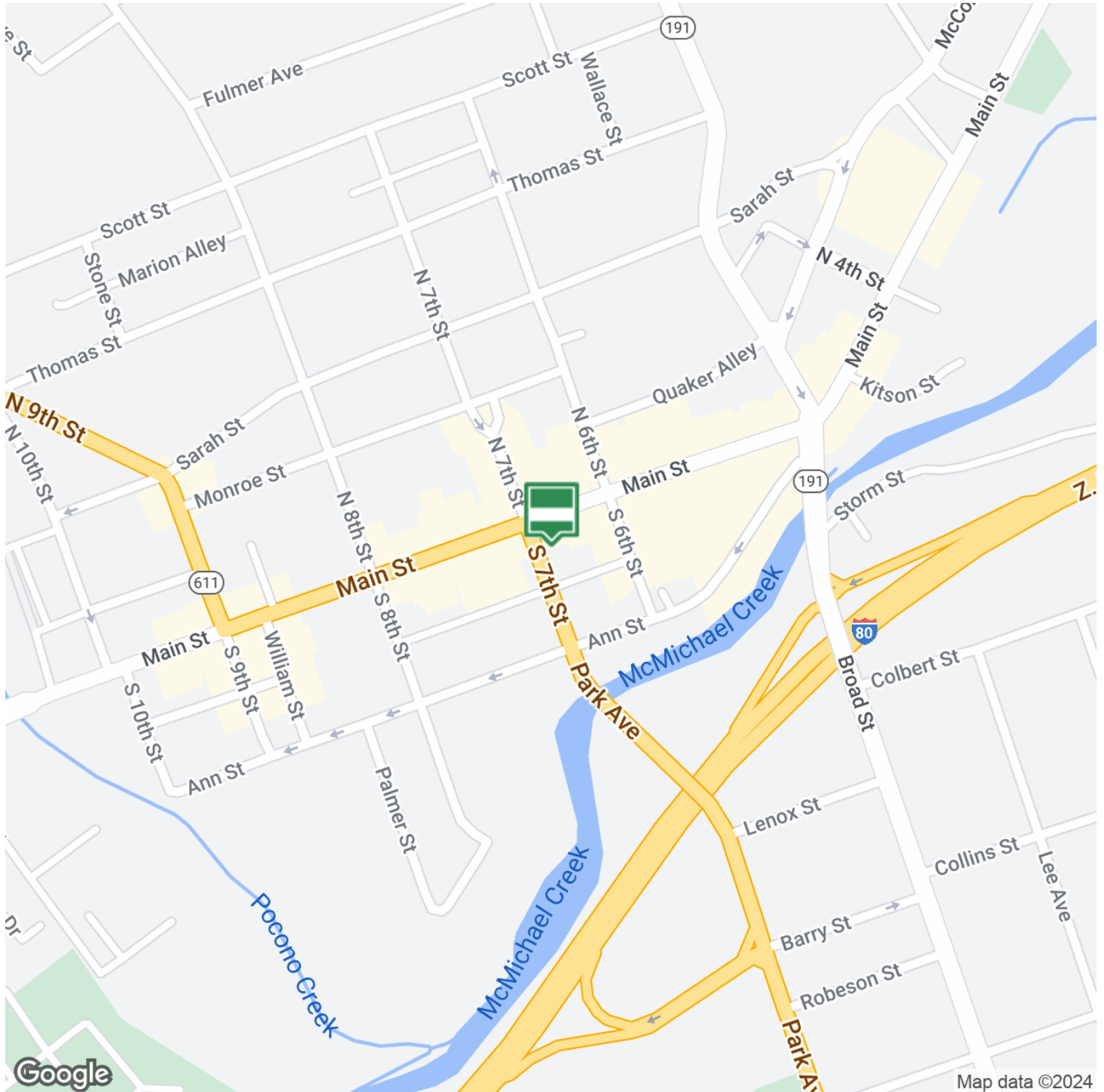

Dan Lichty
Commercial Advisor
570.801.6170
570.460.2335
daniel.lichty@gmail.com