

For Lease

103RD STREET COMMERCIAL PARK



7540 103rd St Jacksonville, FL 32210



Offering Summary

Lease Rate (MG)	\$13.00 - 14.00 SF/yr (MG)
Building Size:	51,000 SF
Lot Size:	4.01 Acres
CAM:	\$3.25 PSF
Number of Units:	23
Year Built:	2005
Zoning:	PUD

Property Overview

Addison Commercial Real Estate is proud to exclusively represent this industrial park in Jacksonville, FL. This multi-tenanted park offers grade level warehouse in 1,500 sf to 3,000 sf spaces. Each 1,500 sf unit has a OH door & glass entrance door on the front of the suites.

Property Highlights

- Grade Level 10' x 14' OH Doors
- Quick Access to I-295

Spaces	Lease Rate (MG)	Space Size
211	\$13.00 SF/yr	1,500 SF
215/216	\$13.00 SF/yr	3,000 SF
207/208	\$13.00 SF/yr	3,000 SF
114	\$14.00 SF/yr	1,500 SF

CONTACT

Advisors

Jake Ammon, CCIM
904.354.1789 x213
jake@acrei.com

Office

Addison Commercial Real Estate, Inc.
7400 Baymeadows Way, Ste. 320
904.354.1789 | www.acrei.com



For Lease

103RD STREET COMMERCIAL PARK



7540 103rd St Jacksonville, FL 32210

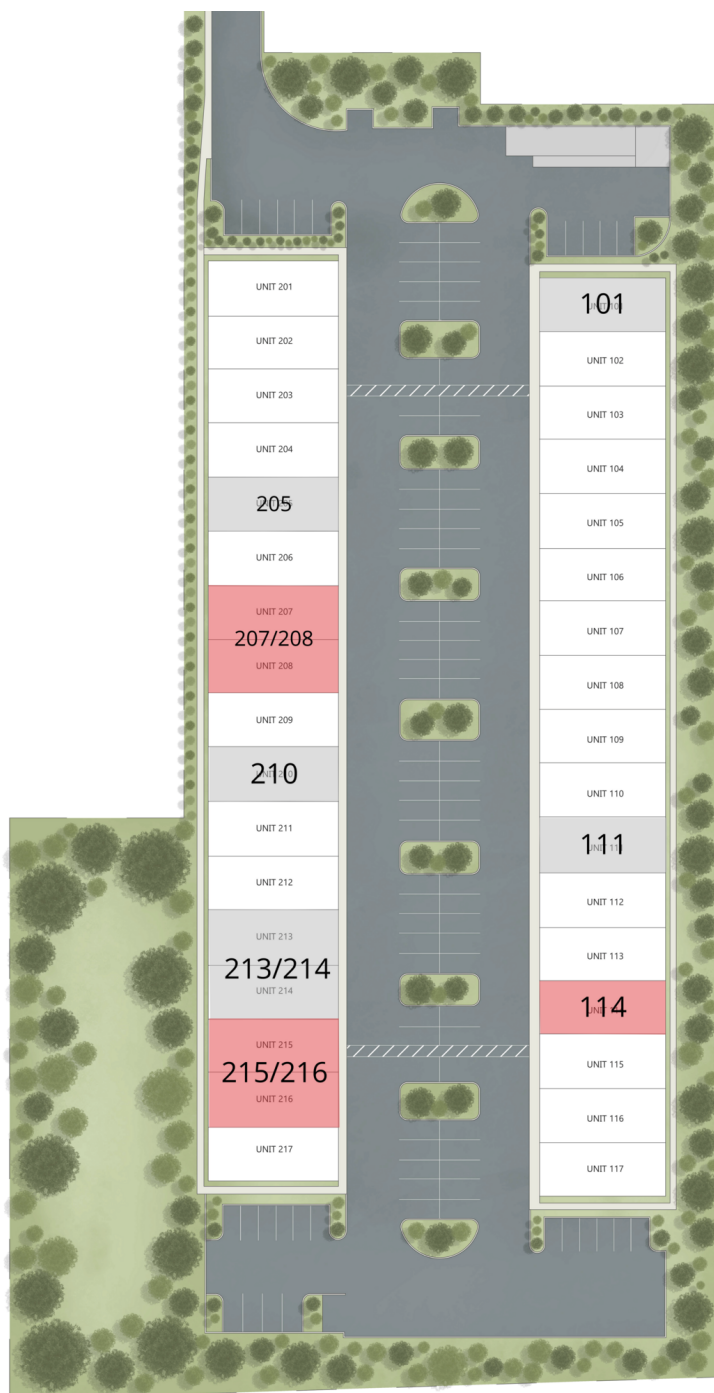

Legend

Available

Unavailable

CONTACT

Advisors

Jake Ammon, CCIM
904.354.1789 x213
jake@acrei.com

Office

Addison Commercial Real Estate, Inc.
7400 Baymeadows Way, Ste. 320
904.354.1789 | www.acrei.com



For Lease

103RD STREET COMMERCIAL PARK



7540 103rd St Jacksonville, FL 32210



Typical 1,500 SF Unit Layout

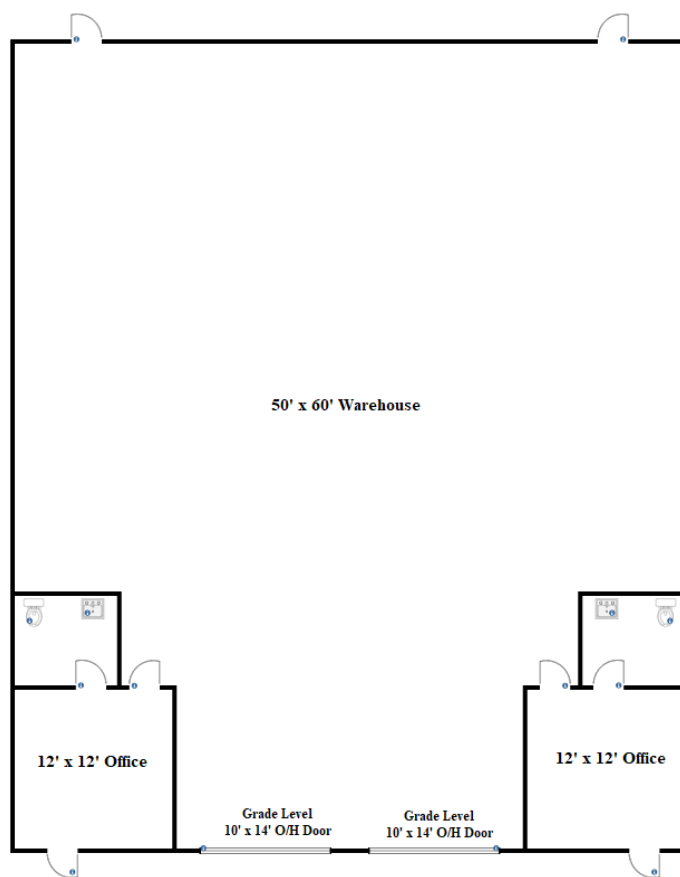

Typical 3,000 SF Unit Layout

CONTACT

Advisors

Jake Ammon, CCIM
904.354.1789 x213
jake@acrei.com

Office

Addison Commercial Real Estate, Inc.
7400 Baymeadows Way, Ste. 320
904.354.1789 | www.acrei.com



For Lease

103RD STREET COMMERCIAL PARK



7540 103rd St Jacksonville, FL 32210

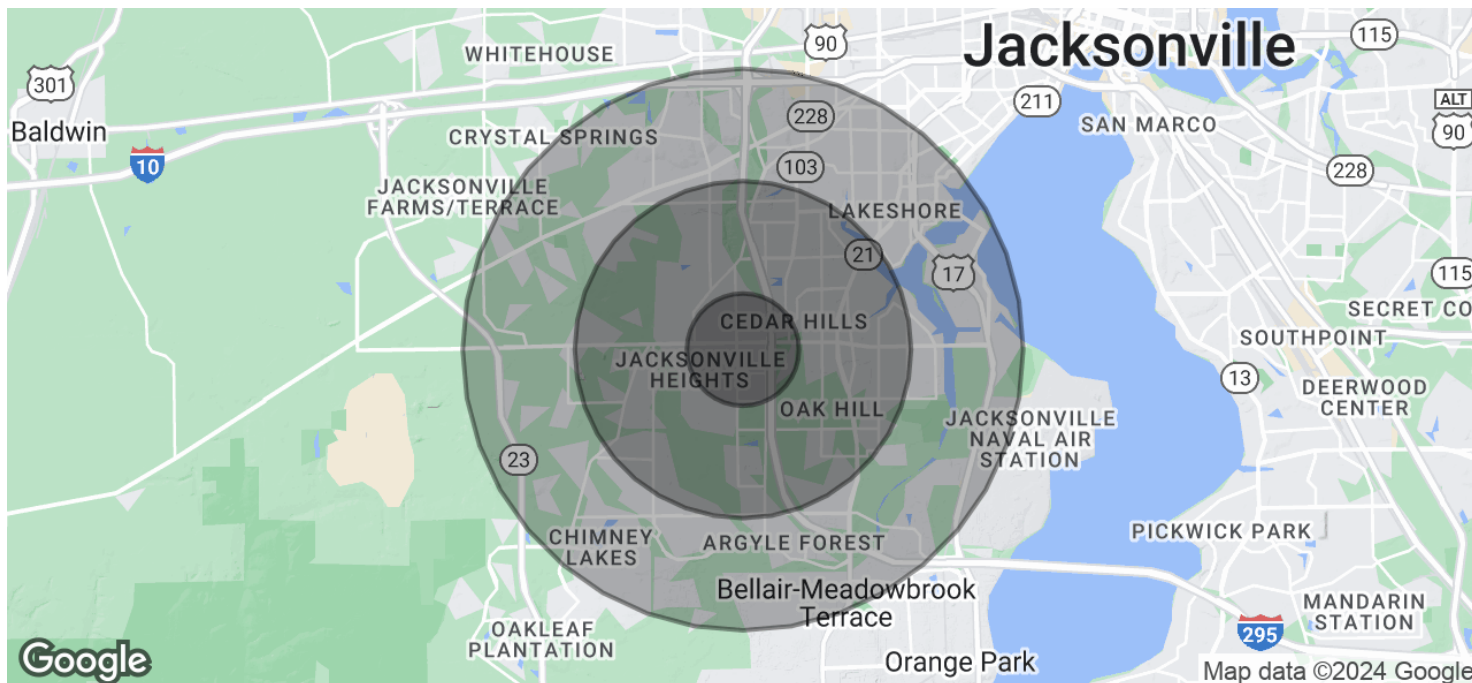

Population	1 Mile	3 Miles	5 Miles
Total Population	11,231	66,350	160,307
Average Age	37.9	35.4	35.8
Average Age (Male)	36.1	34.4	34.3
Average Age (Female)	38.7	36.9	37.3

Households & Income	1 Mile	3 Miles	5 Miles
Total Households	4,602	27,047	66,159
# of Persons per HH	2.4	2.5	2.4
Average HH Income	\$48,187	\$54,957	\$59,623
Average House Value	\$187,467	\$191,434	\$199,291

* Demographic data derived from 2020 ACS - US Census

CONTACT

Advisors

Jake Ammon, CCIM
904.354.1789 x213
jake@acrei.com

Office

Addison Commercial Real Estate, Inc.
7400 Baymeadows Way, Ste. 320
904.354.1789 | www.acrei.com

