

ANTON ASCEND | RETAIL SPACE AVAILABLE FOR LEASE

730 EAST CAPITOL AVENUE, MILPITAS, CA 95035



John Sechser
Managing Director
East Bay Retail Services
925-296-3368
john.sechser@tricommercial.com
LIC: #00829597

Ron Willet
Associate
925-296-3336
ron.willet@tricommercial.com
LIC: #01834997

FOR LEASE

**GROUND FLOOR RETAIL PROPERTY
AVAILABLE NOW**



Located on the ground floor of a brand new housing development in highway accessible Milpitas, CA, Anton Ascend has one retail availability left: a storefront space along Capitol Avenue with excellent exposure and newly available.

- $\pm 1,676$ SF Space is available
- Across the street from new BART station, now open
- Hard-corner visibility on signalized intersection, large glass line
- Space is below Anton Ascend: 266 units and is proximal to several other apartment developments
- Walking distance to the Great Mall, which enjoys over 22 million visitors annually
- Excellent parking

John Sechser

925-296-3368

john.sechser@tricommercial.com

LIC: #00829597

Ron Willet

925-296-3336

ron.willet@tricommercial.com

LIC: #01834997



www.tricommercial.com

FOR LEASE

**GROUND FLOOR RETAIL PROPERTY
AVAILABLE NOW**



John Sechser

925-296-3368

john.sechser@tricommercial.com

LIC: #00829597

Ron Willet

925-296-3336

ron.willet@tricommercial.com

LIC: #01834997



www.tricommercial.com

FOR LEASE

GROUND FLOOR **RETAIL PROPERTY**
AVAILABLE NOW



John Sechser

925-296-3368

john.sechser@tricommercial.com

LIC: #00829597

Ron Willet

925-296-3336

ron.willet@tricommercial.com

LIC: #01834997



www.tricommercial.com

FOR LEASE

**GROUND FLOOR RETAIL PROPERTY
AVAILABLE NOW**

730 E Capitol Ave

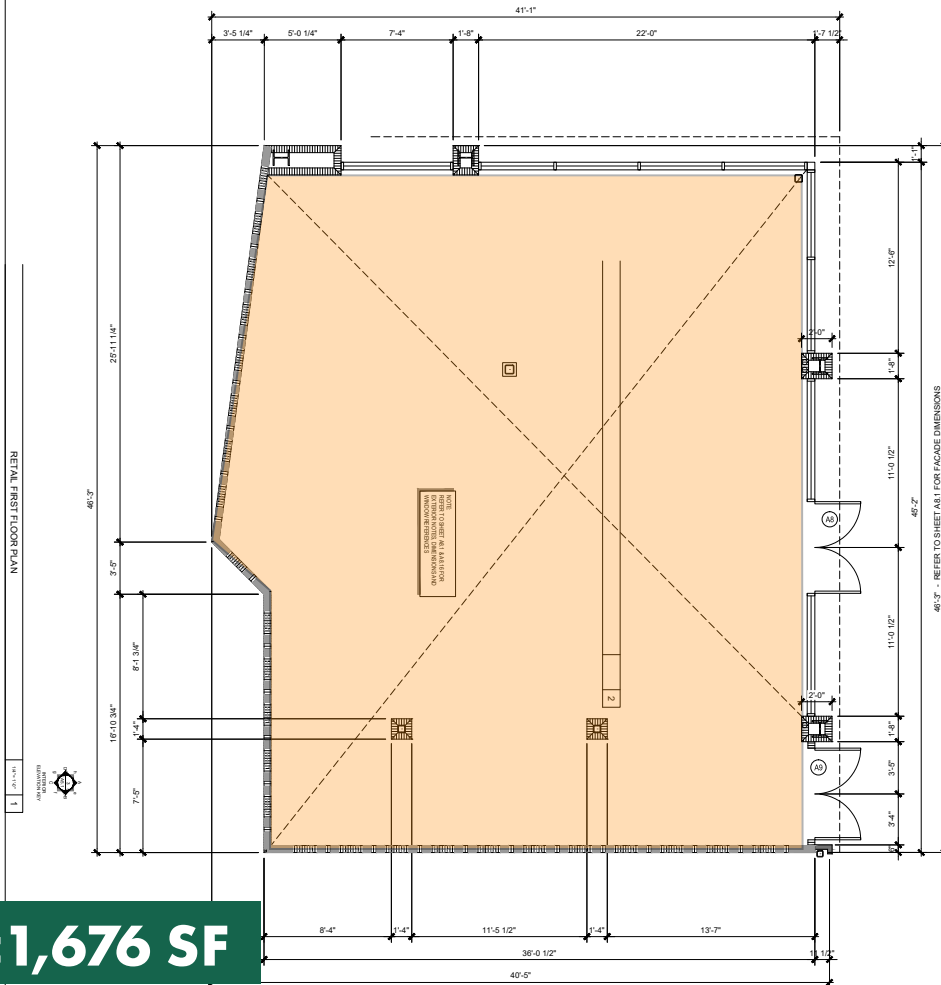

±1,676 SF

John Sechser

925-296-3368

john.sechser@tricommercial.com

LIC: #00829597

Ron Willet

925-296-3336

ron.willet@tricommercial.com

LIC: #01834997



www.tricommercial.com