

Summer Trees Rd

**SALE / LEASE**  
**Port Orange Medical  
Office For Lease-**  
**3,330 SF**

**5440 S WILLIAMSON BLVD, SUITE 5**

Port Orange, FL 32128

**PRESENTED BY:**

**CARL W. LENTZ IV, MBA, CCIM**

O: 386.566.3726

carl.lentz@svn.com

FL #BK3068067



PROPERTY SUMMARY

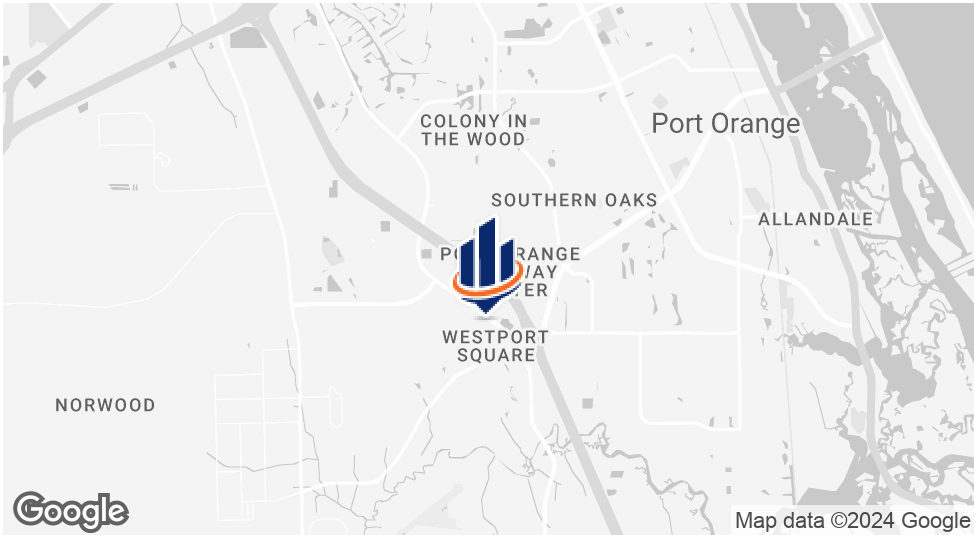

OFFERING SUMMARY

SALE PRICE:	Request From Broker
LEASE RATE:	\$19.00 SF/yr (NNN)
BUILDING SIZE:	3,330 SF
AVAILABLE SF:	3,330 - 10,330 SF
LOT SIZE:	2.5 Acres
YEAR BUILT:	2021
ZONING:	PC-A(Planned Community-AGR)

PROPERTY OVERVIEW

3,330 SF Brand New Office/Retail Adjacent to Halifax Health Offices  
Join HH Express Care, Primary Care, Pediatrics & Imaging  
Dimensions of Unit are 37' X 83' 4"  
Total Building Will Be 20,000 SF  
West of I-95 on Williamson Boulevard  
Directly Across Street From The Pavilion - Easy Access to I-95  
Corner of Williamson and Summer Trees Road- 19,000 VPD  
LandLord Buildout Available  
Currently Dirt Floors With Drywall  
Ample Parking - 6 per 1,000 Square Feet  
7,000 SF Expansion Opportunity  
Pass Through Expenses +/- \$9/SF-Includes Utilities

CARL W. LENTZ IV, MBA, CCIM  
O: 386.566.3726  
carl.lentz@svn.com  
FL #BK3068067

PORT ORANGE MEDICAL OFFICE, RETAIL, PROFESSIONAL SERVICES - 3,330 SF | 5440 S Williamson Blvd, Suite 5 Port Orange, FL 32128

We obtained the information above from sources we believe to be reliable. However, we have not verified its accuracy and make no guarantee, warranty or representation about it. It is submitted subject to the possibility of errors, omissions, change of price, rental or other conditions, prior sale, lease or financing, or withdrawal without notice. We include projections, opinions, assumptions or estimates for example only, and they may not represent current or future performance of the property. You and your tax and legal advisors should conduct your own investigation of the property and transaction. All SVN offices are independently owned and operated.



# SITE PLAN

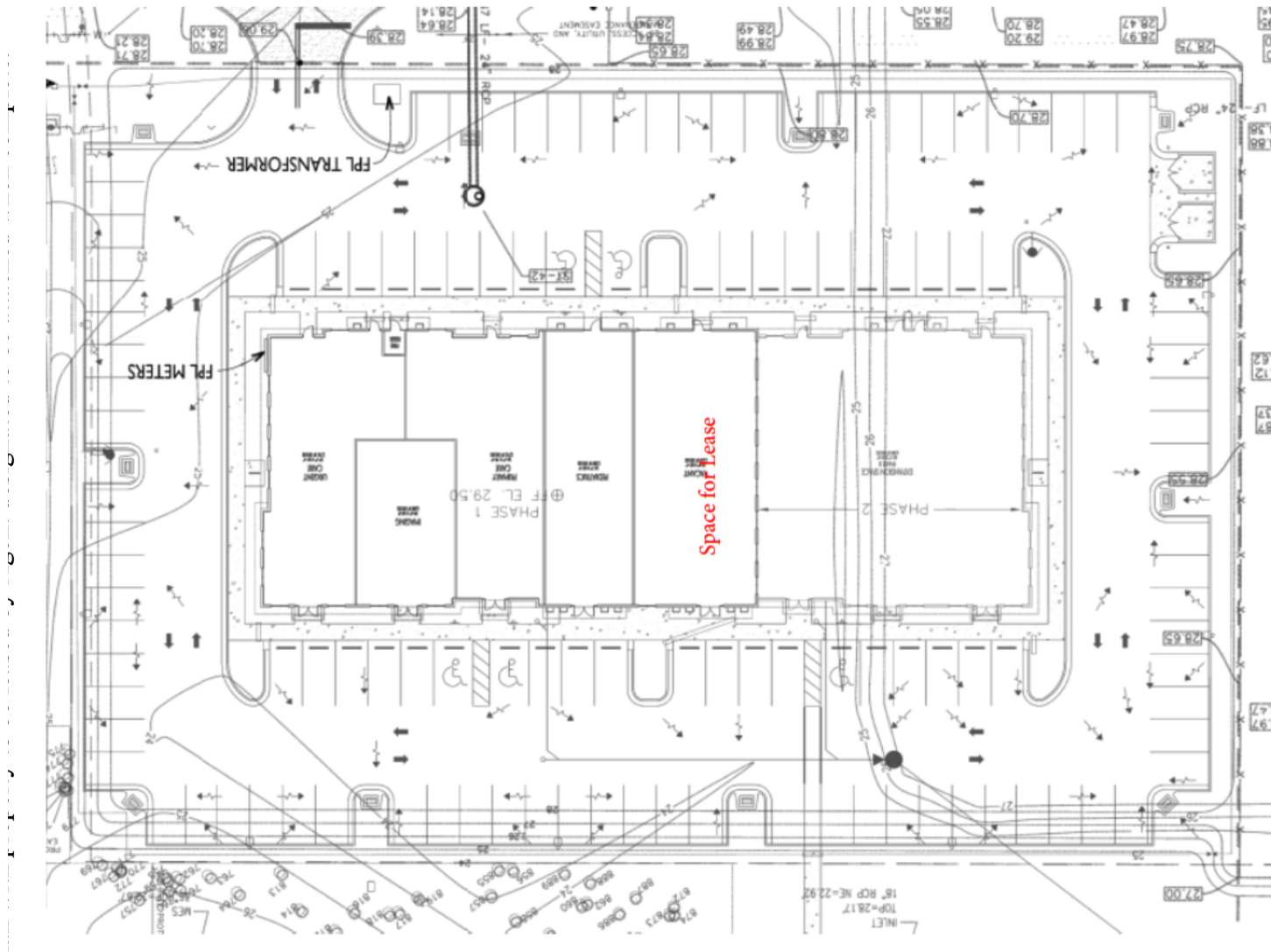

**CARL W. LENTZ IV, MBA, CCIM**

O: 386.566.3726

carl.lentz@svn.com

FL #BK3068067

**PORT ORANGE MEDICAL OFFICE, RETAIL, PROFESSIONAL SERVICES - 3,330 SF** | 5440 S Williamson Blvd, Suite 5 Port Orange, FL 32128

We obtained the information above from sources we believe to be reliable. However, we have not verified its accuracy and make no guarantee, warranty or representation about it. It is submitted subject to the possibility of errors, omissions, change of price, rental or other conditions, prior sale, lease or financing, or withdrawal without notice. We include projections, opinions, assumptions or estimates for example only, and they may not represent current or future performance of the property. You and your tax and legal advisors should conduct your own investigation of the property and transaction. All SVN offices are independently owned and operated.



## ADDITIONAL PHOTOS



**CARL W. LENTZ IV, MBA, CCIM**

O: 386.566.3726

carl.lentz@svn.com

FL #BK3068067

**PORT ORANGE MEDICAL OFFICE, RETAIL, PROFESSIONAL SERVICES - 3,330 SF** | 5440 S Williamson Blvd, Suite 5 Port Orange, FL 32128

We obtained the information above from sources we believe to be reliable. However, we have not verified its accuracy and make no guarantee, warranty or representation about it. It is submitted subject to the possibility of errors, omissions, change of price, rental or other conditions, prior sale, lease or financing, or withdrawal without notice. We include projections, opinions, assumptions or estimates for example only, and they may not represent current or future performance of the property. You and your tax and legal advisors should conduct your own investigation of the property and transaction. All SVN offices are independently owned and operated.





## ADDITIONAL PHOTOS



**CARL W. LENTZ IV, MBA, CCIM**

O: 386.566.3726

carl.lentz@svn.com

FL #BK3068067

**PORT ORANGE MEDICAL OFFICE, RETAIL, PROFESSIONAL SERVICES - 3,330 SF** | 5440 S Williamson Blvd, Suite 5 Port Orange, FL 32128

We obtained the information above from sources we believe to be reliable. However, we have not verified its accuracy and make no guarantee, warranty or representation about it. It is submitted subject to the possibility of errors, omissions, change of price, rental or other conditions, prior sale, lease or financing, or withdrawal without notice. We include projections, opinions, assumptions or estimates for example only, and they may not represent current or future performance of the property. You and your tax and legal advisors should conduct your own investigation of the property and transaction. All SVN offices are independently owned and operated.



RETAILER MAP



CARL W. LENTZ IV, MBA, CCIM  
O: 386.566.3726  
carl.lentz@svn.com  
FL #BK3068067

PORT ORANGE MEDICAL OFFICE, RETAIL, PROFESSIONAL SERVICES - 3,330 SF | 5440 S Williamson Blvd, Suite 5 Port Orange, FL 32128

We obtained the information above from sources we believe to be reliable. However, we have not verified its accuracy and make no guarantee, warranty or representation about it. It is submitted subject to the possibility of errors, omissions, change of price, rental or other conditions, prior sale, lease or financing, or withdrawal without notice. We include projections, opinions, assumptions or estimates for example only, and they may not represent current or future performance of the property. You and your tax and legal advisors should conduct your own investigation of the property and transaction. All SVN offices are independently owned and operated.



## LOCATION MAP

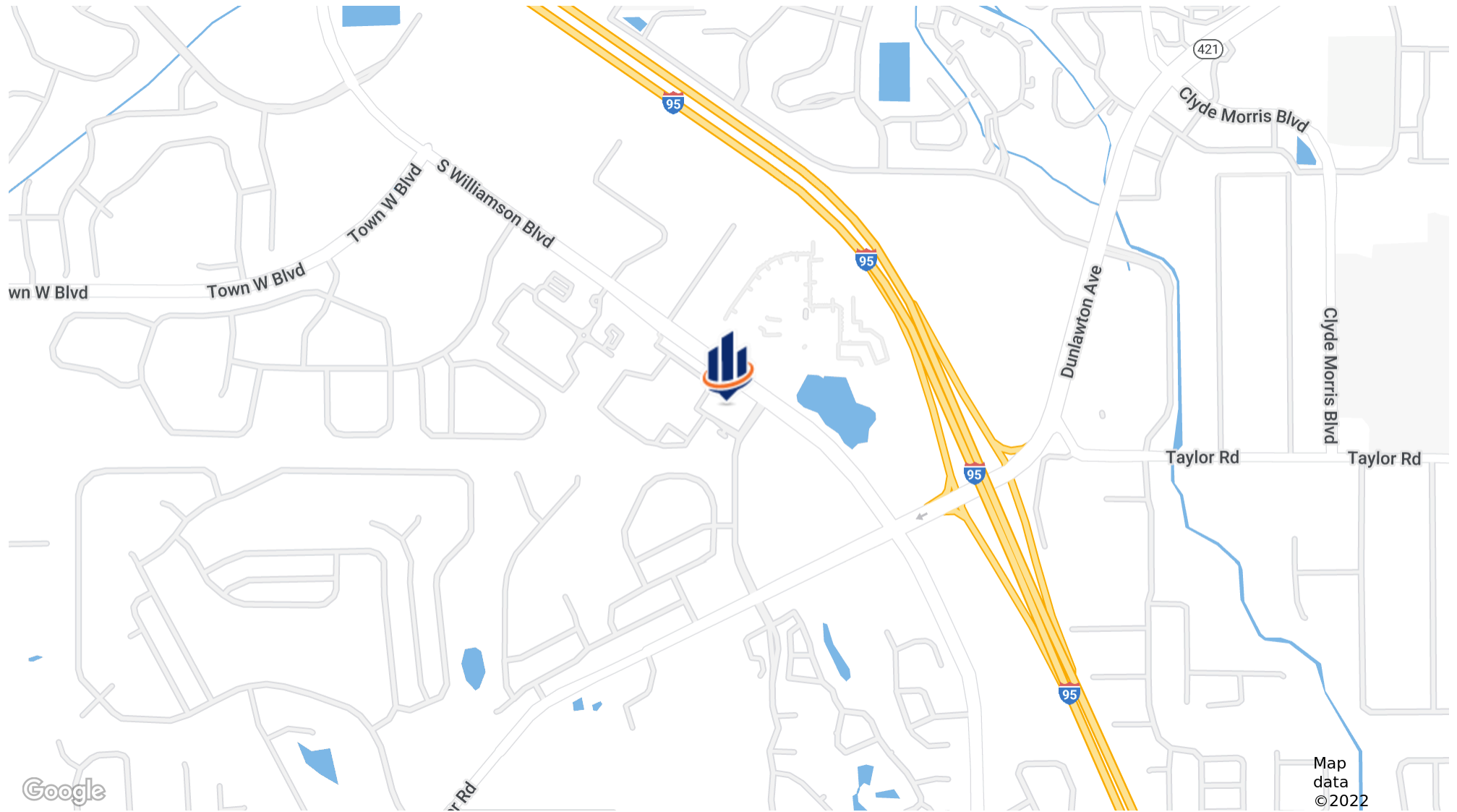

**CARL W. LENTZ IV, MBA, CCIM**

O: 386.566.3726

carl.lentz@svn.com

FL #BK3068067

**PORT ORANGE MEDICAL OFFICE, RETAIL, PROFESSIONAL SERVICES - 3,330 SF** | 5440 S Williamson Blvd, Suite 5 Port Orange, FL 32128

We obtained the information above from sources we believe to be reliable. However, we have not verified its accuracy and make no guarantee, warranty or representation about it. It is submitted subject to the possibility of errors, omissions, change of price, rental or other conditions, prior sale, lease or financing, or withdrawal without notice. We include projections, opinions, assumptions or estimates for example only, and they may not represent current or future performance of the property. You and your tax and legal advisors should conduct your own investigation of the property and transaction. All SVN offices are independently owned and operated.





# DEMOGRAPHICS MAP & REPORT

## POPULATION

	1 MILE	5 MILES	10 MILES
TOTAL POPULATION	3,355	93,414	202,656
AVERAGE AGE	47.9	46.6	43.8
AVERAGE AGE (MALE)	47.5	44.0	42.1
AVERAGE AGE (FEMALE)	47.6	48.9	45.5

## HOUSEHOLDS & INCOME

	1 MILE	5 MILES	10 MILES
TOTAL HOUSEHOLDS	1,490	39,806	85,519
# OF PERSONS PER HH	2.3	2.3	2.4
AVERAGE HH INCOME	\$63,308	\$59,223	\$53,108
AVERAGE HOUSE VALUE	\$375,868	\$224,893	\$247,754

\* Demographic data derived from 2020 ACS - US Census

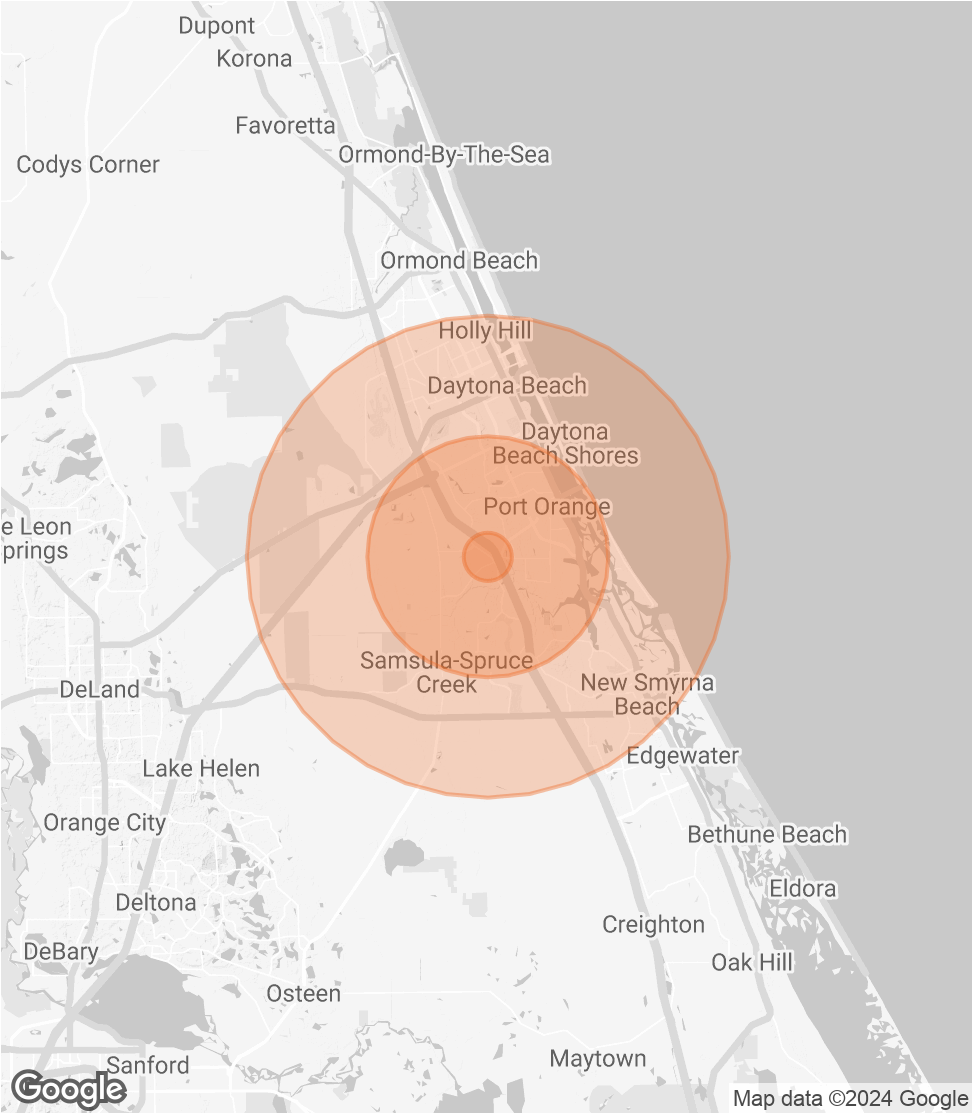

CARL W. LENTZ IV, MBA, CCIM

O: 386.566.3726

carl.lentz@svn.com

FL #BK3068067

PORT ORANGE MEDICAL OFFICE, RETAIL, PROFESSIONAL SERVICES - 3,330 SF | 5440 S Williamson Blvd, Suite 5 Port Orange, FL 32128

We obtained the information above from sources we believe to be reliable. However, we have not verified its accuracy and make no guarantee, warranty or representation about it. It is submitted subject to the possibility of errors, omissions, change of price, rental or other conditions, prior sale, lease or financing, or withdrawal without notice. We include projections, opinions, assumptions or estimates for example only, and they may not represent current or future performance of the property. You and your tax and legal advisors should conduct your own investigation of the property and transaction. All SVN offices are independently owned and operated.

