

NOTE:

-LEASE AREA CALCULATION IS BASED ON
BOMA MEASUREMENT STANDARDS.

-FLOOR TO UNDERSIDE OF STRUCTURE IS
ABOVE IS 14'-0" +/-, FIELD VERIFY.

-ALL DIMENSIONS & NOTES SHOWN ARE FIELD VERIFIED.
VERIFY ALL CONDITIONS & MATERIALS NOT RECORDED.

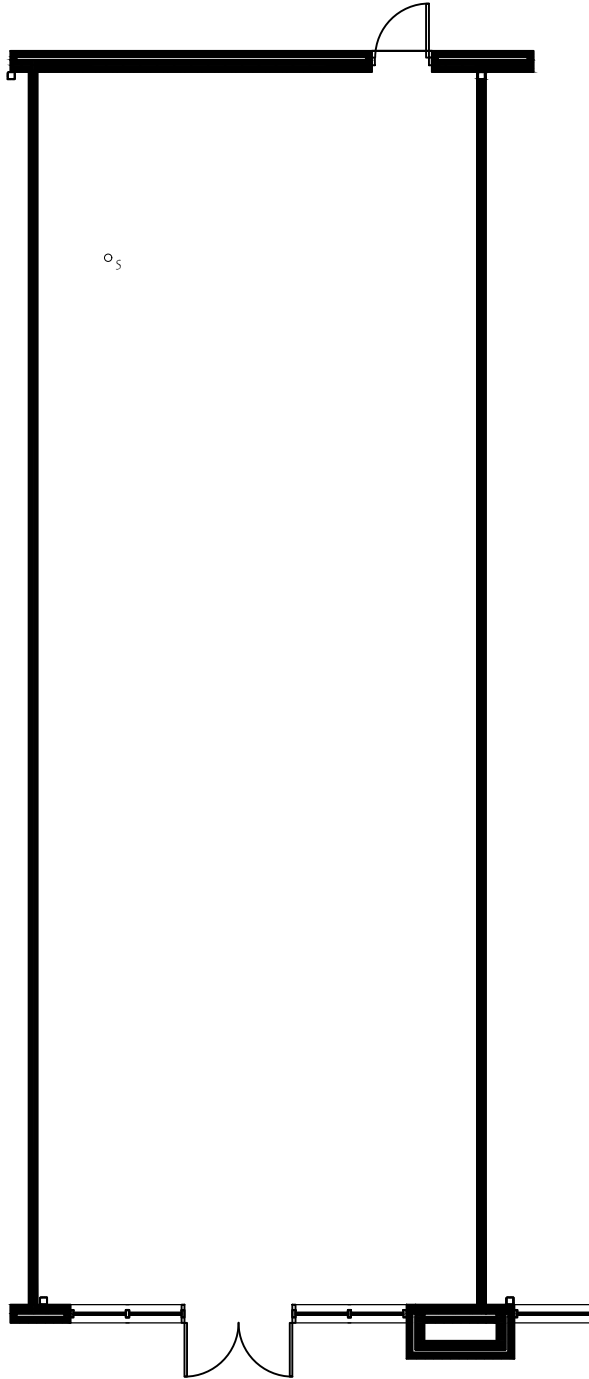

NORTH/EAST PARKING LOT FRONTAGE

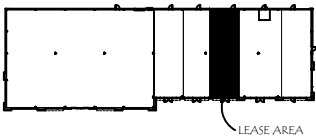

KEY PLAN



BLOSSOM PARK COMMONS
SUITE "D" - FLOOR PLAN
240 BLOSSOM PARK DR. GEORGETOWN, KY 40324
LEASE AREA: 1,736 SQ. FT.



11/29/21