



LEASE
Rockville Center

600 SOUTH STATE ROAD

Marysville, PA 17053

PRESENTED BY:

LAURA MARTIN, CCIM, CPM

O: 717.737.2422 x1001

laura.martin@svn.com

PA #RM419784



PROPERTY SUMMARY



OFFERING SUMMARY

LEASE RATE:	\$1,000.00 per month (MG)
BUILDING SIZE:	30,000 SF
AVAILABLE SF:	600 SF
LOT SIZE:	1.52 Acres
ZONING:	C-2 Commercial
MARKET:	Central Pennsylvania
TRAFFIC COUNT:	19,170

LAURA MARTIN, CCIM, CPM
O: 717.737.2422 x1001
laura.martin@svn.com
PA #RM419784

ROCKVILLE CENTER | 600 South State Road Marysville, PA 17053

We obtained the information above from sources we believe to be reliable. However, we have not verified its accuracy and make no guarantee, warranty or representation about it. It is submitted subject to the possibility of errors, omissions, change of price, rental or other conditions, prior sale, lease or financing, or withdrawal without notice. We include projections, opinions, assumptions or estimates for example only, and they may not represent current or future performance of the property. You and your tax and legal advisors should conduct your own investigation of the property and transaction. All SVN offices are independently owned and operated.

PROPERTY OVERVIEW

One suite remaining for lease in the Rockville Center, located on the highly traveled Route 15 in Marysville, PA.

PROPERTY HIGHLIGHTS

- Lower-Level Suite – 600 SF potential office suite or salon
- Brand new store front space
- Great frontage & visibility - faces Route 15
- Plus electric, janitorial & sewer
- Join existing tenants – Dollar General, Susquehanna Beer & Soda, Liquid Noise Brewing Co & State Farm
- Last space available

ADDITIONAL PHOTOS



LAURA MARTIN, CCIM, CPM

O: 717.737.2422 x1001

laura.martin@svn.com

PA #RM419784

ROCKVILLE CENTER | 600 South State Road Marysville, PA 17053

SVN | LATUS 3

We obtained the information above from sources we believe to be reliable. However, we have not verified its accuracy and make no guarantee, warranty or representation about it. It is submitted subject to the possibility of errors, omissions, change of price, rental or other conditions, prior sale, lease or financing, or withdrawal without notice. We include projections, opinions, assumptions or estimates for example only, and they may not represent current or future performance of the property. You and your tax and legal advisors should conduct your own investigation of the property and transaction. All SVN offices are independently owned and operated.

SUITE 105 & SUITE 106

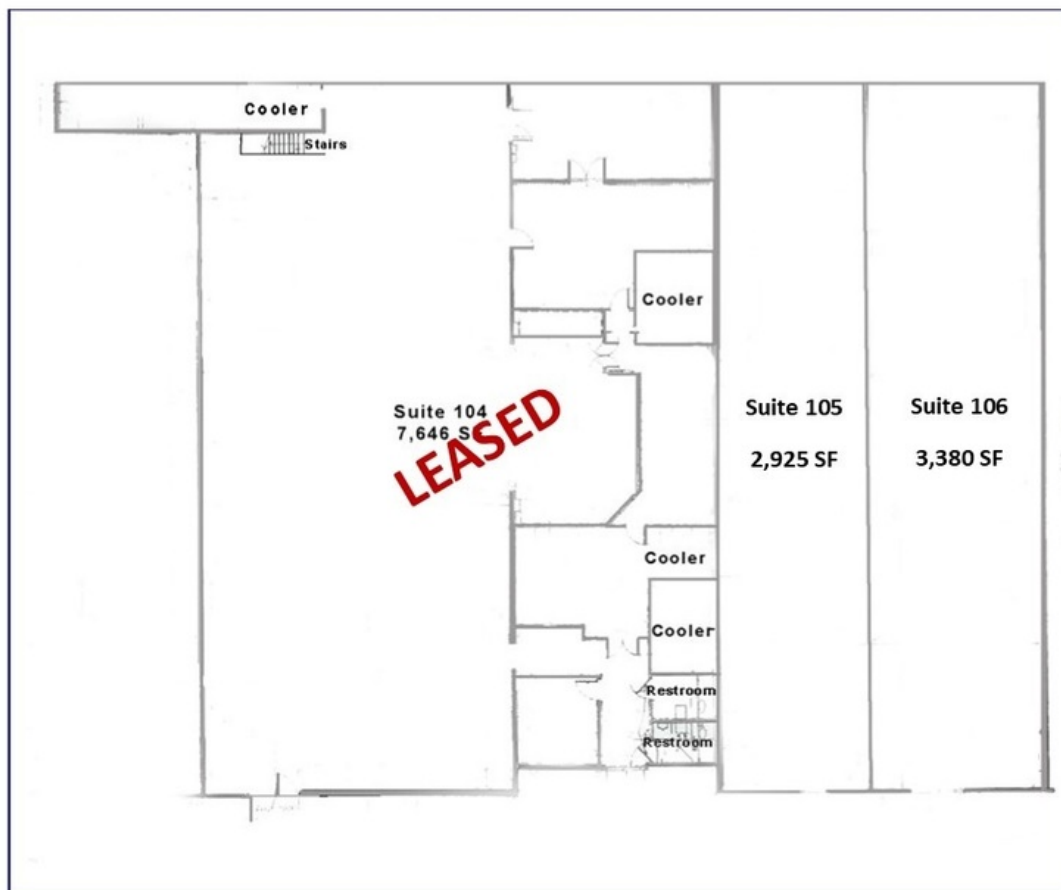

Suites 105 & 106

Note: Not drawn to scale

LAURA MARTIN, CCIM, CPM

O: 717.737.2422 x1001

laura.martin@svn.com

PA #RM419784

ROCKVILLE CENTER | 600 South State Road Marysville, PA 17053

SVN | LATUS

4

We obtained the information above from sources we believe to be reliable. However, we have not verified its accuracy and make no guarantee, warranty or representation about it. It is submitted subject to the possibility of errors, omissions, change of price, rental or other conditions, prior sale, lease or financing, or withdrawal without notice. We include projections, opinions, assumptions or estimates for example only, and they may not represent current or future performance of the property. You and your tax and legal advisors should conduct your own investigation of the property and transaction. All SVN offices are independently owned and operated.

LOCATION MAP



LAURA MARTIN, CCIM, CPM
O: 717.737.2422 x1001
laura.martin@svn.com
PA #RM419784

ROCKVILLE CENTER | 600 South State Road Marysville, PA 17053

SVN | LATUS 5

We obtained the information above from sources we believe to be reliable. However, we have not verified its accuracy and make no guarantee, warranty or representation about it. It is submitted subject to the possibility of errors, omissions, change of price, rental or other conditions, prior sale, lease or financing, or withdrawal without notice. We include projections, opinions, assumptions or estimates for example only, and they may not represent current or future performance of the property. You and your tax and legal advisors should conduct your own investigation of the property and transaction. All SVN offices are independently owned and operated.

DEMOGRAPHICS MAP & REPORT

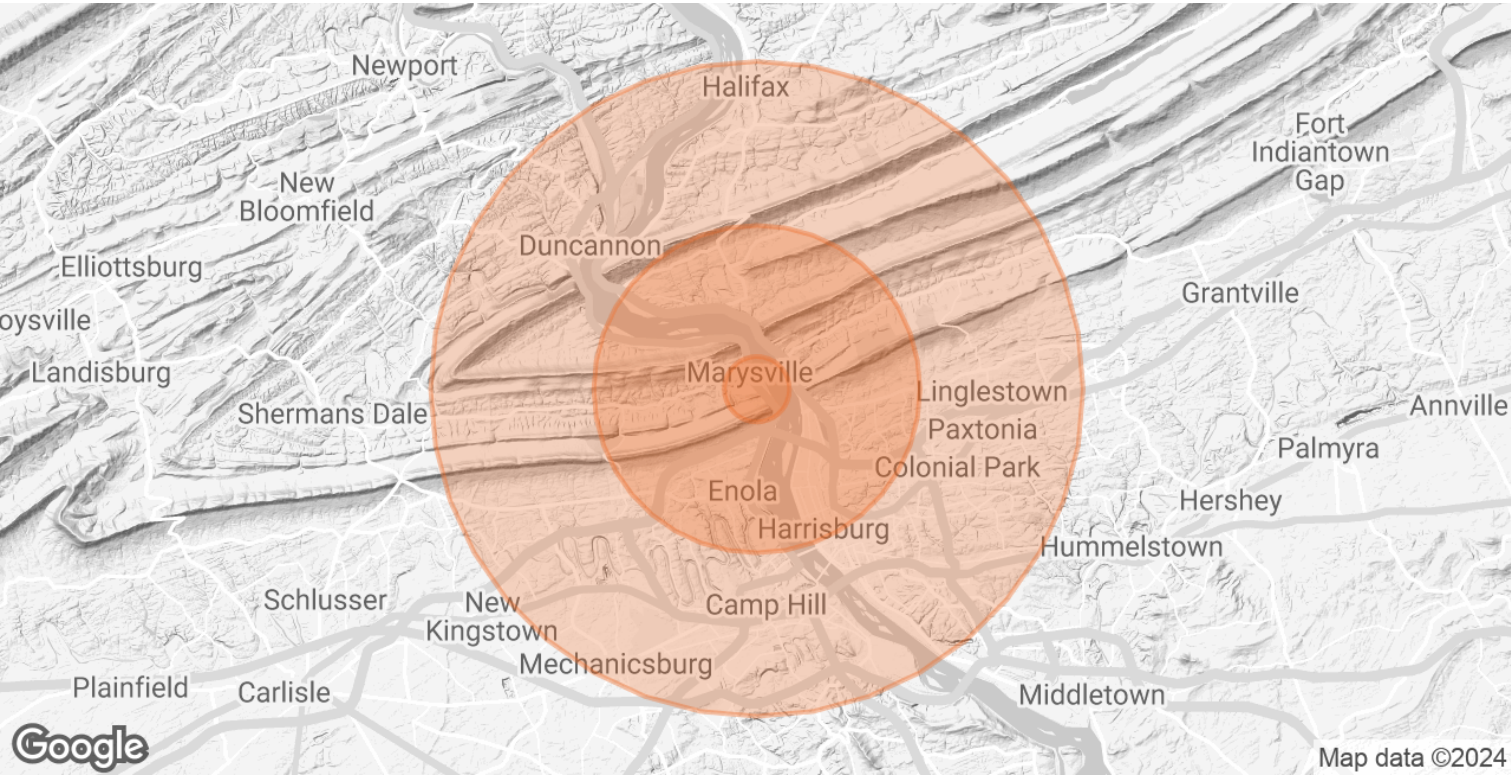

POPULATION	1 MILE	5 MILES	10 MILES
TOTAL POPULATION	1,138	65,380	310,859
AVERAGE AGE	42.5	38.0	39.4
AVERAGE AGE (MALE)	41.8	36.9	37.6
AVERAGE AGE (FEMALE)	43.0	38.6	40.3

HOUSEHOLDS & INCOME	1 MILE	5 MILES	10 MILES
TOTAL HOUSEHOLDS	499	26,947	130,873
# OF PERSONS PER HH	2.3	2.4	2.4
AVERAGE HH INCOME	\$75,478	\$68,822	\$67,694
AVERAGE HOUSE VALUE	\$180,029	\$168,569	\$174,233

* Demographic data derived from 2020 ACS - US Census

LAURA MARTIN, CCIM, CPM
O: 717.737.2422 x1001
laura.martin@svn.com
PA #RM419784

We obtained the information above from sources we believe to be reliable. However, we have not verified its accuracy and make no guarantee, warranty or representation about it. It is submitted subject to the possibility of errors, omissions, change of price, rental or other conditions, prior sale, lease or financing, or withdrawal without notice. We include projections, opinions, assumptions or estimates for example only, and they may not represent current or future performance of the property. You and your tax and legal advisors should conduct your own investigation of the property and transaction. All SVN offices are independently owned and operated.