

# RETAIL/FLEX FOR LEASE



## OFFERING SUMMARY

Lease Rate: N/A

Building Size: 57,693 SF

Available SF:

Zoning: CR-3

## PROPERTY OVERVIEW

approximately 6,325 square feet on the first floor with loading dock and approximately 3,000 square feet on the second floor mezzanine with expansive windows, many uses are possible. City of San Bernardino: CR-3 (COMMERCIAL REGIONAL-TRI-CITY-CLUB) ZONE This zone is intended to permit a diversity of regional-serving uses including corporate and professional offices, retail commercial, entertainment (theaters, nightclubs, etc.), financial establishments, restaurants, hotels-motels, warehouse-promotional retail, supporting retail and services, and similar uses. (Ord. MC-1436, 12-21-16; Ord. MC-1098, 6-05-01)

## LOCATION OVERVIEW

at the intersection of West Hospitality Lane and South E Street - conveniently located adjacent to the intersection of I-10 and I-215 within a larger multi-tenant flex business park environment with fitness center, church and billiard club.

## PROPERTY HIGHLIGHTS

- low lease rate
- street and freeway visibility
- pole and building signage available
- call to show

**STEVEN D. ROPPEL**

909.297.0881  
sroppe@gmail.com  
CalDRE #01151111



# INTERIOR PHOTO - SITE PLAN

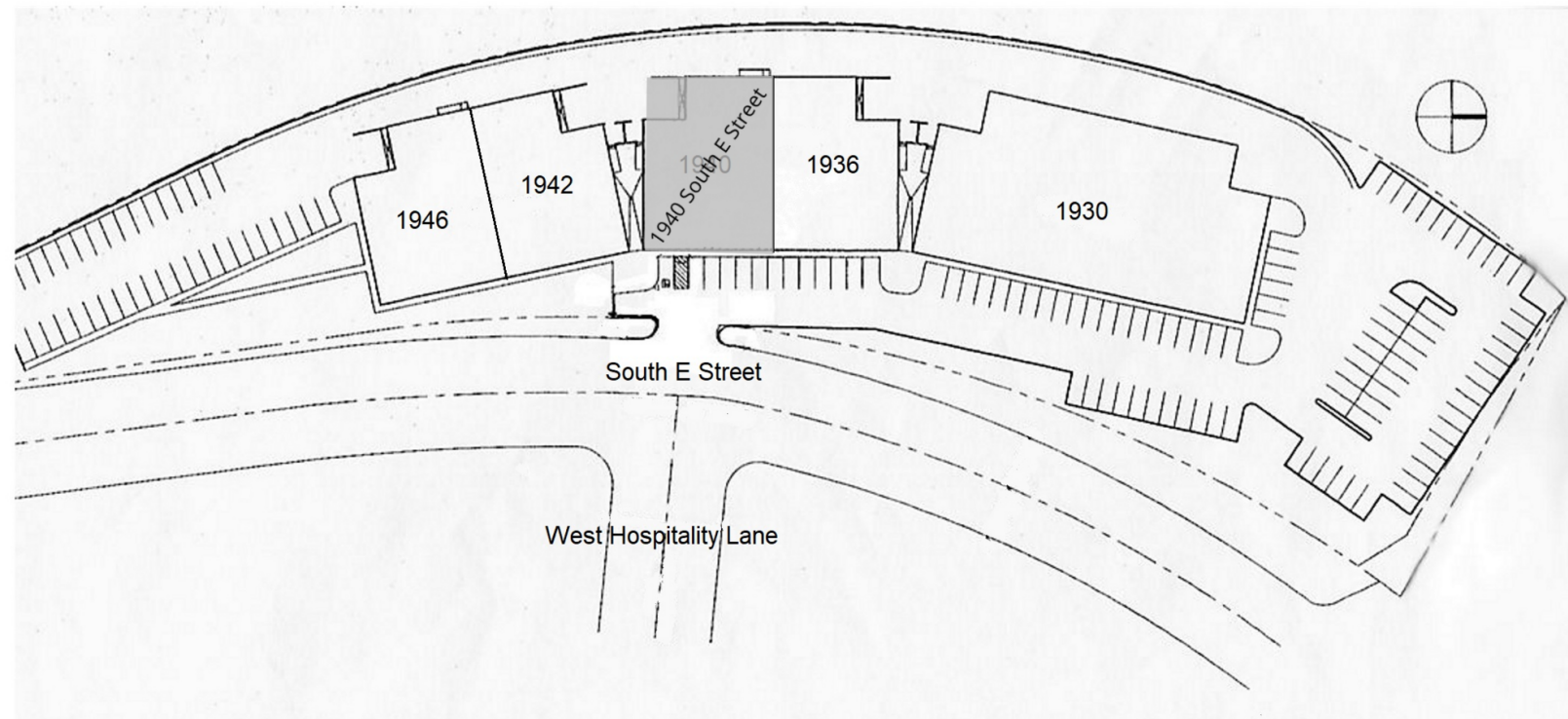

**STEVEN D. ROPPEL**

909.297.0881

sroppe@gmail.com

CalDRE #01151111





1940 SOUTH E STREET // San Bernardino, CA 92408

# LOCATION MAP

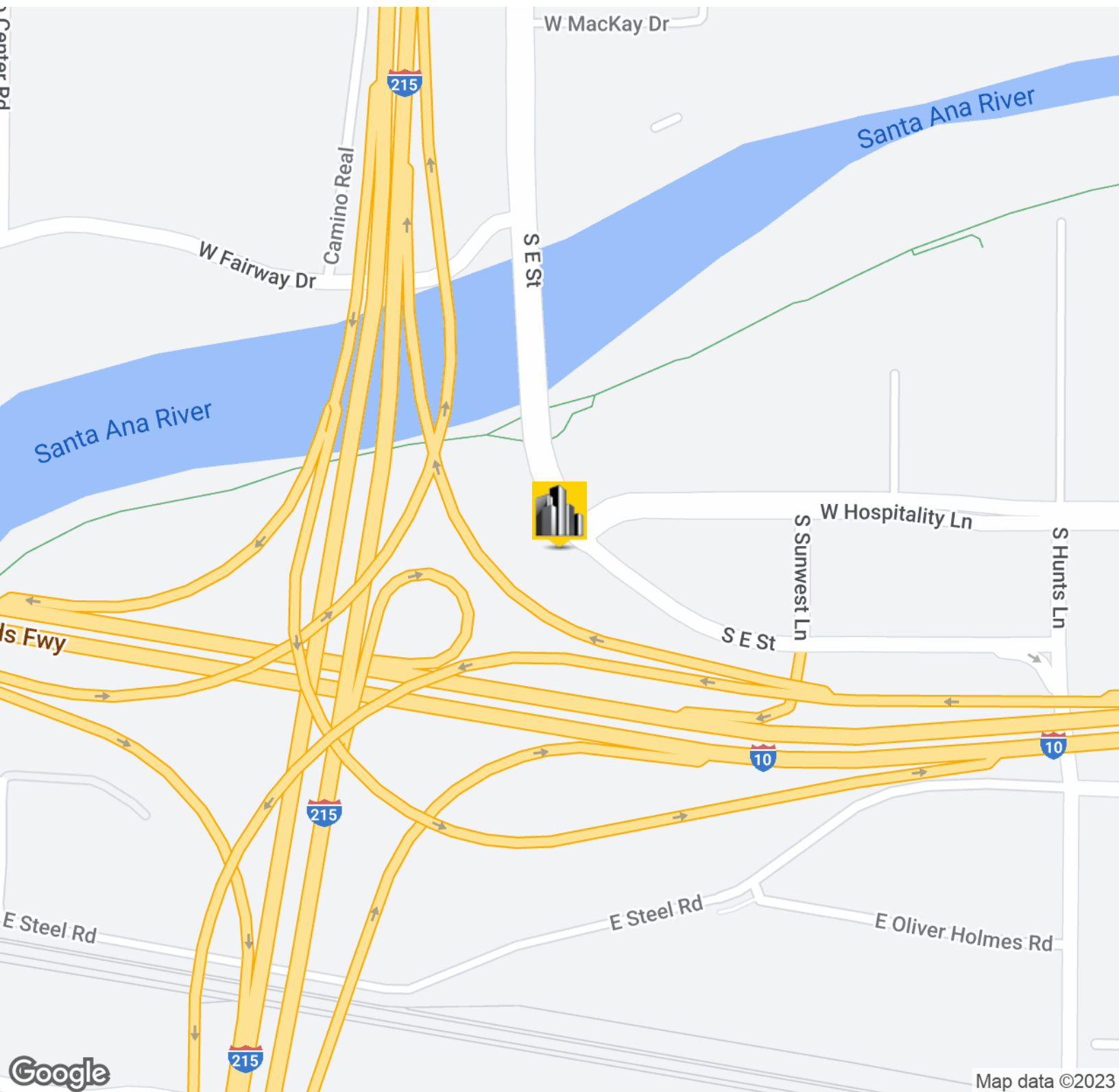

**STEVEN D. ROPPEL**

909.297.0881

sroppe@gmail.com

CalDRE #01151111



9327 Fairway View Place, Suite 300 // Rancho Cucamonga, CA 91730 // 909.786.4300 // [alliedcommercialrealestate.com](http://alliedcommercialrealestate.com)

**COMMERCIAL REAL ESTATE**

The information above has been obtained from sources believed reliable. While we do not doubt its accuracy we have not verified it and make no guarantee, warranty or representation about it. It is your responsibility to independently confirm its accuracy and completeness. Any projections, opinions, assumptions, or estimates used are for example only and do not represent the current or future performance of the property. The value of this transaction to you depends on tax and other factors which should be evaluated by your tax, financial, and legal advisors. You and your advisors should conduct a careful, independent investigation of the property to determine to your satisfaction the suitability of the property for your needs.

# DEMOGRAPHICS MAP & REPORT

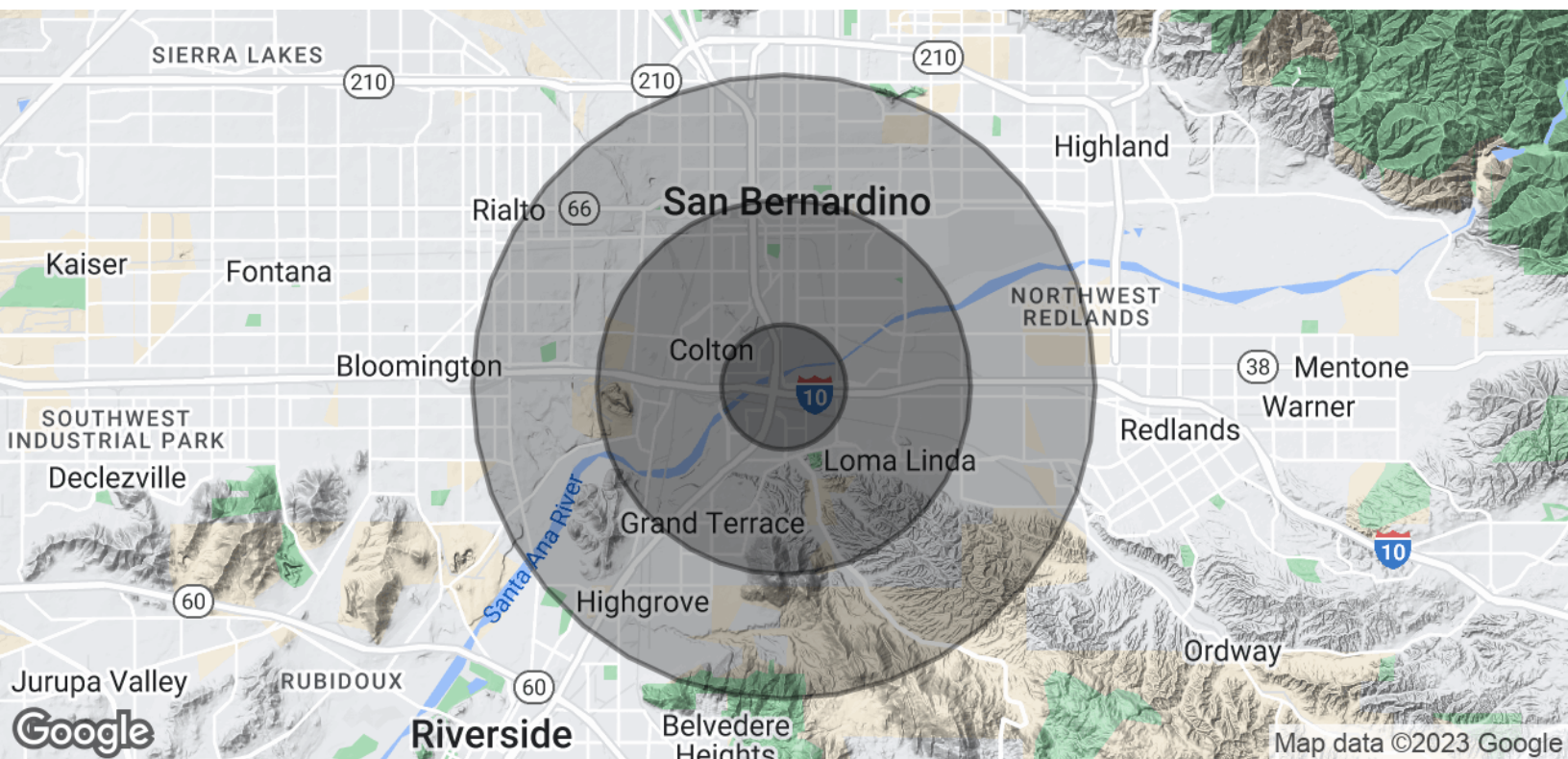

POPULATION	1 MILE	3 MILES	5 MILES
Total Population	7,669	75,245	226,183
Average Age	32.9	34.0	32.2
Average Age (Male)	31.3	33.8	31.7
Average Age (Female)	36.2	34.8	32.9

HOUSEHOLDS & INCOME	1 MILE	3 MILES	5 MILES
Total Households	2,492	26,855	72,084
# of Persons per HH	3.1	2.8	3.1
Average HH Income	\$76,480	\$61,155	\$60,670
Average House Value	\$393,790	\$312,536	\$299,651

\* Demographic data derived from 2020 ACS - US Census

STEVEN D. ROPPEL

909.297.0881  
sroppe@gmail.com  
CalDRE #01151111

