

619 EAST SAM HOUSTON PARKWAY S., SUITE 200

PASADENA, TX 77503



33,280 SF | FOR LEASE

Energy Commerce Business Park is a 287,560 square foot, two building development located in Pasadena, Texas at Beltway 8 and Highway 225. Building B is a cross-dock facility with an ESFR sprinkler system. This property's location boasts excellent access to Beltway 8, Hwy 225, and is in close proximity to the Port of Houston.

PROPERTY SPECIFICATIONS

| | |
|----------------------|-------------------|
| Available Space: | 33,280 SF |
| Office Space: | 1,598 SF |
| Total Building Size: | 199,680 SF |
| Submarket: | Southeast Houston |
| Ceiling Height: | 32' |
| Dock High Doors: | 10 |
| Ramps: | 1 |
| Sprinklers: | ESFR |

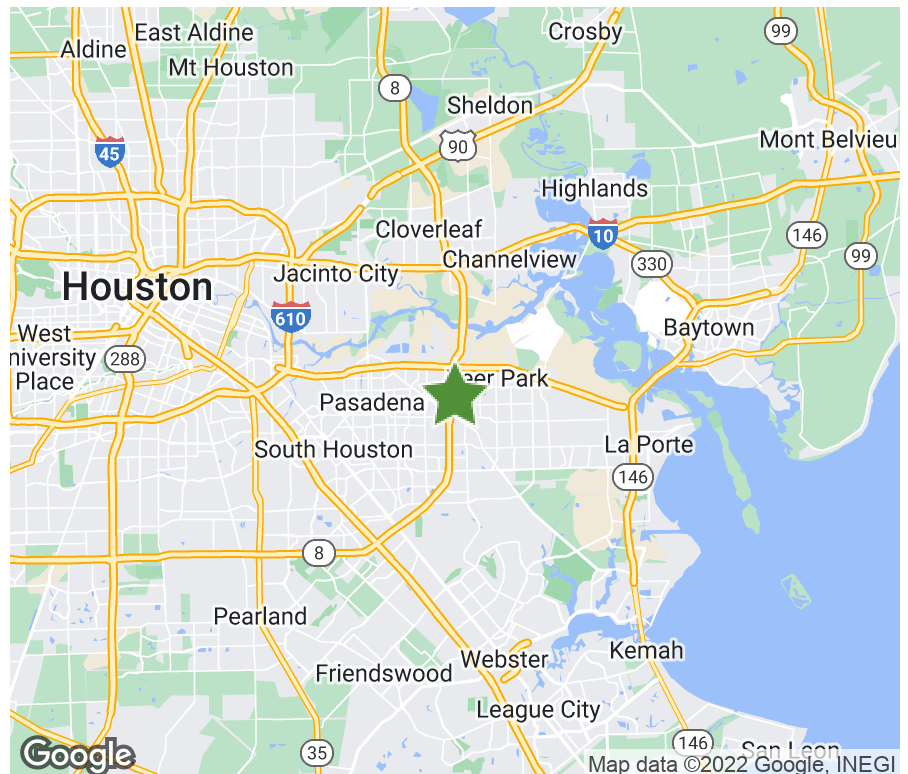

619 EAST SAM HOUSTON PARKWAY S., SUITE 200

33,280 SF | FOR LEASE

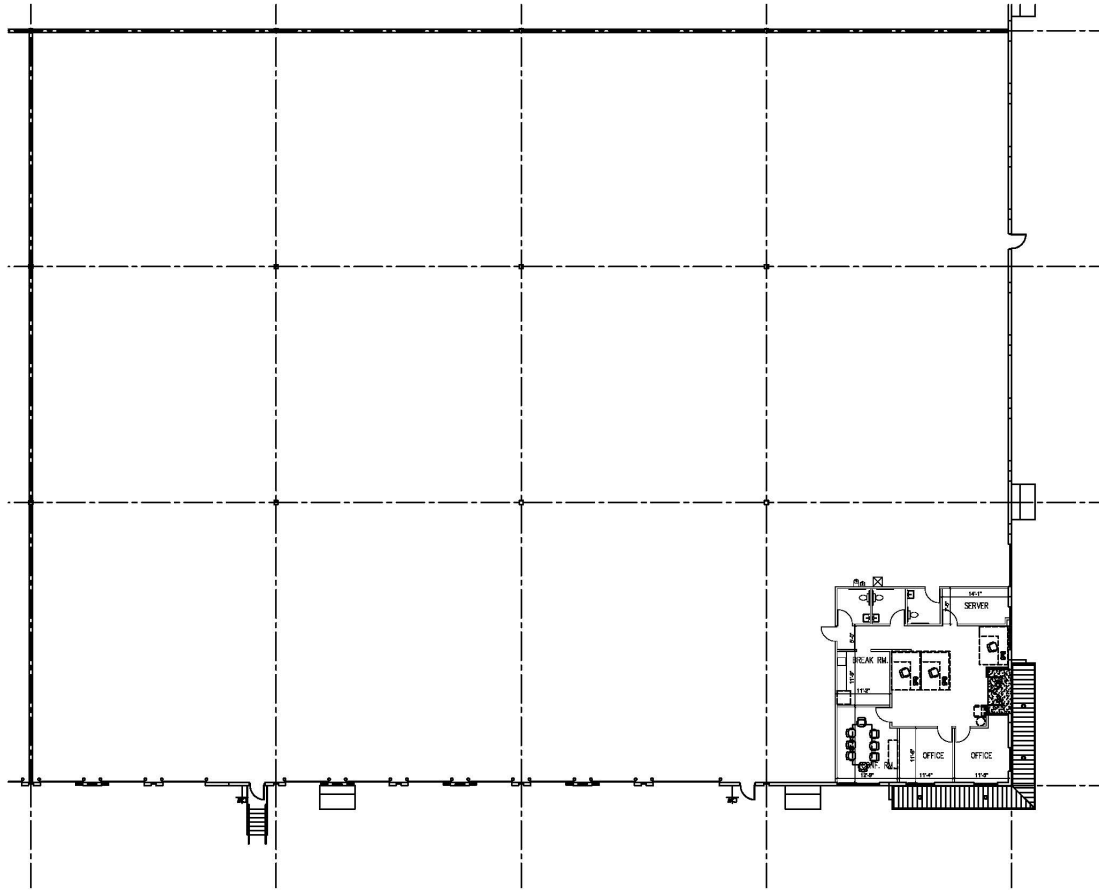

BROKER CONTACT

Holden Rushing

NAI Partners Houston

713.275.9612

holden.rushing@naipartners.com



OWNER CONTACT

Brad Kluever

Regional Director

312.344.4347

bkluever@firstindustrial.com

