

Premiere Warehouse District Retail  
700 Magazine St New Orleans, LA 70130

EXECUTIVE SUMMARY



Offering Summary

Lease Rate:	Negotiable
Building Size:	70,000 SF
Available SF:	
Year Built:	2018
Market:	New Orleans-Metairie

Property Highlights

**Beau Box, SIOR**     **Matthew Pittman, CCIM**  
225.931.3200     504.322.1275  
bbox@beaubox.com     mpittman@beaubox.com

Broker of Record, Beau J. Box; Licensed by the Louisiana Real Estate Commission, Mississippi Real Estate Commission, Alabama Real Estate Commission and Florida Real Estate Commission, USA. This information has been secured from sources we believe to be reliable, but we make no representations or warranties, expressed or implied, as to the accuracy of the information. References to square footage or age are approximate. Buyer must verify the information and bears all risk for any inaccuracies. © Beau Box Commercial Real Estate. 5500 Bankers Avenue, Baton Rouge, LA 70808 | 225-237-3343. | January 09, 2024





# Premiere Warehouse District Retail

700 Magazine St New Orleans, LA 70130

## LOCATION MAP

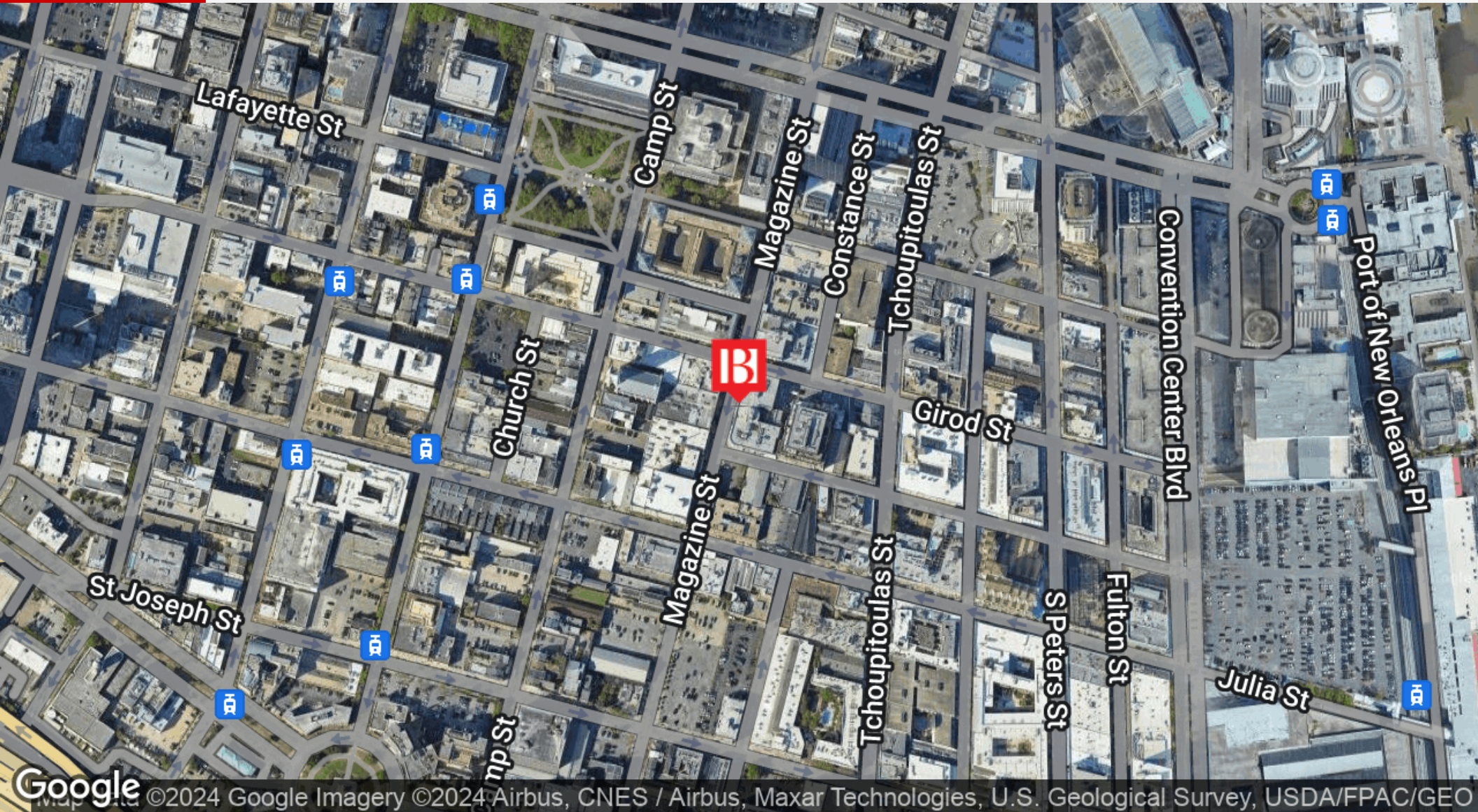

**Beau Box, SIOR**   **Matthew Pittman, CCIM**  
225.931.3200   504.322.1275  
bbox@beaubox.com   mpittman@beaubox.com

Broker of Record, Beau J. Box; Licensed by the Louisiana Real Estate Commission, Mississippi Real Estate Commission, Alabama Real Estate Commission and Florida Real Estate Commission, USA. This information has been secured from sources we believe to be reliable, but we make no representations or warranties, expressed or implied, as to the accuracy of the information. References to square footage or age are approximate. Buyer must verify the information and bears all risk for any inaccuracies. © Beau Box Commercial Real Estate. 5500 Bankers Avenue, Baton Rouge, LA 70808 | 225-237-3343. | January 09, 2024





# Premiere Warehouse District Retail

700 Magazine St New Orleans, LA 70130

## SITE PLAN

### HATCH LEGEND

UNIT AREA	L.C.E. SERVING RETAIL SPACE
RETAIL A	
RETAIL B	
RETAIL C	

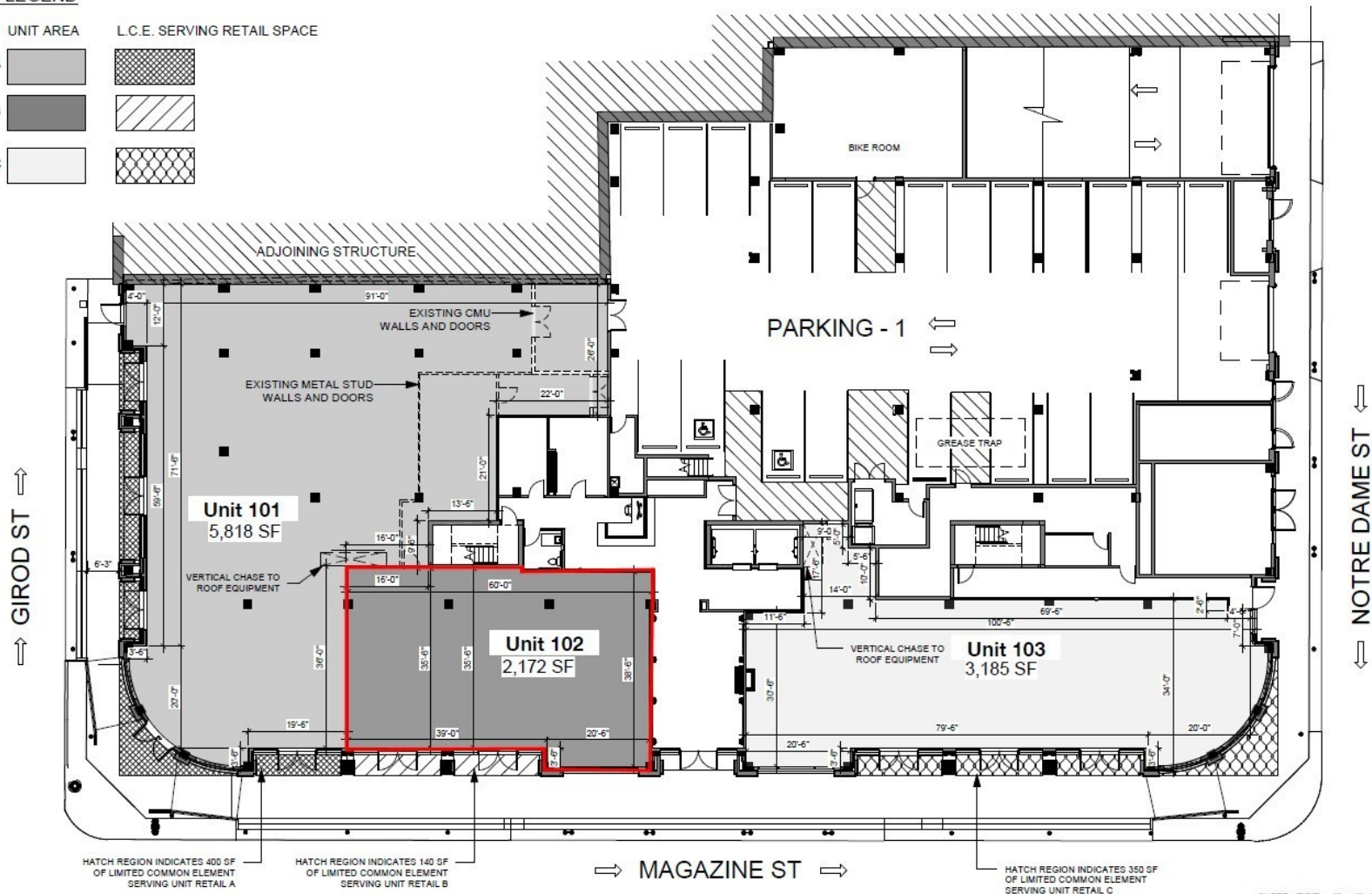

1ST FLOOR RETAIL

**RW** ROZAS WARD  
architects

ARE FOOTAGE NUMBERS AND DIMENSIONS DEPICTED ARE APPROXIMATE.  
FOOTAGE NUMBERS EQUAL THE INTERIOR PAINT TO PAINT AREA.  
NOTION DEPICTED IS FOR INFORMATIONAL PURPOSES ONLY.

**Beau Box, SIOR** **Matthew Pittman, CCIM**  
225.931.3200 504.322.1275  
bbox@beaubox.com mpittman@beaubox.com

Broker of Record, Beau J. Box; Licensed by the Louisiana Real Estate Commission, Mississippi Real Estate Commission, Alabama Real Estate Commission and Florida Real Estate Commission, USA. This information has been secured from sources we believe to be reliable, but we make no representations or warranties, expressed or implied, as to the accuracy of the information. References to square footage or age are approximate. Buyer must verify the information and bears all risk for any inaccuracies. © Beau Box Commercial Real Estate. 5500 Bankers Avenue, Baton Rouge, LA 70808 | 225-237-3343. | January 09, 2024

**BB**  
BEAU BOX  
REAL ESTATE



# Premiere Warehouse District Retail

700 Magazine St New Orleans, LA 70130

## EXTERIOR PHOTOS



**Beau Box, SIOR**    **Matthew Pittman, CCIM**  
225.931.3200    504.322.1275  
bbox@beaubox.com    mpittman@beaubox.com

Broker of Record, Beau J. Box; Licensed by the Louisiana Real Estate Commission, Mississippi Real Estate Commission, Alabama Real Estate Commission and Florida Real Estate Commission, USA. This information has been secured from sources we believe to be reliable, but we make no representations or warranties, expressed or implied, as to the accuracy of the information. References to square footage or age are approximate. Buyer must verify the information and bears all risk for any inaccuracies. © Beau Box Commercial Real Estate. 5500 Bankers Avenue, Baton Rouge, LA 70808 | 225-237-3343. | January 09, 2024





# Premiere Warehouse District Retail

700 Magazine St New Orleans, LA 70130

## INTERIOR PHOTOS



**Beau Box, SIOR**    **Matthew Pittman, CCIM**  
225.931.3200    504.322.1275  
bbox@beaubox.com    mpittman@beaubox.com

Broker of Record, Beau J. Box; Licensed by the Louisiana Real Estate Commission, Mississippi Real Estate Commission, Alabama Real Estate Commission and Florida Real Estate Commission, USA. This information has been secured from sources we believe to be reliable, but we make no representations or warranties, expressed or implied, as to the accuracy of the information. References to square footage or age are approximate. Buyer must verify the information and bears all risk for any inaccuracies. © Beau Box Commercial Real Estate. 5500 Bankers Avenue, Baton Rouge, LA 70808 | 225-237-3343. | January 09, 2024





# Premiere Warehouse District Retail

## 700 Magazine St New Orleans, LA 70130

### DEMOGRAPHICS MAP & REPORT

Population	1 Mile	3 Miles	5 Miles
Total Population	10,925	147,126	327,067
Average Age	41.3	37.0	36.7
Average Age (Male)	40.4	36.5	35.6
Average Age (Female)	41.5	38.2	37.8

Households & Income	1 Mile	3 Miles	5 Miles
Total Households	6,234	63,344	131,500
# Of Persons Per HH	1.8	2.3	2.5
Average HH Income	\$72,958	\$53,667	\$58,694
Average House Value	\$333,532	\$242,108	\$255,119

\* Demographic data derived from 2020 ACS - US Census

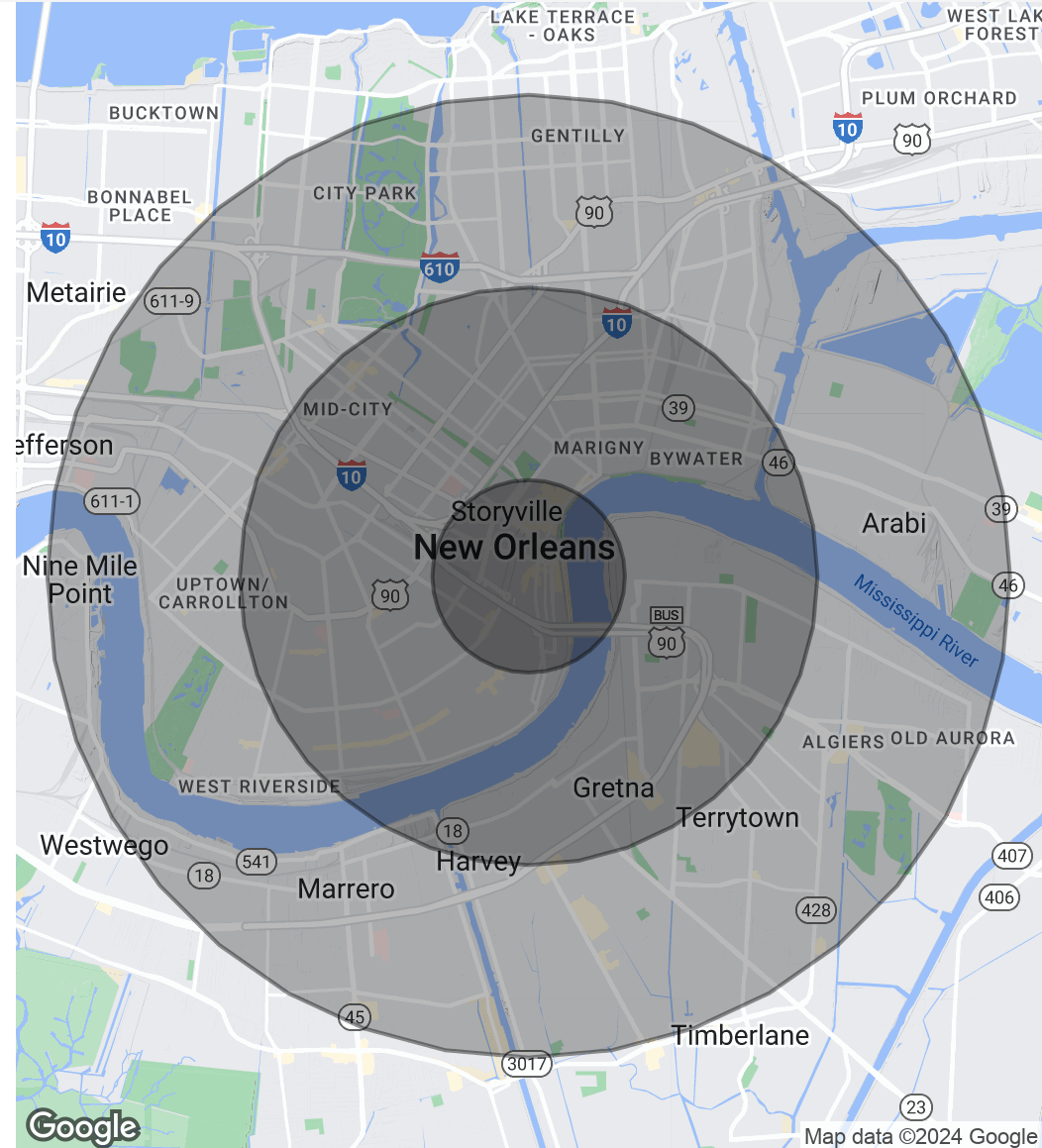

**Beau Box, SIOR**    **Matthew Pittman, CCIM**  
 225.931.3200    504.322.1275  
 bbox@beaubox.com    mpittman@beaubox.com

Broker of Record, Beau J. Box; Licensed by the Louisiana Real Estate Commission, Mississippi Real Estate Commission, Alabama Real Estate Commission and Florida Real Estate Commission, USA. This information has been secured from sources we believe to be reliable, but we make no representations or warranties, expressed or implied, as to the accuracy of the information. References to square footage or age are approximate. Buyer must verify the information and bears all risk for any inaccuracies. © Beau Box Commercial Real Estate. 5500 Bankers Avenue, Baton Rouge, LA 70808 | 225-237-3343. | January 09, 2024

