

For Lease

1000 SF-2,800 SF | \$24-\$33 SF/yr

* NNN Retail Space



852 Main St

Oak Ridge, Tennessee 37830

Property Highlights

- New construction
- Convenient location
- Abundant Parking
- Consumers with discretionary income.

Amenities

- Grease Trap

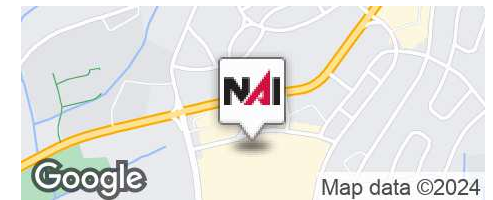

Lease Rate:

\$27.00 SF/vr (NNN)

For More Information

Justin Sterling

O: 865 531 6400

jsterling@koellamoore.com

Lauren Gabel

O: 865 531 6400

lgabel@koellamoore.com | TN #13164228





NO WARRANTY OR REPRESENTATION, EXPRESS OR IMPLIED, IS MADE AS TO THE ACCURACY OF THE INFORMATION CONTAINED HEREIN, AND THE SAME IS SUBMITTED SUBJECT TO ERRORS, OMISSIONS, CHANGE OF PRICE, RENTAL OR OTHER CONDITIONS, PRIOR SALE, LEASE OR FINANCING, WITHDRAWAL WITHOUT NOTICE, OR ANY SPECIAL LISTING CONDITIONS IMPOSED BY OUR PRINCIPALS. NO WARRANTIES OR REPRESENTATIONS ARE MADE AS TO THE CONDITION OF THE PROPERTY OR ANY HAZARDS CONTAINED THEREIN. UNLESS THERE IS AN AGREEMENT STIPULATING OTHERWISE, THE AFFILIATE BROKERS OR BROKERS NAMED WITHIN REPRESENT THE OWNER OR LANDLORD.

255 N Peters Road, Suite 101
Knoxville, TN 37923
865 531 6400 tel
koellamoore.com



NO WARRANTY OR REPRESENTATION, EXPRESS OR IMPLIED, IS MADE AS TO THE ACCURACY OF THE INFORMATION CONTAINED HEREIN, AND THE SAME IS SUBMITTED SUBJECT TO ERRORS, OMISSIONS, CHANGE OF PRICE, RENTAL OR OTHER CONDITIONS, PRIOR SALE, LEASE OR FINANCING, WITHDRAWAL WITHOUT NOTICE, OR ANY SPECIAL LISTING CONDITIONS IMPOSED BY OUR PRINCIPALS. NO WARRANTIES OR REPRESENTATIONS ARE MADE AS TO THE CONDITION OF THE PROPERTY OR ANY HAZARDS CONTAINED THEREIN. UNLESS THERE IS AN AGREEMENT STIPULATING OTHERWISE, THE AFFILIATE BROKERS OR BROKERS NAMED WITHIN REPRESENT THE OWNER OR LANDLORD.

255 N Peters Road, Suite 101
Knoxville, TN 37923
865 531 6400 tel
koellamoore.com

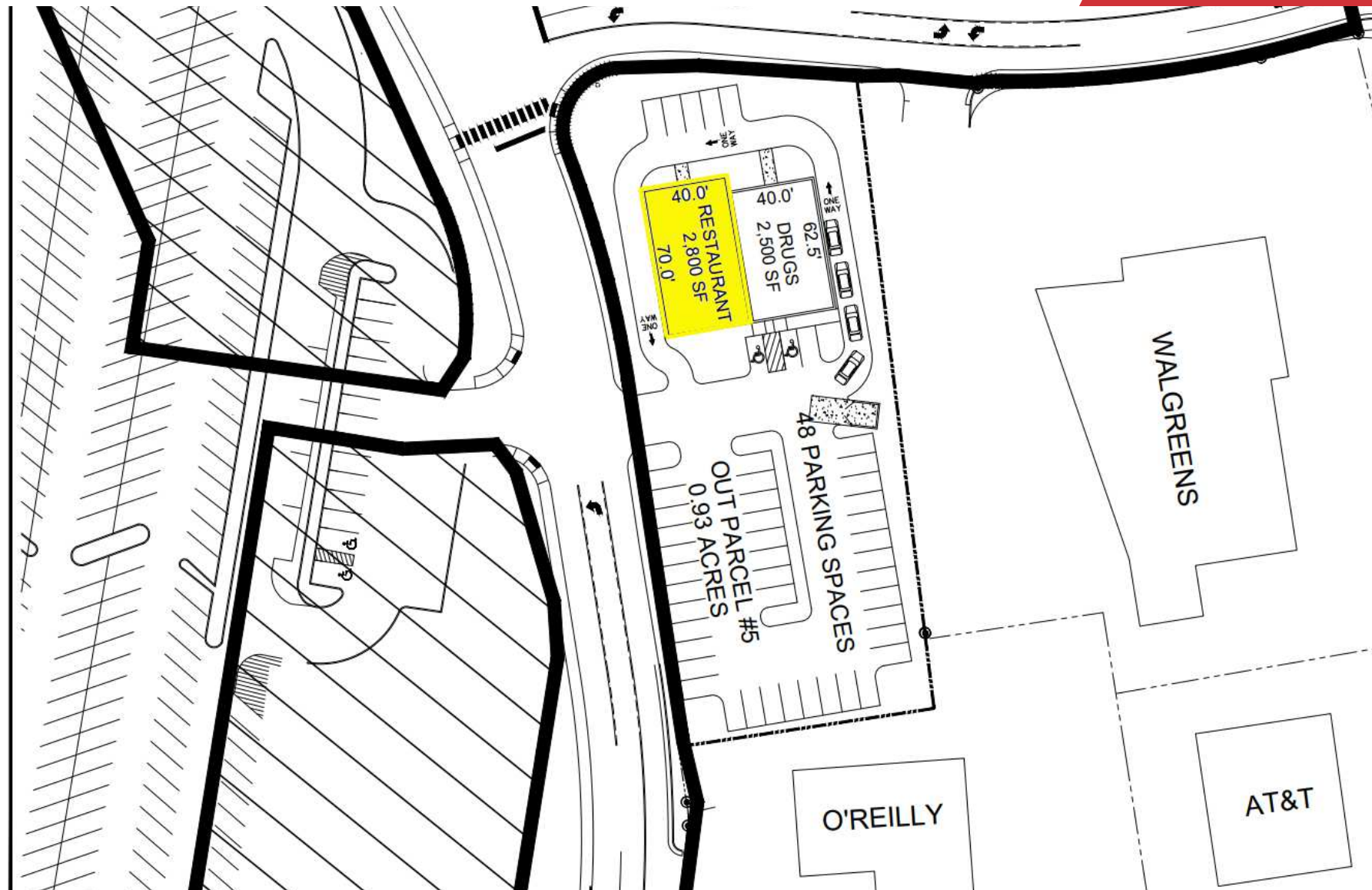

REALTYLINK

201 RIVERPLACE, SUITE 101
GREENVILLE, SC 29615
864-242-4008
REALTYLINKDEV.COM

CONCEPTUAL SITE PLAN

TN OAK RIDGE RUTGERS OVERALL SITE

STARTING WITH CIVIL CAD FILE OF 8-27-18



NO WARRANTY OR REPRESENTATION, EXPRESS OR IMPLIED, IS MADE AS TO THE ACCURACY OF THE INFORMATION CONTAINED HEREIN, AND THE SAME IS SUBMITTED SUBJECT TO ERRORS, OMISSIONS, CHANGE OF PRICE, RENTAL OR OTHER CONDITIONS, PRIOR SALE, LEASE OR FINANCING, WITHDRAWAL WITHOUT NOTICE, OR ANY SPECIAL LISTING CONDITIONS IMPOSED BY OUR PRINCIPALS. NO WARRANTIES OR REPRESENTATIONS ARE MADE AS TO THE CONDITION OF THE PROPERTY OR ANY HAZARDS CONTAINED THEREIN. UNLESS THERE IS AN AGREEMENT STIPULATING OTHERWISE, THE AFFILIATE BROKERS OR BROKERS NAMED WITHIN REPRESENT THE OWNER OR LANDLORD.

255 N Peters Road, Suite 101
Knoxville, TN 37923
865 531 6400 tel
koellamoore.com

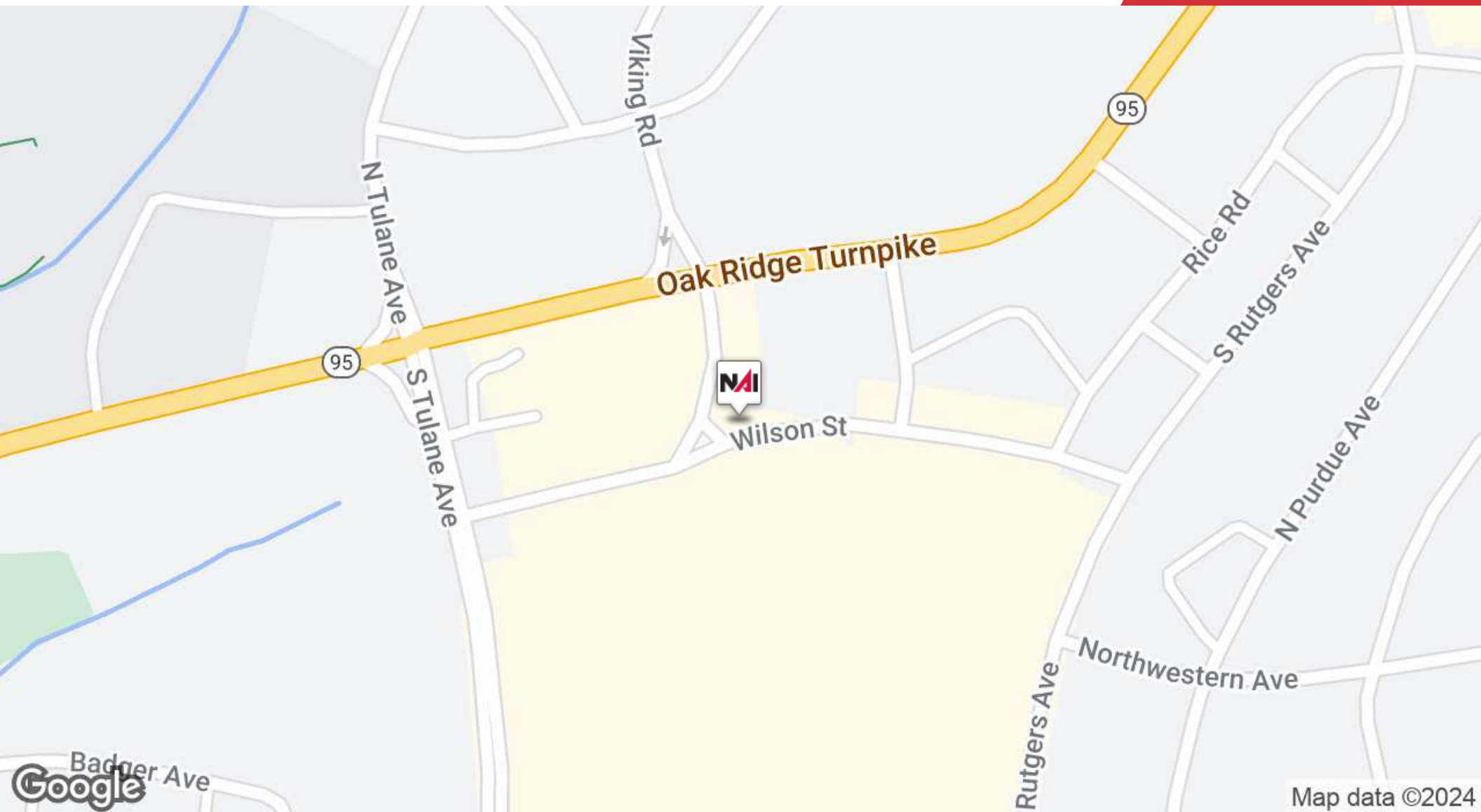

Map data ©2024

Population	1 Mile	2 Miles	3 Miles
Total Population	6,269	12,594	20,002
Average Age	34.4	36.4	38.1
Average Age (Male)	31.2	33.8	35.9
Average Age (Female)	37.9	38.7	40.7
Households & Income	1 Mile	2 Miles	3 Miles
Total Households	3,216	6,481	9,845
# of Persons per HH	1.9	1.9	2.0
Average HH Income	\$40,854	\$45,160	\$52,162
Average House Value	\$239,646	\$207,223	\$178,974

* Demographic data derived from 2020 ACS - US Census

