

PROFESSIONAL CONDO FOR SALE WHITE MARSH PROFESSIONAL CENTER

8100 Sandpiper Circle, Suite 308, Nottingham, MD 21236

Available: 5,672 SF



LISTING DATA

AVAILABLE SF: 5,672

ECONOMIC DATA

SALE PRICE: \$215.00 / SF

PROPERTY INFORMATION

COUNTY: Baltimore
MARKET: Baltimore
SUBMARKET: Baltimore County East

BUILDING DATA

TOTAL BUILDING SF: 45,000 SF
YEAR BUILT: 2009
ZONING: ML

PROPERTY OVERVIEW

Class A professional condo for sale
\$1,458.75 per month condo fees
\$15,672.96 per year in real estate taxes

LOCATION OVERVIEW

Excellent access to I-695, I-95, Routes 43 and Rt 1. Located near The Avenue At White Marsh and White Marsh Mall.

PROPERTY HIGHLIGHTS

- Completely built out with a mix of private offices, conference room, and full kitchen
- Multiple nearby restaurants, shopping centers, and hospitality
- 3rd-floor space with immediate presence directly off the elevator

Bill Harrison
Senior Vice President
443.741.4045
bharrison@lee-associates.com

Ben Brooks
Senior Associate
443.741.4053
bbrooks@lee-associates.com

All information furnished regarding property for sale, rental or financing is from sources deemed reliable, but no warranty or representation is made to the accuracy thereof and same is submitted to errors, omissions, change of price, rental or other conditions prior to sale, lease or financing or withdrawal without notice. No liability of any kind is to be imposed on the broker herein.

PROFESSIONAL CONDO FOR SALE

WHITE MARSH PROFESSIONAL CENTER

8100 Sandpiper Circle, Suite 308, Nottingham, MD 21236

Available: 5,672 SF

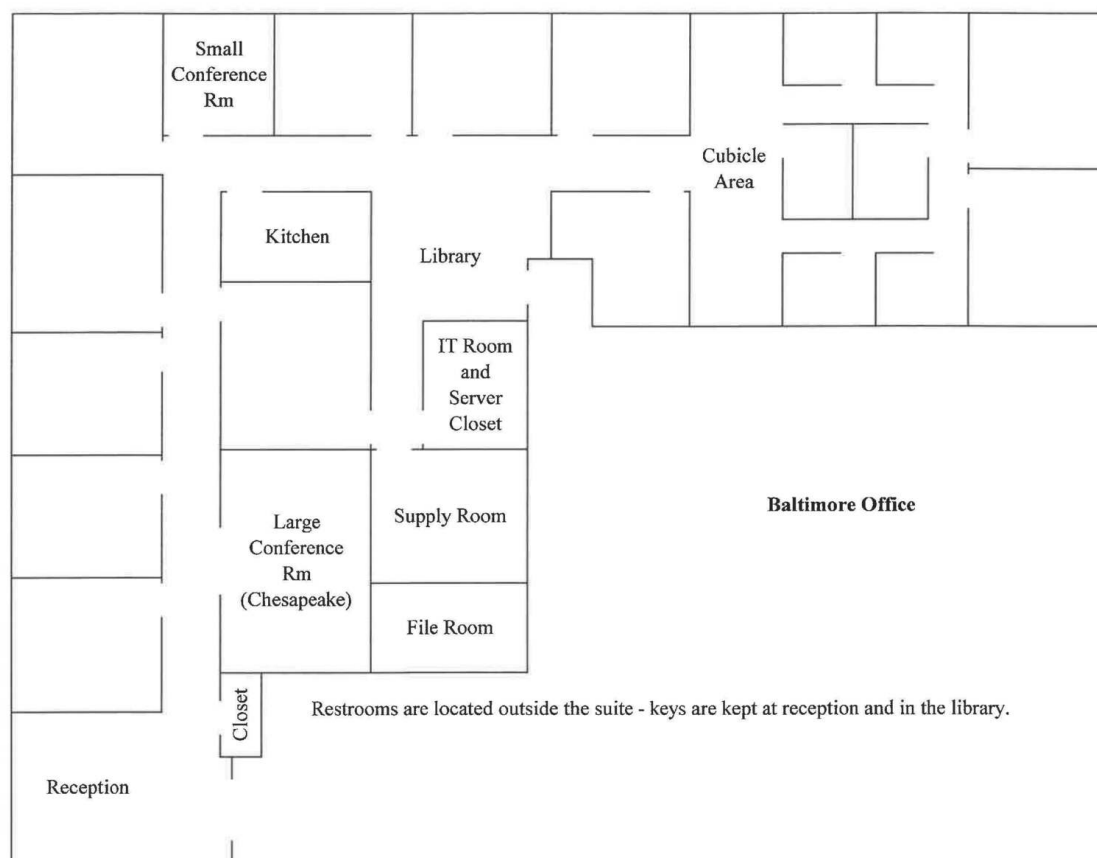

Suite 308 | 5,672 SF

Bill Harrison
Senior Vice President
443.741.4045
bharrison@lee-associates.com

Ben Brooks
Senior Associate
443.741.4053
bbrooks@lee-associates.com

All information furnished regarding property for sale, rental or financing is from sources deemed reliable, but no warranty or representation is made to the accuracy thereof and same is submitted to errors, omissions, change of price, rental or other conditions prior to sale, lease or financing or withdrawal without notice. No liability of any kind is to be imposed on the broker herein.

PROFESSIONAL CONDO FOR SALE WHITE MARSH PROFESSIONAL CENTER

8100 Sandpiper Circle, Suite 308, Nottingham, MD 21236

Available: 5,672 SF

LEE & ASSOCIATES
COMMERCIAL REAL ESTATE SERVICES



Bill Harrison
Senior Vice President
443.741.4045
bharrison@lee-associates.com

Ben Brooks
Senior Associate
443.741.4053
bbrooks@lee-associates.com

All information furnished regarding property for sale, rental or financing is from sources deemed reliable, but no warranty or representation is made to the accuracy thereof and same is submitted to errors, omissions, change of price, rental or other conditions prior to sale, lease or financing or withdrawal without notice. No liability of any kind is to be imposed on the broker herein.

PROFESSIONAL CONDO FOR SALE WHITE MARSH PROFESSIONAL CENTER

8100 Sandpiper Circle, Suite 308, Nottingham, MD 21236

Available: 5,672 SF

LEE & ASSOCIATES
COMMERCIAL REAL ESTATE SERVICES

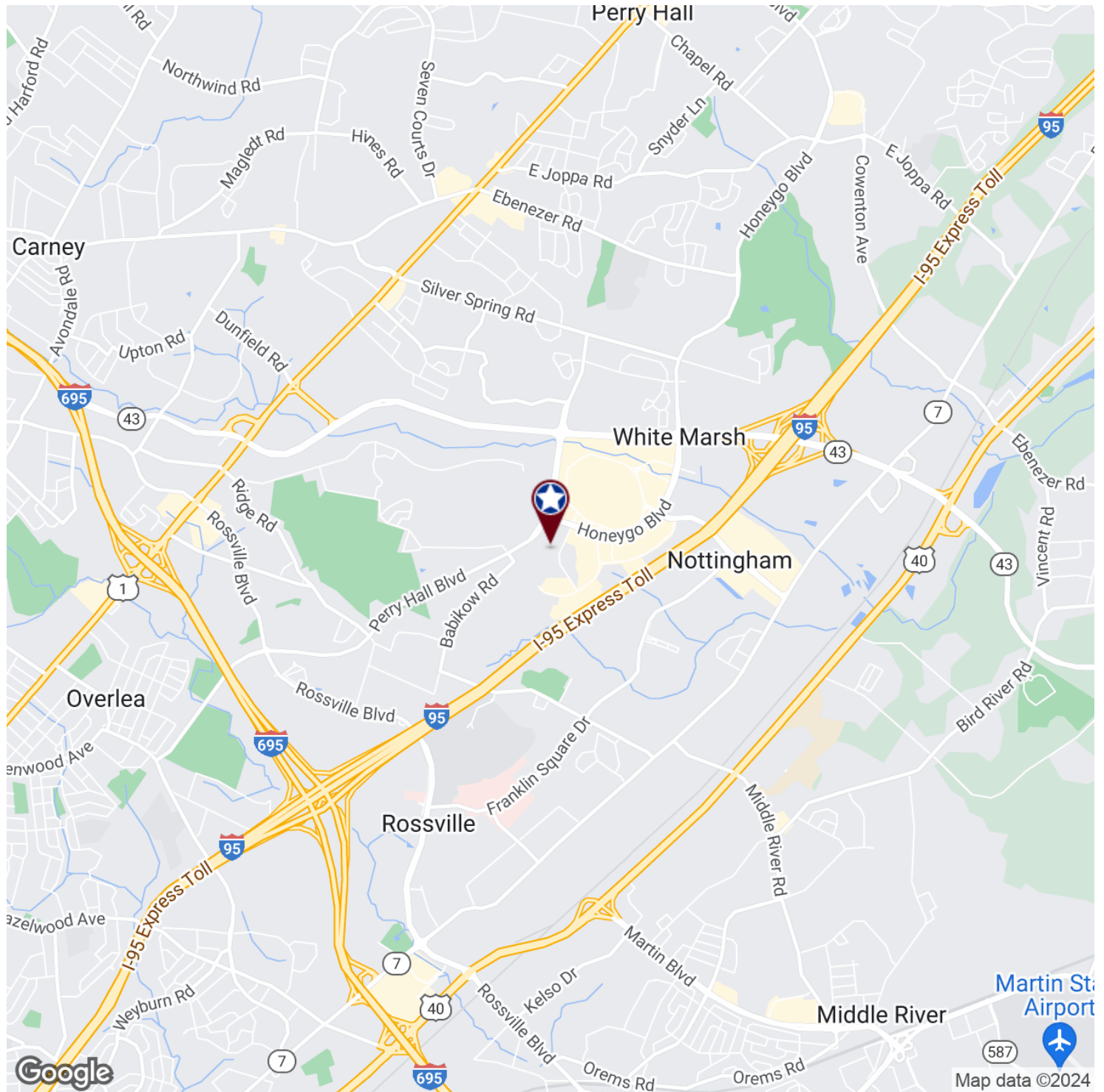

Bill Harrison
Senior Vice President
443.741.4045
bharrison@lee-associates.com

Ben Brooks
Senior Associate
443.741.4053
bbrooks@lee-associates.com

All information furnished regarding property for sale, rental or financing is from sources deemed reliable, but no warranty or representation is made to the accuracy thereof and same is submitted to errors, omissions, change of price, rental or other conditions prior to sale, lease or financing or withdrawal without notice. No liability of any kind is to be imposed on the broker herein.

PROFESSIONAL CONDO FOR SALE

WHITE MARSH PROFESSIONAL CENTER

8100 Sandpiper Circle, Suite 308, Nottingham, MD 21236

Available: 5,672 SF

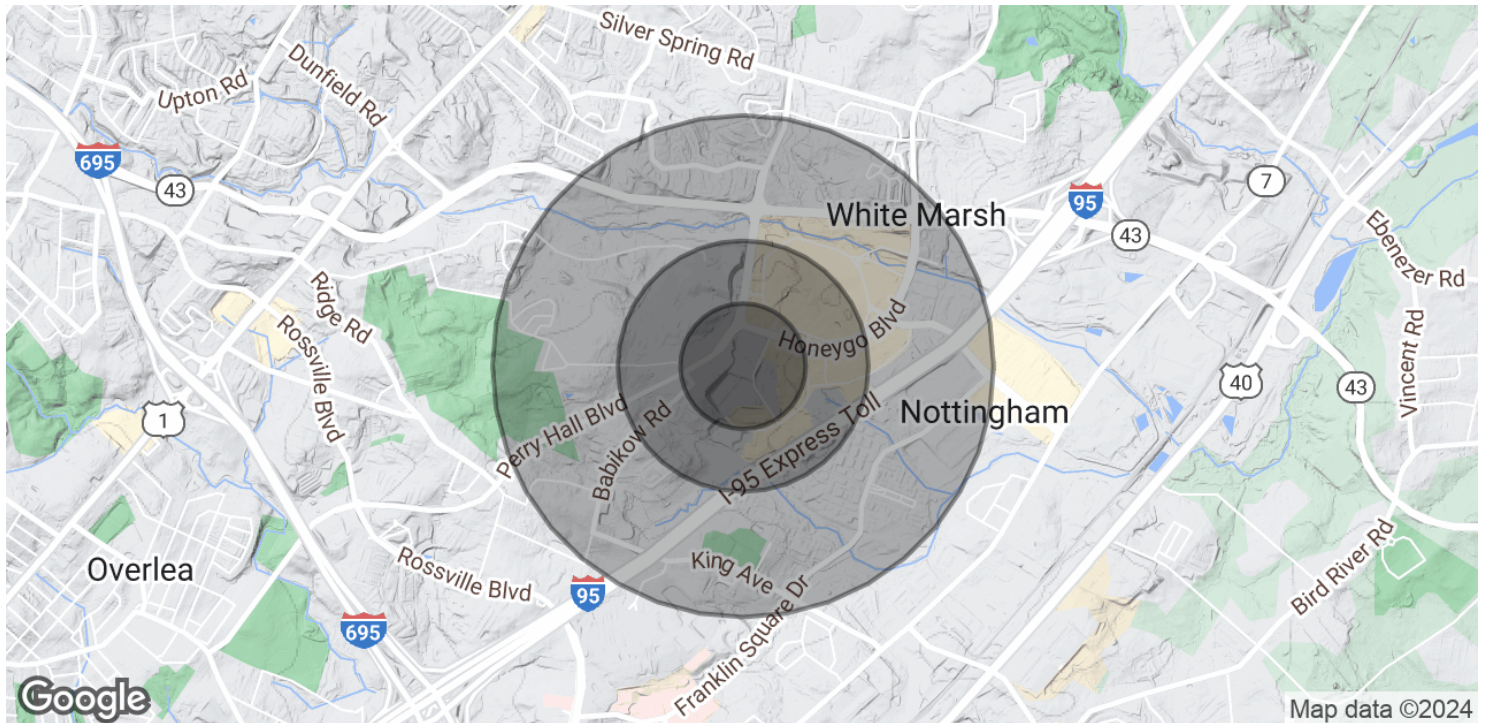

POPULATION

	0.25 MILES	0.5 MILES	1 MILE
Total Population	191	968	8,596
Average Age	43.9	44.0	40.1
Average Age (Male)	47.1	46.1	39.5
Average Age (Female)	43.3	44.8	41.9

HOUSEHOLDS & INCOME

	0.25 MILES	0.5 MILES	1 MILE
Total Households	64	369	3,597
# of Persons per HH	3.0	2.6	2.4
Average HH Income	\$125,462	\$113,674	\$88,790
Average House Value	\$366,917	\$306,791	\$244,450

* Demographic data derived from 2020 ACS - US Census

Bill Harrison
Senior Vice President
443.741.4045
bharrison@lee-associates.com

Ben Brooks
Senior Associate
443.741.4053
bbrooks@lee-associates.com

All information furnished regarding property for sale, rental or financing is from sources deemed reliable, but no warranty or representation is made to the accuracy thereof and same is submitted to errors, omissions, change of price, rental or other conditions prior to sale, lease or financing or withdrawal without notice. No liability of any kind is to be imposed on the broker herein.