

# 345 Crown Point Circle

345 CROWN POINT CIRCLE, GRASS VALLEY, CA 95945

**FOR LEASE**

Industrial Property



## Features

- A rare 7,071 SF high-bay shop space for lease.
- Massive power supply suitable for most any use.
- 3 large roll-up truck doors.
- 25' clear height.
- Drive-around access with lots of parking.

## Units Available

SPACE	SIZE (SF)	LEASE RATE
-------	-----------	------------



HIGHLAND COMMERCIAL

[www.SperryCGA.com](http://www.SperryCGA.com)



**Lock Richards**  
PRESIDENT/BROKER  
530.470.1740  
lock@highlandcre.com  
CalDRE #01302767

Each office independently owned and operated.

We obtained the information above from sources we believe to be reliable. However, we have not verified its accuracy and make no guarantee, warranty or representation about it. It is submitted subject to the possibility of errors, omissions, change of price, rental or other conditions, prior sale, lease or financing, or withdrawal without notice. We include projections, opinions, assumptions or estimates for example only, and they may not represent current or future performance of the property. You and your tax and legal advisors should conduct your own investigation of the property and transaction.

# 345 Crown Point Circle

345 CROWN POINT CIRCLE, GRASS VALLEY, CA 95945

## FOR LEASE

Industrial Property

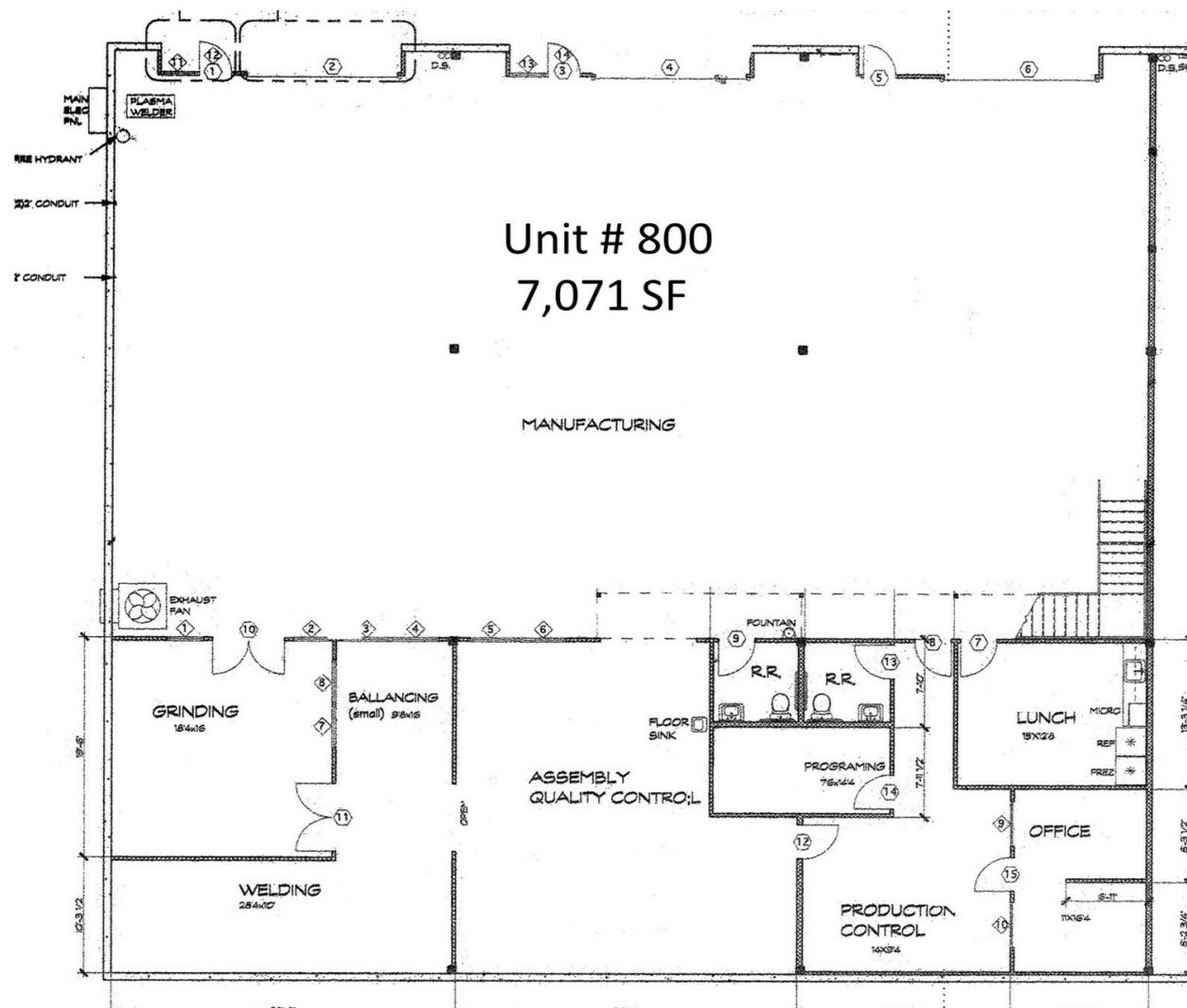

HIGHLAND COMMERCIAL

[www.SperryCGA.com](http://www.SperryCGA.com)



**Lock Richards**  
PRESIDENT/BROKER  
530.470.1740  
[lock@highlandcre.com](mailto:lock@highlandcre.com)  
CalDRE #01302767

Each office independently owned and operated.

We obtained the information above from sources we believe to be reliable. However, we have not verified its accuracy and make no guarantee, warranty or representation about it. It is submitted subject to the possibility of errors, omissions, change of price, rental or other conditions, prior sale, lease or financing, or withdrawal without notice. We include projections, opinions, assumptions or estimates for example only, and they may not represent current or future performance of the property. You and your tax and legal advisors should conduct your own investigation of the property and transaction.