



301 E Robinson, Norman, OK 73071



### PROPERTY DESCRIPTION

Brand new retail space for lease in a 2 tenant shopping strip. Located in a bustling commercial area, this beautiful, modern unit offers ample square footage to accommodate a wide range of retail ventures.

### PROPERTY HIGHLIGHTS

- New construction
- Dunkin Donuts anchor tenant
- 27,000 VPD
- Modern Aesthetic
- High Daytime Traffic
- Near Medical Corridor

### OFFERING SUMMARY

Lease Rate:	\$22.00 SF/yr (NNN)
NNN:	\$4.30 SF/yr
Zoning	C-2
Available SF:	1,383 SF
Lot Size:	0.55 Acres
Building Size:	3,151 SF

DEMOGRAPHICS	1 MILE	3 MILES	5 MILES
Total Households	3,529	23,884	44,684
Total Population	8,089	64,344	113,305
Average HH Income	\$42,903	\$51,385	\$61,921

**Nick Tyler**

Sales Associate

405.397.3228

nick@fleskeholding.com



**Kendra Streeter**

Broker Associate

405.590.7202

kendra@fleskeholding.com



301 E Robinson, Norman, OK 73071

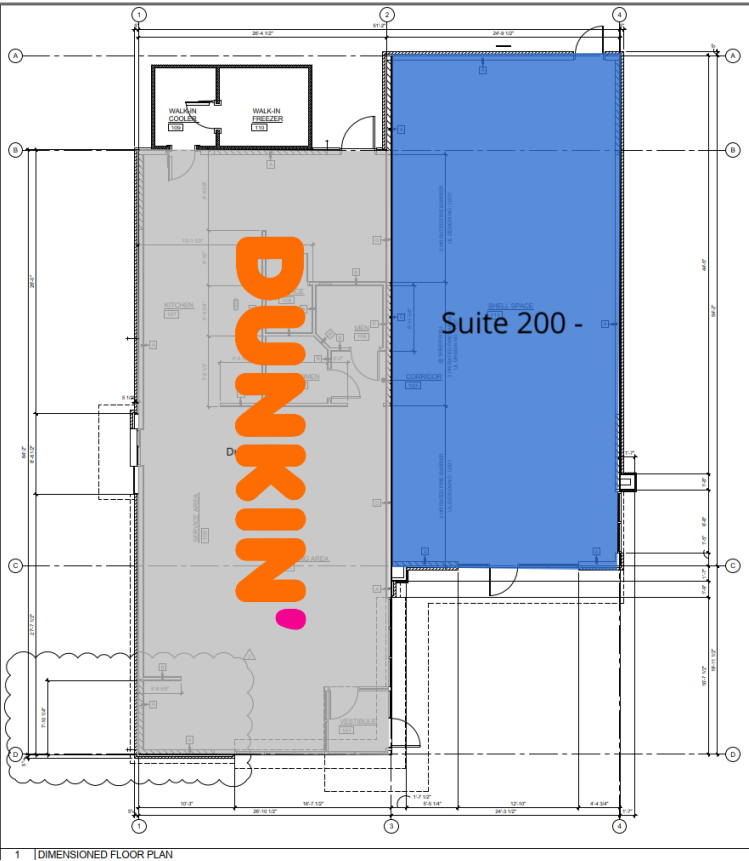

AVAILABLE SPACES

SUITE	TENANT	SIZE	TYPE	RATE	DESCRIPTION
Suite 200 -	Available	1,383 SF	NNN	\$22.00 SF/yr	-





301 E Robinson, Norman, OK 73071

