



RENOVATED & VERSATILE RETAIL SUITES FRONTING FLORIDA BLVD

4373 FLORIDA BLVD BATON ROUGE, LA 70806



OFFERED: FOR LEASE
LEASE RATE: **NEGOTIABLE**

- 3 suites available
- Large, versatile suite - ±7,700 SF, 10' rollup door
- Multiple access points, fronting ±13,621 daily traffic

CONTACT:

JACOB LOVELAND
225.460.0877

800.895.9329 | <https://elifinrealty.com> | October 2023
640 Main St, Suite A, Baton Rouge, LA 70801
Broker of Record, Mathew Laborde; Licensed by the Louisiana, Mississippi, and Ohio Real Estate Commissions. This information has been secured from sources we believe to be reliable, but we make no representations or warranties, expressed or implied, as to the accuracy of the information. References to square footage or age are approximate. Interested parties must verify the information and bears all risk for any inaccuracies.

OFFERING SUMMARY



PROPERTY SUMMARY

- This corner building fronting Florida Blvd has been completely renovated and is "like new."
- It is ready for tenant buildout and customization and offers versatile spaces to match many different uses.
- The building is comprised of two smaller retail suites ± 812 SF & ± 849 SF (each with a restroom), and a large $\pm 6,422$ SF suite with 12' ceilings, a storage area, restroom, and 10' rollup door.
- Located at the corner of Florida Blvd and N Beck St between Downtown and Amazon, this building is well-positioned to attract local traffic and commuters traveling down one of Baton Rouge's primary thoroughfares.
- The property sees over 13,000 vehicles per day and has multiple points of access for the sizeable parking lot in front of the building.

CONTACT:

JACOB LOVELAND
225.460.0877

800.895.9329 | <https://elifinrealty.com> | October 2023
640 Main St, Suite A, Baton Rouge, LA 70801
Broker of Record, Mathew Laborde; Licensed by the Louisiana, Mississippi, and Ohio Real Estate Commissions. This information has been secured from sources we believe to be reliable, but we make no representations or warranties, expressed or implied, as to the accuracy of the information. References to square footage or age are approximate. Interested parties must verify the information and bears all risk for any inaccuracies.

LEASE SPACES

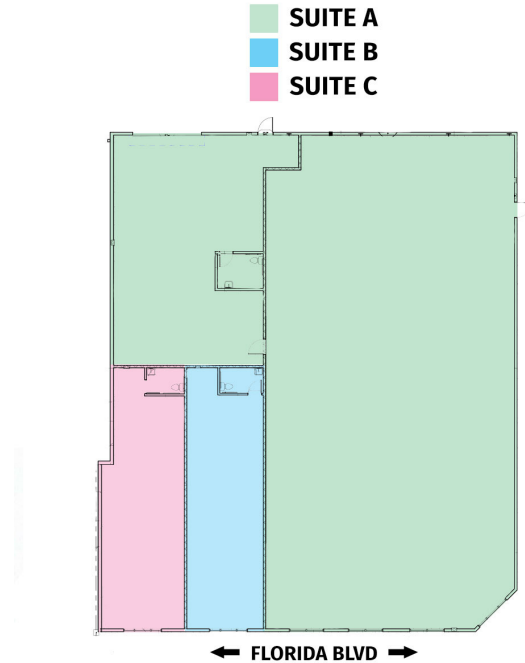

LEASE INFORMATION

Lease Type:	-	Lease Term:	Negotiable
Total Space:	-	Lease Rate:	Negotiable

AVAILABLE SPACES



SUITE	TENANT	SIZE (SF)	LEASE TYPE	LEASE RATE	DESCRIPTION
Suite A	-	6,422 SF	NNN	\$15.00 SF/yr	\$8,027.50 / month
Suite B	-	812 SF	NNN	\$15.00 SF/yr	\$1,015 / month
Suite C	-	849 SF	NNN	\$15.00 SF/yr	\$1,062 / month

CONTACT:

JACOB LOVELAND
225.460.0877

800.895.9329 | <https://elifinrealty.com> | October 2023
640 Main St, Suite A, Baton Rouge, LA 70801
Broker of Record, Mathew Laborde; Licensed by the Louisiana, Mississippi, and Ohio Real Estate Commissions. This information has been secured from sources we believe to be reliable, but we make no representations or warranties, expressed or implied, as to the accuracy of the information. References to square footage or age are approximate. Interested parties must verify the information and bears all risk for any inaccuracies.

ADDITIONAL PHOTOS

 SUITE A
 SUITE B
 SUITE C

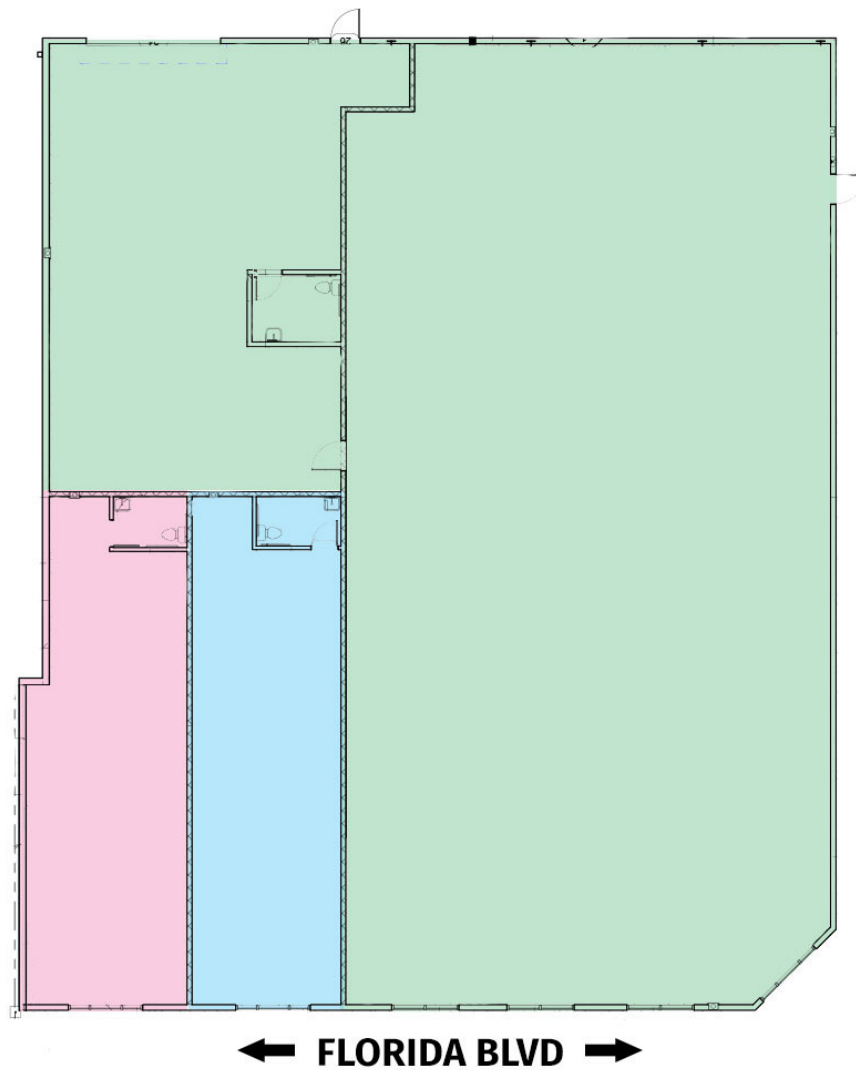
**CONTACT:**

JACOB LOVELAND
225.460.0877

800.895.9329 | <https://elifinrealty.com> | October 2023
640 Main St, Suite A, Baton Rouge, LA 70801
Broker of Record, Mathew Laborde; Licensed by the Louisiana, Mississippi, and Ohio Real Estate Commissions. This information has been secured from sources we believe to be reliable, but we make no representations or warranties, expressed or implied, as to the accuracy of the information. References to square footage or age are approximate. Interested parties must verify the information and bears all risk for any inaccuracies.

SUITE A

**CONTACT:**

JACOB LOVELAND
225.460.0877

800.895.9329 | <https://elifinrealty.com> | October 2023

640 Main St, Suite A, Baton Rouge, LA 70801
Broker of Record, Mathew Laborde; Licensed by the Louisiana, Mississippi, and Ohio Real Estate Commissions. This information has been secured from sources we believe to be reliable, but we make no representations or warranties, expressed or implied, as to the accuracy of the information. References to square footage or age are approximate. Interested parties must verify the information and bears all risk for any inaccuracies.

SUITE B & SUITE C



Suite B



Suite B



Suite C



Suite C

CONTACT:

JACOB LOVELAND
225.460.0877

800.895.9329 | <https://elifinrealty.com> | October 2023

640 Main St, Suite A, Baton Rouge, LA 70801
Broker of Record, Mathew Laborde; Licensed by the Louisiana, Mississippi, and Ohio Real Estate Commissions. This information has been secured from sources we believe to be reliable, but we make no representations or warranties, expressed or implied, as to the accuracy of the information. References to square footage or age are approximate. Interested parties must verify the information and bears all risk for any inaccuracies.

EXTERIOR PHOTOS

**CONTACT:**

JACOB LOVELAND
225.460.0877

800.895.9329 | <https://elifinrealty.com> | October 2023

640 Main St, Suite A, Baton Rouge, LA 70801
Broker of Record, Mathew Laborde; Licensed by the Louisiana, Mississippi, and Ohio Real Estate Commissions. This information has been secured from sources we believe to be reliable, but we make no representations or warranties, expressed or implied, as to the accuracy of the information. References to square footage or age are approximate. Interested parties must verify the information and bears all risk for any inaccuracies.

LOCATION MAP

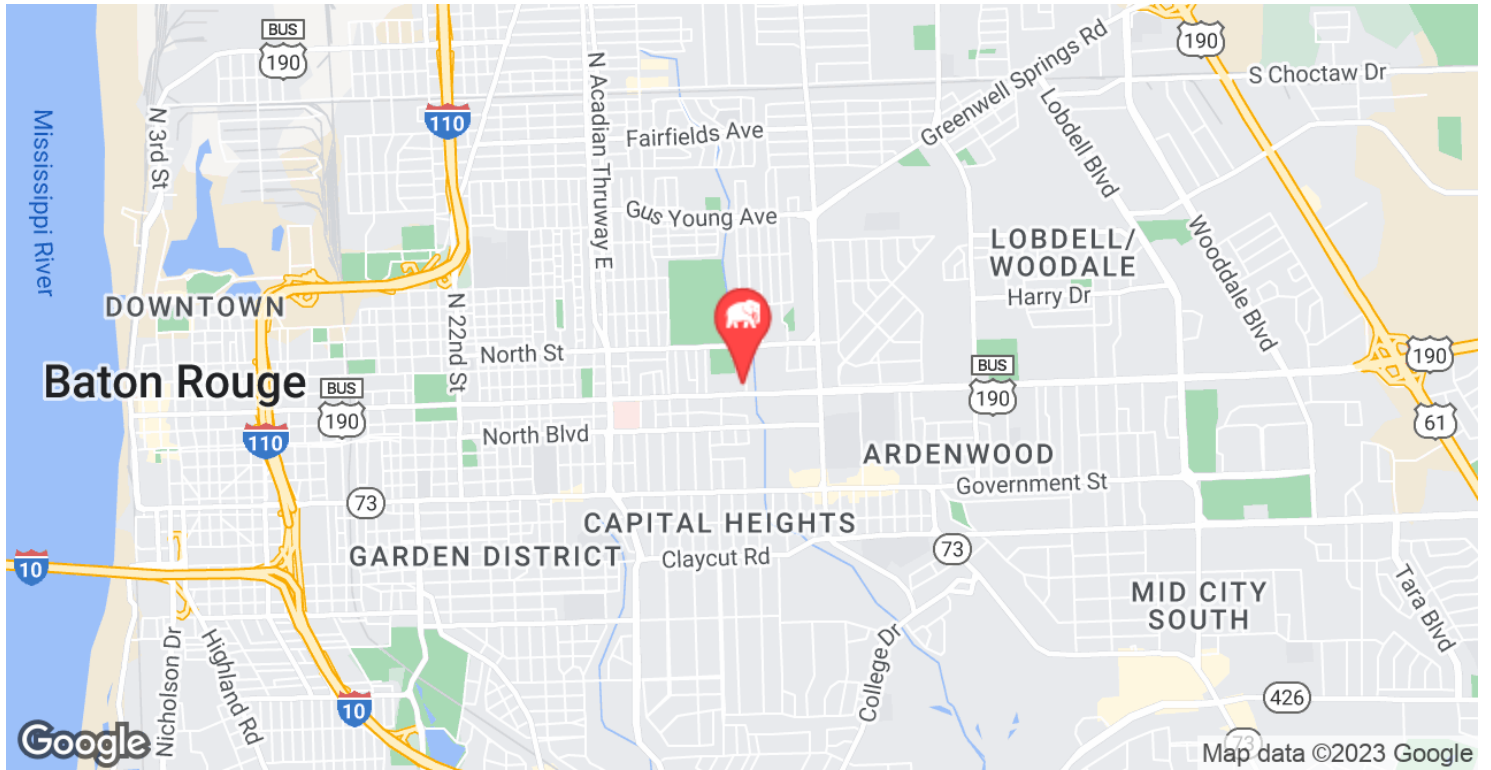

CONTACT:

JACOB LOVELAND
225.460.0877

800.895.9329 | <https://elifinrealty.com> | October 2023

640 Main St, Suite A, Baton Rouge, LA 70801
Broker of Record, Mathew Laborde; Licensed by the Louisiana, Mississippi, and Ohio Real Estate Commissions. This information has been secured from sources we believe to be reliable, but we make no representations or warranties, expressed or implied, as to the accuracy of the information. References to square footage or age are approximate. Interested parties must verify the information and bears all risk for any inaccuracies.

DEMOGRAPHICS MAP & REPORT

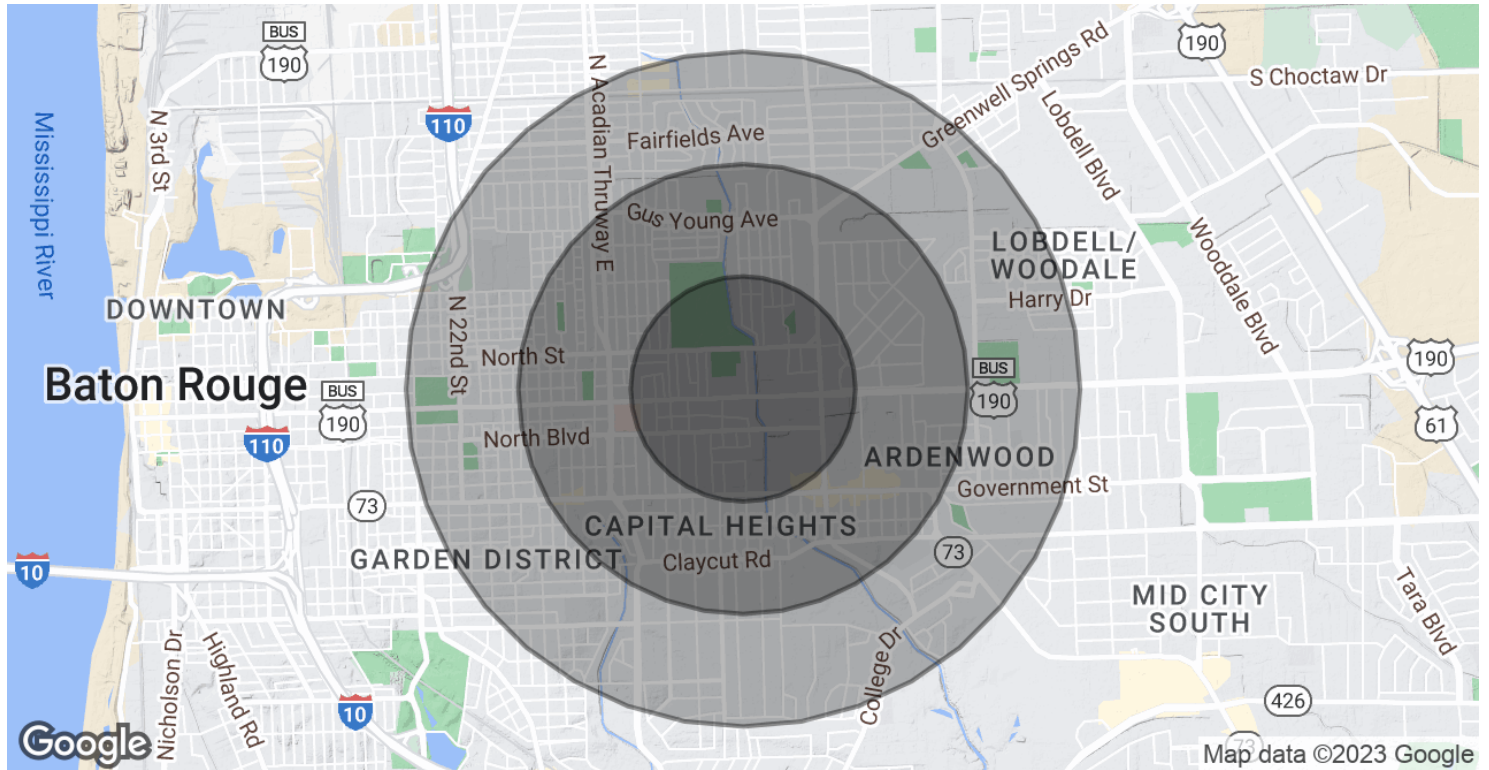

POPULATION

	0.5 MILES	1 MILE	1.5 MILES
Total Population	2,739	13,566	30,124
Average Age	42.8	38.8	38.9
Average Age (Male)	44.6	39.8	37.0
Average Age (Female)	43.1	38.0	39.3

HOUSEHOLDS & INCOME

	0.5 MILES	1 MILE	1.5 MILES
Total Households	1,455	6,753	15,563
# of Persons per HH	1.9	2.0	1.9
Average HH Income	\$41,815	\$55,053	\$60,572
Average House Value	\$155,053	\$183,710	\$203,196

* Demographic data derived from 2020 ACS - US Census

CONTACT:

JACOB LOVELAND
225.460.0877

800.895.9329 | <https://elifinrealty.com> | October 2023
640 Main St, Suite A, Baton Rouge, LA 70801
Broker of Record, Mathew Laborde; Licensed by the Louisiana, Mississippi, and Ohio Real Estate Commissions. This information has been secured from sources we believe to be reliable, but we make no representations or warranties, expressed or implied, as to the accuracy of the information. References to square footage or age are approximate. Interested parties must verify the information and bears all risk for any inaccuracies.