

±600 SF FOR LEASE

ALPINE PLAZA

10642-10650 BALBOA BOULEVARD | LOS ANGELES, CA 91344



AARON GUIDO

CALDRE #01924252

714.769.6117

AARON@CBM1.COM

DANIEL BARRIGA

CALDRE #02031360

949.608.4886

DANIEL@CBM1.COM

CBM1.COM

CBM1

LEASING

BROKERAGE

INVESTMENTS

PROPERTY SUMMARY

ALPINE PLAZA | 10642-10650 BALBOA BOULEVARD, LOS ANGELES, CA 91344

BROCHURE | PAGE 2



PROPERTY DESCRIPTION

These exceptional units offer an exciting leasing opportunity for businesses seeking a strong presence in a bustling commercial hub. Positioned along the prominent Balboa Boulevard, this retail space benefits from high visibility and exposure to a diverse customer base. The modern architectural charm and well-crafted storefront create an enticing facade that draws attention. Inside, the retail shop space boasts versatility and adaptability, providing the perfect environment to showcase various retail concepts. Whether you're a boutique, cafe, or service provider, this space offers the ideal foundation for your success.

PROPERTY HIGHLIGHTS

- Retail shop space for lease at Alpine Plaza.
- High visibility along Balboa Boulevard in a bustling commercial hub.
- Modern architecture and inviting storefront.
- Versatile interior, perfect for diverse retail concepts.

AARON GUIDO

CALDRE #01924252
714.769.6117
AARON@CBM1.COM

DANIEL BARRIGA

CALDRE #02031360
949.608.4886
DANIEL@CBM1.COM

OFFERING SUMMARY

Lease Rate:	\$1,824.00 per month (Including NNN)
Available SF:	598 SF
Building Size:	8,476 SF

DEMOGRAPHICS	1 MILE	3 MILES	5 MILES
Total Households	8,514	57,702	173,673
Total Population	25,642	175,622	567,905
Average HH Income	\$102,761	\$105,638	\$90,898

LEASE SPACES

ALPINE PLAZA | 10642-10650 BALBOA BOULEVARD, LOS ANGELES, CA 91344

BROCHURE | PAGE 3

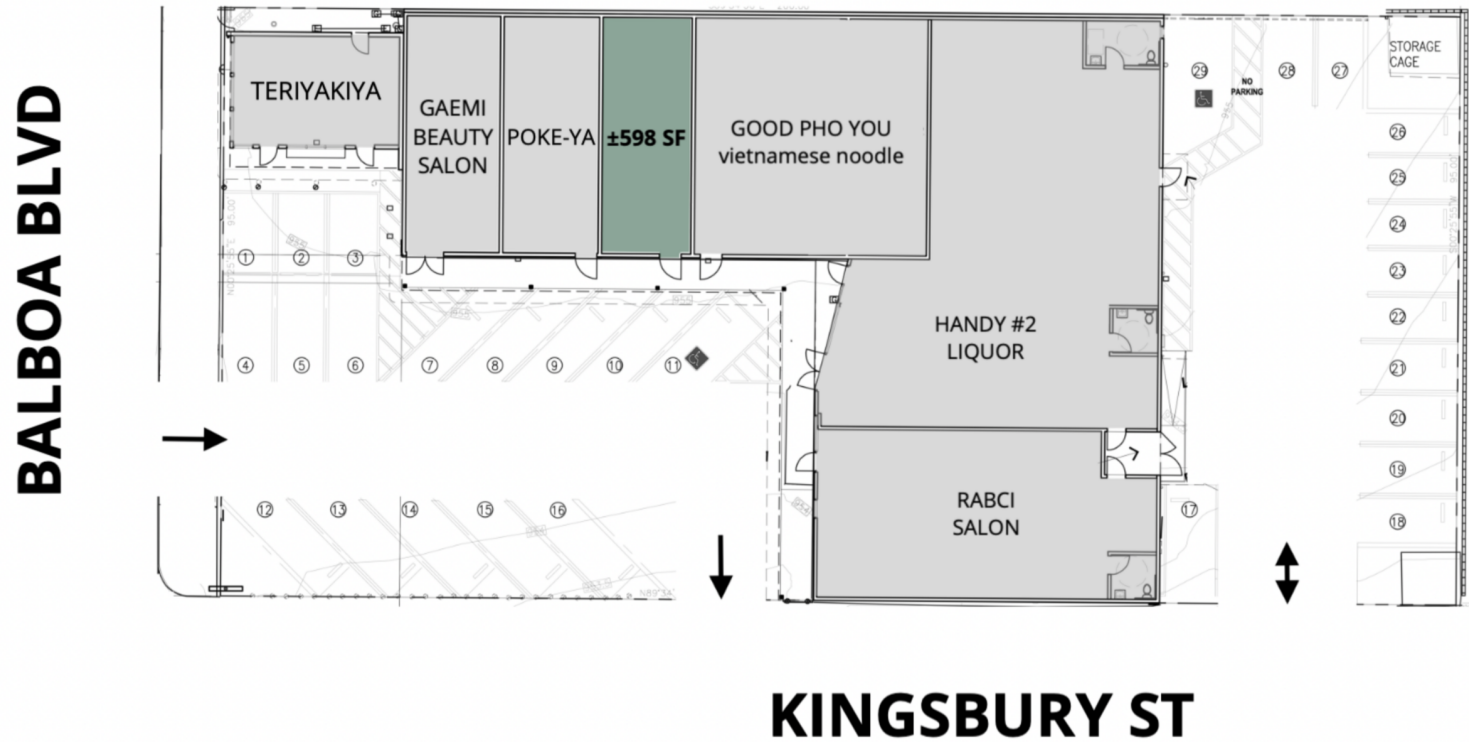

AVAILABLE SPACES

SUITE	TENANT	SIZE (SF)	LEASE TYPE	LEASE RATE	DESCRIPTION	VIDEO
10648 1/2	Available	598 SF	Including NNN	\$1,824 per month	Ready To Go Vanilla Shell Shop Space	View Here

AARON GUIDO

CALDRE #01924252

714.769.6117

AARON@CBM1.COM

DANIEL BARRIGA

CALDRE #02031360

949.608.4886

DANIEL@CBM1.COM

LOCATION MAP

ALPINE PLAZA | 10642-10650 BALBOA BOULEVARD, LOS ANGELES, CA 91344

BROCHURE | PAGE 4

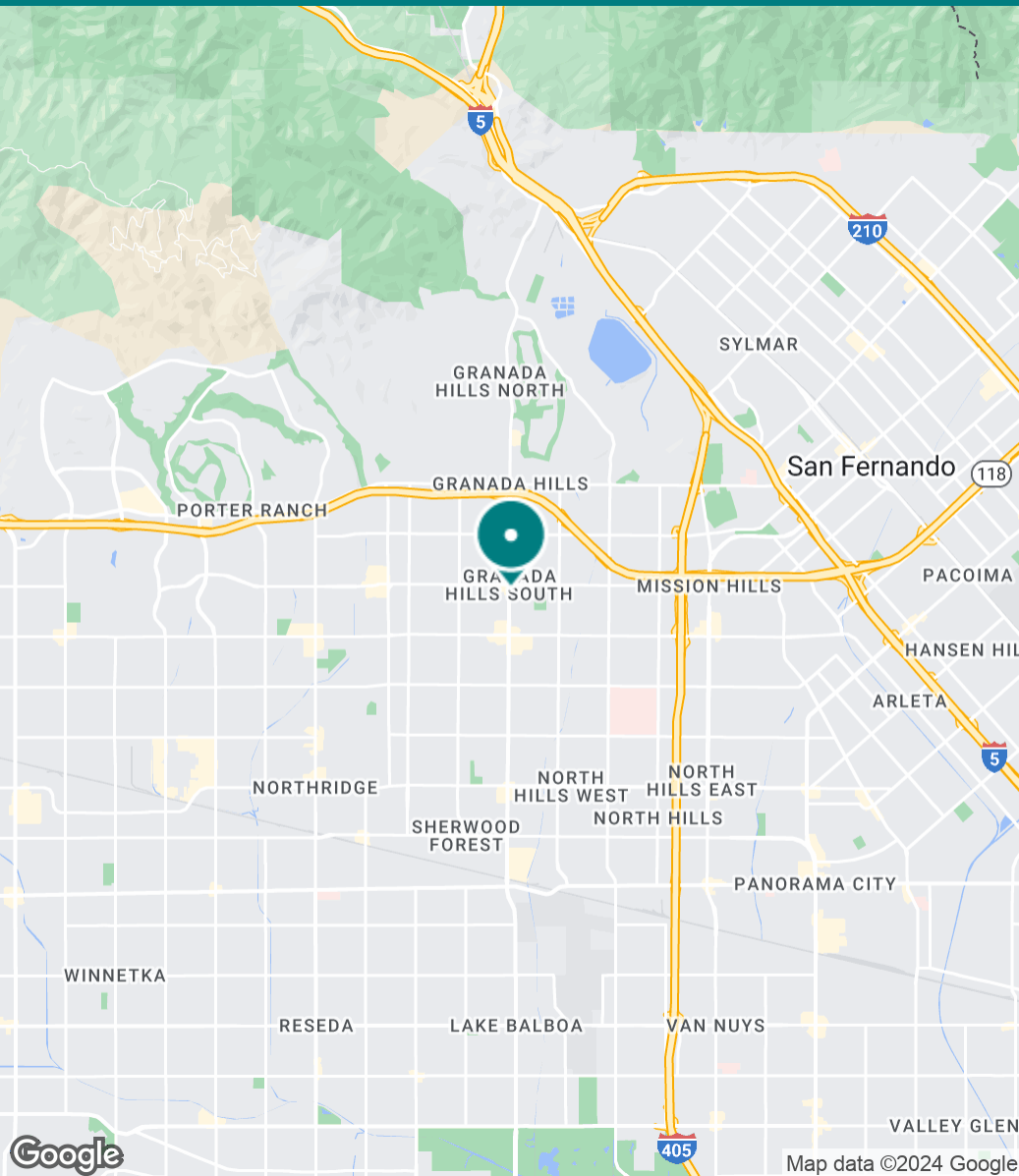

AARON GUIDO
CALDRE #01924252
714.769.6117
AARON@CBM1.COM

DANIEL BARRIGA
CALDRE #02031360
949.608.4886
DANIEL@CBM1.COM

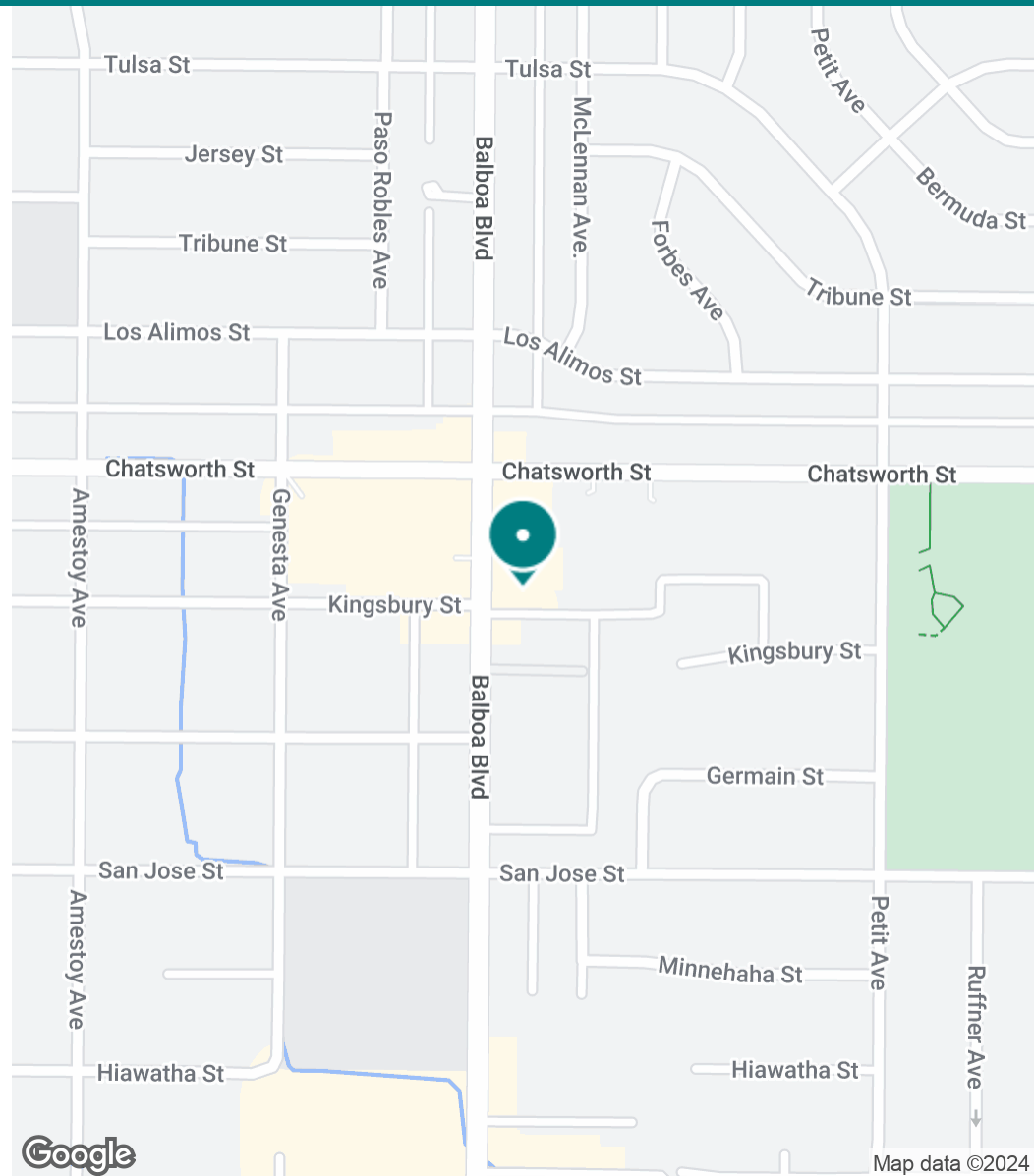

DEMOGRAPHICS MAP & REPORT

ALPINE PLAZA | 10642-10650 BALBOA BOULEVARD, LOS ANGELES, CA 91344

BROCHURE | PAGE 5

POPULATION	1 MILE	3 MILES	5 MILES
Total Population	25,642	175,622	567,905
Average Age	40.3	40.1	37.0
Average Age (Male)	38.8	38.8	35.8
Average Age (Female)	43.3	41.6	38.4
HOUSEHOLDS & INCOME	1 MILE	3 MILES	5 MILES
Total Households	8,514	57,702	173,673
# of Persons per HH	3.0	3.0	3.3
Average HH Income	\$102,761	\$105,638	\$90,898
Average House Value	\$523,449	\$583,294	\$516,981
RACE	1 MILE	3 MILES	5 MILES
% White	56.8%	50.9%	47.1%
% Black	3.6%	4.6%	4.1%
% Asian	17.2%	16.8%	12.8%
% Hawaiian	0.1%	0.2%	0.1%
% American Indian	0.9%	0.6%	0.7%
% Other	13.3%	19.4%	28.4%

** Demographic data derived from 2020 ACS - US Census*

AARON GUIDO

CALDRE #01924252

714.769.6117

AARON@CBM1.COM

DANIEL BARRIGA

CALDRE #02031360

949.608.4886

DANIEL@CBM1.COM

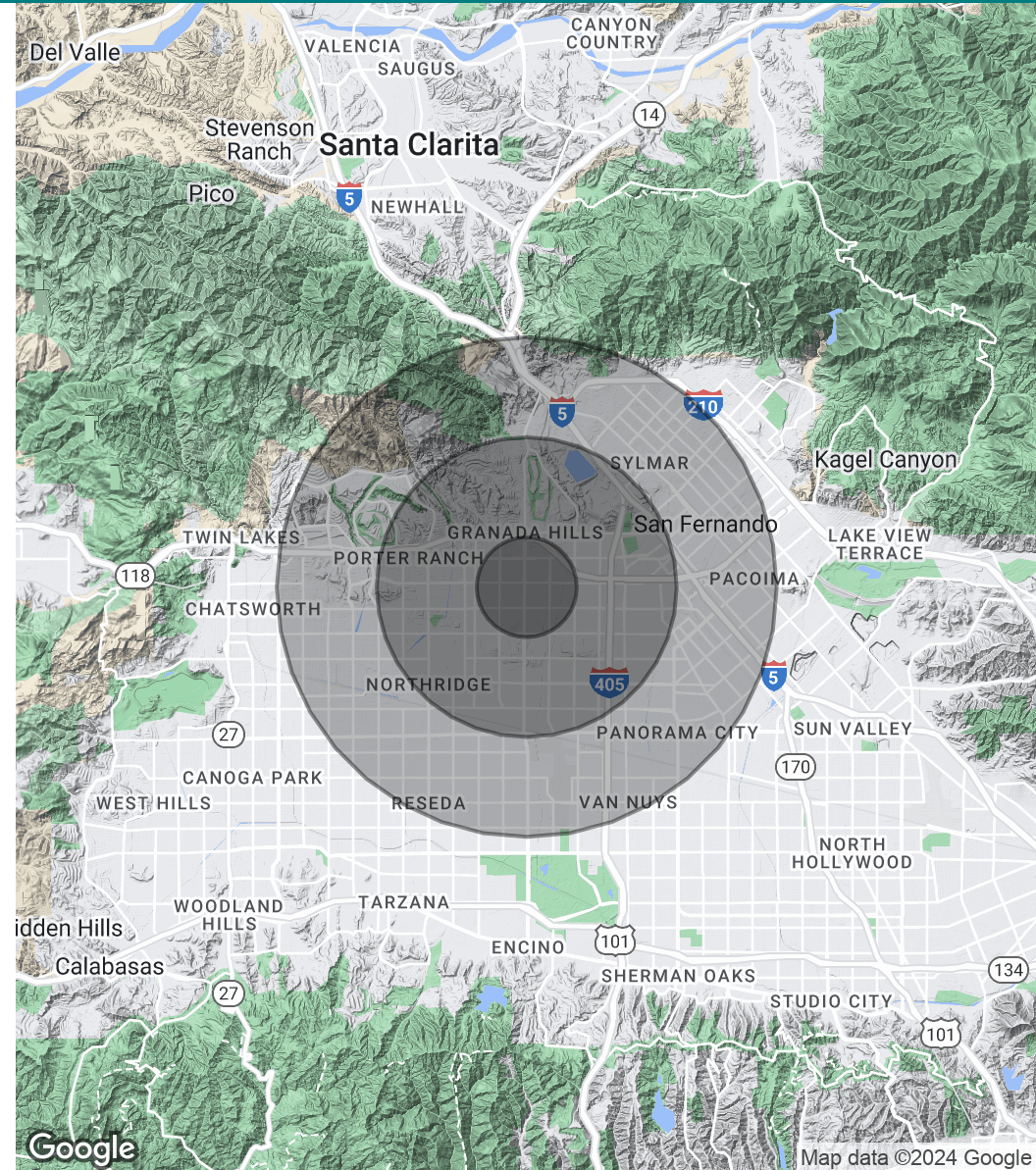

MEET THE TEAM

ALPINE PLAZA | 10642-10650 BALBOA BOULEVARD, LOS ANGELES, CA 91344

BROCHURE | PAGE 6



AARON GUIDO

Senior Vice President

Direct: 714.769.6117 **Cell:** 714.335.9887

Aaron@cbm1.com



CalDRE #01924252



DANIEL BARRIGA

Vice President

Direct: 949.608.4886 **Cell:** 714.394.5052

daniel@cbm1.com



CalDRE #02031360

AARON GUIDO

CalDRE #01924252

714.769.6117

AARON@CBM1.COM

DANIEL BARRIGA

CalDRE #02031360

949.608.4886

DANIEL@CBM1.COM