

General Notes :

1. All Work Shall Meet Local Code Req'ts. And Meet Specifications Of :
2003 International Building Code
2003 International Plumbing Code
2003 International Mechanical Code
2003 International Gas Code
2003 International Fire Prevention Code
2002 National Electrical Code
2. Contractor Shall Verify All Conditions And Dimensions At Site Before Beginning Construction. Any Discrepancies Shall Be Reported To Nettles Architecture Company For Justification And / Or Correction Before Proceeding With Work. Contractor Shall Assume Responsibility For Errors That Are Not Reported.
3. Contractor Shall Insure Compatibility Of The Building With All Site Req'ts.
4. Prior To Construction ; Contractor Shall Determine Rough Opening Sizes For All Built-In Equipment And / Or Facilities And Adjust Dimension As Req'd.
5. All Written Dimensions Shall Have Precedence Over Scale Dimensions.
6. The Contractor Is Responsible For Adjusting And Verifying All Structural Details And Conditions To Meet All Local Codes And To Insure A Quality And Safe Structure.
7. Field Density Tests Are The Responsibility Of The Contractor And Shall Be Performed At Contractor Cost By An Approved Soil Test Co. Test Reports As Recommended By The Soil Test Co. Shall Be Submitted To The Architect Before Concrete Is Poured. Contractor Shall Abide By The Recommendations Of Soil Test Co.
8. Site Plans By Others.
9. Metal Building Plans To Be Provided By Metal Building MFR.
10. Interior Layout Of All Retail Units By Others. Where Counters Are Provided For Sales Or Distribution Of Goods Or Services, At Least One Of Each Type Provided Shall Be Accessible For Persons With Disabilities.

Construction Notes :

The Entire Building Is To Be Designated
A Cold Dark Shell Except For Spaces Labelled
"OTS" (Occupied Tenant Space)

Exterior Walls Labelled 1 Hour Rated are To Be Finished
Complete With Gypsum Board. See Wall Section.

All Other Exterior Walls (Except At "OTS")
Are To Be Metal Studs Only, No Gyp. Bd.

All Interior Walls (Except At "OTS")
Are To Be Metal Studs Only, No Gyp. Bd.

At All Walls Between An "OTS" And The "CDS"
Provide A Fully Finished 1 Hour Rated Wall
Per Detail F/A4.3 Including The Installation
Of Gypsum Board On Each Side Of Wall.

There Shall Be No Storage Of Materials In The "CDS".

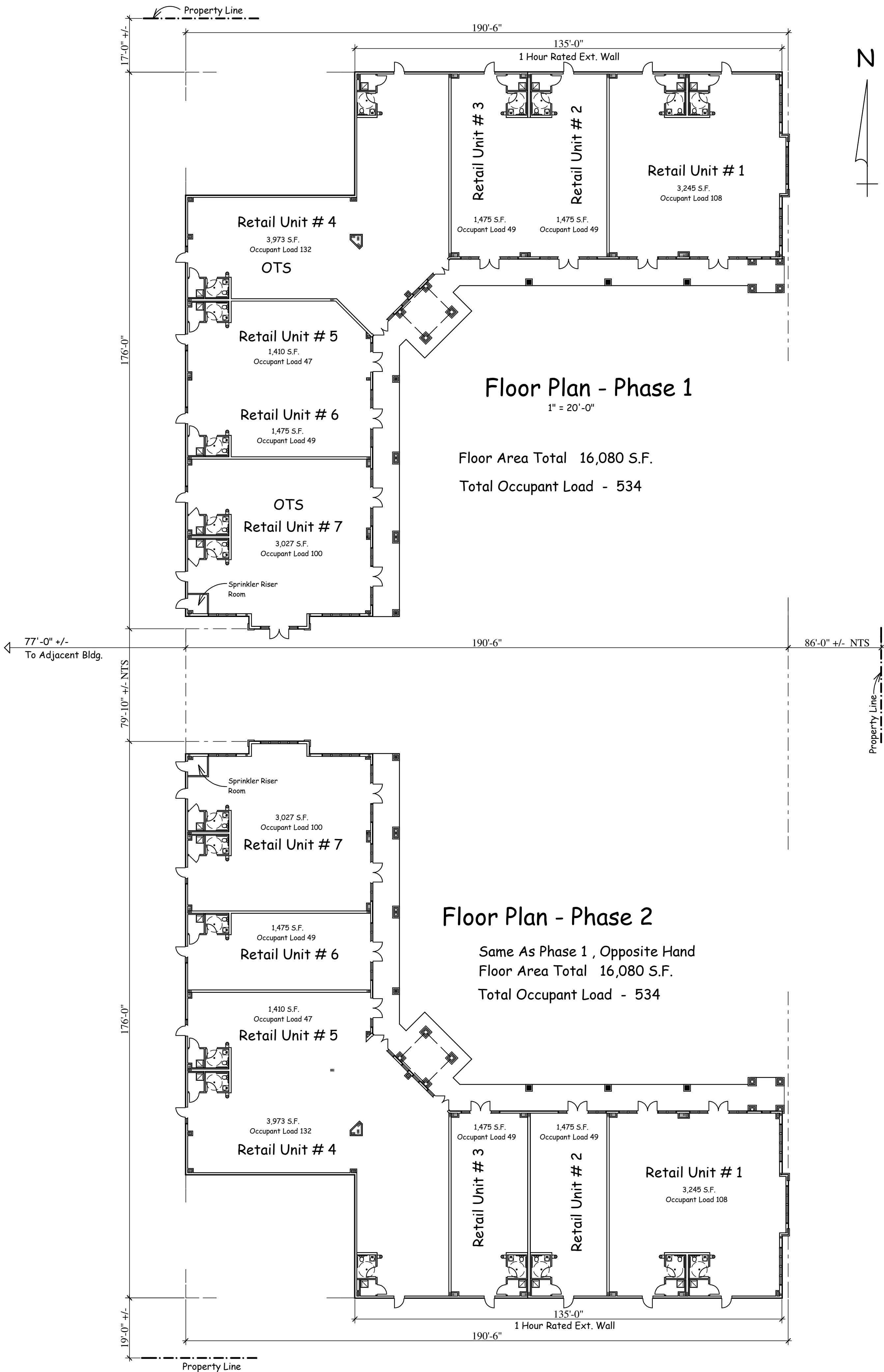

Project Plan

Building Design Per I.B.C. 2003
Occupancy Group M
Construction Type III-B , Sprinklered

Building Is Designed And Intended For
Mercantile Use Only.

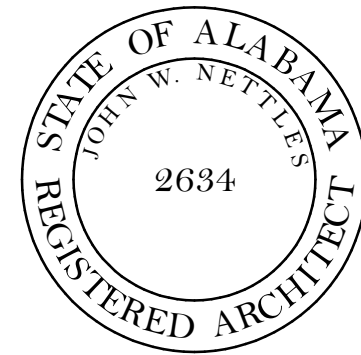

1695 East University Drive
Suite 201
Auburn Alabama 36830
(334) 887 - 3415
(334) 887 - 2057 Fax

Nettles
Architecture
Company

MAGNOLIA PLAZA
Gulf Shores , Alabama
Proposed Strip Mall By :
URBAN DEVELOPMENT, LLC
P.O. Box 1249 Auburn AL 36831 Ph: 334-821-9061

Proj. No.	0612
Date :	6 - 1 - 2007
Rev. Date :	6 - 14 - 2007 2 - 26 - 2008 4 - 14 - 2008
Scale :	As Noted
Drawn By :	Chuck Locklin
A1.1	5 OF 25