

WELCOME to

Lantana at Milpitas Station



The Hub of Milpitas



Discover Lantana Milpitas Station at BART Plaza. Sharing the entrance to the brand-new Milpitas BART station, Lantana is officially the hub of Milpitas. With over 5,000 rooftops within walking distance and one of the regions best population density and household income, Lantana Milpitas Station is poised for retail success.

LEASING BY



Lavery Chacón

Commercial Real Estate



Discover Lantana Milpitas Station at Milpitas BART Plaza

Tenants of Lantana at Milpitas Station are poised to flourish at one of Milpitas' best locations, in its newest luxury residence with 5,600 SF of new retail space. The retail space sits on the signalized intersection of S Milpitas Blvd and the entrance to the Milpitas BART station. It has amazing visibility, a large patio area for those looking to build a place for locals to feel at home, or stop before and after their journey to the next location.

- 5,600 SF of Retail Space
- Shared Entrance with BART
- Signalized Intersection
- High Ceilings and Window Frontage
- Open Patio Seating Area
- Uncompromised Visibility
- 100% Occupied Residential Building

Lantana at Milpitas Station is centrally located in between Montague Expressway E Capitol Avenue and S Milpitas Blvd, directly next to the Milpitas Bart and Transit Station. Lantana is also conveniently located between Highways 680 and 880, just South of Highway 237.

Welcome to the new
Hot Spot of Milpitas!



COMMUNITY HIGHLIGHTS

Milpitas was ranked one of California's best cities, and Lantana Milpitas Station is at the center of it all. With an enviable proximity to the Milpitas BART Station and an abundance of shopping areas, dining hotspots and open outdoor spaces close by, you'll never be far from anywhere you wish to be.

- Perfect for coffee, deli, bakery, and personal services
- 5 MI Households = 112,000
- 5 MI Household Income = \$175,000
- 5 MI Daytime Population = 430,000



Lantana at Milpitas Station is a brand-new, boutique-style community of one and two-bedroom apartment homes, including penthouses. It's the ultra-modern backdrop amid a chic, energized setting.



Multi-story parking garage across the street, over 200 surface parking stalls across S. Milpitas Blvd.



Project is directly in between S. Milpitas Boulevard and Montague Expressway, and one block away from Great Mall Parkway



Centrally located between Highways 101, 880, and 237, as well as Montague Expressway & Great Mall Parkway



BART's newest Silicon Valley hub, Milpitas Station, is just steps away.



Walking distance to ±5,000 apartment homes



EXTERIOR SPACE

Lantana at Milpitas Station



INTERIOR SPACE

Lantana at Milpitas Station



RETAIL SPACE

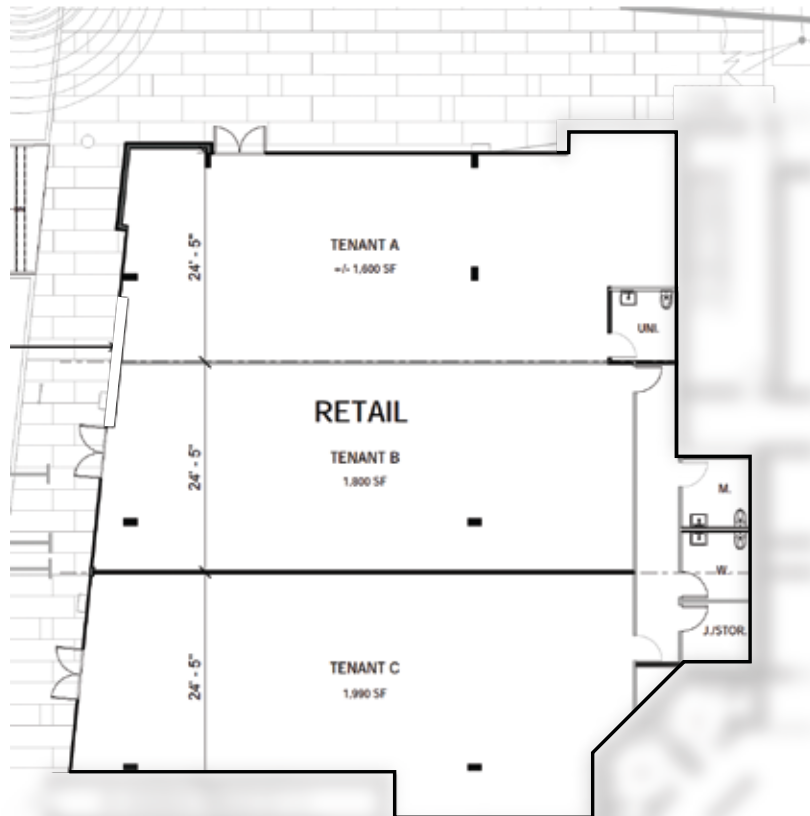

CONNECTION

Transit Stops

With Bicycle Routes

Paradas del tránsito

Tuyến Dừng/Điểm Dừng

公車站地圖



Transit Information

Milpitas Station

Milpitas

Map Key

- ★ You Are Here
- 3-Minute Walk
500ft/150m Radius
- Transit Information
- Station Entrance/Exit
- BART Train
- Bus
- Light Rail
- Transit Stop
- Bicycle Lockers/Parking
- Bicycle Storage
- Elevator
- Escalator
- Parking
- Passenger Pick-up/Drop-off
- Stairs
- Station Agent Booth
- Rideshare/Taxi
- Ticket Vending:
 - Clipper / Add Cash Value
 - Addfare
 - Wheelchair Accessible
 - Bikeway

Transit Lines

Transit Line	Service Area
Local Bus Service	San Jose-VIA
20	San Jose-VIA
47	San Jose-VIA
66	San Jose-VIA
70	San Jose-VIA
71	San Jose-VIA
77	San Jose-VIA
104	San Jose-VIA
217	San Jose-VIA
200	San Jose-VIA
Light Rail Service	San Jose-VIA
1	San Jose-VIA
2	San Jose-VIA
3	San Jose-VIA
4	San Jose-VIA
5	San Jose-VIA
6	San Jose-VIA
7	San Jose-VIA
8	San Jose-VIA
9	San Jose-VIA
10	San Jose-VIA
11	San Jose-VIA
12	San Jose-VIA
13	San Jose-VIA
14	San Jose-VIA
15	San Jose-VIA
16	San Jose-VIA
17	San Jose-VIA
18	San Jose-VIA
19	San Jose-VIA
20	San Jose-VIA
21	San Jose-VIA
22	San Jose-VIA
23	San Jose-VIA
24	San Jose-VIA
25	San Jose-VIA
26	San Jose-VIA
27	San Jose-VIA
28	San Jose-VIA
29	San Jose-VIA
30	San Jose-VIA
31	San Jose-VIA
32	San Jose-VIA
33	San Jose-VIA
34	San Jose-VIA
35	San Jose-VIA
36	San Jose-VIA
37	San Jose-VIA
38	San Jose-VIA
39	San Jose-VIA
40	San Jose-VIA
41	San Jose-VIA
42	San Jose-VIA
43	San Jose-VIA
44	San Jose-VIA
45	San Jose-VIA
46	San Jose-VIA
47	San Jose-VIA
48	San Jose-VIA
49	San Jose-VIA
50	San Jose-VIA
51	San Jose-VIA
52	San Jose-VIA
53	San Jose-VIA
54	San Jose-VIA
55	San Jose-VIA
56	San Jose-VIA
57	San Jose-VIA
58	San Jose-VIA
59	San Jose-VIA
60	San Jose-VIA
61	San Jose-VIA
62	San Jose-VIA
63	San Jose-VIA
64	San Jose-VIA
65	San Jose-VIA
66	San Jose-VIA
67	San Jose-VIA
68	San Jose-VIA
69	San Jose-VIA
70	San Jose-VIA
71	San Jose-VIA
72	San Jose-VIA
73	San Jose-VIA
74	San Jose-VIA
75	San Jose-VIA
76	San Jose-VIA
77	San Jose-VIA
78	San Jose-VIA
79	San Jose-VIA
80	San Jose-VIA
81	San Jose-VIA
82	San Jose-VIA
83	San Jose-VIA
84	San Jose-VIA
85	San Jose-VIA
86	San Jose-VIA
87	San Jose-VIA
88	San Jose-VIA
89	San Jose-VIA
90	San Jose-VIA
91	San Jose-VIA
92	San Jose-VIA
93	San Jose-VIA
94	San Jose-VIA
95	San Jose-VIA
96	San Jose-VIA
97	San Jose-VIA
98	San Jose-VIA
99	San Jose-VIA
100	San Jose-VIA

Local Bus Service

Transit Line	Service Area
20	San Jose-VIA
47	San Jose-VIA
66	San Jose-VIA
70	San Jose-VIA
71	San Jose-VIA
77	San Jose-VIA
104	San Jose-VIA
217	San Jose-VIA
200	San Jose-VIA
Light Rail Service	San Jose-VIA
1	San Jose-VIA
2	San Jose-VIA
3	San Jose-VIA
4	San Jose-VIA
5	San Jose-VIA
6	San Jose-VIA
7	San Jose-VIA
8	San Jose-VIA
9	San Jose-VIA
10	San Jose-VIA
11	San Jose-VIA
12	San Jose-VIA
13	San Jose-VIA
14	San Jose-VIA
15	San Jose-VIA
16	San Jose-VIA
17	San Jose-VIA
18	San Jose-VIA
19	San Jose-VIA
20	San Jose-VIA
21	San Jose-VIA
22	San Jose-VIA
23	San Jose-VIA
24	San Jose-VIA
25	San Jose-VIA
26	San Jose-VIA
27	San Jose-VIA
28	San Jose-VIA
29	San Jose-VIA
30	San Jose-VIA
31	San Jose-VIA
32	San Jose-VIA
33	San Jose-VIA
34	San Jose-VIA
35	San Jose-VIA
36	San Jose-VIA
37	San Jose-VIA
38	San Jose-VIA
39	San Jose-VIA
40	San Jose-VIA
41	San Jose-VIA
42	San Jose-VIA
43	San Jose-VIA
44	San Jose-VIA
45	San Jose-VIA
46	San Jose-VIA
47	San Jose-VIA
48	San Jose-VIA
49	San Jose-VIA
50	San Jose-VIA
51	San Jose-VIA
52	San Jose-VIA
53	San Jose-VIA
54	San Jose-VIA
55	San Jose-VIA
56	San Jose-VIA
57	San Jose-VIA
58	San Jose-VIA
59	San Jose-VIA
60	San Jose-VIA
61	San Jose-VIA
62	San Jose-VIA
63	San Jose-VIA
64	San Jose-VIA
65	San Jose-VIA
66	San Jose-VIA
67	San Jose-VIA
68	San Jose-VIA
69	San Jose-VIA
70	San Jose-VIA
71	San Jose-VIA
72	San Jose-VIA
73	San Jose-VIA
74	San Jose-VIA
75	San Jose-VIA
76	San Jose-VIA
77	San Jose-VIA
78	San Jose-VIA
79	San Jose-VIA
80	San Jose-VIA
81	San Jose-VIA
82	San Jose-VIA
83	San Jose-VIA
84	San Jose-VIA
85	San Jose-VIA
86	San Jose-VIA
87	San Jose-VIA
88	San Jose-VIA
89	San Jose-VIA
90	San Jose-VIA
91	San Jose-VIA
92	San Jose-VIA
93	San Jose-VIA
94	San Jose-VIA
95	San Jose-VIA
96	San Jose-VIA
97	San Jose-VIA
98	San Jose-VIA
99	San Jose-VIA
100	San Jose-VIA

Local Bus Service

Free Bay Area Transit Information
Dial 511 or visit 511.org

Sponsored by BART in cooperation with AC Transit and the Metropolitan Transportation Commission. Contact us at 510-204-1847 or information@bayareatransit.org

© 2014 Bay Area Transit Information

Printed on Recycled Paper

Map Key

3-Minute Walk

500ft/150m Radius

Transit Information

Station Entrance/Exit

BART Train

Bus

Light Rail

Transit Stop

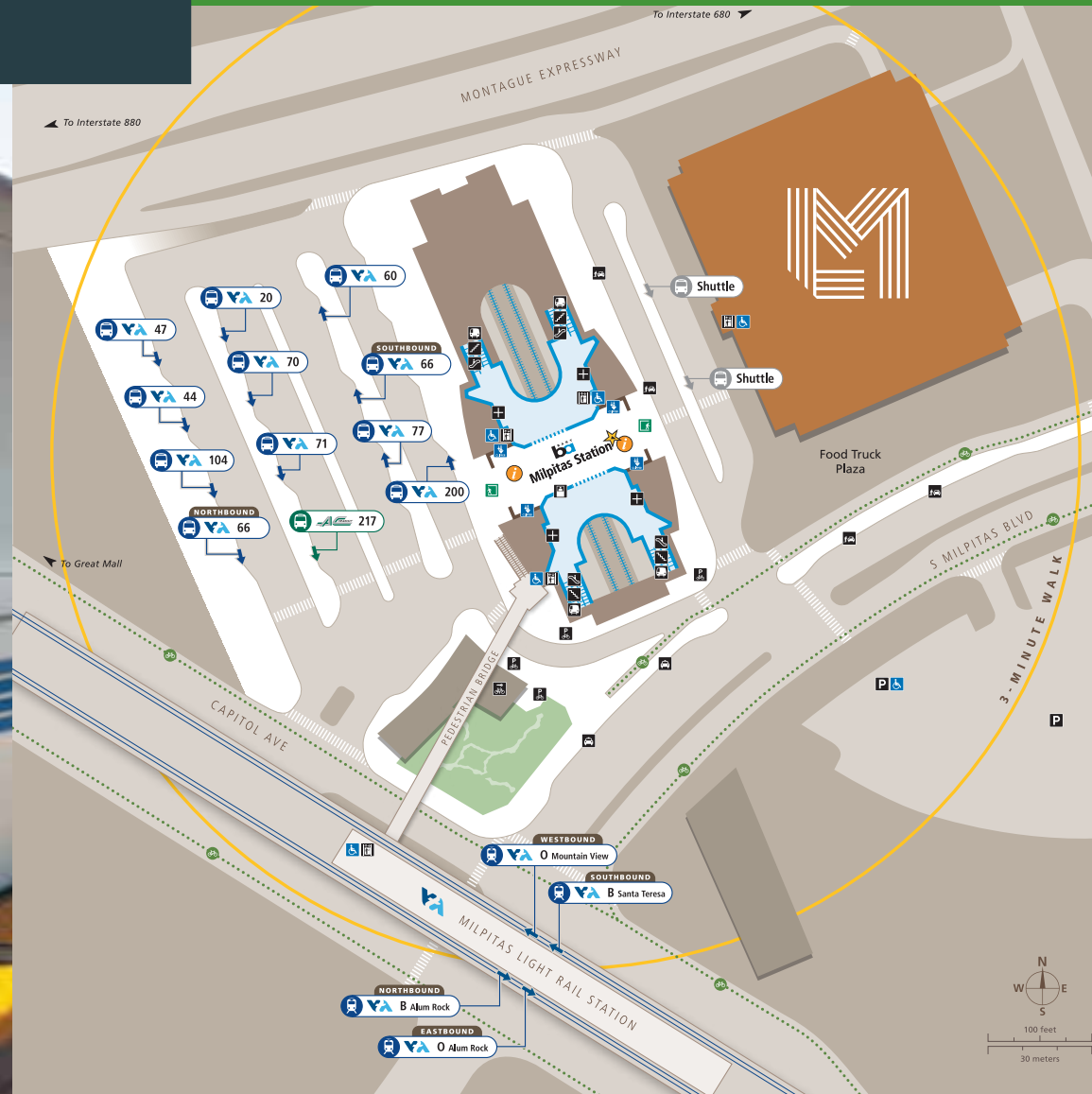

GREAT MALL[®]
A SIMON CENTER

HIGHWAY 680
SINCLAIR FAIRWAY

MONTAGUE EXPRESSWAY

48,047 ADT

BART
ba

BART
ba PARKING

1310
UNITS

203
UNITS

241
UNITS

720
UNITS

114
UNITS

134
UNITS

207
UNITS

489
UNITS

580
UNITS

308
UNITS

381
UNITS

303
UNITS

216
UNITS

486
UNITS

Lantana at Milpitas Station

Centered in the heart of Silicon Valley and next to the Bart Station, Lantana at Milpitas Station is surrounded by several residential communities, totaling over +- 5,700 Units.



WHY MILPITAS?

With the addition of the new Milpitas BART and Transit Station and multiple new mixed-use development projects, Milpitas aims to be the center of the residential growth in Silicon Valley.

#1

FASTEST GROWING
CITY IN SILICON
VALLEY

#2

FASTEST
GROWING CITY
IN CALIFORNIA

#8

FASTEST
GROWING CITY
IN THE USA

#29

BEST SMALL
CITY TO LIVE
IN THE US

37

MEDIAN
AGE

±78K

TOTAL
POPULATION

16%

POPULATION
GROWTH
OVER 5 YRS

20K

DAYTIME
POPULATION

±41K

WORKING
PROFESSIONALS

SOURCES: MILPITAS OFFICE OF ECONOMIC 2023

DEMOGRAPHICS

POPULATION

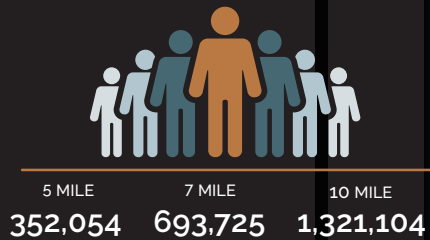

EMPLOYEES



HOUSEHOLD INCOME

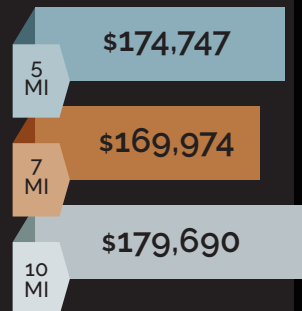

DAYTIME POPULATION



HOUSEHOLDS



SOURCE: ESRI



Lantana at Milpitas Station

1675 S MILPITAS BLVD | MILPITAS, CA 95035

FOR RETAIL LEASING INFORMATION:

TANNER LAVERTY

Laverty Chacón

408.622.4490

tanner@lavertychacon.com

CA BRE Officer #01436559



Laverty Chacón

Commercial Real Estate

This information supplied herein is from sources we deem reliable. It is provided without any representation, warranty, or guarantee, expressed or implied as to its accuracy. Prospective Buyer or Tenant should conduct an independent investigation and verification of all matters deemed to be material, including, but not limited to, statements of income and expenses. Consult your attorney, accountant, or other professional advisor.

