

OFFICE PROPERTY // FOR SUBLEASE

EXECUTIVE SUITES AT HIGH-IMAGE BUILDING ON TELEGRAPH

1668 SOUTH TELEGRAPH RD
BLOOMFIELD TOWNSHIP, MI 48302



- Two suites available: 140 & 165 SF
- Great for an accountant, financial planner, tutor, etc.
- Excellent location close to Bloomfield Hills
- Close to restaurants, shopping, business services
- Short-term lease preferred



P.A. COMMERCIAL
Corporate & Investment Real Estate

26555 Evergreen Road, Suite 1500
Southfield, MI 48076
248.358.0100
pacommercial.com

We obtained the information above from sources we believe to be reliable. However, we have not verified its accuracy and make no guarantee, warranty or representation about it. It is submitted subject to the possibility of errors, omissions, change of price, rental or other conditions, prior sale, lease or financing, or withdrawal without notice. We include projections, opinions, assumptions or estimates for example only, and they may not represent current, past or future performance of the property. You and your tax and legal advisors should conduct your own investigation of the property and transaction.

1668 SOUTH TELEGRAPH RD, BLOOMFIELD TOWNSHIP, MI 48302 // FOR LEASE

EXECUTIVE SUMMARY

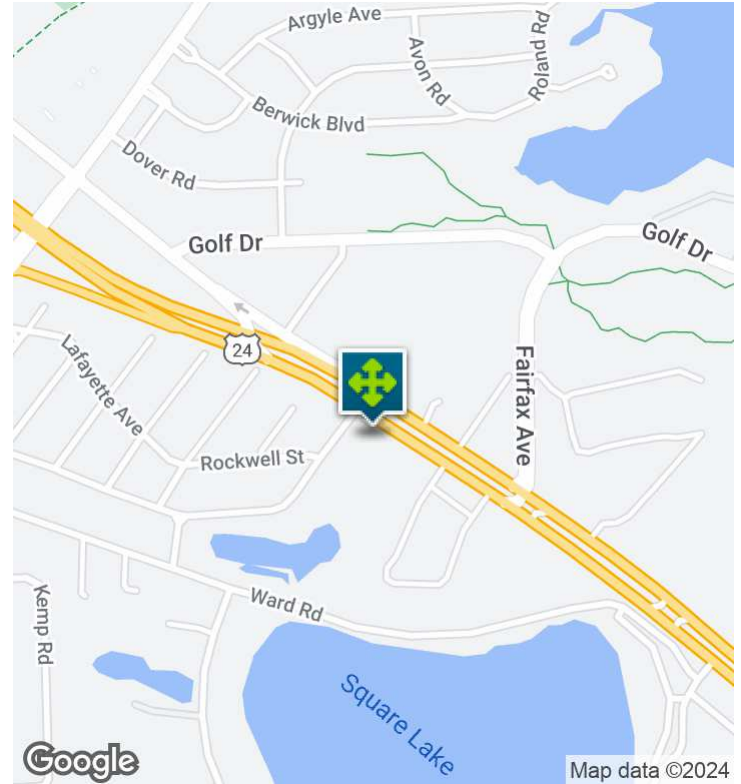

| | |
|------------|--|
| Lease Rate | \$550.00 - 650.00 PER MONTH (GROSS) |
|------------|--|

OFFERING SUMMARY

| | |
|----------------|------------------------------|
| Building Size: | 24,536 SF |
| Available SF: | 140 - 165 SF |
| Year Built: | 1998 |
| Zoning: | O-1 Office Building District |
| Market: | Detroit |
| Submarket: | North Oakland |
| Traffic Count: | 61,411 |

PROPERTY OVERVIEW

Quiet professional, office suites available inside a suite leased by Blue River Financial. Lobby, conference room, and office amenities are included. Ideal location for an accountant, financial planner, manufacturer's agent, etc.. All utilities and janitorial are included. Short-term lease preferred.

LOCATION OVERVIEW

Conveniently located on the south side of Telegraph Rd, east of Orchard Lake Rd . Easy access to many communities in Oakland County and just minutes from I-75 and M-59.

PROPERTY HIGHLIGHTS

- Two suites available: 140 & 165 SF
- Great for an accountant, financial planner, tutor, etc.
- Excellent location close to Bloomfield Hills
- Short-term lease preferred

1668 SOUTH TELEGRAPH RD, BLOOMFIELD TOWNSHIP, MI 48302 // FOR LEASE

LEASE SPACES

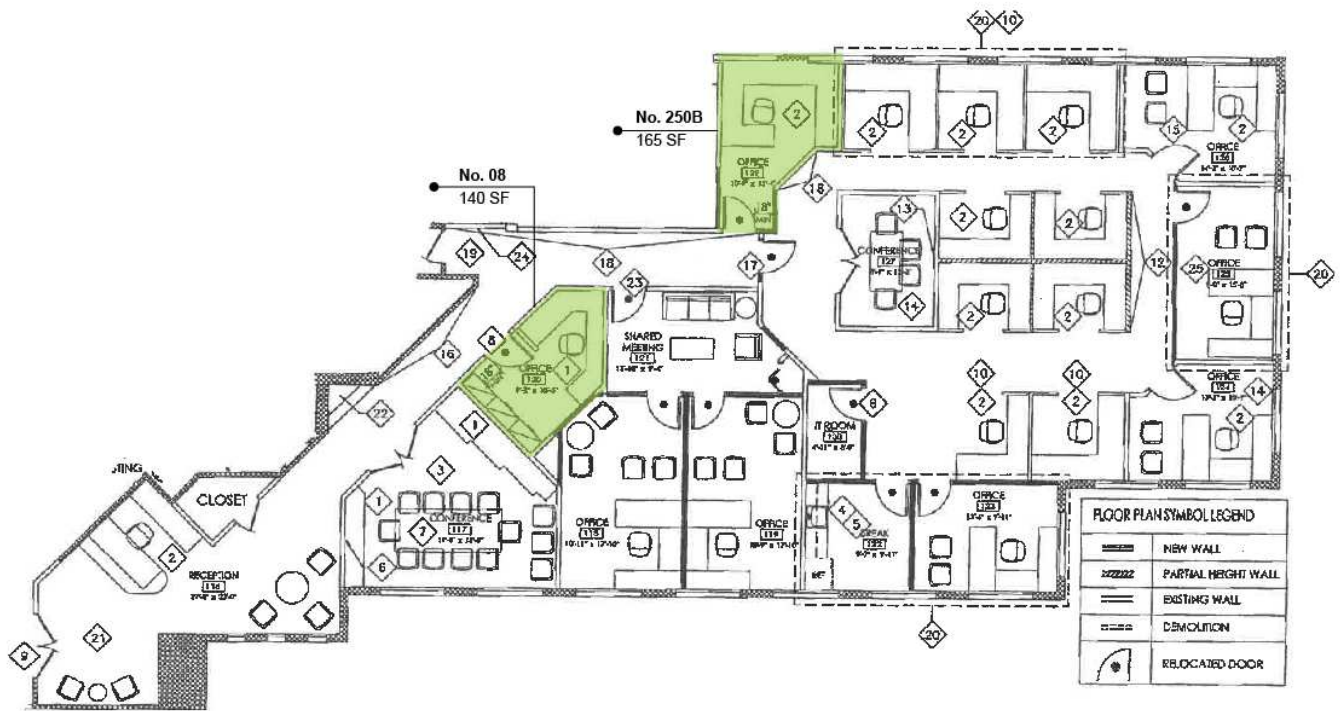

LEASE INFORMATION

| | | | |
|---------------------|--------------|--------------------|-------------------------------|
| Lease Type: | Gross | Lease Term: | Negotiable |
| Total Space: | 140 - 165 SF | Lease Rate: | \$550.00 - \$650.00 per month |

AVAILABLE SPACES

| SUITE | TENANT | SIZE (SF) | LEASE TYPE | LEASE RATE | DESCRIPTION |
|-------------------------------------|-----------|-----------|------------|-----------------|-------------|
| 1668 South Telegraph Rd, Suite 250B | Available | 165 SF | Gross | \$650 per month | - |
| 1668 South Telegraph Rd, Suite 8 | Available | 140 SF | Gross | \$550 per month | - |

1668 SOUTH TELEGRAPH RD, BLOOMFIELD TOWNSHIP, MI 48302 // FOR LEASE
BUILDING LOBBY PHOTOS



1668 SOUTH TELEGRAPH RD, BLOOMFIELD TOWNSHIP, MI 48302 // FOR LEASE

ADDITIONAL PHOTOS



P.A. COMMERCIAL
Corporate & Investment Real Estate

We obtained the information above from sources we believe to be reliable. However, we have not verified its accuracy and make no guarantee, warranty or representation about it. It is submitted subject to the possibility of errors, omissions, change of price, rental or other conditions, prior sale, lease or financing, or withdrawal without notice. We include projections, opinions, assumptions or estimates for example only, and they may not represent current, past or future performance of the property. You and your tax and legal advisors should conduct your own investigation of the property and transaction.

Kevin Bull SENIOR ASSOCIATE
D: 248.358.5361 | C: 248.895.9972
kevin@pacommercial.com

RETAILER MAP



We obtained the information above from sources we believe to be reliable. However, we have not verified its accuracy and make no guarantee, warranty or representation about it. It is submitted subject to the possibility of errors, omissions, change of price, rental or other conditions, prior sale, lease or financing, or withdrawal without notice. We include projections, opinions, assumptions or estimates for example only, and they may not represent current, past or future performance of the property. You and your tax and legal advisors should conduct your own investigation of the property and transaction.

1668 SOUTH TELEGRAPH RD, BLOOMFIELD TOWNSHIP, MI 48302 // FOR LEASE

DEMOGRAPHICS MAP & REPORT

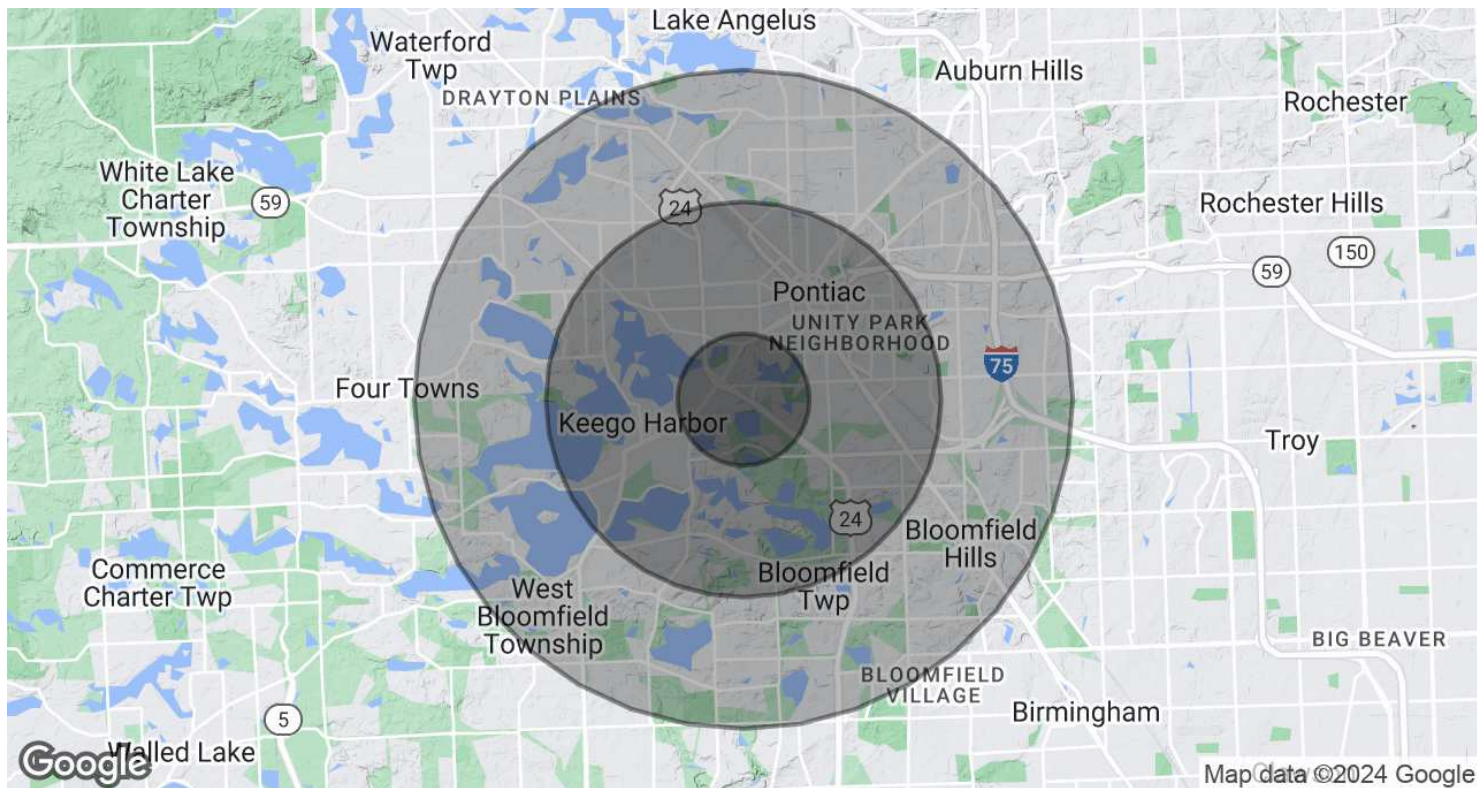

| POPULATION | 1 MILE | 3 MILES | 5 MILES |
|----------------------|--------|---------|---------|
| Total Population | 5,729 | 66,688 | 167,806 |
| Average Age | 41.1 | 37.3 | 37.8 |
| Average Age (Male) | 39.9 | 35.8 | 36.7 |
| Average Age (Female) | 42.7 | 38.8 | 39.1 |

| HOUSEHOLDS & INCOME | 1 MILE | 3 MILES | 5 MILES |
|---------------------|-----------|-----------|-----------|
| Total Households | 2,675 | 26,320 | 65,679 |
| # of Persons per HH | 2.1 | 2.5 | 2.6 |
| Average HH Income | \$72,391 | \$76,490 | \$85,244 |
| Average House Value | \$319,692 | \$188,601 | \$252,734 |

* Demographic data derived from 2020 ACS - US Census

1668 SOUTH TELEGRAPH RD, BLOOMFIELD TOWNSHIP, MI 48302 // FOR LEASE

CONTACT US



FOR MORE INFORMATION, PLEASE CONTACT:



Kevin Bull

SENIOR ASSOCIATE

D: 248.358.5361

C: 248.895.9972

kevin@pacommercial.com

P.A. Commercial

26555 Evergreen Road, Suite 1500

Southfield, MI 48076

P: 248.358.0100

F: 248.358.5300

pacommercial.com

Follow Us!



P.A. COMMERCIAL
Corporate & Investment Real Estate

We obtained the information above from sources we believe to be reliable. However, we have not verified its accuracy and make no guarantee, warranty or representation about it. It is submitted subject to the possibility of errors, omissions, change of price, rental or other conditions, prior sale, lease or financing, or withdrawal without notice. We include projections, opinions, assumptions or estimates for example only, and they may not represent current, past or future performance of the property. You and your tax and legal advisors should conduct your own investigation of the property and transaction.