



# FOR SALE

St. Lucie Gardens Apartments - Approved 81 Unit Multi-Family Site

322 Kitterman Road

Port Saint Lucie, FL 34952

## PROPERTY OVERVIEW

Residential development land, site plan approved for 81 low rise multifamily units. Features of the approved plan include: 8 two story buildings, with 68 2BR/2BA and 12 2BR/1BA units, a manager's apartment and an office & pool. 179 parking spaces. To be served by water & sewer from Port St. Lucie Utilities.

## LOCATION OVERVIEW

Conveniently located just off US1 and Kitterman Rd in Port St. Lucie, east of US1, in an area of single and multifamily residential, and with an elementary school nearby. Close to shopping and restaurants. Lennard Road provides an alternate north/south corridor to US1.

## OFFERING SUMMARY

Land Size:

9.75 Acres

Land Use:

RM - Residential Medium Density

Zoning:

RM-9 - St. Lucie County

SALE PRICE

\$2,800,000



**JEFFREY D. CHAMBERLIN**

PRESIDENT/BROKER, CCIM,  
SIOR

Mobile 772.528.6056  
chamberlin@slccommercial.com

772.220.4096 | slccommercial.com



**SLC Commercial**  
Realty & Development



The information contained herein has been obtained from sources believed to be reliable, but no warranty or representation, expressed or implied, is made. All sizes and dimensions are approximate. Any prospective buyer should exercise prudence and verify independently all significant data and property information. This is NOT an offer of sub-agency or co-brokerage.

# Property Details

ST. LUCIE GARDENS APARTMENTS - APPROVED 81 UNIT MULTI-FAMILY SITE

FOR SALE

SALE PRICE	\$2,800,000
------------	-------------

Location Information	
Building Name	St. Lucie Gardens Apartments - Approved 81 Unit Multi-Family Site
Street Address	322 Kitterman Road
City, State, Zip	Port Saint Lucie, FL 34952
County/Township	Saint Lucie County

Zoning / Land Use Details	
Zoning	RM-9 - St. Lucie County
Land Use	RM - Residential Medium Density
Permitted Use	See Below

[Click here for permitted uses](#)

Property Details	
Property Type	Land
Property Subtype	Multifamily
Lot Size	9.75 Acres
APN#	3415-501-0016-000-6
Corner Property	No
Waterfront	No

Utilities	
Water & Sewer	Yes

Location Overview	
Conveniently located just off US1 and Kitterman Rd in Port St. Lucie, east of US1, in an area of single and multifamily residential, and with an elementary school nearby. Close to shopping and restaurants. Lennard Road provides an alternate north/south corridor to US1.	

## ST. LUCIE GARDENS APARTMENTS - APPROVED 81 UNIT MULTI-FAMILY SITE

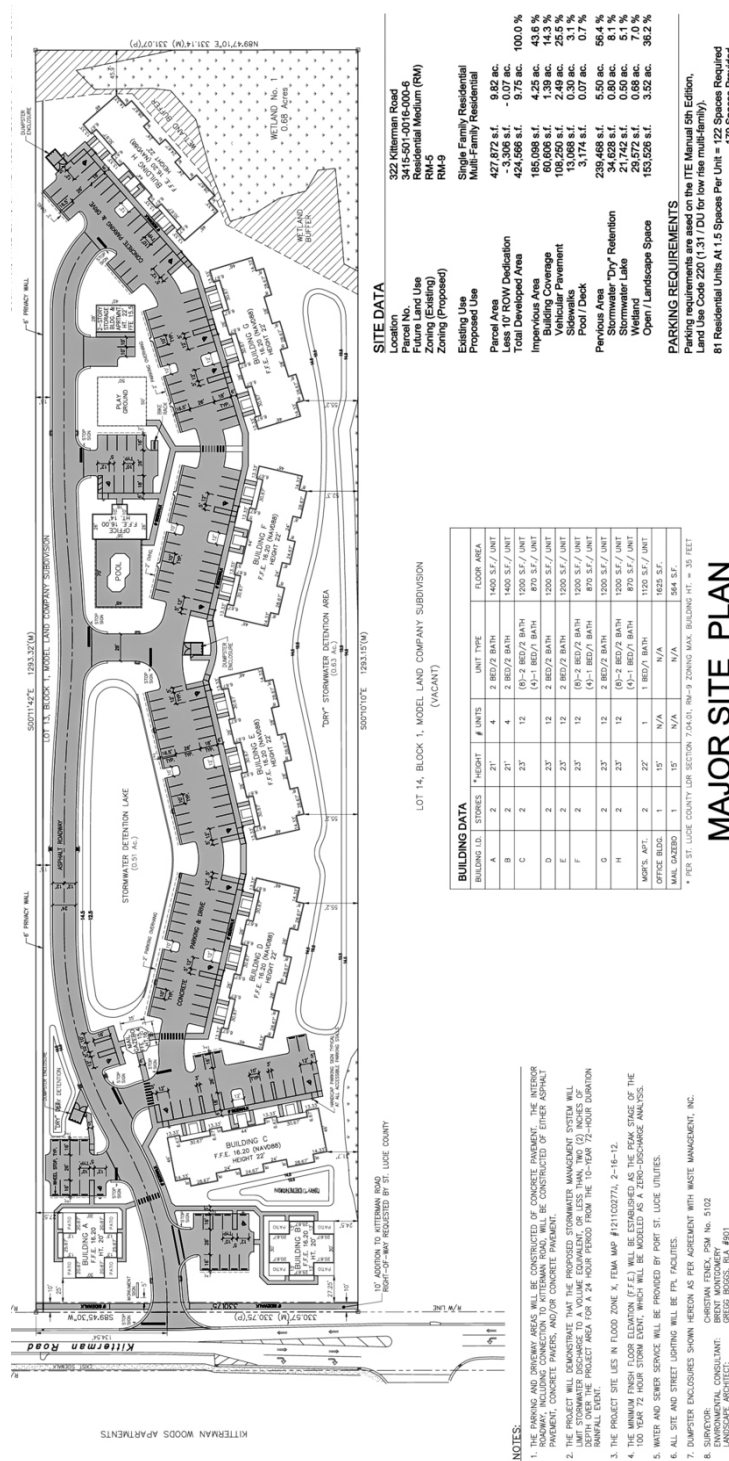
[illegible]

The information contained herein has been obtained from sources believed to be reliable, but no warranty or representation, expressed or implied, is made. All sizes and dimensions are approximate. Any prospective buyer should exercise prudence and verify independently all significant data and property information. This is NOT an offer of sub-agency or co-brokerage.



# Area Map

ST. LUCIE GARDENS APARTMENTS - APPROVED 81 UNIT MULTI-FAMILY SITE

# FOR SALE





# Location Map

ST. LUCIE GARDENS APARTMENTS - APPROVED 81 UNIT MULTI-FAMILY SITE

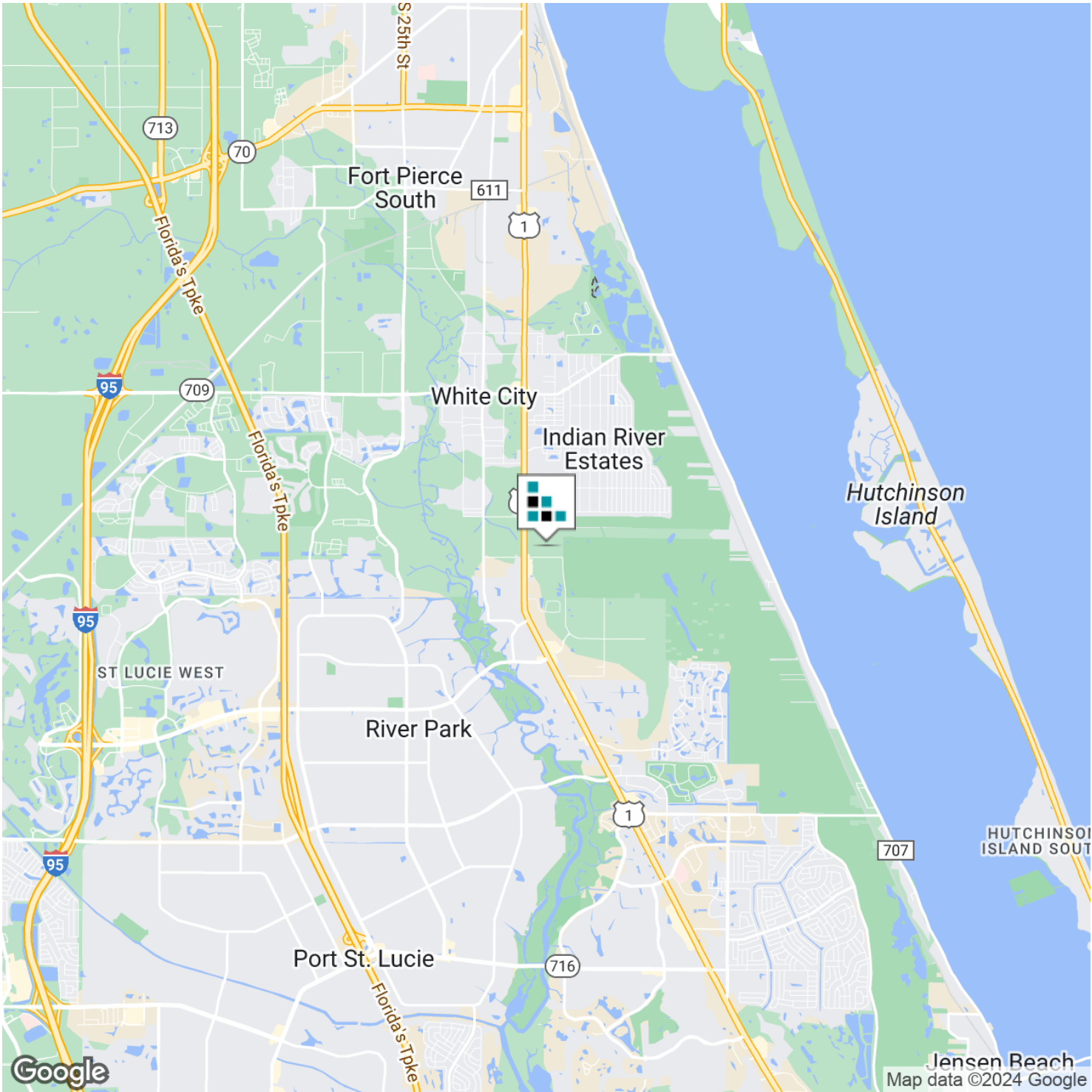

The information contained herein has been obtained from sources believed to be reliable, but no warranty or representation, expressed or implied, is made. All sizes and dimensions are approximate. Any prospective buyer should exercise prudence and verify independently all significant data and property information. This is NOT an offer of sub-agency or co-brokerage.

# Demographics Map

ST. LUCIE GARDENS APARTMENTS - APPROVED 81 UNIT MULTI-FAMILY SITE

FOR SALE

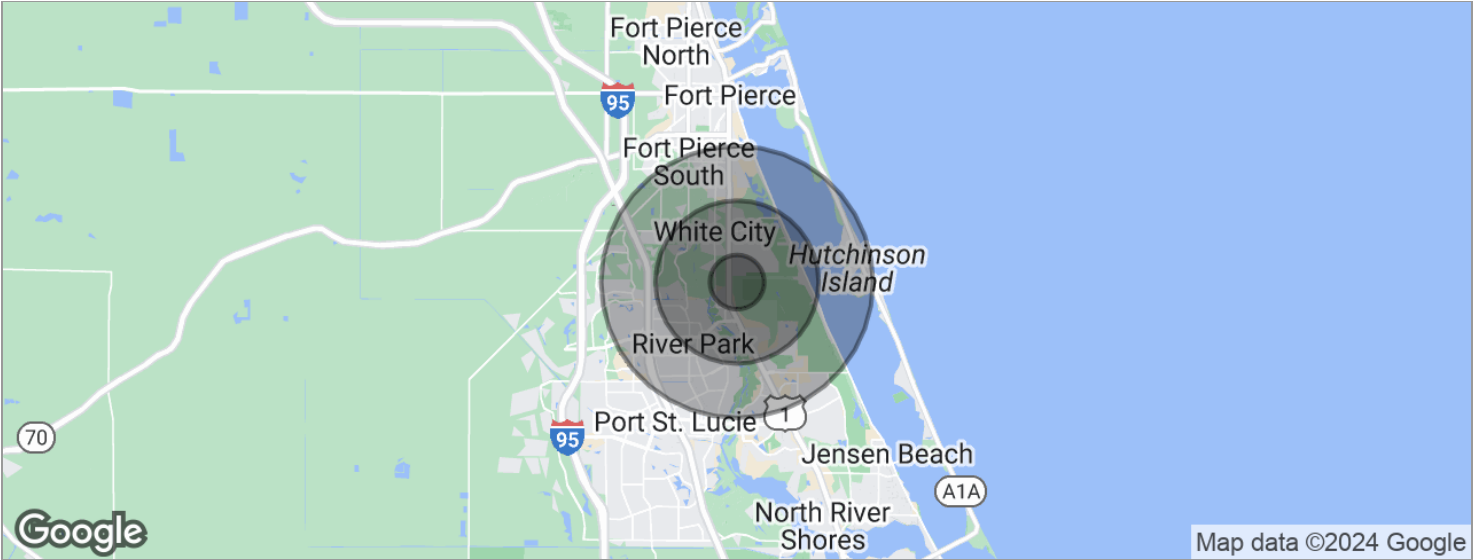

POPULATION	1 MILE	3 MILES	5 MILES
Total population	4,426	40,911	114,752
Median age	52.6	48.9	46.2
Median age (Male)	50.8	46.5	44.8
Median age (Female)	54.6	49.5	46.7
HOUSEHOLDS & INCOME	1 MILE	3 MILES	5 MILES
Total households	2,075	17,708	49,700
# of persons per HH	2.1	2.3	2.3
Average HH income	\$63,987	\$60,182	\$59,220
Average house value	\$193,748	\$185,652	\$192,025

\* Demographic data derived from 2020 ACS - US Census

# Disclaimer

ST. LUCIE GARDENS APARTMENTS - APPROVED 81 UNIT MULTI-FAMILY SITE

FOR SALE

This presentation package has been prepared by the company representing the property for informational purposes only and does not purport to contain all information necessary to reach a purchase decision.

The information herein has been given by the Owner or other sources believed to be reliable, but it has not necessarily been independently verified by the Company representing the property and neither its accuracy nor its completeness is guaranteed.

This information is subject to errors, omissions, changes, prior sale or withdrawal without notice by the Company representing the property and does not constitute a recommendation, endorsement or advice as to the value for the purchase of any property. Each prospective lessee or purchaser is to rely upon his/her own investigation, evaluation and judgment as to the advisability of leasing or purchasing the property.

Furthermore, any financial information and calculations presented in this analysis are believed to be accurate, but are not guaranteed and are intended for the purposes of projection and analysis only. The user of this financial information contained herein should consult a tax specialist concerning his/her particular circumstances before making any investment.

