

BENSALEM PROFESSIONAL PLAZA

3237 Bristol Road, Bensalem, PA 19020

 **FOR LEASE**

 **OFFICE**

 **570 - 4,030 SF**



**CLICK HERE FOR A
VIRTUAL TOUR**



PROPERTY DESCRIPTION

- Two suites available on first floor
- Second floor fully leased
- Attractive, elevator served building consisting of multiple private offices, open areas, waiting areas, conference room, kitchenette and plenty of parking
- 2 miles to US Route 1/Lincoln Highway, PA Turnpike & Neshaminy Mall; 5 miles to I-95/I-295
- Close proximity to shopping, restaurants, bank and hotels

LEASE RATE:

\$18.00 SF/YR GROSS + UTILITIES

FOR MORE INFORMATION

Zena Charokopos

 215.396.2900 x103

 zena.charokopos@naimertz.com

Joe Sternberg

 215.396.2900 x107

 joe.sternberg@naimertz.com

NAI MERTZ DISCLAIMER: NO WARRANTY OR REPRESENTATION, EXPRESS OR IMPLIED, IS MADE AS TO THE ACCURACY OF THE INFORMATION CONTAINED HEREIN, AND THE SAME IS SUBMITTED SUBJECT TO ERRORS, OMISSIONS, CHANGE OF PRICE, RENTAL OR OTHER CONDITIONS, PRIOR SALE, LEASE OR FINANCING, OR WITHDRAWAL WITHOUT NOTICE, AND OF ANY SPECIAL LISTING CONDITIONS IMPOSED BY OUR PRINCIPALS. NO WARRANTIES OR REPRESENTATIONS ARE MADE AS TO THE CONDITION OF THE PROPERTY OR ANY HAZARDS CONTAINED THEREIN ARE ANY TO BE IMPLIED. OUTLINES ARE APPROXIMATE AND SHOWN ONLY TO IDENTIFY THE PARCEL IN CONSIDERATION.

NAI Mertz

 **NAI Mertz** | 210 E. Street Road, Suite 3B
Feasterville-Trevose, PA 19053
215-396-2900 | naimertz.com



BENSALEM PROFESSIONAL PLAZA

First Floor Availabilities

 FOR LEASE

 OFFICE

 570 - 4,030 SF

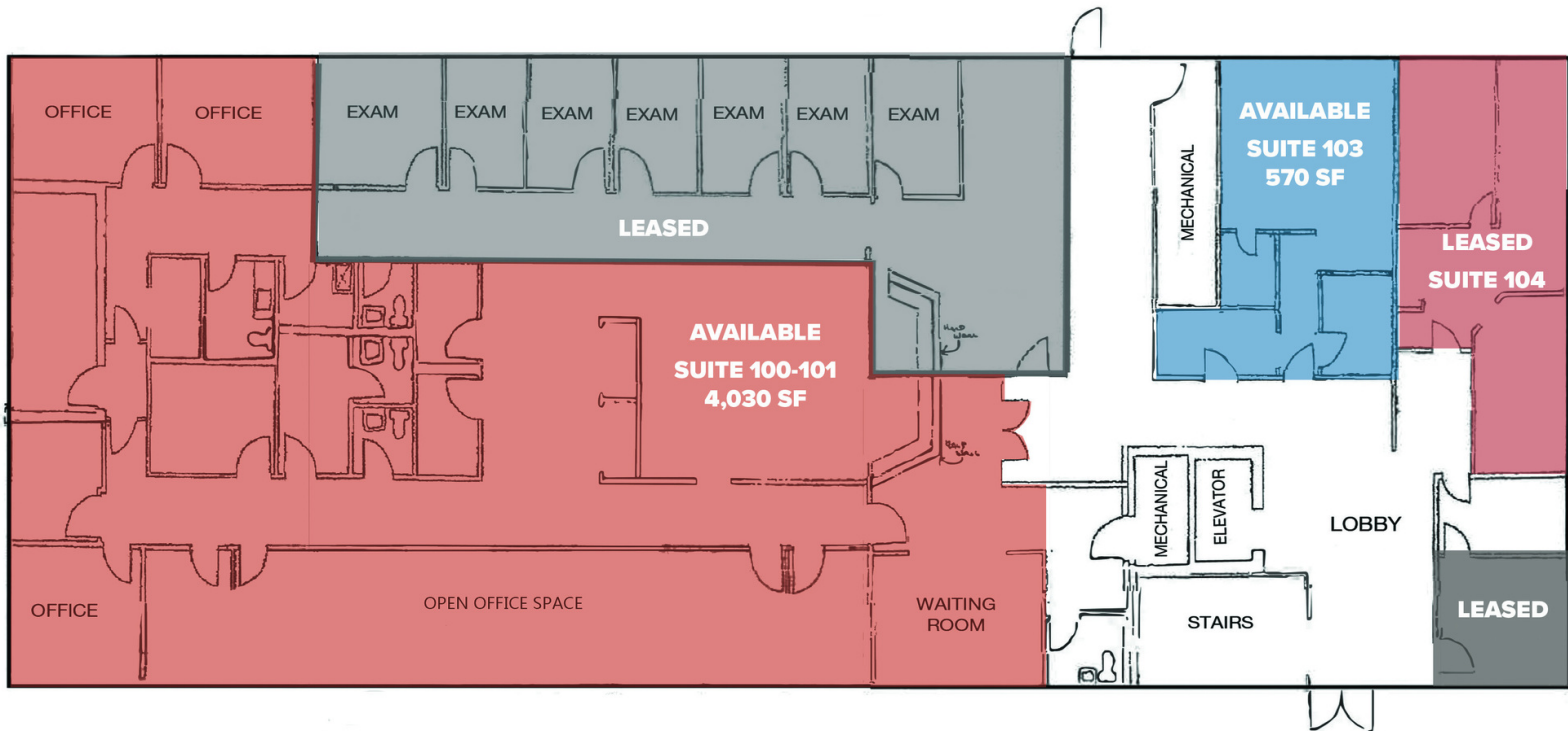

FOR MORE INFORMATION

Zena Charokopos

 215.396.2900 x103

 zena.charokopos@naimertz.com

Joe Sternberg

 215.396.2900 x107

 joe.sternberg@naimertz.com

NAI MERTZ DISCLAIMER: NO WARRANTY OR REPRESENTATION, EXPRESS OR IMPLIED, IS MADE AS TO THE ACCURACY OF THE INFORMATION CONTAINED HEREIN, AND THE SAME IS SUBMITTED SUBJECT TO ERRORS, OMISSIONS, CHANGE OF PRICE, RENTAL OR OTHER CONDITIONS, PRIOR SALE, LEASE OR FINANCING, OR WITHDRAWAL WITHOUT NOTICE, AND OF ANY SPECIAL LISTING CONDITIONS IMPOSED BY OUR PRINCIPALS. NO WARRANTIES OR REPRESENTATIONS ARE MADE AS TO THE CONDITION OF THE PROPERTY OR ANY HAZARDS CONTAINED THEREIN ARE ANY TO BE IMPLIED. OUTLINES ARE APPROXIMATE AND SHOWN ONLY TO IDENTIFY THE PARCEL IN CONSIDERATION.

NAIMertz

 **NAI Mertz** | 210 E. Street Road, Suite 3B
Feasterville-Trevose, PA 19053
215-396-2900 | naimertz.com



BENSALEM PROFESSIONAL PLAZA

3237 Bristol Road, Bensalem, PA 19020



FOR LEASE



OFFICE



570 - 4,030 SF

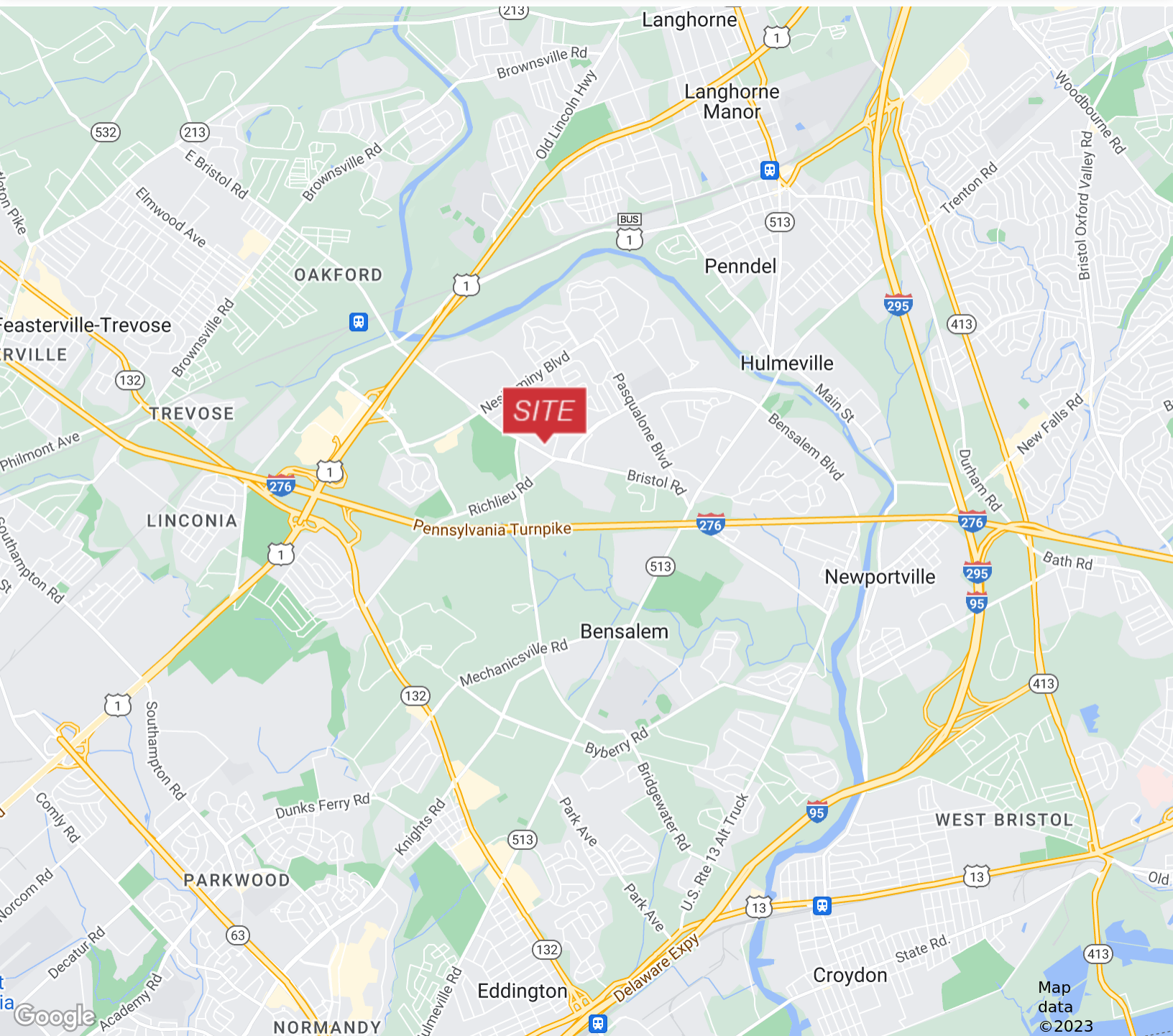

FOR MORE INFORMATION

Zena Charokopos

215.396.2900 x103

zena.charokopos@naimertz.com

Joe Sternberg

215.396.2900 x107

joe.sternberg@naimertz.com

NAI MERTZ DISCLAIMER: NO WARRANTY OR REPRESENTATION, EXPRESS OR IMPLIED, IS MADE AS TO THE ACCURACY OF THE INFORMATION CONTAINED HEREIN, AND THE SAME IS SUBMITTED SUBJECT TO ERRORS, OMISSIONS, CHANGE OF PRICE, RENTAL OR OTHER CONDITIONS, PRIOR SALE, LEASE OR FINANCING, OR WITHDRAWAL WITHOUT NOTICE, AND OF ANY SPECIAL LISTING CONDITIONS IMPOSED BY OUR PRINCIPALS. NO WARRANTIES OR REPRESENTATIONS ARE MADE AS TO THE CONDITION OF THE PROPERTY OR ANY HAZARDS CONTAINED THEREIN ARE ANY TO BE IMPLIED. OUTLINES ARE APPROXIMATE AND SHOWN ONLY TO IDENTIFY THE PARCEL IN CONSIDERATION.

NAI Mertz



NAI Mertz | 210 E. Street Road, Suite 3B

Feasterville-Trevoze, PA 19053

215-396-2900 | naimertz.com

