



3010 Whipple Ave NW
Canton, Ohio 44718

SALE PRICE	\$2,500,000.00
LEASE RATE	\$16.00/SF/NNN
TOTAL SQ FT	13,788
LAND AREA	1.9 Acres
PARCEL	5218148
ZONING	B2
FRONTAGE	292' Whipple 158' Hills & Dales
TOWNSHIP	Plain
TRAFFIC COUNT	27,781 AADT
TAXES	\$18,766.99/half



Property Features

- Former Rite Aid located on the high traffic corner of Whipple Ave and Hills & Dales Rd.
- 8' delivery door, 3 drive thru lanes.
- 82 parking spaces with potential to add more.
- Owner will consider dividing space.
- Ingress/Egress from three roads.

Sean Sanford

330 284 0331 • sean@naispring.com

Jared Sanford

330 354 3466 • jared@naispring.com

FOR SALE/LEASE/LAND LEASE

3010 Whipple Ave NW

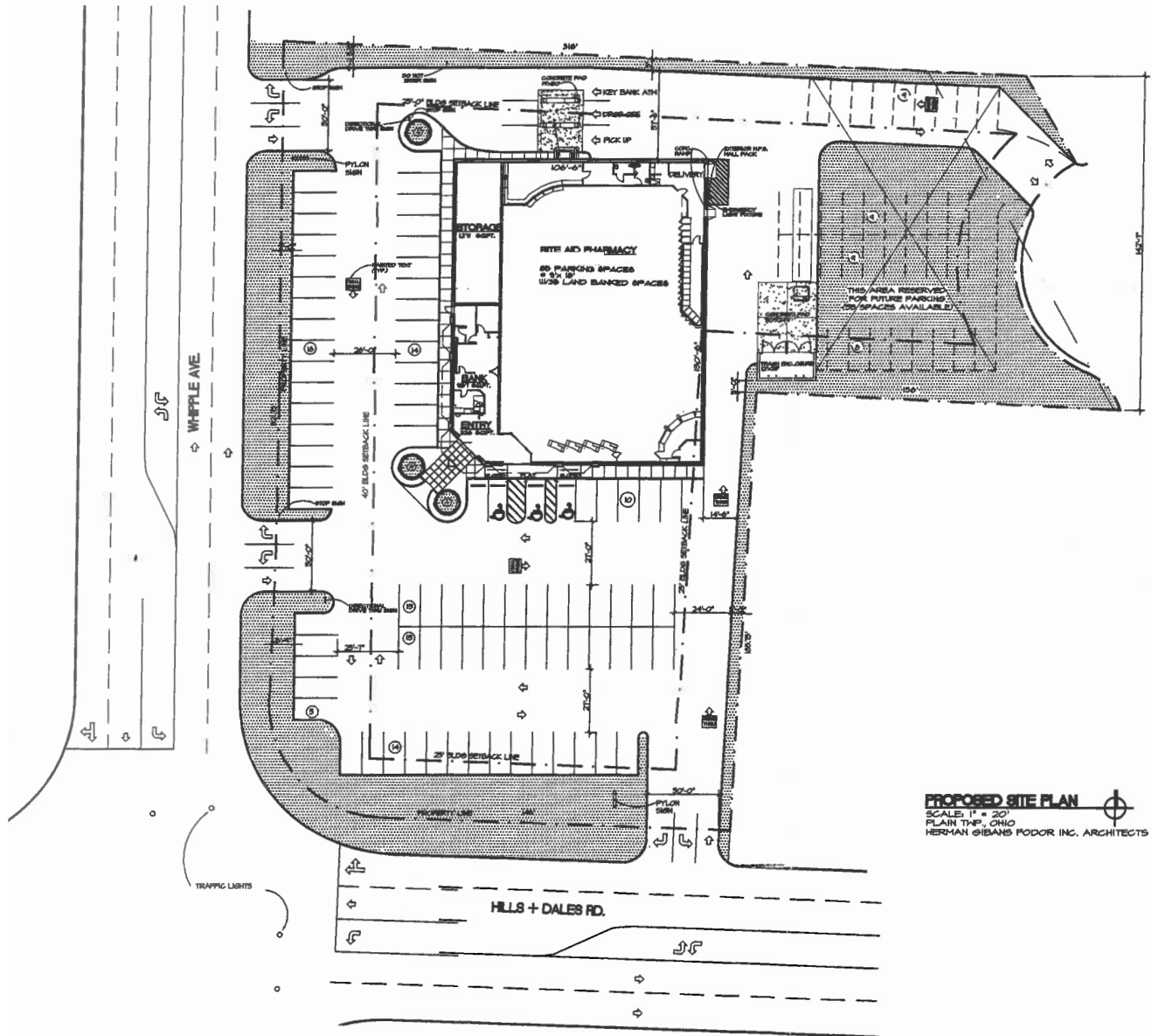

NO WARRANTY OR REPRESENTATION, EXPRESS OR IMPLIED, IS MADE AS TO THE ACCURACY OF THE INFORMATION CONTAINED HEREIN, AND THE SAME IS SUBMITTED SUBJECT TO ERRORS, OMISSIONS, CHANGE OF PRICE, RENTAL OR OTHER CONDITIONS, PRIOR SALE, LEASE OR FINANCING, OR WITHDRAWAL WITHOUT NOTICE, AND OF ANY SPECIAL LISTING CONDITIONS IMPOSED BY OUR PRINCIPALS NO WARRANTIES OR REPRESENTATIONS ARE MADE AS TO THE CONDITION OF THE PROPERTY OR ANY HAZARDS CONTAINED THEREIN ARE ANY TO BE IMPLIED.

8234 Pittsburg Ave NW
North Canton, Ohio 44720
330-966-8800
naispring.com

FOR SALE/LEASE/LAND LEASE

3010 Whipple Ave NW



NO WARRANTY OR REPRESENTATION, EXPRESS OR IMPLIED, IS MADE AS TO THE ACCURACY OF THE INFORMATION CONTAINED HEREIN, AND THE SAME IS SUBMITTED SUBJECT TO ERRORS, OMISSIONS, CHANGE OF PRICE, RENTAL OR OTHER CONDITIONS, PRIOR SALE, LEASE OR FINANCING, OR WITHDRAWAL WITHOUT NOTICE, AND OF ANY SPECIAL LISTING CONDITIONS IMPOSED BY OUR PRINCIPALS NO WARRANTIES OR REPRESENTATIONS ARE MADE AS TO THE CONDITION OF THE PROPERTY OR ANY HAZARDS CONTAINED THEREIN ARE ANY TO BE IMPLIED.

8234 Pittsburg Ave NW
North Canton, Ohio 44720
330-966-8800
naispring.com

FOR SALE/LEASE/LAND LEASE

3010 Whipple Ave NW

2023 Summary

	1 Mile	3 Miles	5 Miles
Population	5,445	69,969	174,253
Households	2,851	31,102	75,854
Families	1,325	17,016	44,277
Average Household Size	1.88	2.20	2.25
Owner Occupied Housing Units	1,766	18,827	46,481
Renter Occupied Housing Units	1,085	12,275	29,373
Median Age	56.4	44.2	43.2
Median Household Income	\$63,392	\$55,141	\$55,082
Average Household Income	\$94,095	\$80,449	\$82,065

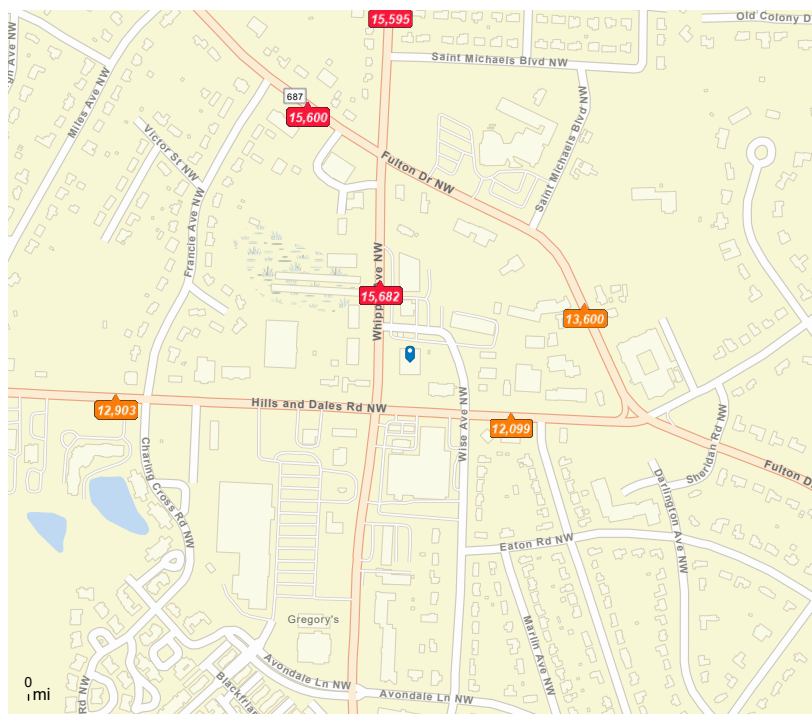
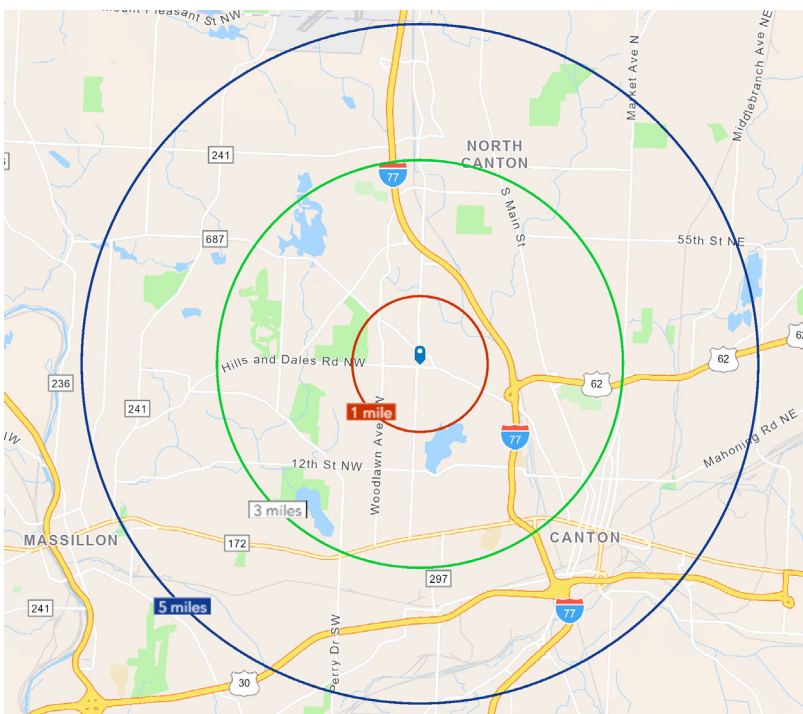

NO WARRANTY OR REPRESENTATION, EXPRESS OR IMPLIED, IS MADE AS TO THE ACCURACY OF THE INFORMATION CONTAINED HEREIN, AND THE SAME IS SUBMITTED SUBJECT TO ERRORS, OMISSIONS, CHANGE OF PRICE, RENTAL OR OTHER CONDITIONS, PRIOR SALE, LEASE OR FINANCING, OR WITHDRAWAL WITHOUT NOTICE, AND OF ANY SPECIAL LISTING CONDITIONS IMPOSED BY OUR PRINCIPALS NO WARRANTIES OR REPRESENTATIONS ARE MADE AS TO THE CONDITION OF THE PROPERTY OR ANY HAZARDS CONTAINED THEREIN ARE ANY TO BE IMPLIED.

8234 Pittsburg Ave NW
North Canton, Ohio 44720
330-966-8800
naispring.com