

113 MAIN ST S

# South Main Street Retail Building



Lease Rate

**\$6.00 SF/YR**

## OFFERING SUMMARY

Building Size:	7,596 SF
Available SF:	7,596 SF
Year Built:	1963
Zoning:	Commercial

## PROPERTY OVERVIEW

This Main Street Property is in great condition and ready for your business to move in. The front retail front has updated windows, canopy, and entrance. Within the building you will find several floors for clean and dry retail sales, storage, and office. Dating back this building was a furniture store and since 1995 has been used as a paper/office product store. You will find that the building has been well maintained with improvements ranging from a new roof to one new furnace. The city of Stewartville is looking forward to what business may be able to call this property a great place to operate in the years to come.

## PROPERTY HIGHLIGHTS

- Located downtown Stewartville MN
- High visibility from Hwy 63
- Move-in ready retail space

**BUCKY BEEMAN**

507.951.7130

bucky@rgi-group.com

**MATT GOVE**

507.951.1147

matt@rgi-group.com

416 SOUTH BROADWAY, SUITE #1 | 507.951.7130 | **RGI-GROUP.COM**



113 MAIN ST S

# South Main Street Retail Building



BUCKY BEEMAN

507.951.7130

bucky@rgi-group.com

MATT GOVE

507.951.1147

matt@rgi-group.com

416 SOUTH BROADWAY, SUITE #1 | 507.951.7130 | RGI-GROUP.COM





113 MAIN ST S

# South Main Street Retail Building

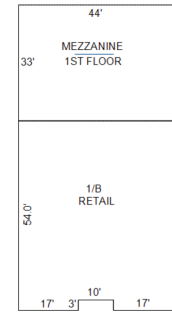

BUCKY BEEMAN

507.951.7130

bucky@rgi-group.com

MATT GOVE

507.951.1147

matt@rgi-group.com

416 SOUTH BROADWAY, SUITE #1 | 507.951.7130 | RGI-GROUP.COM





# South Main Street Retail Building

POPULATION	1 MILE	3 MILES	5 MILES
Total Population	3,029	6,923	8,311
Average Age	36.7	36.2	36.8
Average Age (Male)	35.6	35.3	35.9
Average Age (Female)	37.3	36.8	37.7

HOUSEHOLDS & INCOME	1 MILE	3 MILES	5 MILES
Total Households	1,268	2,781	3,329
# of Persons per HH	2.4	2.5	2.5
Average HH Income	\$74,348	\$79,490	\$82,573
Average House Value	\$196,261	\$207,485	\$222,498

2020 American Community Survey (ACS)

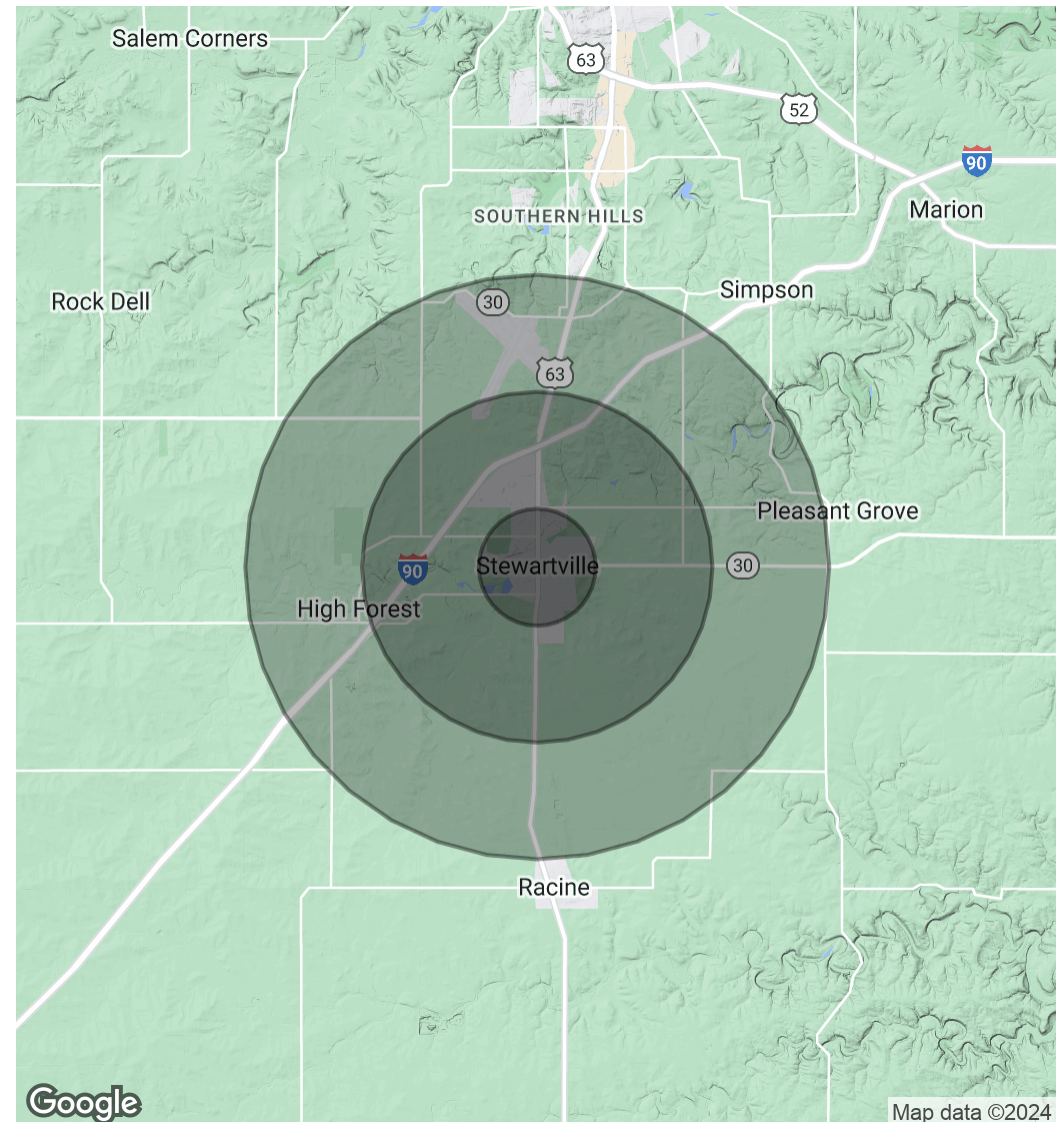

BUCKY BEEMAN

507.951.7130

bucky@rgi-group.com

MATT GOVE

507.951.1147

matt@rgi-group.com



# South Main Street Retail Building

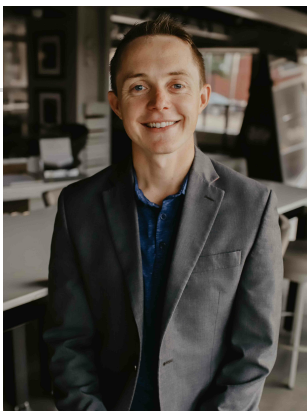

**BUCKY BEEMAN**

Realtor-Developer-Partner

**Direct:** 507.951.7130 **Cell:** 507.951.7130  
bucky@rgi-group.com

MN #40149580



**MATT GOVE**

Agent

**Direct:** 507.951.1147 **Cell:** 507.951.1147  
matt@rgi-group.com

MN #40779556

**BUCKY BEEMAN**

507.951.7130  
bucky@rgi-group.com

**MATT GOVE**

507.951.1147  
matt@rgi-group.com

# South Main Street Retail Building

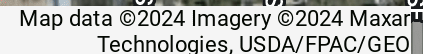

[matt@rgi-group.com](mailto:matt@rgi-group.com)

