

1798 FAIRVIEW AVE

PRATTVILLE, AL 36066

Executive Summary

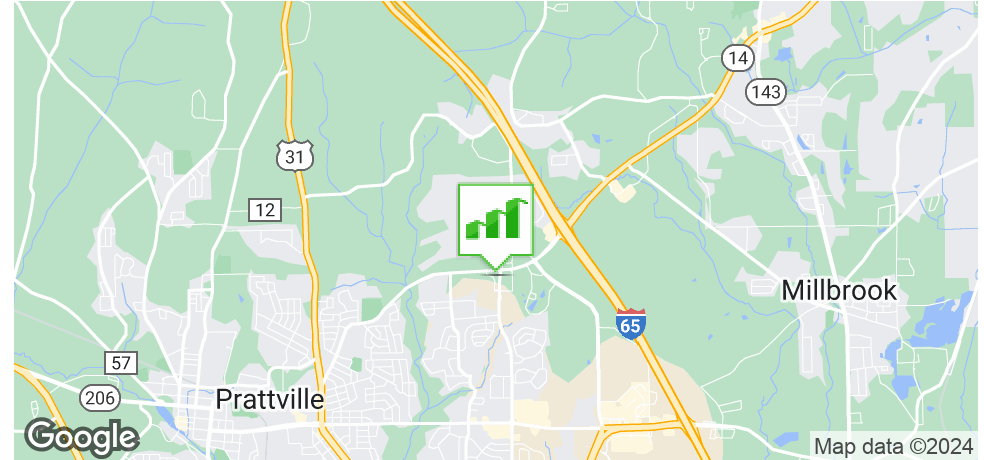

OFFERING SUMMARY

Available SF: 8,000 SF

Lease Rate: Contact Agent

Lot Size: 1.92 Acres

Building Size: 8,000

Zoning: B-2

PROPERTY HIGHLIGHTS

- Former bank building with drive-thru
- Located at the corner of McQueen Smith Rd and Fairview Ave (Highway 14)
- Property is in excellent condition- current furnishings remain
- Zoned B-2 (General Business)
- Located in Prattville's high growth corridor
- High density of new homes and businesses within a 1 mile radius
- Within minutes of Target, Home Goods, Lowe's, Home Depot, Books-A-Million, Publix, Bass Pro Shops and much more
- Easy access to I-65- Exit 181

DEMOGRAPHICS

	1 MILE	5 MILES	10 MILES
Total Households	2101	21922	39000
Total Population	4783	52909	94251
Average HH Income	\$83,400	\$72,505	\$63,215

GENE CODY, CCIM

334.386.2441
gcody@mcrmpm.com

MOORE COMPANY REALTY

312 Catoma St #200, Montgomery, AL 36104
334.262.1958 | moorecompanyrealty.com



1798 FAIRVIEW AVE

PRATTVILLE, AL 36066

Additional Photos



GENE CODY, CCIM

334.386.2441
gcody@mcrrmpm.com

MOORE COMPANY REALTY

312 Catoma St #200, Montgomery, AL 36104
334.262.1958 | moorecompanyrealty.com



PRATTVILLE, AL 36066

1798 FAIRVIEW AVE

PRATTVILLE, AL 36066

Second Floor Plan

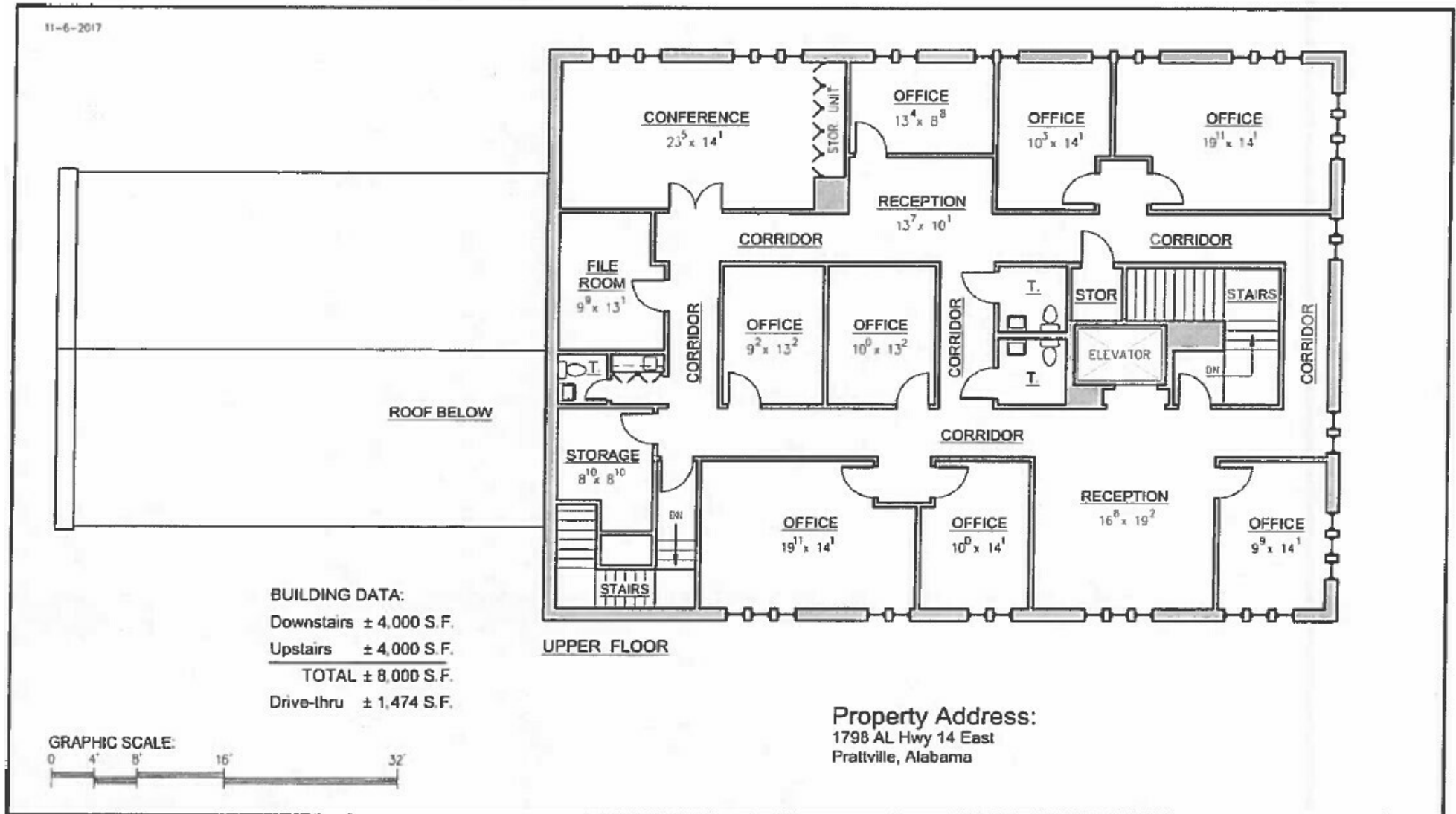

GENE CODY, CCIM

334.386.2441
gcody@mcrrmpm.com

MOORE COMPANY REALTY

312 Catoma St #200, Montgomery, AL 36104
334.262.1958 | moorecompanyrealty.com



1798 FAIRVIEW AVE

PRATTVILLE, AL 36066

Aerial



GENE CODY, CCIM

334.386.2441
gcody@mcrmpm.com

MOORE COMPANY REALTY

312 Catoma St #200, Montgomery, AL 36104
334.262.1958 | moorecompanyrealty.com



1798 FAIRVIEW AVE

PRATTVILLE, AL 36066

Retail Map



GENE CODY, CCIM

334.386.2441
gcody@mcrmpm.com

MOORE COMPANY REALTY

312 Catoma St #200, Montgomery, AL 36104
334.262.1958 | moorecompanyrealty.com

