



THE FIELDS

SILICON VALLEY'S PREMIER LIFESTYLE COMMUNITY

Four luxury apartment communities,
88,000 SF of retail, and a grand 162-room
hotel, conveniently located adjacent to the
Milpitas BART railway station

THEFIELDSRETAIL.COM

LEASING BY

 **Lavery Chacón**
Commercial Real Estate

EAT. SHOP. PLAY. LIVE.

The Fields is Milpitas' premier lifestyle community with 1,310 of Silicon Valley's newest multifamily residences and 88,000 SF of retail space. Where luxury and convenience converge, The Fields is the place to be. Come represent the new heart of the second fastest growing city in California.

5

SIGNATURE BUILDINGS

1,310

LUXURY APARTMENTS

162

EXECUTIVE STAY HOTEL ROOMS

88,000 SF

OF RETAIL SPACE

A true lifestyle epicenter, The Fields is strategically located at Great Mall Parkway and McCandless Drive directly across from the Great Mall. Just two blocks from the Montague Expressway and the Berryessa Bart Station, the Fields is conveniently center between Highways 101 and 880, just South of Highway 237.

Welcome to the new
Hub of Milpitas!



COMMUNITY HIGHLIGHTS

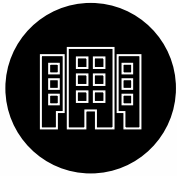

4 signature buildings,
1,310 luxury apartments,
162 executive stay hotel
rooms, and an 88,000 SF
shopping district



11-acre site located directly
across from the Great Mall
on McCandless Drive



Centrally located between
Highways 101, 880, and 237, as
well as Montague Expressway
& Great Mall Parkway



10-aisle Trader Joe's
with dedicated
underground parking



BART's newest Silicon
Valley hub, Berryessa
Station, just blocks away



Walking distance to
±5,000 apartment homes



 25,250 ADT

GREAT MALL®

A SIMON CENTER



1,310 UNITS

 48,047 ADT

308 UNITS

303 UNITS

381 UNITS

216 UNITS

BART
ba

MONTAGUE EXPRESSWAY

468 UNITS

580 UNITS

489 UNITS

720 UNITS

241 UNITS

203 UNITS

114 UNITS

207 UNITS

 3,440 ADT

207 UNITS

134 UNITS

The Fields is in the center of Silicon Valley's burgeoning culture, surrounded by several residential communities in the immediate area, totaling over ±5,722 units.



The Fields includes 1,310 residential units and 88,000 total SF of retail across four resort-style communities.



TURING

371

RESIDENTIAL UNITS

48,510

RETAIL SF

NOW

AVAILABLE

GRAHAM

207

RESIDENTIAL UNITS

5,352

RETAIL SF

NOW

AVAILABLE

TRADER JOE'S

GREAT MALL PKWY



19,829 ADT

MCCANDLESS DR



3,440 ADT

ELION

357

RESIDENTIAL UNITS

13,194

RETAIL SF

FUTURE

DEVELOPMENT

GIDEON

213

RESIDENTIAL UNITS

12,000

RETAIL SF

NOW

AVAILABLE



Silicon Valley is home to the world's largest technology corporations as well as thousands of tech start-ups.

As the leading hub of high-tech innovation and development, the region is the largest high-tech manufacturing center in the US.

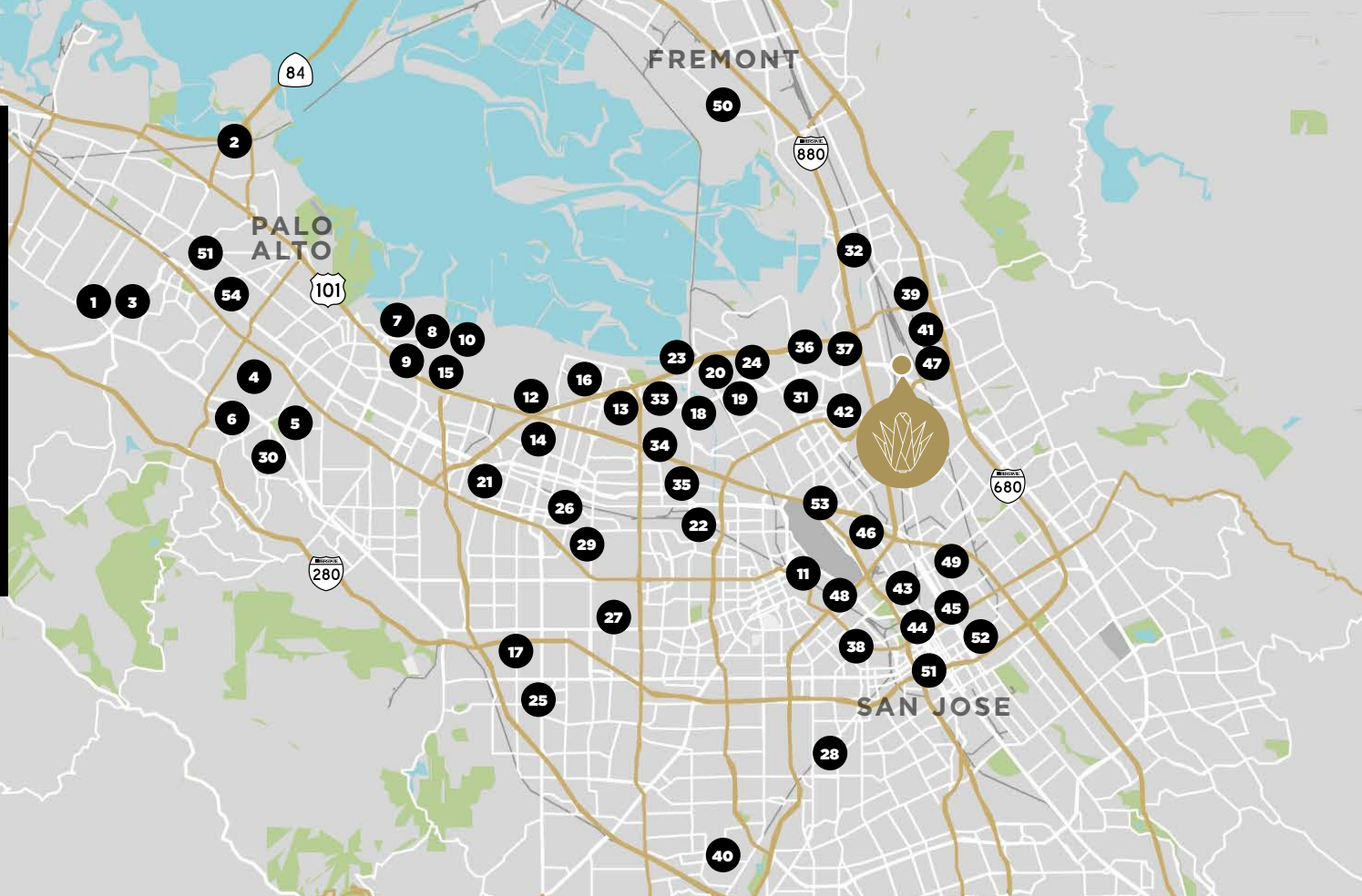

- | | | | | | |
|------------------------|------------------------|----------------------|---------------------|-----------------------|------------------------|
| 1 Stanford Health Care | 10 LinkedIn | 19 Levi's Stadium | 28 eBay | 37 Cisco | 46 TDK |
| 2 Facebook | 11 Yahoo | 20 Marvell | 29 Valley Medical | 38 Santa Clara County | 47 LifeScan |
| 3 Stanford University | 12 Lockheed Martin | 21 McAfee | 30 Tesla | 39 Achievo | 48 Roku |
| 4 Hewlett-Packard | 13 Symantec | 22 Applied Materials | 31 SunPower | 40 Netflix | 49 City of San Jose |
| 5 VMware | 14 Synopsys | 23 Flex | 32 Advantech | 41 Magnum | 50 Logitech |
| 6 Palo Alto Medical | 15 Juniper Networks | 24 Brocade | 33 Global Foundries | 42 Cadence | 51 Ernst & Young |
| 7 Intuit | 16 NetApp | 25 Seagate | 34 Infineon | 43 Zoom | 52 San Jose University |
| 8 Google | 17 Apple | 26 Intel | 35 Ericsson | 44 Adobe | 53 PayPal |
| 9 Microsoft | 18 Silicon Valley Bank | 27 Nvidia | 36 SanDisk | 45 Accenture | 54 Houzz |



PHASE 1

TURING ZONE A | 1,600 SF - 5,166 SF AVAILABLE

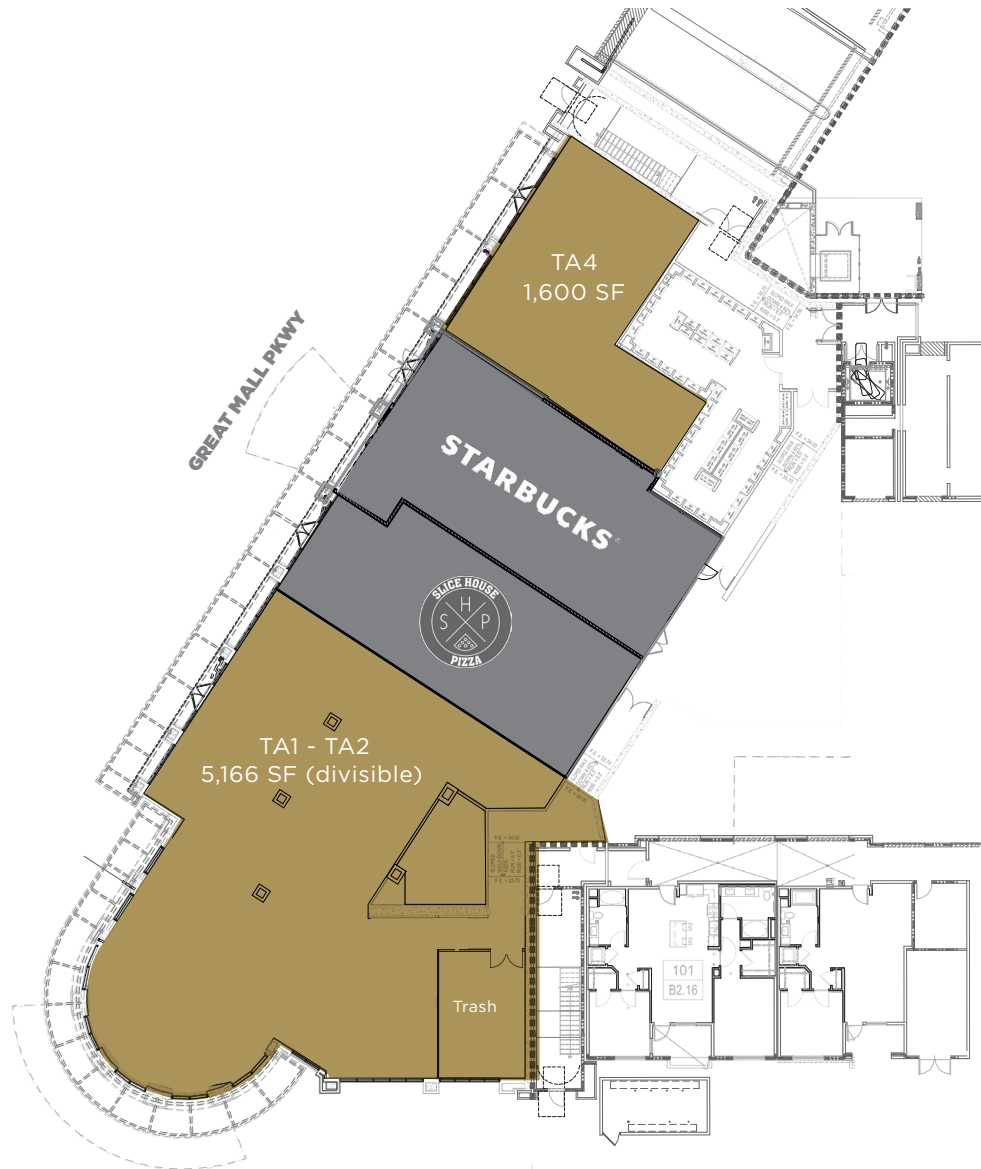

PHASE 1

TURING ZONE B | 1,037 SF - 3,435 SF AVAILABLE

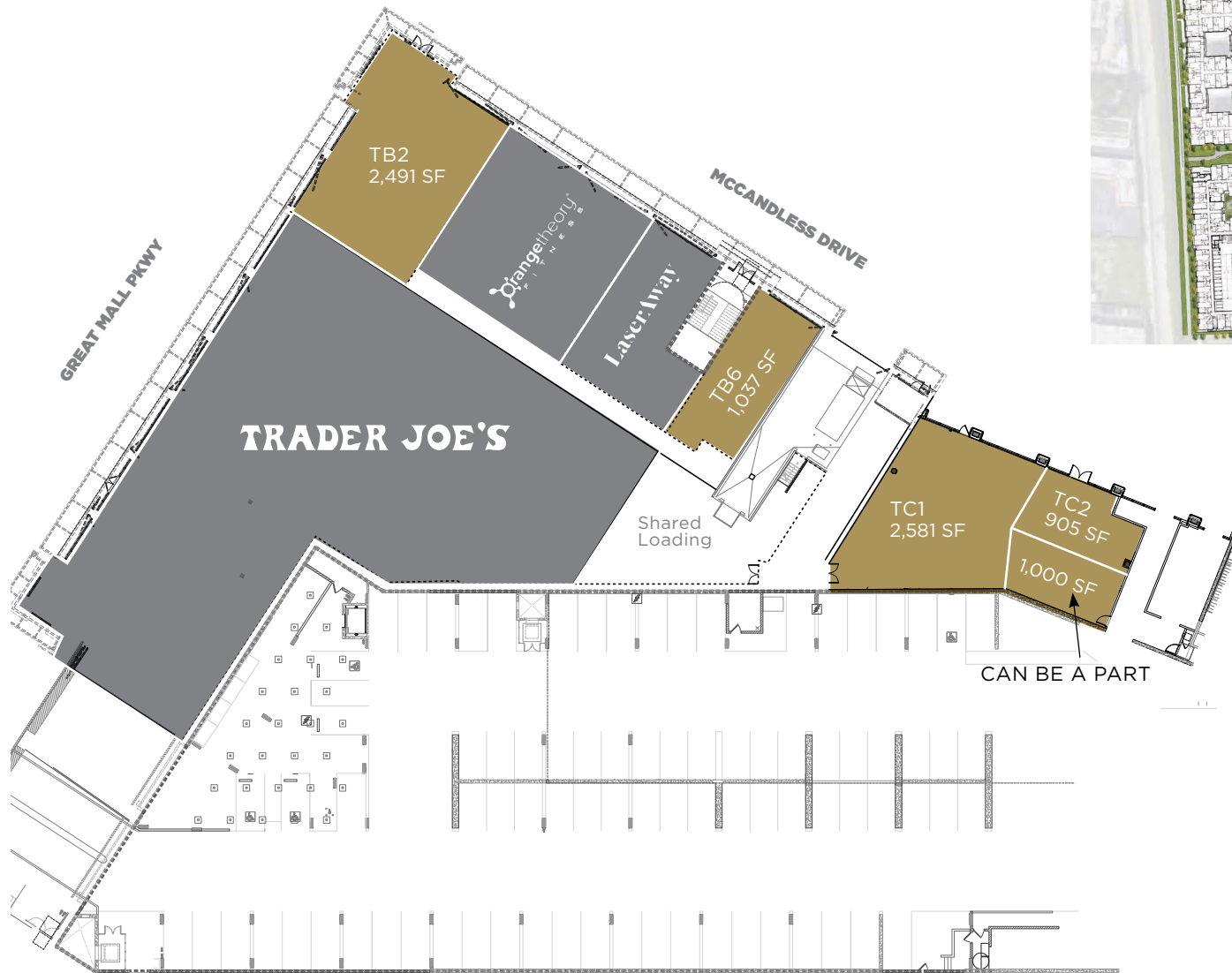

PHASE 2

GRAHAM | 1,880 SF AVAILABLE

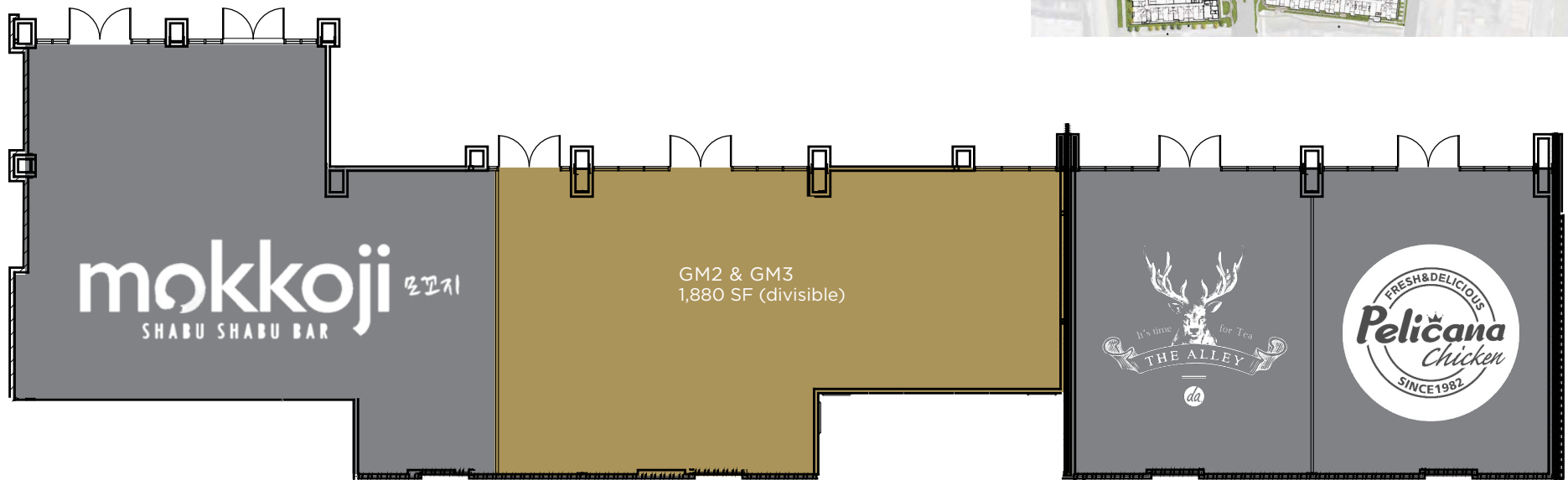

PHASE 3

GIDEON | 800 SF - 12,000 SF AVAILABLE



AVAILABILITIES

PHASE 1 - NOW OPEN

TURING ZONE A & B

Space **SF**

TA1 - TA2 5,166 (divisible)

TA4 1,600

TB2 2,491

TB6 1,037

TC1 2,581

TC2 905

PHASE 2 - NOW OPEN

GRAHAM

Space **SF**

GM2-GM3 1,880 (divisible)

PHASE 3 - NOW OPEN

GIDEON

Space **SF**

GD1 12,000 (divisible)

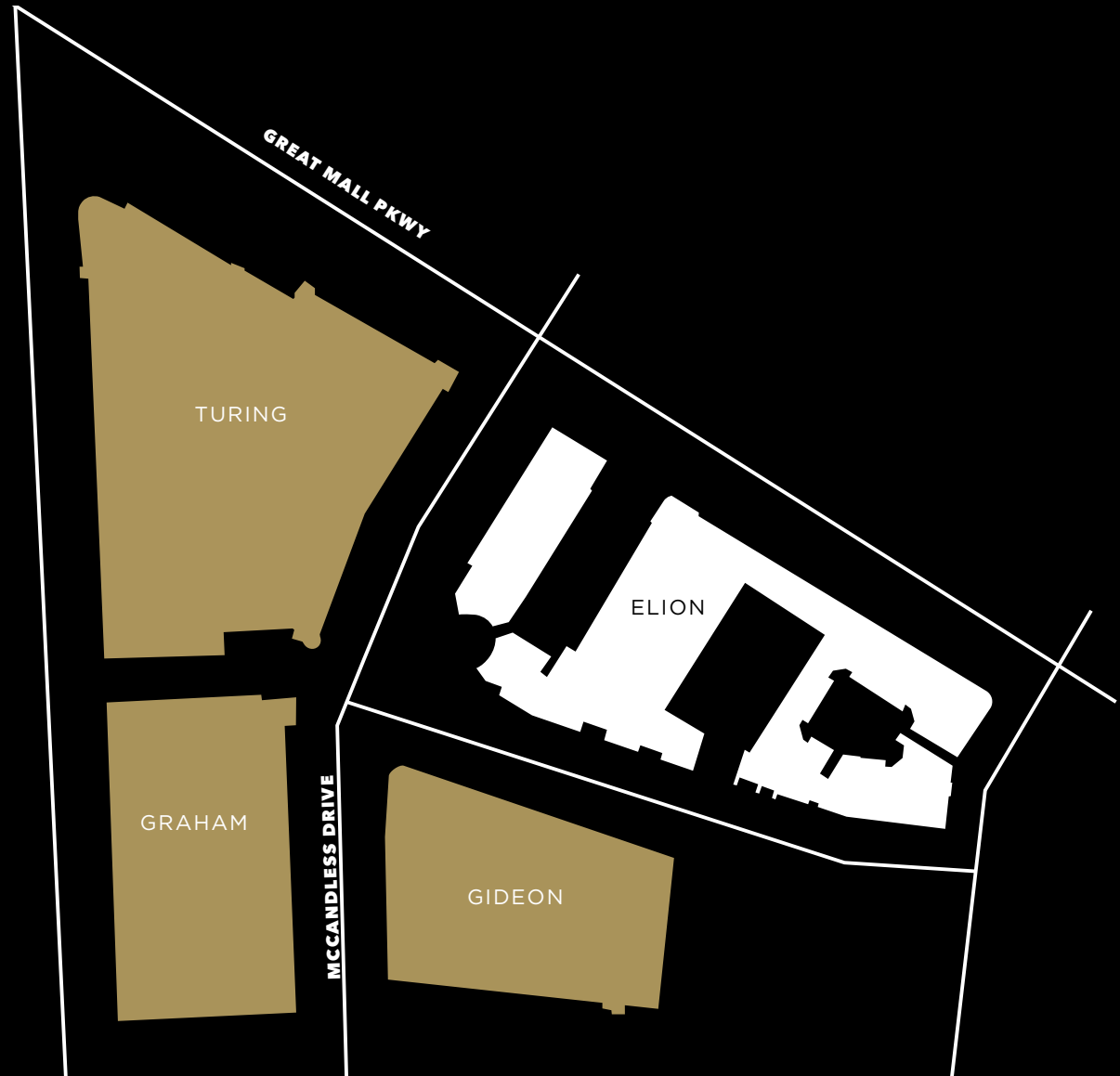

WHY MILPITAS?

With the addition of the new Milpitas BART Station and multiple new mixed-use development projects, Milpitas aims to be the center of the next generation of creative youth.

#1

FASTEST
GROWING CITY
IN SILICON
VALLEY

#2

FASTEST
GROWING CITY
IN CA

#8

FASTEST
GROWING CITY
IN THE US

#29

BEST SMALL
CITY TO LIVE
IN THE US

±78K

TOTAL
POPULATION

120K

DAYTIME
POPULATION

37

MEDIAN
AGE

16%

POPULATION
GROWTH OVER
5 YRS

±41K

WORKING
PROFESSIONALS

SOURCES: MILPITAS OFFICE OF ECONOMIC



DEMOGRAPHICS

POPULATION

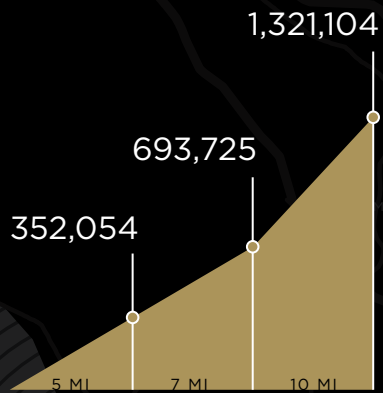

EMPLOYEES



HOUSEHOLD INCOME

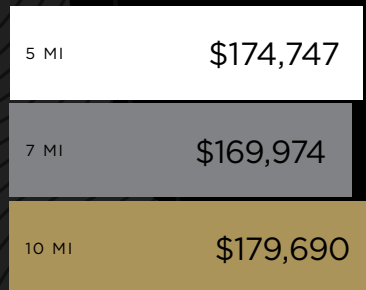

DAYTIME POPULATION



HOUSEHOLDS



DATA SOURCE: ESRI

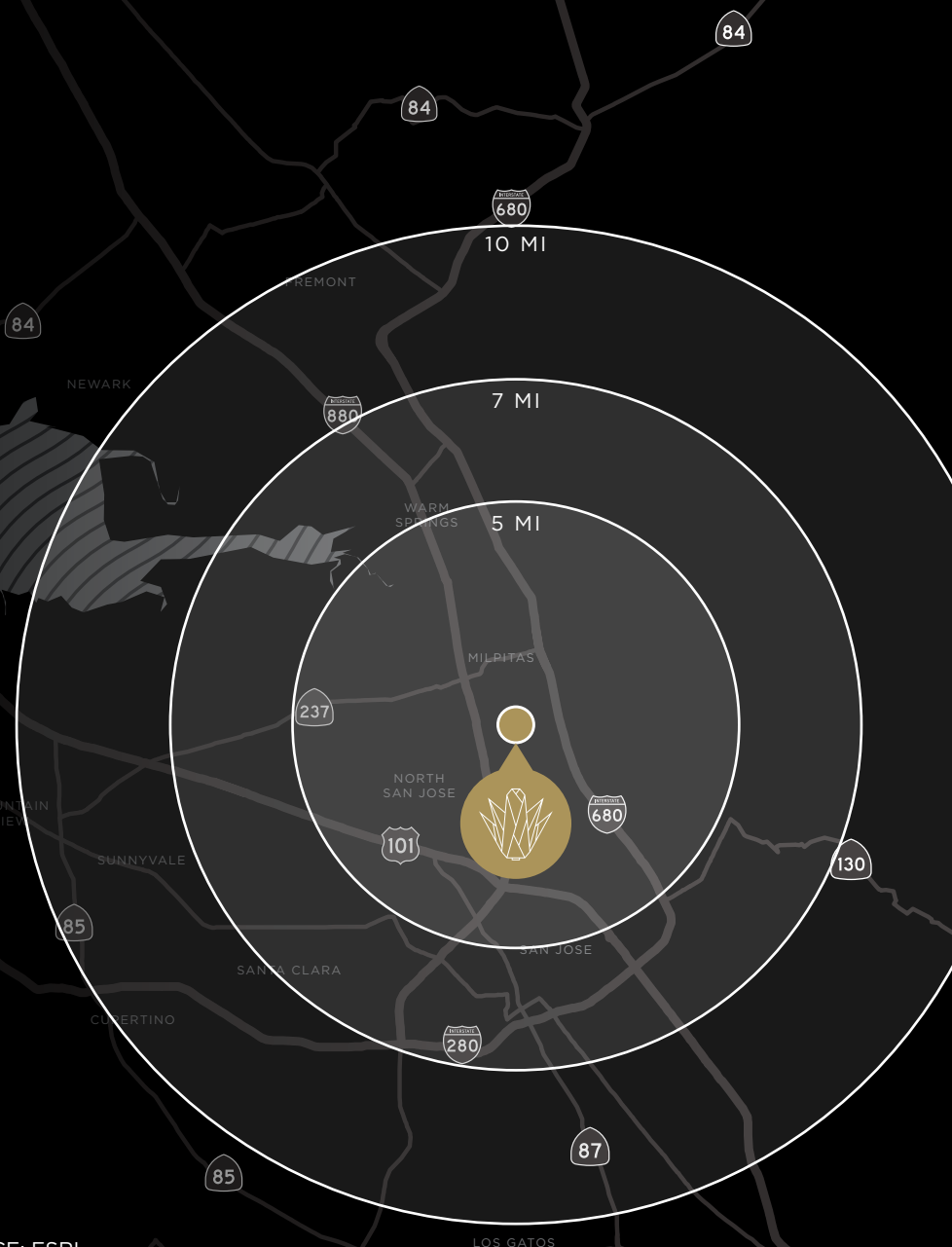



THEFIELDS

1315 MCCANDLESS DRIVE | MILPITAS, CA

FOR LEASING INFORMATION, CONTACT

TANNER LAVERTY
Laverty Chacón
408.622.4490
tanner@lavertychacon.com
CA DRE Officer #1436559



THEFIELDSRETAIL.COM

This information supplied herein is from sources we deem reliable. It is provided without any representation, warranty, or guarantee, expressed or implied as to its accuracy. Prospective Buyer or Tenant should conduct an independent investigation and verification of all matters deemed to be material, including, but not limited to, statements of income and expenses. Consult your attorney, accountant, or other professional advisor.