

1715 NORTH 203RD STREET

7,800 SF | \$11.95 SF/YR (NNN)

1715 NORTH 203RD STREET, OMAHA, NE 68022



WWW.INVESTORSOMAHA.COM



CLINT SEEMANN

402.778.7541

cseemann@investorsomaha.com



LEE EHLERS, CCIM

402.778.7540

lee@investorsomaha.com





1715 NORTH 203RD STREET

EXECUTIVE SUMMARY

OFFERING SUMMARY

LEASE RATE:	\$11.95 SF/YR NNN
Est. Op. Exp.	\$1.63 SF/YR
Available SF:	7,800 SF
Building Size:	7,800 SF
Property Type:	Industrial

PROPERTY OVERVIEW

Nice single tenant industrial/flex building located in Elkhorn

PROPERTY HIGHLIGHTS

- Perfect property for a small business user
- Clean office space
- Drive-in doors (2)
- Park at your front door
- Fenced parking area in rear

CLINT SEEMANN

402.778.7541 | cseemann@investorsomaha.com

LEE EHLERS, CCIM

402.778.7540 | lee@investorsomaha.com

Information presented is deemed reliable and is subject to change. Investors Realty, Inc. makes no warranties or guarantees regarding this information.



BUILDING INFORMATION

Building Size	7,800 SF
Min Divisible	7,800 SF
Max Contiguous	7,800 SF

PARKING & TRANSPORTATION

Number Of Spaces	24
Parking Type	Structure

SITE INFORMATION

County	Douglas
Location Description	Off of 203rd & Roberts

UTILITIES & AMENITIES

Power	Yes
Power Description	220
Gas	Radiant
Gas Description	Radiant and in floor hea
Snow Removal	Tenant does own snow removal

OFFERING SUMMARY

LEASE RATE	\$11.95 SF/YR NNN
Est. Op. Exp.	\$1.63 SF/YR
Available SF	7,800 SF
Property Type	Industrial

DEMOGRAPHICS

POPULATION	0.5 MILES	1 MILE	1.5 MILES
Total Population	1,619	5,798	11,076
Total Households	585	2,284	4,323
Average HH Income	\$115,697	\$109,427	\$119,848

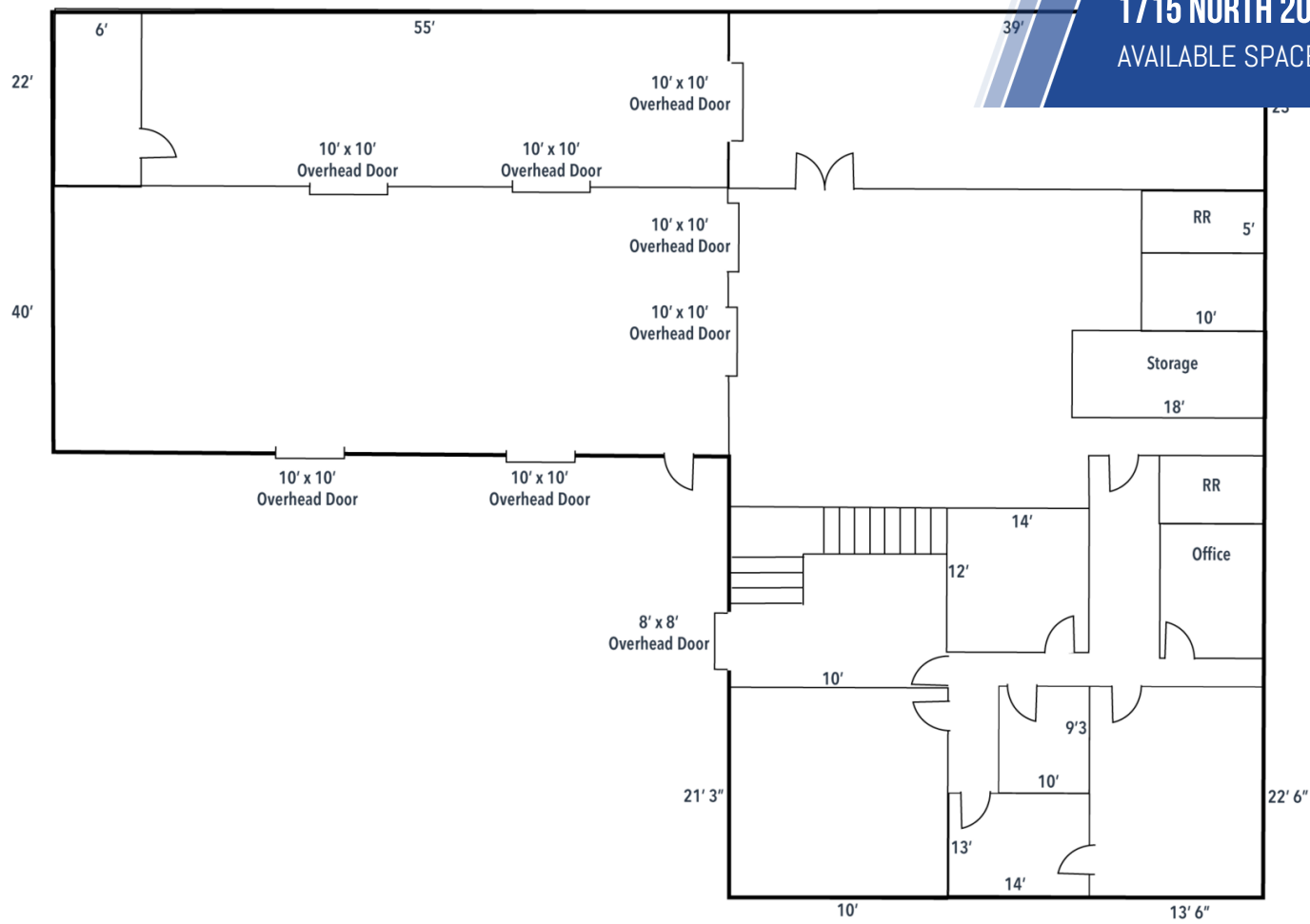

*Floor Plan may not be drawn to scale

AVAILABLE SPACES

SPACE	SIZE	LEASE RATE	EST. OP. EXP	EST. TOTAL / MO.
1715	7,800 SF	\$11.95 SF/yr (NNN)	\$1.63	\$8,827.00

CLINT SEEMANN

402.778.7541 | cseemann@investorsomaha.com

LEE EHLERS, CCIM

402.778.7540 | lee@investorsomaha.com

Information presented is deemed reliable and is subject to change. Investors Realty, Inc. makes no warranties or guarantees regarding this information.





1715 NORTH 203RD STREET
CLOSE VIEW AERIAL

Google

Map data ©2024 Imagery ©2024 Airbus,
Maxar Technologies

CLINT SEEMANN
402.778.7541 | cseemann@investorsomaha.com

LEE EHLERS, CCIM
402.778.7540 | lee@investorsomaha.com

Information presented is deemed reliable and is subject to change. Investors Realty, Inc. makes no warranties or guarantees regarding this information.



1715 NORTH 203RD STREET
RETAILER MAP



Map data ©2024 Imagery ©2024 Airbus, Maxar
Technologies, USDA/FPAC/GEO

CLINT SEEMANN

402.778.7541 | cseemann@investorsomaha.com

LEE EHLERS, CCIM

402.778.7540 | lee@investorsomaha.com

Information presented is deemed reliable and is subject to change. Investors Realty, Inc. makes no warranties or guarantees regarding this information.

