



130 N. Brand Blvd

Glendale, California 91203

Property Description

The Exchange Building located in the heart of the City of Glendale. Premiere Location within the hub of Glendale's Central Business District.

Property Features

- Structure parking at 3/1000 unreserved spaces \$70 per month, 90 minutes free for visitors
- Creative Office Suites
- Walking distance to several restaurants and amenities.
- Professional office setting
- Onsite building engineer
- Covered Parking in adjacent City Garage
- Excellent access to 134, 5 and 2 freeways
- Professionally managed property.



For more information:

John Martin, Senior Vice President

626.204.1503 • jmartin@naicapital.com
CA CalDRE #01280892

NO WARRANTY, EXPRESS OR IMPLIED, IS MADE AS TO THE ACCURACY OF THE INFORMATION CONTAINED HEREIN. THIS INFORMATION IS SUBMITTED SUBJECT TO ERRORS, OMISSIONS, CHANGE OF PRICE, RENTAL OR OTHER CONDITIONS, WITHDRAWAL WITHOUT NOTICE, AND IS SUBJECT TO ANY SPECIAL LISTING CONDITIONS IMPOSED BY OUR PRINCIPALS. COOPERATING BROKERS, BUYERS, TENANTS AND OTHER PARTIES WHO RECEIVE THIS DOCUMENT SHOULD NOT RELY ON IT, BUT SHOULD USE IT AS A STARTING POINT OF ANALYSIS, AND SHOULD INDEPENDENTLY CONFIRM THE ACCURACY OF THE INFORMATION CONTAINED HEREIN THROUGH A DUE DILIGENCE REVIEW OF THE BOOKS, RECORDS, FILES AND DOCUMENTS THAT CONSTITUTE RELIABLE SOURCES OF THE INFORMATION DESCRIBED HEREIN. LOGOS ARE FOR IDENTIFICATION PURPOSES ONLY AND MAY BE TRADEMARKS OF THEIR RESPECTIVE COMPANIES. NAI CAPITAL COMMERCIAL, INC. CAL DRE LIC. #02130474

NAI Capital
225 S. Lake Avenue, Suite M270
Pasadena, CA 91101
626.564.4800
www.naicapital.com

For Lease

130 N. Brand Blvd



SUITE #	SPACE USE	LEASE RATE:	LEASE TYPE	SIZE (SF)	AVAILABILITY
Suite 206	Office Building	\$2.45 SF/MONTH	Full Service	5,520 SF	Immediately
Suite 400	Office Building	\$2.45 SF/MONTH	Full Service	1,810 SF	Immediately
Suite 415	Office Building	\$2.45 SF/MONTH	Full Service	2,146 SF	Immediately

John Martin

Senior Vice President
626.204.1503
jmartin@naicapital.com
CalDRE #01280892

NAICapital
COMMERCIAL REAL ESTATE SERVICES, WORLDWIDE

For Lease

130 N. Brand Blvd

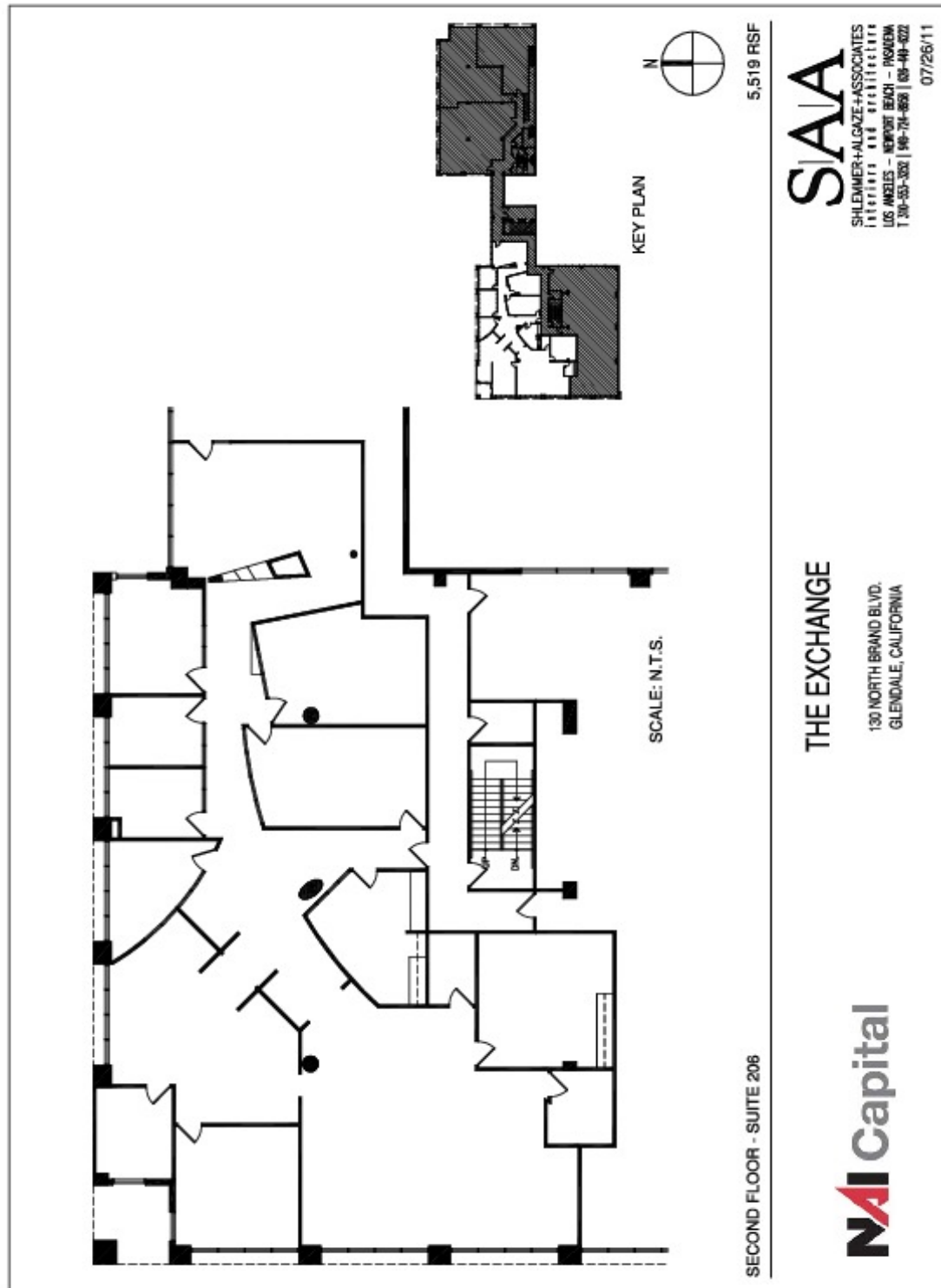

John Martin

Senior Vice President
626.204.1503
jmartin@naicapital.com
CalDRE #01280892

NAI Capital
COMMERCIAL REAL ESTATE SERVICES, WORLDWIDE

For Lease

130 N. Brand Blvd



John Martin

Senior Vice President
626.204.1503
jmartin@naicapital.com
CalDRE #01280892

NAI Capital
COMMERCIAL REAL ESTATE SERVICES, WORLDWIDE