

319 & 321 Ausley Road

Tallahassee, Florida 32304

Property Highlights

Sale Price: \$795,000

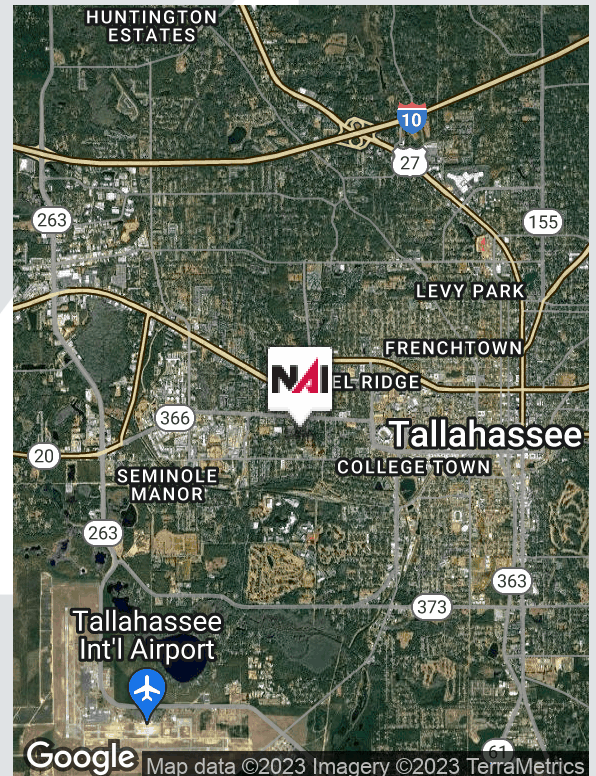

For more information

Peter Gonzalez, Jr.

O: 850 224 2300 | C: 850 510 7864

pete@talcor.com



NO WARRANTY OR REPRESENTATION, EXPRESS OR IMPLIED, IS MADE AS TO THE ACCURACY OF THE INFORMATION CONTAINED HEREIN, AND THE SAME IS SUBMITTED SUBJECT TO ERRORS, OMISSIONS, CHANGE OF PRICE, RENTAL OR OTHER CONDITIONS, PRIOR SALE, LEASE OR FINANCING, OR WITHDRAWAL WITHOUT NOTICE, AND OF ANY SPECIAL LISTING CONDITIONS IMPOSED BY OUR PRINCIPALS. NO WARRANTIES OR REPRESENTATIONS ARE MADE AS TO THE CONDITION OF THE PROPERTY OR ANY HAZARDS CONTAINED THEREIN ARE ANY TO BE IMPLIED.

1018 Thomasville Road, Suite 200A,
Tallahassee, FL 32303

850 224 2300 tel

talcor.com



Multifamily Site Plan

AUSLEY ROAD

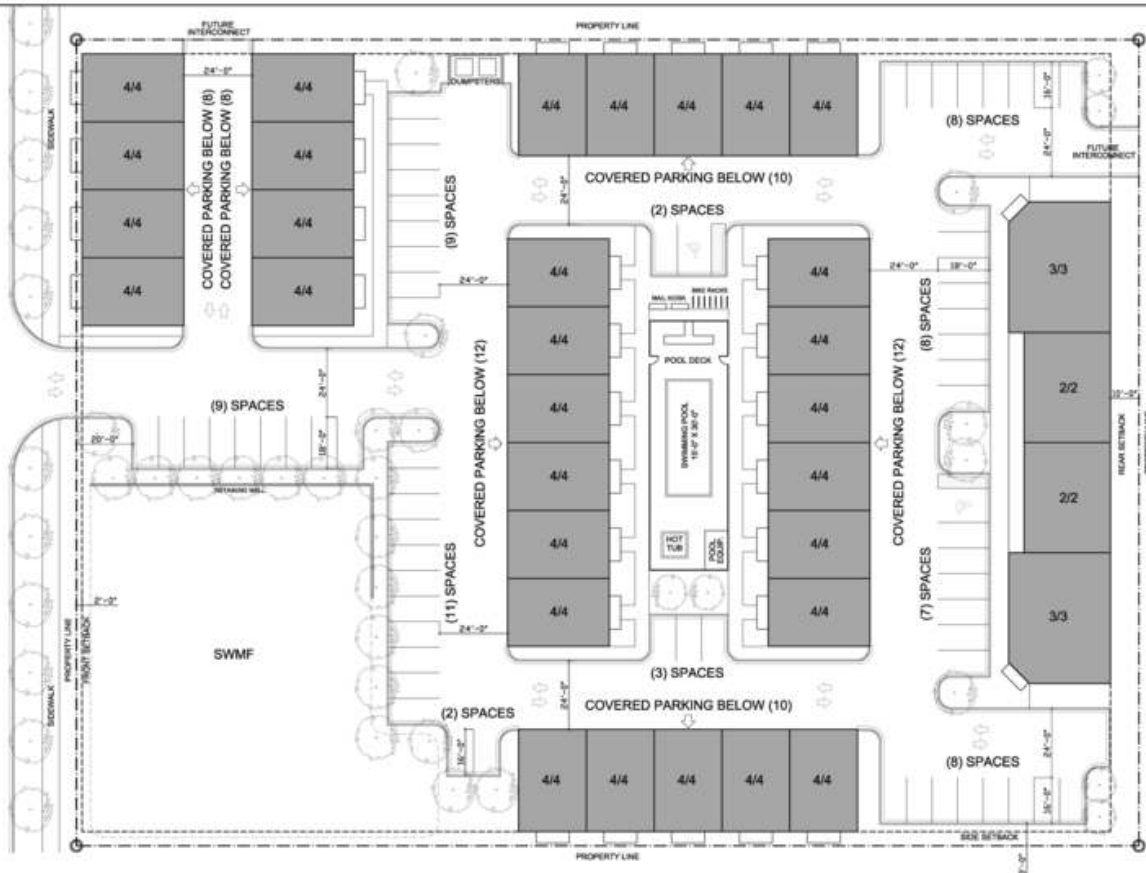

PROPOSED SITE PLAN - OPTION "H"

AUSLEY ROAD APARTMENTS
JUNE 2, 2016

SCALE 1/16" = 1'-0"

SITE PLANNING DATA:
SITE AREA: 2.44 ACRES (106,380 S.F.)
UNIT MIX:
 (30) 4 BR / 4 BATH TOWNHOME UNITS
 (6) 2 BR / 2 BATH FLATS
 (6) 3 BR / 3 BATH FLATS
PROPOSED RESIDENTIAL PARKING: 127 (0.85 PER BR)
 (42) TOTAL UNITS, (150) TOTAL BEDROOMS

CONN ARCHITECTS & ASSOCIATES
 1915-C Buford Blvd. • Tallahassee, Florida 32308 • Phone: 904-479-8786
 www.connarchitects.com • License No. AA C001662



"AUSLEY ROAD" STUDENT HOUSING DEVELOPMENT
AUSLEY ROAD, TALLAHASSEE, FLORIDA

PROPOSED SITE PLAN - OPTION "H"

CONN ARCHITECTS & ASSOCIATES
 1915-C Buford Blvd. • Tallahassee, Florida 32308 • Phone: 904-479-8786
 www.connarchitects.com • License No. AA C001662

JUNE 2, 2016
 DBC/SAM

15-278

A1.0

Soho Living Tallahassee

08-19-16



Soho Living Tallahassee

09-08-16



Soho Living Tallahassee

08-19-16

