

FOR SALE - MEDICAL OFFICE CONDOMINIUM UNIT

1802 Kuhl Ave, Unit B, Orlando, FL 32806



SALE PRICE: \$460,000

SPACE TYPE: Medical Office

YEAR BUILT 1985

CONSTRUCTION: Concrete Block

PROPERTY OVERVIEW

This property is available for sale and consists of a medical office condominium unit within a 3-unit condominium building. It is located just one block south of the Orlando Health hospital campus and surrounding medical uses. This property has good access to transportation networks.

PROPERTY FEATURES

- 1,984 SF
- Reception/Waiting Room
- 2 Offices and 2 Executive Offices
- Breakroom
- 3 Exam Rooms
- 2 Restrooms
- Administrative Space and Storage
- Recent replacement of HVAC Unit in 2017

KW COMMERCIAL
147 W. Lyman Avenue
Winter Park, FL 32789

W. IAN ERTEL
Commercial Associate
O: 407.970.8131
wianertel@kwcommercial.com
FL #SL3300142

DALE DONOVAN
Managing Director
O: 407.491.0005
C: 407.491.0005
ddonovan@kwcommercial1.com
FL #1046923

We obtained the information above from sources we believe to be reliable. However, we have not verified its accuracy and make no guarantee, warranty or representation about it. It is submitted subject to the possibility of errors, omissions, change of price, rental or other conditions, prior sale, lease or financing, or withdrawal without notice. We include projections, opinions, assumptions or estimates for example only, and they may not represent current or future performance of the property. You and your tax and legal advisors should conduct your own investigation of the property and transaction.

Each Office Independently Owned and Operated kwcommercial.com/

Confidentiality & Disclaimer

ORLANDO, FL

All materials and information received or derived from KW Commercial its directors, officers, agents, advisors, affiliates and/or any third party sources are provided without representation or warranty as to completeness, veracity, or accuracy, condition of the property, compliance or lack of compliance with applicable governmental requirements, developability or suitability, financial performance of the property, projected financial performance of the property for any party's intended use or any and all other matters.

Neither KW Commercial its directors, officers, agents, advisors, or affiliates makes any representation or warranty, express or implied, as to accuracy or completeness of the materials or information provided, derived, or received. Materials and information from any source, whether written or verbal, that may be furnished for review are not a substitute for a party's active conduct of its own due diligence to determine these and other matters of significance to such party. KW Commercial will not investigate or verify any such matters or conduct due diligence for a party unless otherwise agreed in writing.

EACH PARTY SHALL CONDUCT ITS OWN INDEPENDENT INVESTIGATION AND DUE DILIGENCE.

Any party contemplating or under contract or in escrow for a transaction is urged to verify all information and to conduct their own inspections and investigations including through appropriate third party independent professionals selected by such party. All financial data should be verified by the party including by obtaining and reading applicable documents and reports and consulting appropriate independent professionals. KW Commercial makes no warranties and/or representations regarding the veracity, completeness, or relevance of any financial data or assumptions. KW Commercial does not serve as a financial advisor to any party regarding any proposed transaction.

All data and assumptions regarding financial performance, including that used for financial modeling purposes, may differ from actual data or performance. Any estimates of market rents and/or projected rents that may be provided to a party do not necessarily mean that rents can be established at or increased to that level. Parties must evaluate any applicable contractual and governmental limitations as well as market conditions, vacancy factors and other issues in order to determine rents from or for the property. Legal questions should be discussed by the party with an attorney. Tax questions should be discussed by the party with a certified public accountant or tax attorney. Title questions should be discussed by the party with a title officer or attorney. Questions regarding the condition of the property and whether the property complies with applicable governmental requirements should be discussed by the party with appropriate engineers, architects, contractors, other consultants and governmental agencies. All properties and services are marketed by Winter Park in compliance with all applicable fair housing and equal opportunity laws.

PRESENTED BY:

KW COMMERCIAL

147 W. Lyman Avenue

Winter Park, FL 32789

W. IAN ERTEL

Commercial Associate
O 407.970.8131
wianertel@kwcommercial.com
FL #SL3300142

DALE DONOVAN

Managing Director
O 407.491.0005
C 407.491.0005
ddonovan@kwcommercial1.com
FL #1046923

We obtained the information above from sources we believe to be reliable. However, we have not verified its accuracy and make no guarantee, warranty or representation about it. It is submitted subject to the possibility of errors, omissions, change of price, rental or other conditions, prior sale, lease or financing, or withdrawal without notice. We include projections, opinions, assumptions or estimates for example only, and they may not represent current or future performance of the property. You and your tax and legal advisors should conduct your own investigation of the property and transaction.



1802 Kuhl Ave, Unit B

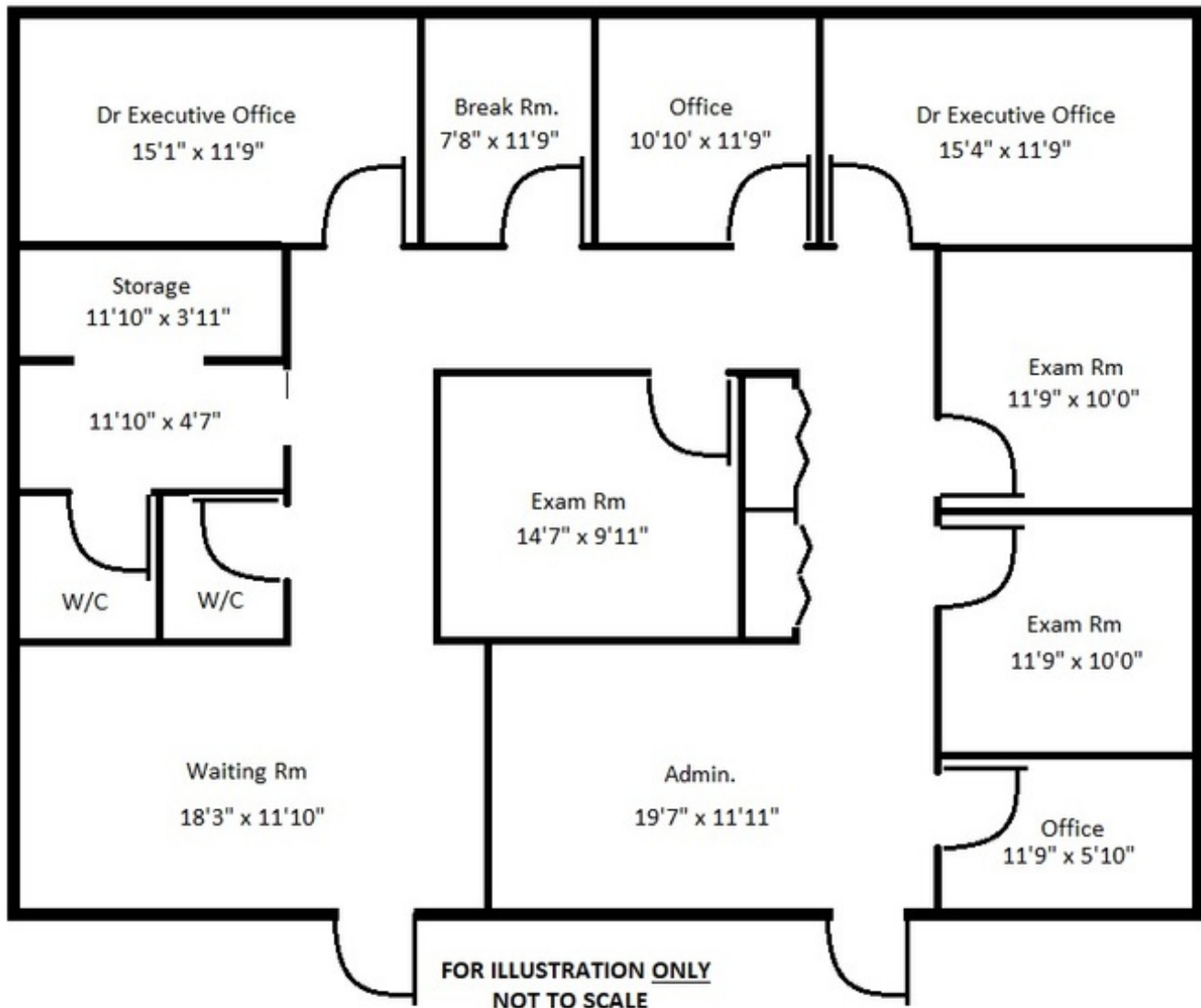

KW COMMERCIAL
147 W. Lyman Avenue
Winter Park, FL 32789

W. IAN ERTEL
Commercial Associate
O: 407.970.8131
wianertel@kwcommercial.com
FL #SL3300142

DALE DONOVAN
Managing Director
O: 407.491.0005
C: 407.491.0005
ddonovan@kwcommercial1.com
FL #1046923

We obtained the information above from sources we believe to be reliable. However, we have not verified its accuracy and make no guarantee, warranty or representation about it. It is submitted subject to the possibility of errors, omissions, change of price, rental or other conditions, prior sale, lease or financing, or withdrawal without notice. We include projections, opinions, assumptions or estimates for example only, and they may not represent current or future performance of the property. You and your tax and legal advisors should conduct your own investigation of the property and transaction.

Each Office Independently Owned and Operated kwcommercial.com/

FOR SALE - MEDICAL OFFICE CONDOMINIUM UNIT

1802 Kuhl Ave, Unit B, Orlando, FL 32806



KW COMMERCIAL
147 W. Lyman Avenue
Winter Park, FL 32789

W. IAN ERTTEL
Commercial Associate
O: 407.970.8131
wianertel@kwcommercial.com
FL #SL3300142

DALE DONOVAN
Managing Director
O: 407.491.0005
C: 407.491.0005
ddonovan@kwcommercial1.com
FL #1046923

We obtained the information above from sources we believe to be reliable. However, we have not verified its accuracy and make no guarantee, warranty or representation about it. It is submitted subject to the possibility of errors, omissions, change of price, rental or other conditions, prior sale, lease or financing, or withdrawal without notice. We include projections, opinions, assumptions or estimates for example only, and they may not represent current or future performance of the property. You and your tax and legal advisors should conduct your own investigation of the property and transaction.

Each Office Independently Owned and Operated kwcommercial.com/

FOR SALE - MEDICAL OFFICE CONDOMINIUM UNIT

1802 Kuhl Ave, Unit B, Orlando, FL 32806



KW COMMERCIAL
147 W. Lyman Avenue
Winter Park, FL 32789

W. IAN ERTEL
Commercial Associate
O: 407.970.8131
wianertel@kwcommercial.com
FL #SL3300142

DALE DONOVAN
Managing Director
O: 407.491.0005
C: 407.491.0005
ddonovan@kwcommercial1.com
FL #1046923

We obtained the information above from sources we believe to be reliable. However, we have not verified its accuracy and make no guarantee, warranty or representation about it. It is submitted subject to the possibility of errors, omissions, change of price, rental or other conditions, prior sale, lease or financing, or withdrawal without notice. We include projections, opinions, assumptions or estimates for example only, and they may not represent current or future performance of the property. You and your tax and legal advisors should conduct your own investigation of the property and transaction.

Each Office Independently Owned and Operated kwcommercial.com/

FOR SALE - MEDICAL OFFICE CONDOMINIUM UNIT

1802 Kuhl Ave, Unit B, Orlando, FL 32806



KW COMMERCIAL
147 W. Lyman Avenue
Winter Park, FL 32789

W. IAN ERTTEL
Commercial Associate
O: 407.970.8131
wianertel@kwcommercial.com
FL #SL3300142

DALE DONOVAN
Managing Director
O: 407.491.0005
C: 407.491.0005
ddonovan@kwcommercial1.com
FL #1046923

We obtained the information above from sources we believe to be reliable. However, we have not verified its accuracy and make no guarantee, warranty or representation about it. It is submitted subject to the possibility of errors, omissions, change of price, rental or other conditions, prior sale, lease or financing, or withdrawal without notice. We include projections, opinions, assumptions or estimates for example only, and they may not represent current or future performance of the property. You and your tax and legal advisors should conduct your own investigation of the property and transaction.

Each Office Independently Owned and Operated kwcommercial.com/

FOR SALE - MEDICAL OFFICE CONDOMINIUM UNIT

1802 Kuhl Ave, Unit B, Orlando, FL 32806



KW COMMERCIAL
147 W. Lyman Avenue
Winter Park, FL 32789

W. IAN ERTEL
Commercial Associate
O: 407.970.8131
wianertel@kwcommercial.com
FL #SL3300142

DALE DONOVAN
Managing Director
O: 407.491.0005
C: 407.491.0005
ddonovan@kwcommercial1.com
FL #1046923

We obtained the information above from sources we believe to be reliable. However, we have not verified its accuracy and make no guarantee, warranty or representation about it. It is submitted subject to the possibility of errors, omissions, change of price, rental or other conditions, prior sale, lease or financing, or withdrawal without notice. We include projections, opinions, assumptions or estimates for example only, and they may not represent current or future performance of the property. You and your tax and legal advisors should conduct your own investigation of the property and transaction.

Each Office Independently Owned and Operated kwcommercial.com/

FOR SALE - MEDICAL OFFICE CONDOMINIUM UNIT

1802 Kuhl Ave, Unit B, Orlando, FL 32806



KW COMMERCIAL
147 W. Lyman Avenue
Winter Park, FL 32789

W. IAN ERTEL
Commercial Associate
O: 407.970.8131
wianertel@kwcommercial.com
FL #SL3300142

DALE DONOVAN
Managing Director
O: 407.491.0005
C: 407.491.0005
ddonovan@kwcommercial1.com
FL #1046923

We obtained the information above from sources we believe to be reliable. However, we have not verified its accuracy and make no guarantee, warranty or representation about it. It is submitted subject to the possibility of errors, omissions, change of price, rental or other conditions, prior sale, lease or financing, or withdrawal without notice. We include projections, opinions, assumptions or estimates for example only, and they may not represent current or future performance of the property. You and your tax and legal advisors should conduct your own investigation of the property and transaction.

Each Office Independently Owned and Operated kwcommercial.com/

FOR SALE - MEDICAL OFFICE CONDOMINIUM UNIT



1802 Kuhl Ave, Unit B, Orlando, FL 32806



KW COMMERCIAL
147 W. Lyman Avenue
Winter Park, FL 32789

W. IAN ERTEL
Commercial Associate
O: 407.970.8131
wianertel@kwcommercial.com
FL #SL3300142

DALE DONOVAN
Managing Director
O: 407.491.0005
C: 407.491.0005
ddonovan@kwcommercial1.com
FL #1046923

We obtained the information above from sources we believe to be reliable. However, we have not verified its accuracy and make no guarantee, warranty or representation about it. It is submitted subject to the possibility of errors, omissions, change of price, rental or other conditions, prior sale, lease or financing, or withdrawal without notice. We include projections, opinions, assumptions or estimates for example only, and they may not represent current or future performance of the property. You and your tax and legal advisors should conduct your own investigation of the property and transaction.

Each Office Independently Owned and Operated kwcommercial.com/

FOR SALE - MEDICAL OFFICE CONDOMINIUM UNIT

1802 Kuhl Ave, Unit B, Orlando, FL 32806

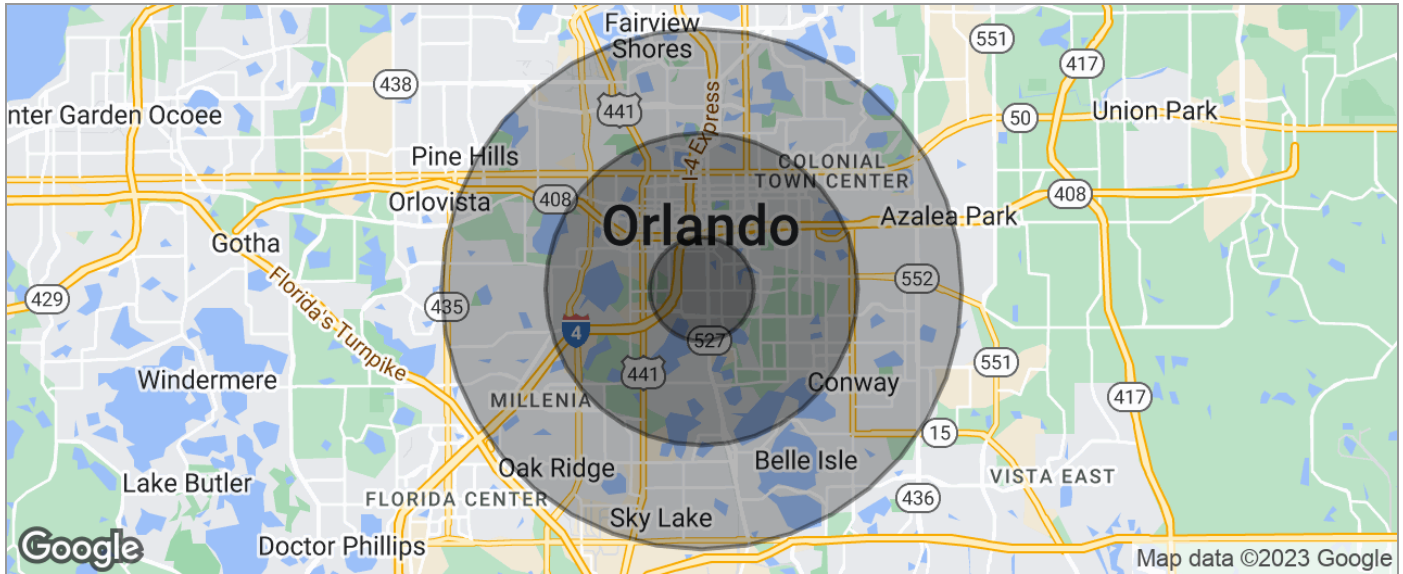

POPULATION	1 MILE	3 MILES	5 MILES
TOTAL POPULATION	8,733	100,539	266,982
MEDIAN AGE	38.8	36.5	35.3
MEDIAN AGE (MALE)	37.4	35.2	33.7
MEDIAN AGE (FEMALE)	39.8	38.3	36.8
HOUSEHOLDS & INCOME	1 MILE	3 MILES	5 MILES
TOTAL HOUSEHOLDS	3,815	41,958	107,362
# OF PERSONS PER HH	2.3	2.4	2.5
AVERAGE HH INCOME	\$71,007	\$59,959	\$60,941
AVERAGE HOUSE VALUE	\$448,245	\$285,609	\$299,300
RACE	1 MILE	3 MILES	5 MILES
% WHITE	67.9%	62.4%	59.6%
% BLACK	25.6%	29.4%	27.8%
% ASIAN	1.9%	1.7%	2.6%
% HAWAIIAN	0.0%	0.0%	0.1%
% INDIAN	0.4%	0.6%	0.6%
% OTHER	3.1%	4.3%	7.5%
ETHNICITY	1 MILE	3 MILES	5 MILES
% HISPANIC	10.2%	16.0%	21.4%

* Demographic data derived from 2020 ACS - US Census

KW COMMERCIAL
147 W. Lyman Avenue
Winter Park, FL 32789

W. IAN ERTTEL
Commercial Associate
O: 407.970.8131
wianertel@kwcommercial.com
FL #SL3300142

DALE DONOVAN
Managing Director
O: 407.491.0005
C: 407.491.0005
ddonovan@kwcommercial1.com
FL #1046923

We obtained the information above from sources we believe to be reliable. However, we have not verified its accuracy and make no guarantee, warranty or representation about it. It is submitted subject to the possibility of errors, omissions, change of price, rental or other conditions, prior sale, lease or financing, or withdrawal without notice. We include projections, opinions, assumptions or estimates for example only, and they may not represent current or future performance of the property. You and your tax and legal advisors should conduct your own investigation of the property and transaction.

Each Office Independently Owned and Operated kwcommercial.com/