

# 7826 W. STATE RD. 28

7826 W. STATE RD. 28, ELWOOD, IN 46036

## PROPERTY SUMMARY



### PROPERTY DESCRIPTION

High visibility near the northwest corner of West State Rd 28 and N Jackley Rd with up to 4000 Sq Ft available

### OFFERING SUMMARY

Lease Rate: Currently Occupied | Inquire if Interested

Available SF:

Building Size: 4,000 SF

SPACES	LEASE RATE			SPACE SIZE
DEMOGRAPHICS	1 MILE	3 MILES	5 MILES	
Total Households	1,240	4,304	5,985	
Total Population	2,837	9,273	13,104	
Average HH Income	\$52,597	\$54,248	\$58,529	



Presented By:

Legacy Commercial Property

847.904.9200

info@legacypro.com



# 7826 W. STATE RD. 28

7826 W. STATE RD. 28, ELWOOD, IN 46036

ADDITIONAL PHOTOS



Presented By:

Legacy Commercial Property

847.904.9200

info@legacypro.com



**LEGACY**  
COMMERCIAL PROPERTY

209 Powell Place  
Brentwood, TN 37027  
<http://legacypro.com>

# 7826 W. STATE RD. 28

7826 W. STATE RD. 28, ELWOOD, IN 46036

## SITE PLANS

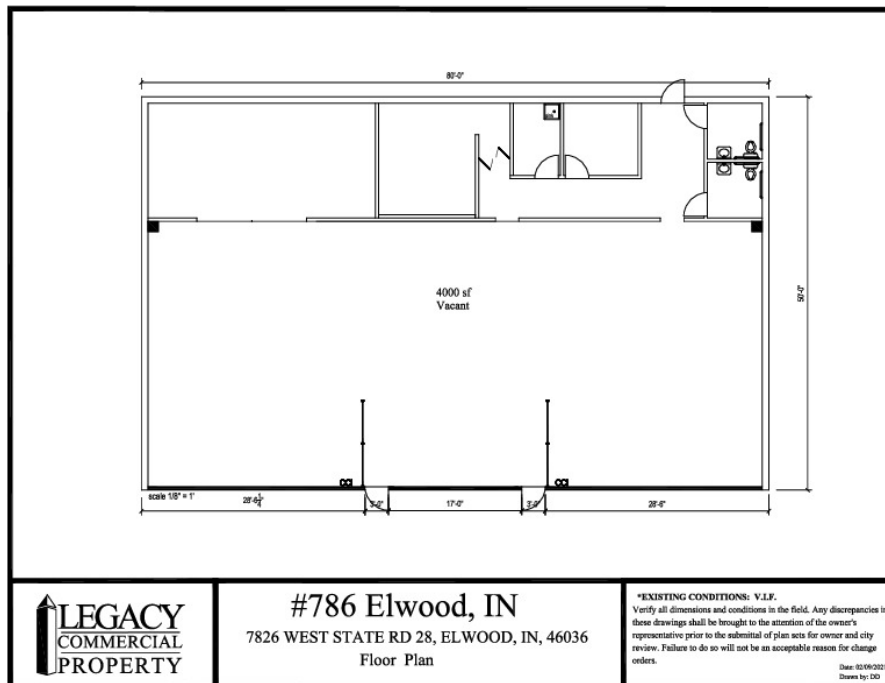

Presented By:

Legacy Commercial Property

847.904.9200

info@legacypro.com



**LEGACY**  
COMMERCIAL PROPERTY

209 Powell Place  
Brentwood, TN 37027  
<http://legacypro.com>