



McFadden Center

1700-1766 East McFadden Avenue
Santa Ana, California 92705

Property Highlights

- Available suite is Part of an approx. 184,737 SF best in class business park
- 1,480 SF & 1,775 SF Spaces Availab
- Easy Access & Central Location to 55 & 5 Freeways
- Ample Parking w/ Multiple Ingress/Egress
- 50+ Co-Tenants, Providing Strong Day-Time Population
- Strong Synergy with Various Long-Term Tenants
- Monument Sign Available
- Join: 7 Leaves, Pizza Hut, and Miguel's Jr

OFFERING SUMMARY

Lease Rate:	\$1.95 SF/month (NNN, \$0.67)
Available SF:	1,480 - 1,775 SF
Lot Size:	13.47 Acres
Building Size:	184,737 SF

SPACES	LEASE RATE	SPACE SIZE
R	\$1.95 SF/month	1,480 SF
L	\$1.95 SF/month	1,775 SF

Steve Liu

Executive Vice President | C: 714.349.3547
sliu@naicapital.com | CalDRE #01323150

Nikki Liu

Senior Associate | C: 818.744.3398
nliu@naicapital.com | CalDRE #02038755



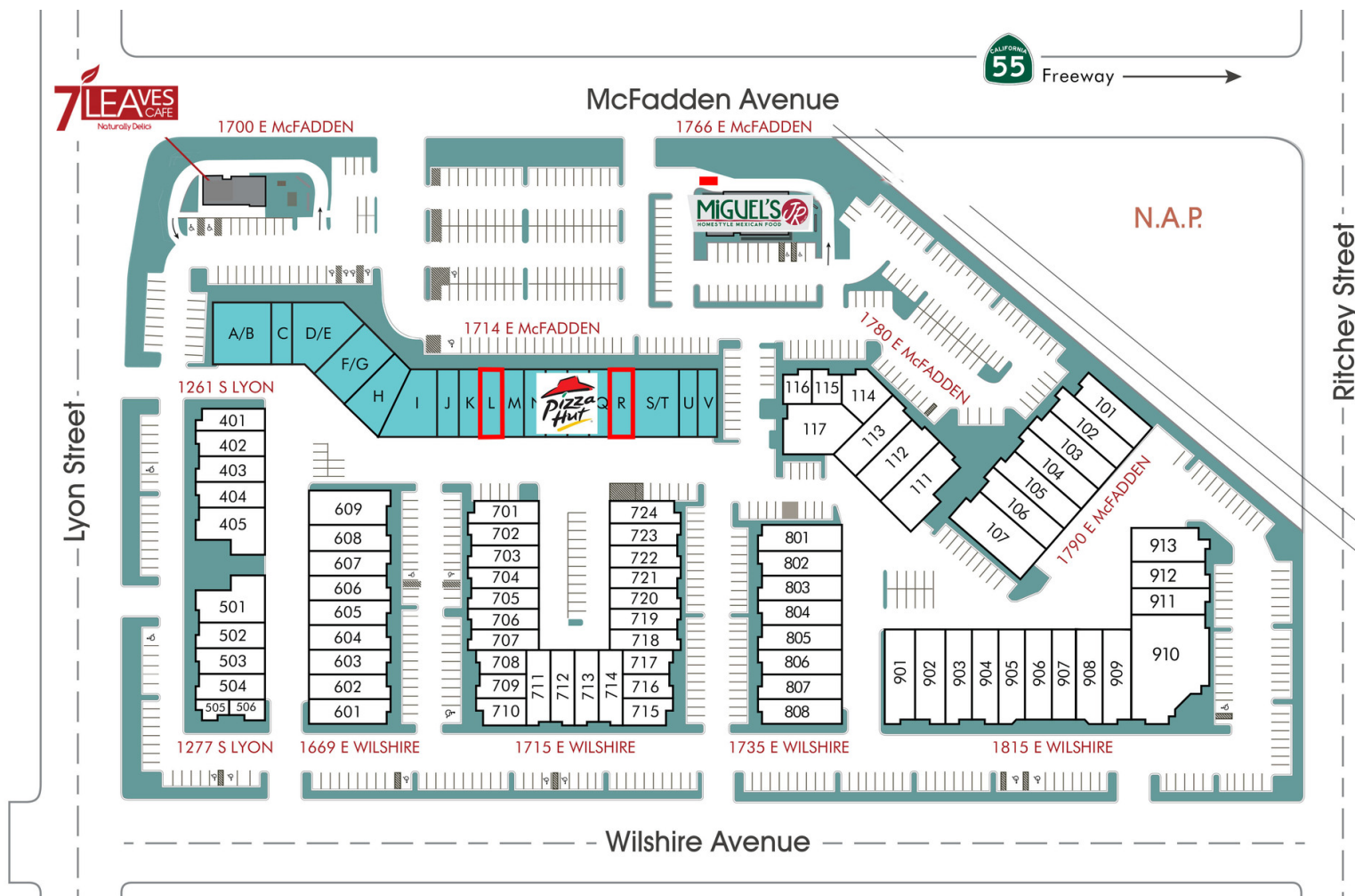

Multi-Tenant Flex Units



In-line Retail & Restaurants

McFadden Center | Multi-Tenant Flex Park

mcfaddencenter.com

The information contained herein has been obtained from sources we deem reliable. While we have no reason to doubt its accuracy, we do not guarantee it. All rights Reserved.



Steve Liu

Executive Vice President | C: 714.349.3547
slu@naicapital.com | CalDRE #01323150

Nikki Liu

Senior Associate | C: 818.744.3398
nliu@naicapital.com | CalDRE #02038755





Steve Liu

Executive Vice President | C: 714.349.3547
sliu@naicapital.com | CalDRE #01323150

Nikki Liu

Senior Associate | C: 818.744.3398
nliu@naicapital.com | CalDRE #02038755





FOR LEASE



MCFADDEN CENTER



1,480 - 1,775 SF



Steve Liu

Executive Vice President | C: 714.349.3547
sliu@naicapital.com | CalDRE #01323150

Nikki Liu

Senior Associate | C: 818.744.3398
nliu@naicapital.com | CalDRE #02038755



www.naicapital.com

NO WARRANTY, EXPRESS OR IMPLIED, IS MADE AS TO THE ACCURACY OF THE INFORMATION CONTAINED HEREIN. THIS INFORMATION IS SUBMITTED SUBJECT TO ERRORS, OMISSIONS, CHANGE OF PRICE, RENTAL OR OTHER CONDITIONS. WITHDRAWAL WITHOUT NOTICE, AND IS SUBJECT TO ANY SPECIAL LISTING CONDITIONS IMPOSED BY OUR PRINCIPALS. COOPERATING BROKERS, BUYERS, TENANTS AND OTHER PARTIES WHO RECEIVE THIS DOCUMENT SHOULD NOT RELY ON IT, BUT SHOULD USE IT AS A STARTING POINT OF ANALYSIS, AND SHOULD INDEPENDENTLY CONFIRM THE ACCURACY OF THE INFORMATION CONTAINED HEREIN THROUGH A DUE DILIGENCE REVIEW OF THE BOOKS, RECORDS, FILES AND DOCUMENTS THAT CONSTITUTE RELIABLE SOURCES OF THE INFORMATION DESCRIBED HEREIN. LOGOS ARE FOR IDENTIFICATION PURPOSES ONLY AND MAY BE TRADEMARKS OF THEIR RESPECTIVE COMPANIES. NAI CAPITAL COMMERCIAL, INC. CAL DRE LIC. #02130474

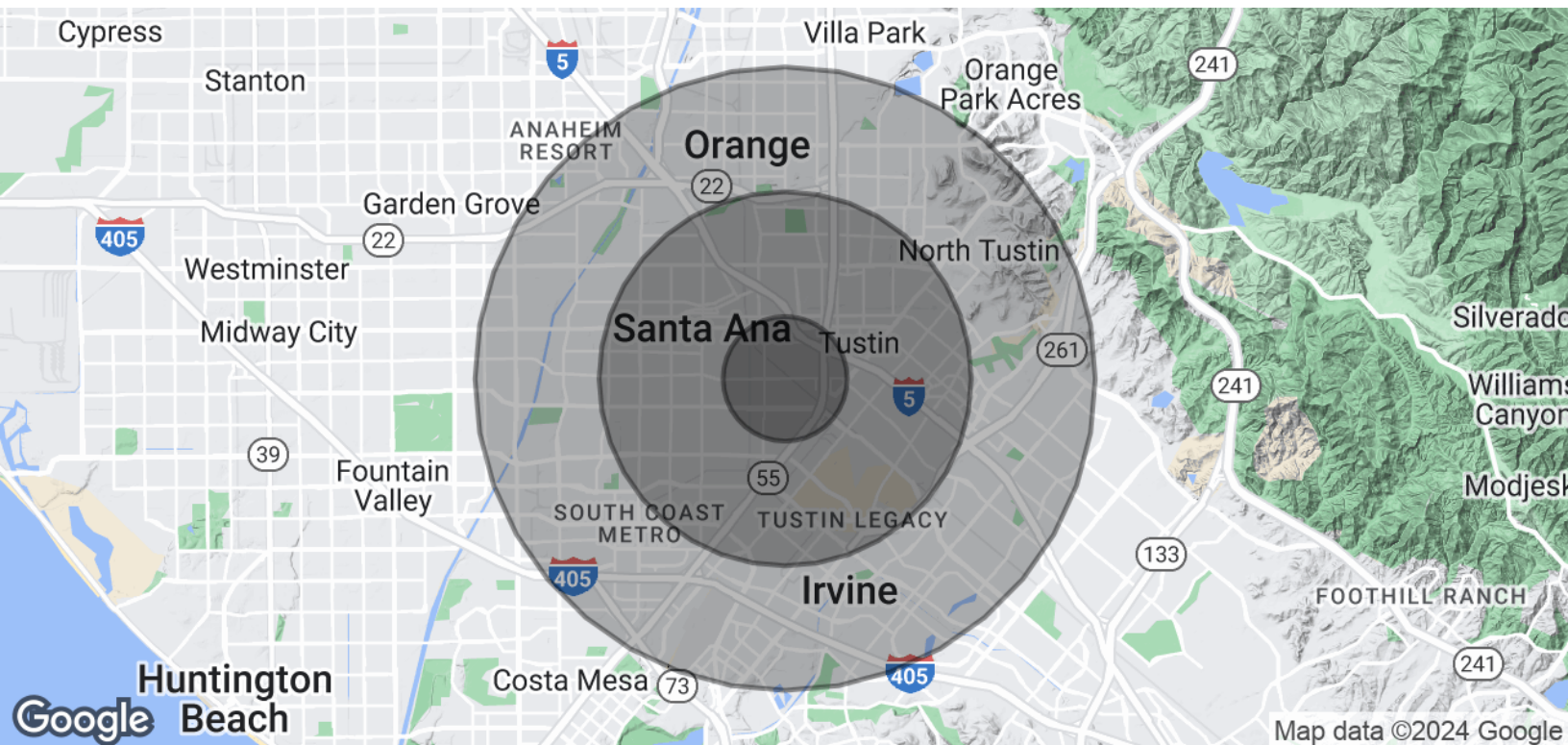

POPULATION	1 MILE	3 MILES	5 MILES
Total Population	31,285	256,618	628,170
Average age	26.1	29.7	31.6
Average age (Male)	26.2	29.6	31.2
Average age (Female)	26.2	30.0	32.0
HOUSEHOLDS & INCOME	1 MILE	3 MILES	5 MILES
Total households	7,818	65,693	176,391
# of persons per HH	4.0	3.9	3.6
Average HH income	\$52,218	\$71,238	\$84,764
Average house value	\$427,660	\$519,439	\$549,567

* Demographic data derived from 2020 ACS - US Census

Steve Liu

Executive Vice President | C: 714.349.3547
sliu@naicapital.com | CalDRE #01323150

Nikki Liu

Senior Associate | C: 818.744.3398
nliu@naicapital.com | CalDRE #02038755

