



OFFICE PROPERTY // FOR LEASE

80 - 1,488 SF OF OFFICE SPACE ON GROESBECK HWY

27432 GROESBECK HWY
ROSEVILLE, MI 48066



- 80 - 1,488 SF of office space available
- Flexible landlord - many configurations available
- Several windowed offices
- Ample parking
- Groesbeck frontage, just north of I-696



P.A. COMMERCIAL
Corporate & Investment Real Estate

26555 Evergreen Road, Suite 1500
Southfield, MI 48076
248.358.0100
pacommercial.com

We obtained the information above from sources we believe to be reliable. However, we have not verified its accuracy and make no guarantee, warranty or representation about it. It is submitted subject to the possibility of errors, omissions, change of price, rental or other conditions, prior sale, lease or financing, or withdrawal without notice. We include projections, opinions, assumptions or estimates for example only, and they may not represent current, past or future performance of the property. You and your tax and legal advisors should conduct your own investigation of the property and transaction.

27432 GROESBECK HWY, ROSEVILLE, MI 48066 // FOR LEASE

EXECUTIVE SUMMARY

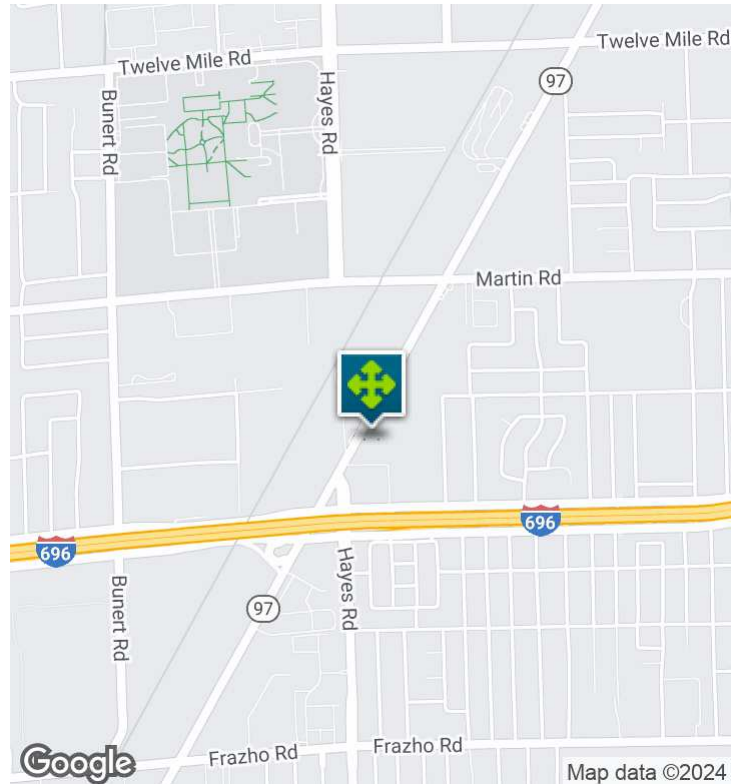

Lease Rate

**\$200.00 -
850.00 PER
MONTH
(GROSS)**

OFFERING SUMMARY

Building Size:	12,104 SF
Available SF:	80 - 677 SF
Lot Size:	2.18 Acres
Year Built:	1985
Zoning:	Light Industrial
Market:	Detroit
Submarket:	Groesbeck South
Traffic Count:	37,250

PROPERTY OVERVIEW

Very well-maintained freestanding office/ building with up to 1,488 SF of office space on Groesbeck Highway available for lease. Available office space includes several individually widowed single offices. Flexible landlord - many configurations are available. Monument signage is possible with municipality approval. Formerly owned and occupied by Comcast.

LOCATION OVERVIEW

High visibility location on Groesbeck Hwy, just north of I-696. Main road frontage and easy access. High traffic count of 37,000 vehicles per day.

PROPERTY HIGHLIGHTS

- 80 - 1,488 SF of office space available
- Several windowed offices
- Groesbeck frontage, just north of I-696
- Flexible landlord - many configurations available
- Ample parking



P.A. COMMERCIAL
Corporate & Investment Real Estate

Kevin Bull SENIOR ASSOCIATE

D: 248.358.5361 | **C:** 248.895.9972

kevin@pacommercial.com

We obtained the information above from sources we believe to be reliable. However, we have not verified its accuracy and make no guarantee, warranty or representation about it. It is submitted subject to the possibility of errors, omissions, change of price, rental or other conditions, prior sale, lease or financing, or withdrawal without notice. We include projections, opinions, assumptions or estimates for example only, and they may not represent current, past or future performance of the property. You and your tax and legal advisors should conduct your own investigation of the property and transaction.

27432 GROESBECK HWY, ROSEVILLE, MI 48066 // FOR LEASE

PROPERTY DETAILS

LOCATION INFORMATION

Street Address	27432 Groesbeck Hwy
City, State, Zip	Roseville, MI 48066
County	Macomb
Market	Detroit
Sub-market	Groesbeck South
Cross-Streets	Groesbeck Hwy and I-696
Side of the Street	East
Road Type	Paved
Market Type	Medium
Nearest Highway	I-696

BUILDING INFORMATION

Building Size	12,104 SF
Building Class	B
Tenancy	Multiple
Ceiling Height	12 ft
Number of Floors	1
Average Floor Size	12,104 SF
Year Built	1985
Construction Status	Existing
Free Standing	Yes
Number of Buildings	1

PROPERTY INFORMATION

Property Type	Office
Property Subtype	Office Building
Zoning	Light Industrial
Lot Size	2.18 Acres
APN #	08-14-18-352-005
Lot Frontage	140 ft
Lot Depth	750 ft
Corner Property	No
Traffic Count	37,250
Traffic Count Street	Groesbeck Hwy
Power	Yes
Rail Access	No

PARKING & TRANSPORTATION

Street Parking	No
Parking Type	Surface
Number of Parking Spaces	100

UTILITIES & AMENITIES

Central HVAC	Yes
Leed Certified	No
Gas / Propane	Yes



P.A. COMMERCIAL
Corporate & Investment Real Estate

We obtained the information above from sources we believe to be reliable. However, we have not verified its accuracy and make no guarantee, warranty or representation about it. It is submitted subject to the possibility of errors, omissions, change of price, rental or other conditions, prior sale, lease or financing, or withdrawal without notice. We include projections, opinions, assumptions or estimates for example only, and they may not represent current, past or future performance of the property. You and your tax and legal advisors should conduct your own investigation of the property and transaction.

Kevin Bull SENIOR ASSOCIATE

D: 248.358.5361 | **C:** 248.895.9972

kevin@pacommercial.com

27432 GROESBECK HWY, ROSEVILLE, MI 48066 // FOR LEASE

LEASE SPACES

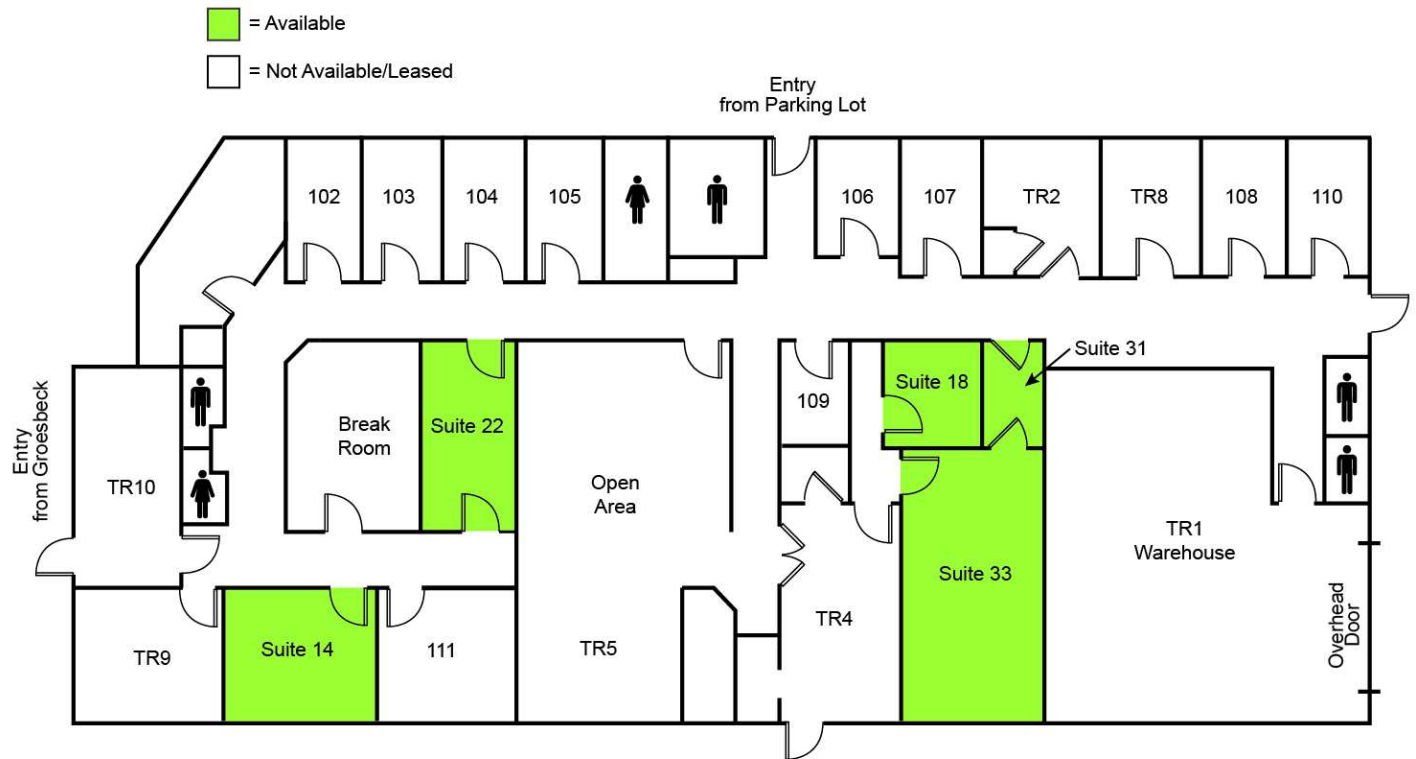

LEASE INFORMATION

Lease Type:	Gross	Lease Term:	Negotiable
Total Space:	80 - 677 SF	Lease Rate:	\$200.00 - \$850.00 per month

AVAILABLE SPACES

SUITE	TENANT	SIZE (SF)	LEASE TYPE	LEASE RATE	DESCRIPTION
27432 Groesbeck Hwy, Suite 33	Available	677 SF	Gross	\$850 per month	-
27432 Groesbeck Hwy, Suite 22	Available	165 SF	Gross	\$400 per month	-
27432 Groesbeck Hwy, Suite 14	Available	446 SF	Gross	\$600 per month	-
27432 Groesbeck Hwy, Suite 18	Available	120 SF	Gross	\$400 per month	-
27432 Groesbeck Hwy, Suite 31	Available	80 SF	Gross	\$200 per month	-

27432 GROESBECK HWY, ROSEVILLE, MI 48066 // FOR LEASE
ADDITIONAL PHOTOS



P.A. COMMERCIAL
Corporate & Investment Real Estate

We obtained the information above from sources we believe to be reliable. However, we have not verified its accuracy and make no guarantee, warranty or representation about it. It is submitted subject to the possibility of errors, omissions, change of price, rental or other conditions, prior sale, lease or financing, or withdrawal without notice. We include projections, opinions, assumptions or estimates for example only, and they may not represent current, past or future performance of the property. You and your tax and legal advisors should conduct your own investigation of the property and transaction.

Kevin Bull SENIOR ASSOCIATE
D: 248.358.5361 | C: 248.895.9972
kevin@pacommercial.com

27432 GROESBECK HWY, ROSEVILLE, MI 48066 // FOR LEASE
LOCATION MAPS

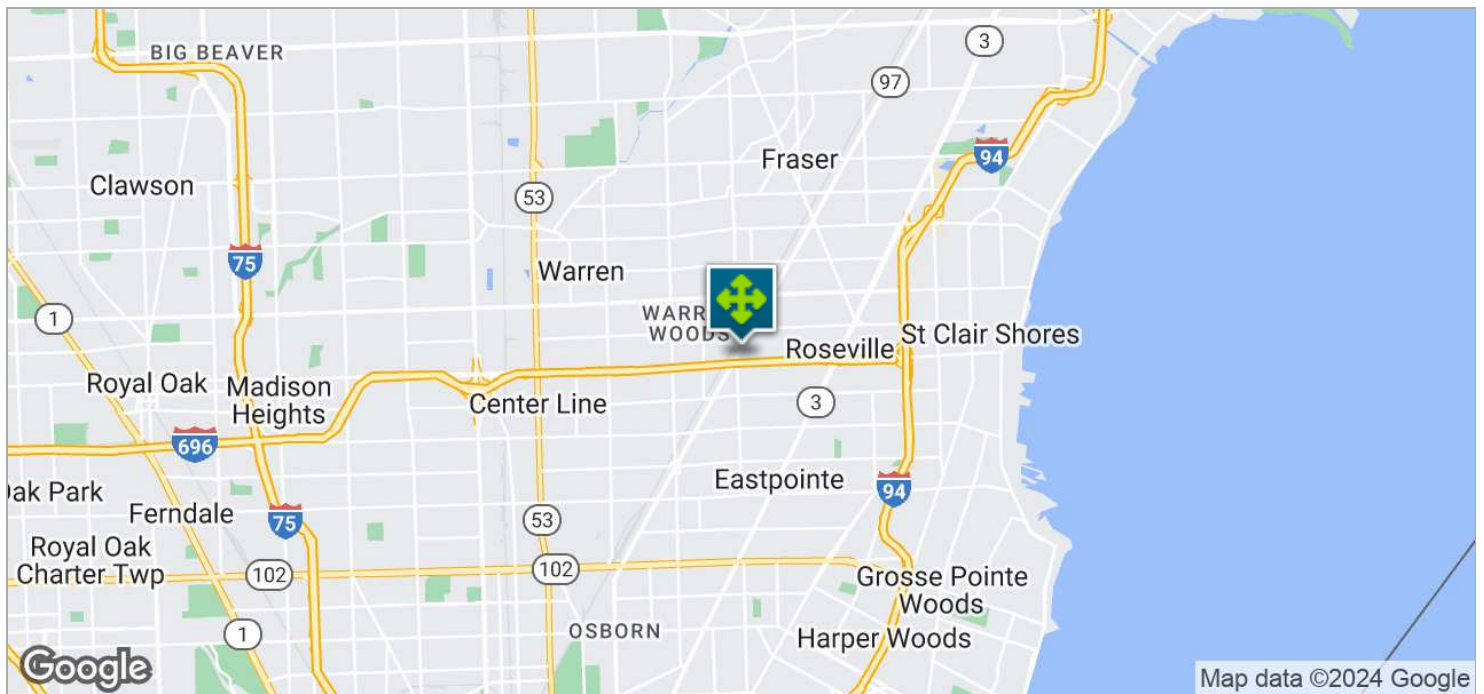
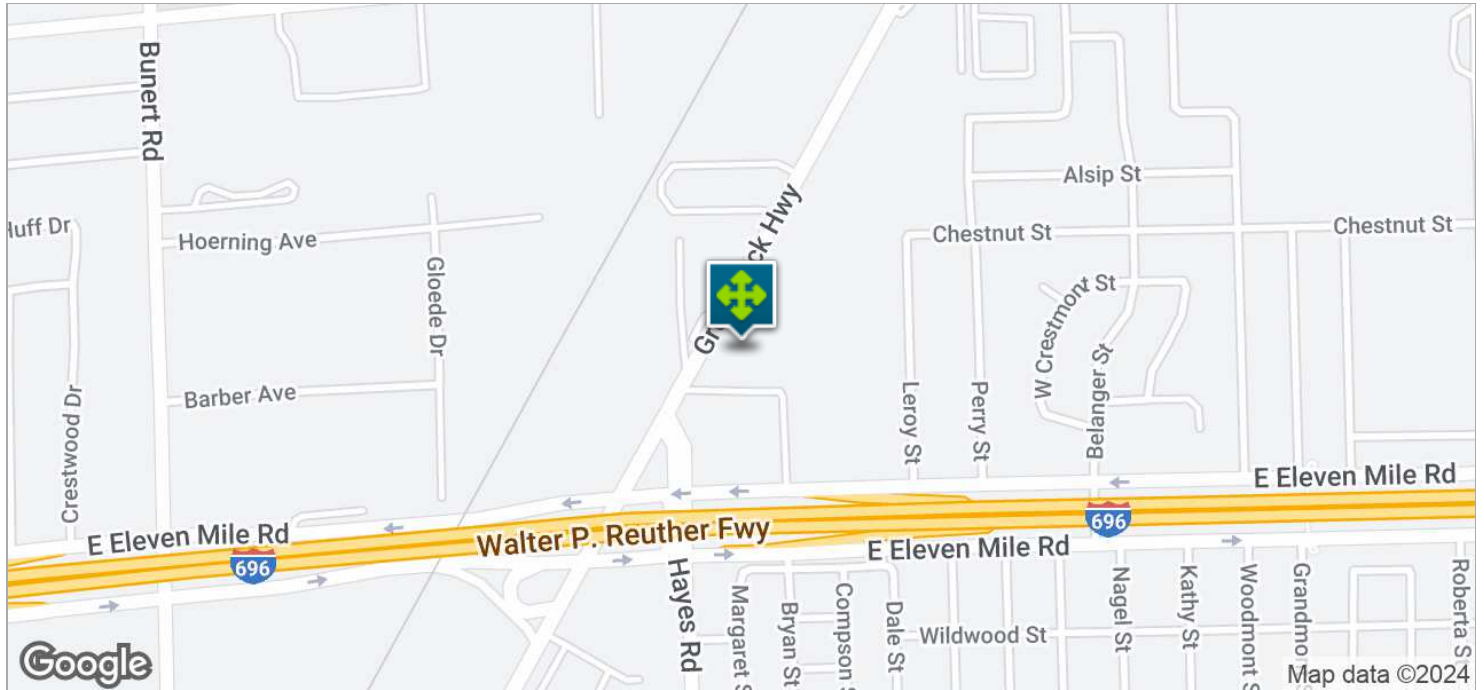

P.A. COMMERCIAL
Corporate & Investment Real Estate

Kevin Bull SENIOR ASSOCIATE
D: 248.358.5361 | C: 248.895.9972
kevin@pacommercial.com

We obtained the information above from sources we believe to be reliable. However, we have not verified its accuracy and make no guarantee, warranty or representation about it. It is submitted subject to the possibility of errors, omissions, change of price, rental or other conditions, prior sale, lease or financing, or withdrawal without notice. We include projections, opinions, assumptions or estimates for example only, and they may not represent current, past or future performance of the property. You and your tax and legal advisors should conduct your own investigation of the property and transaction.

27432 GROESBECK HWY, ROSEVILLE, MI 48066 // FOR LEASE

DEMOGRAPHICS MAP & REPORT

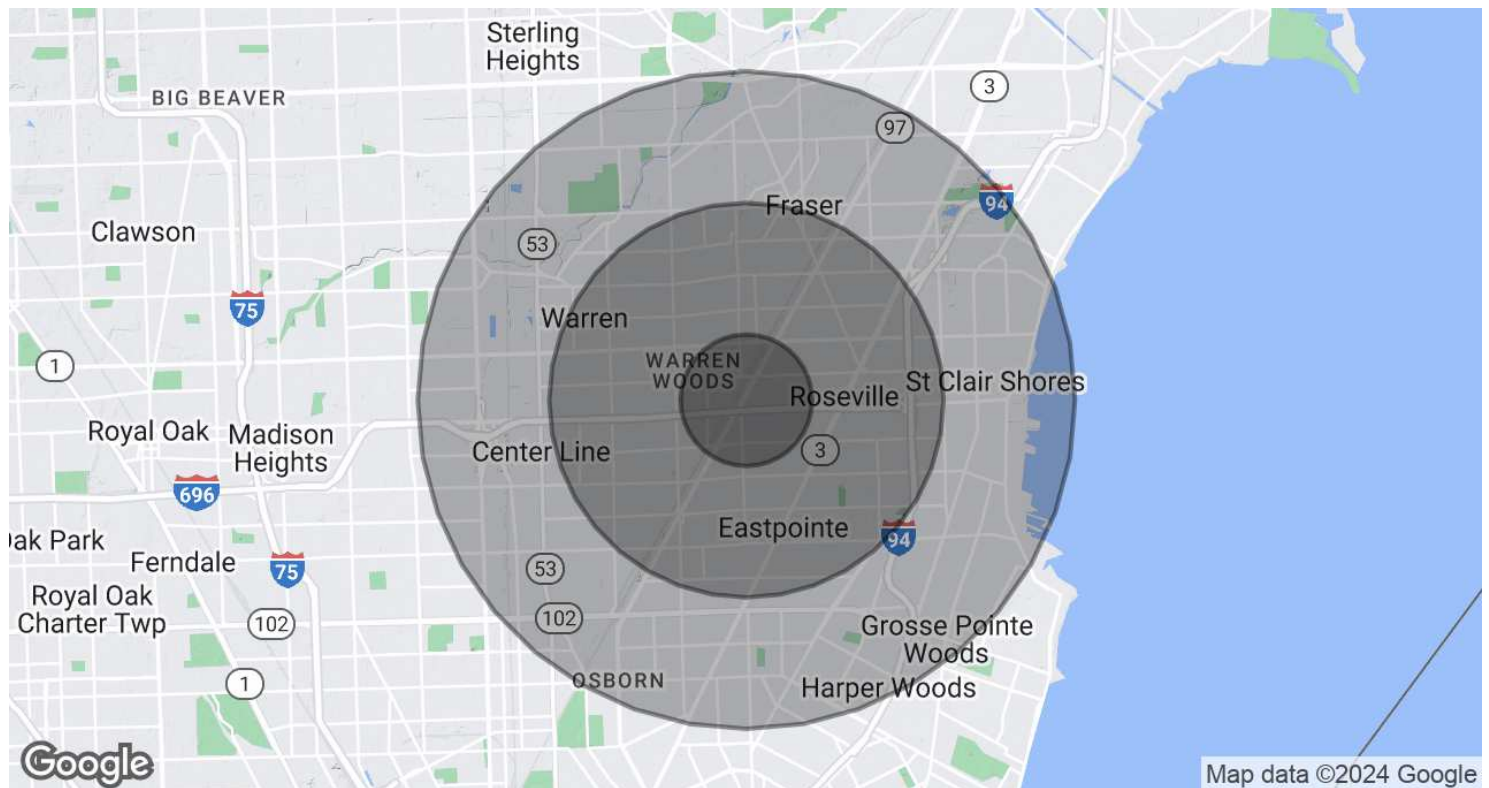

POPULATION	1 MILE	3 MILES	5 MILES
Total Population	13,056	143,659	379,549
Average Age	39.0	38.7	38.0
Average Age (Male)	38.5	37.6	36.3
Average Age (Female)	38.8	40.0	39.5

HOUSEHOLDS & INCOME	1 MILE	3 MILES	5 MILES
Total Households	5,194	58,779	151,473
# of Persons per HH	2.5	2.4	2.5
Average HH Income	\$58,388	\$53,735	\$54,188
Average House Value	\$131,962	\$127,163	\$131,228

* Demographic data derived from 2020 ACS - US Census

27432 GROESBECK HWY, ROSEVILLE, MI 48066 // FOR LEASE



FOR MORE INFORMATION, PLEASE CONTACT:



Kevin Bull

SENIOR ASSOCIATE

D: 248.358.5361

C: 248.895.9972

kevin@pacommercial.com

P.A. Commercial

26555 Evergreen Road, Suite 1500

Southfield, MI 48076

P: 248.358.0100

F: 248.358.5300

pacommercial.com

Follow Us!



P.A. COMMERCIAL
Corporate & Investment Real Estate

We obtained the information above from sources we believe to be reliable. However, we have not verified its accuracy and make no guarantee, warranty or representation about it. It is submitted subject to the possibility of errors, omissions, change of price, rental or other conditions, prior sale, lease or financing, or withdrawal without notice. We include projections, opinions, assumptions or estimates for example only, and they may not represent current, past or future performance of the property. You and your tax and legal advisors should conduct your own investigation of the property and transaction.